

Submit to Appropriate  
District Office  
State Lease-4 copies  
Fee Lease-3 copies

State of New Mexico  
Energy, Minerals and Natural Resources Department

Form C-102  
Revised 1-1-89

OIL CONSERVATION DIVISION

P.O. Box 2088  
Santa Fe, New Mexico 87504-2088

DISTRICT I  
P.O. Box 1980, Hobbs, NM 88240

DISTRICT II  
P.O. Drawer DD, Artesia, NM 88210

DISTRICT III  
1000 Rio Brazos Rd., Aztec, NM 87410

WELL LOCATION AND ACREAGE DEDICATION PLAT

All distances must be from the outer boundaries of the Section.

Operator Exxon Corporation			Lease NEW MEXICO STATE "S"		Well No. 12
Unit Letter A	Section 2	Township 22/S	Range 37/E	County NMPM	LEA
Actual Footage Location of Well: 660 feet from the NORTH line and 760 feet from the EAST line.					
Ground level Elev. 3,370'	Producing Formation BLINEBRY	Pool BLINEBRY (PRO GAS)(CONSOLIDATED)		Dedicated Acreage: 48 Acres	
1. Outline the acreage dedicated to the subject well by colored pencil or hatchure marks on the plat below.					
2. If more than one lease is dedicated to the well, outline each and identify the ownership thereof (both as to working interest and royalty).					
3. If more than one lease of different ownership is dedicated to the well, have the interest of oil owners been consolidated by communitization, unitization, force-pooling, etc.? <input type="checkbox"/> Yes <input type="checkbox"/> No If answer is "yes", type of consolidation _____ If answer is "no", list the owners and tract descriptions which have actually been consolidated. (Use reverse side of this form if necessary.) _____ No allowable will be assigned to the well until all interests have been consolidated (by communitization, unitization, forced-pooling, or otherwise) or until a non-standard unit, eliminating such interest, has been approved by the Division.					

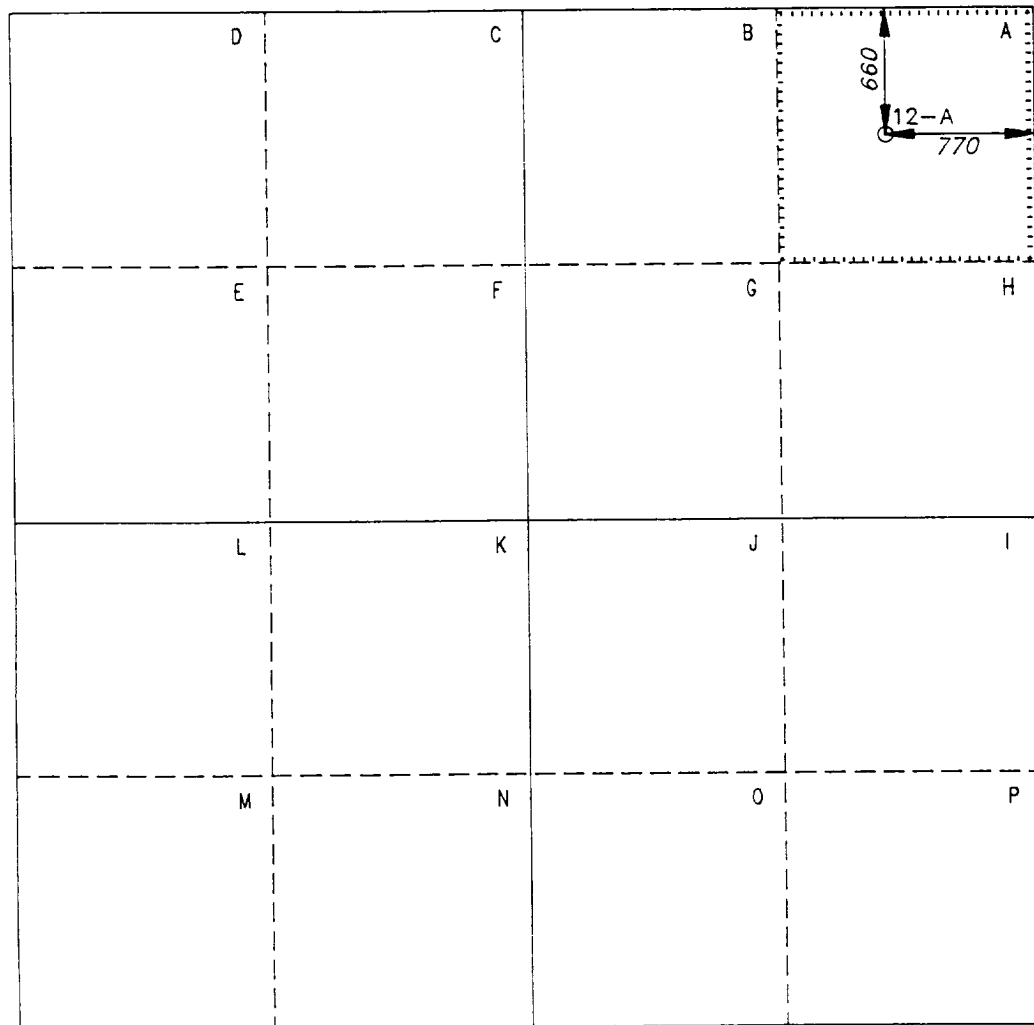

OPERATOR CERTIFICATION

I hereby certify that the information  
contained herein is true and complete to the  
best of my knowledge and belief.

Signature  
C. H. Harper

Printed Name  
C.H. HARPER

Position  
PERMITS SUPERVISOR

Company Exxon Corporation  
P.O. Box 1600-Midland, Tx.-79702

Date  
10-11-93

SURVEYOR CERTIFICATION

I hereby certify that the well location  
shown on this plat was plotted from field  
notes of actual surveys made by me or  
under my supervision, and that the same  
is true and correct to the best of my  
knowledge and belief.

Date Surveyed  
6/6/74

Signature & Seal of  
Professional Surveyor

Certificate No.

Submit to Appropriate  
District Office  
State Lease—4 copies  
Fee Lease—3 copies

State of New Mexico  
En. gy, Minerals and Natural Resources Department

Form C-102  
Revised 1-1-89

OIL CONSERVATION DIVISION

P.O. Box 2088  
Santa Fe, New Mexico 87504-2088

DISTRICT I  
P.O. Box 1980, Hobbs, NM 88240

DISTRICT II  
P.O. Drawer DD, Artesia, NM 88210

DISTRICT III  
1000 Rio Brazos Rd., Aztec, NM 87410

WELL LOCATION AND ACREAGE DEDICATION PLAT

All distances must be from the outer boundaries of the Section.

Operator Exxon Corporation			Lease NEW MEXICO STATE "S"		Well No. 12-A
Unit Letter A	Section 2	Township 22/S	Range 37/E	County NMPM	LEA
Actual Footage Location of Well: 660 feet from the NORTH line and 760 feet from the EAST line.					
Ground level Elev. 3,370'	Producing Formation BLINEBRY		Pool BLINEBRY OIL & GAS		Dedicated Acreage: 80 Acres

- Outline the acreage dedicated to the subject well by colored pencil or hachure marks on the plat below. (79.50)
- If more than one lease is dedicated to the well, outline each and identify the ownership thereof (both as to working interest and royalty).
- If more than one lease of different ownership is dedicated to the well, have the interest of all owners been consolidated by communitization, unitization, force-pooling, etc.?

☐ Yes ☐ No If answer is "yes", type of consolidation \_\_\_\_\_

If answer is "no", list the owners and tract descriptions which have actually been consolidated. (Use reverse side of this form if necessary.) \_\_\_\_\_

No allowable will be assigned to the well until all interests have been consolidated (by communitization, unitization, forced-pooling, or otherwise) or until a non-standard unit, eliminating such interest, has been approved by the Division.

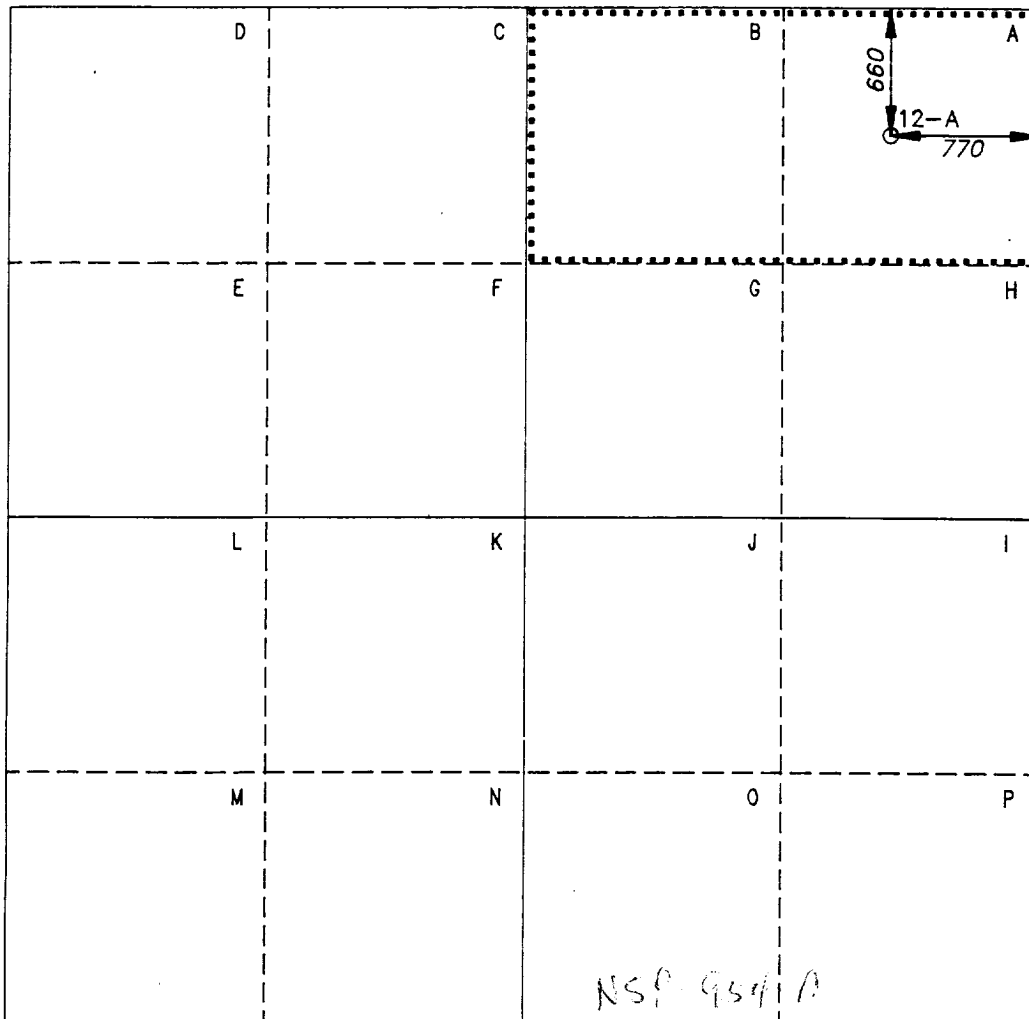

OPERATOR CERTIFICATION

I hereby certify that the information contained herein is true and complete to the best of my knowledge and belief.

Signature

Printed Name

C.H. HARPER

Position

PERMITS SUPERVISOR

Company Exxon Corporation

P.O. Box 1600-Midland, Tx.-79702

Date

1-29-93

SURVEYOR CERTIFICATION

I hereby certify that the well location shown on this plat was plotted from field notes of actual surveys made by me or under my supervision, and that the same is true and correct to the best of my knowledge and belief.

Date Surveyed

6/6/74

Signature & Seal of  
Professional Surveyor

Certificate No.

1.6 Miles SE of EUNICE, New Mexico.

C.E. File No. A01839w

OIL CONSERVATION DIVISION

DISTRICT I  
P.O. Box 1980, Hobbs, NM 88240

DISTRICT II  
P.O. Drawer DD, Artesia, NM 88210

DISTRICT III  
1000 Rio Brizos Rd., Aztec, NM 87410

P.O. Box 2088  
Santa Fe, New Mexico 87504-2088

JAN 13 92

WELL LOCATION AND ACREAGE DEDICATION PLAT

All distances must be from the outer boundaries of the Section.

Operator Exxon Corporation			Lease NEW MEXICO "S" STATE		Well No. 12-A
Unit Letter "A"	Section 2	Township 22/S	Range 37/E	County NMPM	LEA
Actual Footage Location of Well: 660 feet from the NORTH line and 760 feet from the EAST line.					
Ground level Elev. 3,370'	Producing Formation BLINEBRY	Pool BLINEBRY OIL & GAS		Dedicated Acreage: 40 Acres	

- Outline the acreage dedicated to the subject well by colored pencil or hatchure marks on the plat below.
- If more than one lease is dedicated to the well, outline each and identify the ownership thereof (both as to working interest and royalty).
- If more than one lease of different ownership is dedicated to the well, have the interest of all owners been consolidated by communitization, unitization, force-pooling, etc.?

☐ Yes ☐ No If answer is "yes", type of consolidation

If answer is "no", list the owners and tract descriptions which have actually been consolidated. (Use reverse side of this form if necessary.)

No allowable will be assigned to the well until all interests have been consolidated (by communitization, unitization, forced-pooling, or otherwise) or until a non-standard unit, eliminating such interest, has been approved by the Division.

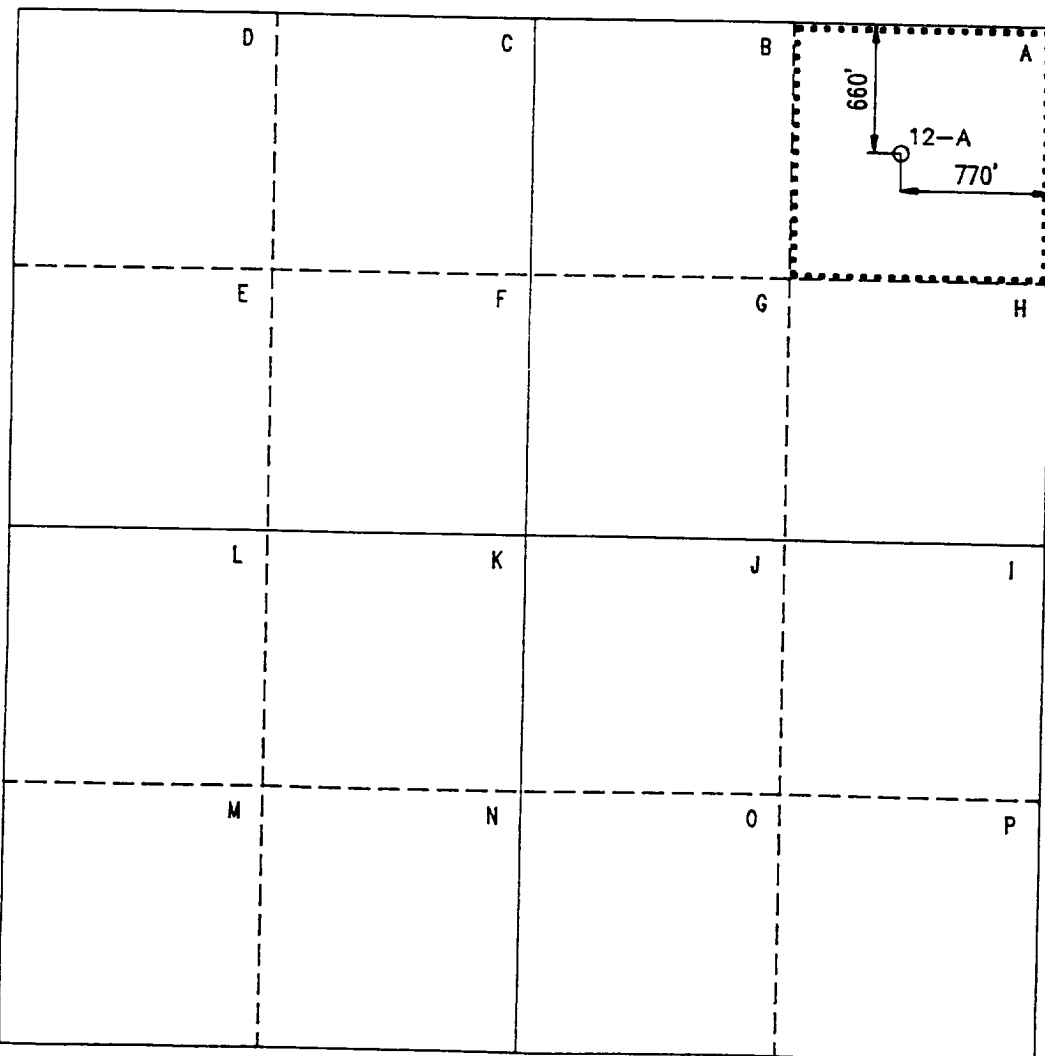

OPERATOR CERTIFICATION

I hereby certify that the information contained herein is true and complete to the best of my knowledge and belief.

Signature

Printed Name

Position  
PERMITS SUPERVISOR

Company Exxon Corporation  
P.O. Box 1600-Midland, Tx.-79702

Date

SURVEYOR CERTIFICATION

I hereby certify that the well location shown on this plat was plotted from field notes of actual surveys made by me or under my supervision, and that the same is true and correct to the best of my knowledge and belief.

Date Surveyed  
6/6/74

Signature & Seal of  
Professional Surveyor

Certificate No.

0 330 660 990 1320 1650 1980 2310 2640 2000 1500 1000 500 0

6 Miles S of EUNICE, New Mexico.

C.E. File No. A06834AA

Exxon Lse. No. 3772State Lse. No. P

Federal Lse. No. \_\_\_\_\_

NEW MEXICO OIL CONSERVATION COMMISSION  
WELL LOCATION AND ACREAGE DEDICATION PL.Form C-102  
Supersedes C-128  
Effective 1-1-65

All distances must be from the outer boundaries of the Section.

Operator Exxon Corporation			Lease New Mexico "S" State		Well No. 12
Unit Letter "A"	Section 2	Township 22-S	Range 37-E	County Lea	
Actual Footage Location of Well: 660 feet from the North line and 760 feet from the East line					
Ground Level Elev. 3,370'	Producing Formation Clearfork		Pool Blinebry (Gas)		Dedicated Acreage: 120 Acres

1. Outline the acreage dedicated to the subject well by colored pencil or hachure marks on the plat below.
2. If more than one lease is dedicated to the well, outline each and identify the ownership thereof (both as to working interest and royalty).
3. If more than one lease of different ownership is dedicated to the well, have the interests of all owners been consolidated by communitization, unitization, force-pooling, etc?

☐ Yes ☐ No If answer is "yes," type of consolidation \_\_\_\_\_

If answer is "no," list the owners and tract descriptions which have actually been consolidated. (Use reverse side of this form if necessary.) \_\_\_\_\_

No allowable will be assigned to the well until all interests have been consolidated (by communitization, unitization, forced-pooling, or otherwise) or until a non-standard unit, eliminating such interests, has been approved by the Commission.

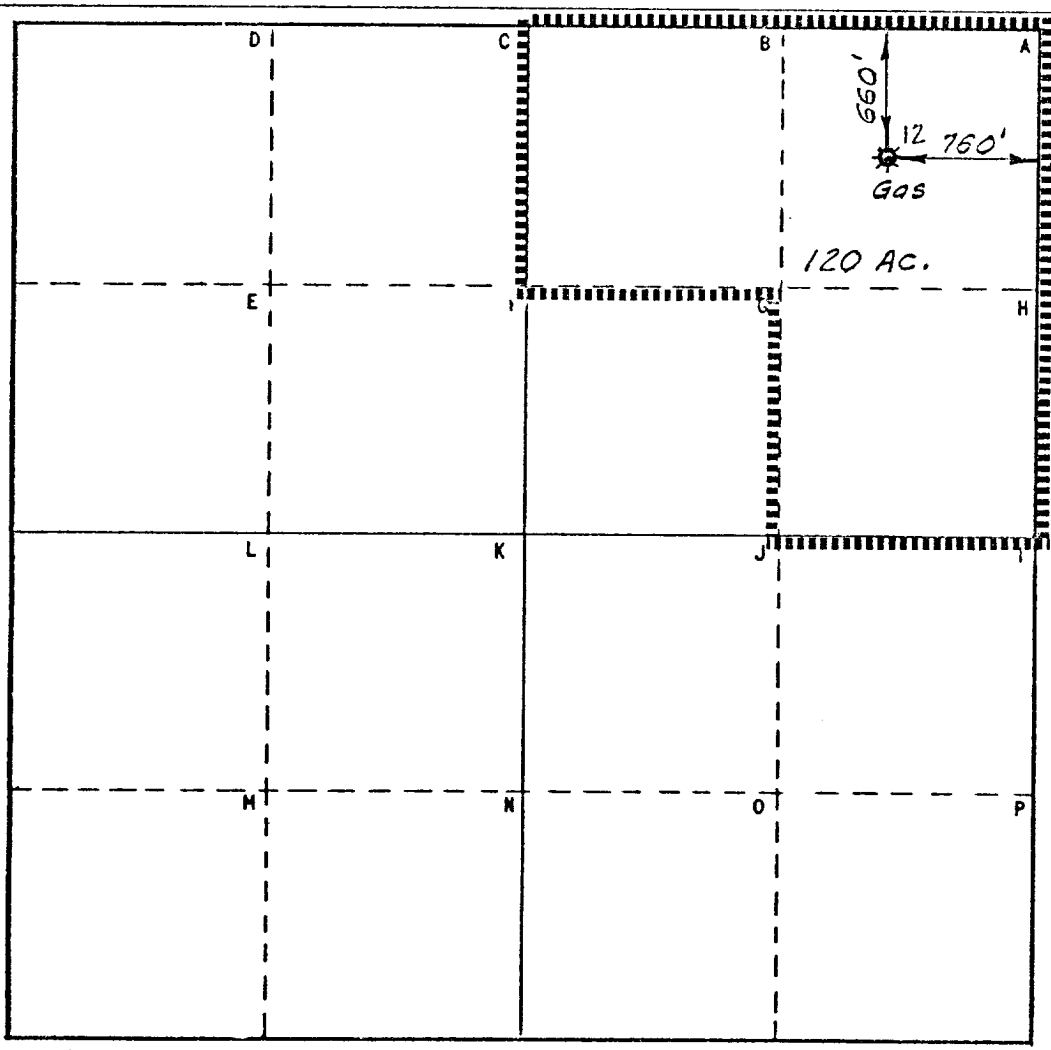

## CERTIFICATION

I hereby certify that the information contained herein is true and complete to the best of my knowledge and belief.

Name A. L. ClemmerPosition Proration SpecialistCompany Exxon Corporation  
Box 1600 Midland, TexasDate June 6, 1974

I hereby certify that the well location shown on this plat was plotted from field notes of actual surveys made by me or under my supervision, and that the same is true and correct to the best of my knowledge and belief.

Date Surveyed 6/6/74Registered Professional Engineer  
and/or Land SurveyorH. S. HesterfieldCertificate No. 13826 Miles S of Eunice, New MexicoC.E. Sec. File No. A-6834

**DUPLICATE**

NEW MEXICO  
OIL CONSERVATION COMMISSION

Gas Well Plat

Date 11-12-53

HUMBLE OIL & REFINING CO.

New Mexico State "S"

12

Operator

Lease

Well No.

(Drinkard - Oil)

Name of Producing Formation Blinebry

Pool Blinebry

No. Acres Dedicated to the Well 160

SECTION 2 TOWNSHIP 22 - S RANGE 37 - E

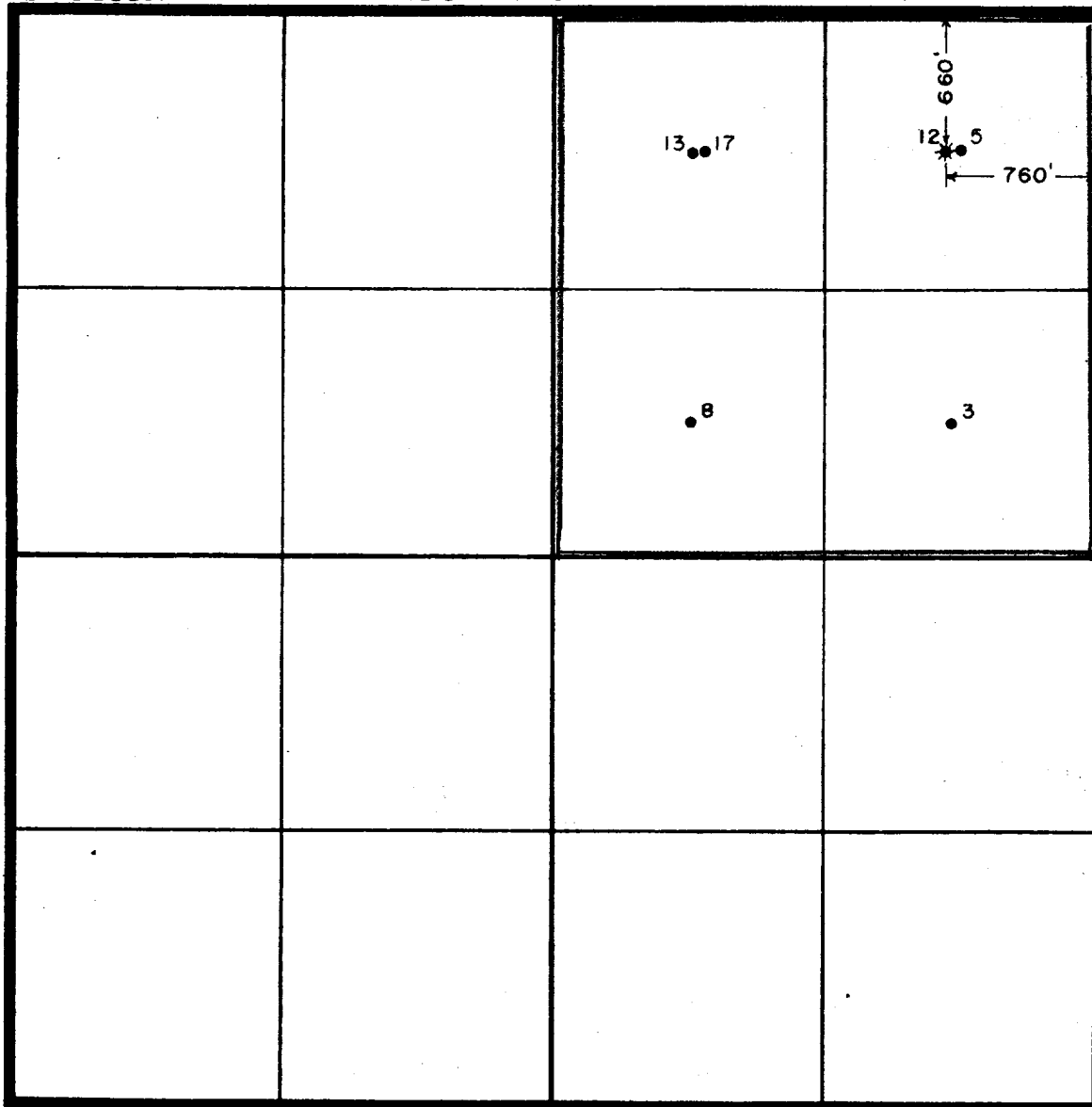

I hereby certify that the information given above is true and complete to the best of my knowledge.

1. Is this gas well a dual completion? Yes No
2. Are there any other dually completed wells within the dedicated acreage? Yes No

Name [Signature]  
Position Assistant Division Superintendent  
Representing Humble Oil & Refining Co.  
Address Box 1600 - Midland, Texas

