

NEW MEXICO OIL CONSERVATION COMMISSION

Santa Fe, New Mexico

## NOTICE OF INTENTION TO DRILL

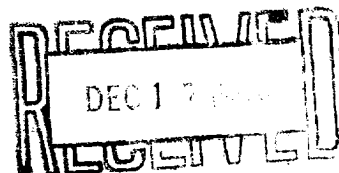

Notice must be given to the Oil Conservation Commission or its proper agent and approval obtained before drilling begins. If changes in the proposed plan are considered advisable, a copy of this notice showing such changes will be returned to the sender. Submit this notice in triplicate. One copy will be returned following approval. See additional instructions in Rules and Regulations of the Commission.

Midland, Texas

December 16, 1946

Place

Date

OIL CONSERVATION COMMISSION,  
Santa Fe, New Mexico,

Gentlemen:

You are hereby notified that it is our intention to commence the drilling of a well to be known as Lease #37721Humble Oil & Refining Company N. M. State "B" Well No. 14 in Center of NE/4

Company or Operator

Lease

of NW/4

of Sec. 2, T. 22-S, R. 37-E, N. M., P. M., Drishard Field, Lea County.

N

The well is 660 feet (N) (S.) of the North line and 1980 feet (E.) (W) of the West line of Center of NE/4 of NW/4 of Section 2

(Give location from section or other legal subdivision lines. Cross out wrong directions.)

If state land the oil and gas lease is No. \_\_\_\_\_ Assignment No. \_\_\_\_\_

If patented land the owner is \_\_\_\_\_

Address \_\_\_\_\_

If government land the permittee is \_\_\_\_\_

Address \_\_\_\_\_

The lessee is Humble Oil & Refining CompanyAddress Box 1600, Midland, Texas

AREA 640 ACRES

LOCATE WELL CORRECTLY

We propose to drill well with drilling equipment as follows:

Rotary RigThe status of a bond for this well in conformance with Rule 39 of the General Rules and Regulations of the Commission is as follows: Now on file in Commission office

We propose to use the following strings of casing and to land or cement them as indicated:

Size of Hole	Size of Casing	Weight Per Foot	New or Second Hand	Depth	Landed or Cemented	Sacks Cement
<u>13"</u>	<u>10-3/4"</u>	<u>40.5#</u>	<u>New</u>	<u>300'</u>	<u>Cemented</u>	<u>200 sz.</u>
<u>9-7/8"</u>	<u>7-5/8"</u>	<u>26.4#</u>	<u>"</u>	<u>2800'</u>	<u>"</u>	<u>1000 sz.</u>
<u>6-3/4"</u>	<u>5-1/2"</u>	<u>15.5#</u>	<u>"</u>	<u>6600'</u>	<u>"</u>	<u>400 sz.</u>

If changes in the above plan become advisable we will notify you before cementing or landing casing. We estimate that the first productive oil or gas sand should occur at a depth of about 6600 feet.

Additional information:

Approved DEC 17 1946, 19\_\_\_\_

except as follows:

Sincerely yours,

Humble Oil & Refining Company

Company or Operator

By [Signature]Position Division Superintendent

Send communications regarding well to

Name J. W. HouseAddress Box 1600, Midland, Texas

OIL CONSERVATION COMMISSION,

By [Signature]Title Oil & Gas Inspector

The first part of the study focuses on the analysis of the data collected from the experiments. The results are presented in a series of tables and figures, which show the variation of the measured quantities with the independent variables. The data are then compared with the theoretical predictions, and the discrepancies are discussed.

The second part of the study is devoted to the discussion of the results. The main findings are summarized, and the implications of the results are discussed. The study concludes with a series of conclusions and recommendations for future work.

The study is organized as follows. In the first section, the introduction is given, followed by the methodology section. The results and discussion section follows, and the study concludes with a series of conclusions and recommendations for future work.

The study is organized as follows. In the first section, the introduction is given, followed by the methodology section. The results and discussion section follows, and the study concludes with a series of conclusions and recommendations for future work.

The study is organized as follows. In the first section, the introduction is given, followed by the methodology section. The results and discussion section follows, and the study concludes with a series of conclusions and recommendations for future work.

The study is organized as follows. In the first section, the introduction is given, followed by the methodology section. The results and discussion section follows, and the study concludes with a series of conclusions and recommendations for future work.

The study is organized as follows. In the first section, the introduction is given, followed by the methodology section. The results and discussion section follows, and the study concludes with a series of conclusions and recommendations for future work.

The study is organized as follows. In the first section, the introduction is given, followed by the methodology section. The results and discussion section follows, and the study concludes with a series of conclusions and recommendations for future work.

The study is organized as follows. In the first section, the introduction is given, followed by the methodology section. The results and discussion section follows, and the study concludes with a series of conclusions and recommendations for future work.

The study is organized as follows. In the first section, the introduction is given, followed by the methodology section. The results and discussion section follows, and the study concludes with a series of conclusions and recommendations for future work.

The study is organized as follows. In the first section, the introduction is given, followed by the methodology section. The results and discussion section follows, and the study concludes with a series of conclusions and recommendations for future work.

The study is organized as follows. In the first section, the introduction is given, followed by the methodology section. The results and discussion section follows, and the study concludes with a series of conclusions and recommendations for future work.

The study is organized as follows. In the first section, the introduction is given, followed by the methodology section. The results and discussion section follows, and the study concludes with a series of conclusions and recommendations for future work.

The study is organized as follows. In the first section, the introduction is given, followed by the methodology section. The results and discussion section follows, and the study concludes with a series of conclusions and recommendations for future work.

The study is organized as follows. In the first section, the introduction is given, followed by the methodology section. The results and discussion section follows, and the study concludes with a series of conclusions and recommendations for future work.

The study is organized as follows. In the first section, the introduction is given, followed by the methodology section. The results and discussion section follows, and the study concludes with a series of conclusions and recommendations for future work.

The study is organized as follows. In the first section, the introduction is given, followed by the methodology section. The results and discussion section follows, and the study concludes with a series of conclusions and recommendations for future work.

The study is organized as follows. In the first section, the introduction is given, followed by the methodology section. The results and discussion section follows, and the study concludes with a series of conclusions and recommendations for future work.

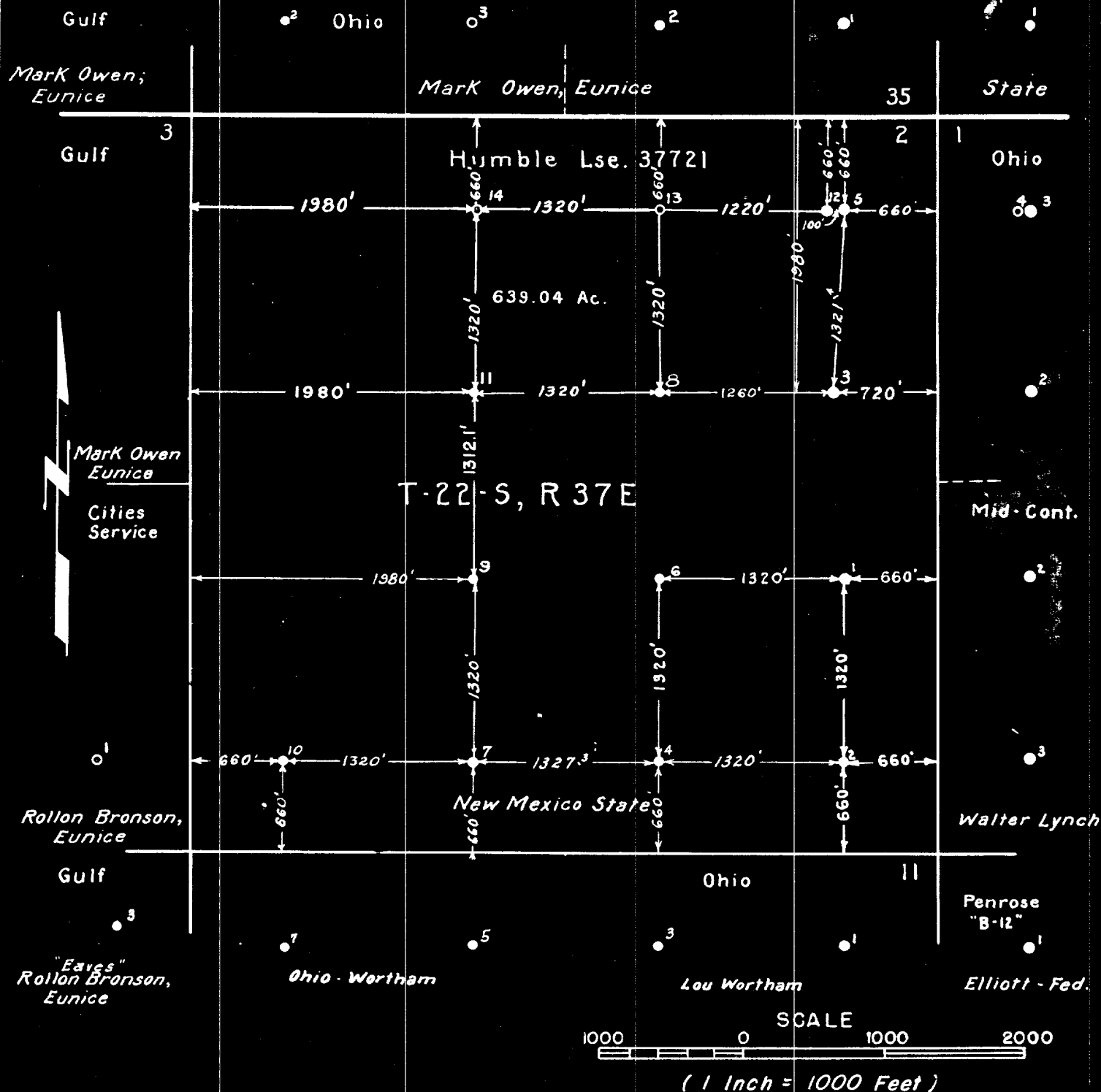

Note: The area shown hereon is a portion of Lease No. 37721 which covers 6023.83 acres, except Parker Drilling Co. owning rights to 4250' depth on SW/4 of SW/4 of Sec. 2, T22S, R37E, Lea Co., NM.

Humble New Mexico State "S" Lease No. 37721  
Sec. 2, T-22-S, R-37-E Lea Co., N.M.

HUMBLE OIL & REFINING COMPANY

**CIVIL ENGINEERING DEPARTMENT**  
MIDLAND, TEXAS

DRAWN C. Watson  
CHECKED [Signature]  
APPR. [Signature]

SCALE 1" = 1000'  
DATE 10-8-45  
REVISE:           

FILE NO.  
**WT-A-417**