

Form 900  
**DUPLICATE**

NEW MEXICO OIL CONSERVATION COMMISSION  
Santa Fe, New Mexico

APR 21 1947  
**RECEIVED**

**NOTICE OF INTENTION TO DRILL**

Notice must be given to the Oil Conservation Commission or its proper agent and approval obtained before drilling begins. If changes in the proposed plan are considered advisable, a copy of this notice showing such changes will be returned to the sender. Submit this notice in triplicate. One copy will be returned following approval. See additional instructions in Rules and Regulations of the Commission.

Midland, Texas

April 18, 1947

Place

Date

OIL CONSERVATION COMMISSION,  
Santa Fe, New Mexico,

Gentlemen:

You are hereby notified that it is our intention to commence the drilling of a well to be known as Lease #37721

Humble Oil & Refining Company N. M. State "S" Well No. 17 in NW/4 of NW/4  
Company or Operator

of Sec. 2, T. 22-S, R. 37-E, N. M., P. M., Paddock Field, Lea County.

The well is 660 feet (N.) (S.) of the North line and 735 feet (E.) (W.) of the West line of NW/4 of NW/4 of Section 2

(Give location from section or other legal subdivision lines. Cross out wrong directions.)

If state land the oil and gas lease is No. \_\_\_\_\_ Assignment No. \_\_\_\_\_

If patented land the owner is \_\_\_\_\_

Address \_\_\_\_\_

If government land the permittee is \_\_\_\_\_

Address \_\_\_\_\_

The lessee is Humble Oil & Refining Company

Address Box 1600, Midland, Texas

We propose to drill well with drilling equipment as follows: \_\_\_\_\_

Rotary Rig

The status of a bond for this well in conformance with Rule 39 of the General Rules and Regulations of the Commission is as follows: Now on file in Commission office

We propose to use the following strings of casing and to land or cement them as indicated:

Size of Hole	Size of Casing	Weight Per Foot	New or Second Hand	Depth	Landed or Cemented	Sacks Cement
<u>12"</u>	<u>10-3/4"</u>	<u>40.5#</u>	<u>New</u>	<u>400'</u>	<u>Cemented</u>	<u>300 sz.</u>
<u>8-3/4"</u>	<u>7-5/8"</u>	<u>26.4#</u>	<u>"</u>	<u>2800'</u>	<u>"</u>	<u>1800 sz.</u>
<u>6-3/4"</u>	<u>5-1/2"</u>	<u>14#</u>	<u>"</u>	<u>5300'</u>	<u>"</u>	<u>500 sz.</u>

If changes in the above plan become advisable we will notify you before cementing or landing casing. We estimate that the first productive oil or gas sand should occur at a depth of about 5300 feet.

Additional information:

Approved APR 21 1947, 19\_\_\_\_  
except as follows:

Sincerely yours,

Humble Oil & Refining Company

Company or Operator

By \_\_\_\_\_

Position Division Superintendent

Send communications regarding well to

Name J. W. House

Address Box 1600, Midland, Texas

OIL CONSERVATION COMMISSION,

By Roy Yarbrough  
Title Oil & Gas Inspector



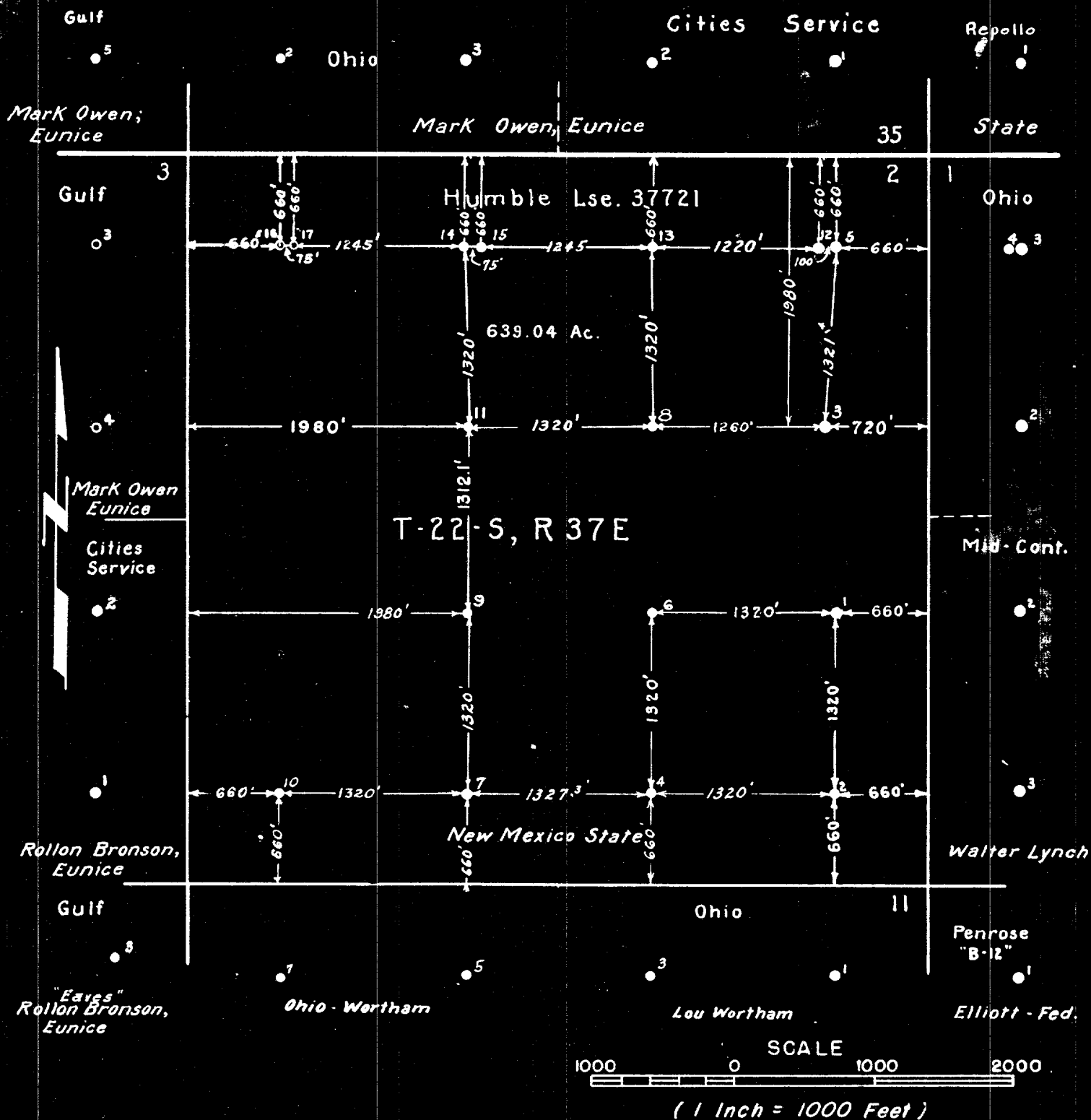

Note: The area shown hereon is a portion of Lease No. 37721 which covers 6023.83 acres, except Parker Drilling Co. owning rights to 4250' depth on SW/4 of SW/4 of Sec. 2, T22S, R37E, Lea Co., NM.

Humble New Mexico State "S" Lease No. 37721  
Sec. 2, T-22-S, R-37-E  
Lea Co., N. M.

HUMBLE OIL & REFINING COMPANY  
CIVIL ENGINEERING DEPARTMENT  
MIDLAND, TEXAS

DRAWN C. Watson  
CHECKED [Signature]  
APPR. [Signature]

SCALE 1" = 1000'  
DATE 10-8-45  
REVISED S.M. Lanham  
2-17-47

FILE NO.  
WT-A-417