

Santa Fe, New Mexico

APR 7 - 1950

## NOTICE OF INTENTION TO DRILL

Notice must be given to the Oil Conservation Commission or its proper agent and approval obtained before drilling begins. If changes in the proposed plan are considered advisable, a copy of this notice showing such changes will be returned to the sender. Submit this notice in triplicate. One copy will be returned following approval. See additional instructions in Rules and Regulations of the Commission.

Midland, Texas

April 6, 1950

Place

Date

OIL CONSERVATION COMMISSION,  
Santa Fe, New Mexico,

Gentlemen:

You are hereby notified that it is our intention to commence the drilling of a well to be known as **Lea. #37721**  
**Humble Oil & Refining Company** **New Mexico State #3** Well No. **21** in **NW/4 of SW/4**  
Company or Operator Lease

of Sec. **2**, T. **22-S**, R. **37-E**, N. M. P. M., **Drinkard** Field, **Lea** County.

N

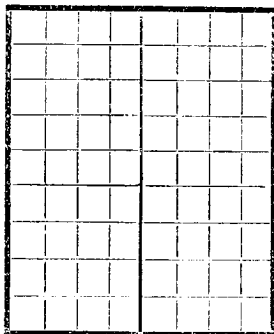

AREA 640 ACRES

LOCATE WELL CORRECTLY

The well is **1980** feet (N.) **(S)** of the **South** line and **500** feet  
(E.) **(W.)** of the **West** line of **NW/4 of SW/4 of Section 2**

(Give location from section or other legal subdivision lines. Cross out wrong directions.)

If state land the oil and gas lease is No. \_\_\_\_\_ Assignment No. \_\_\_\_\_

If patented land the owner is \_\_\_\_\_

Address \_\_\_\_\_

If government land the permittee is \_\_\_\_\_

Address \_\_\_\_\_

The lessee is **Humble Oil & Refining Company**

Address **Box 1600, Midland, Texas**

We propose to drill well with drilling equipment as follows: \_\_\_\_\_

**Rotary Rig**

The status of a bond for this well in conformance with Rule 39 of the General Rules and Regulations of the Commission is as follows: **Now on file in Commission office**

We propose to use the following strings of casing and to land or cement them as indicated:

Size of Hole	Size of Casing	Weight Per Foot	New or Second Hand	Depth	Landed or Cemented	Sacks Cement
17-1/4"	10-3/4"	40.5#	New	300'	Cemented	300 sx.
9-7/8"	7-5/8"	26.40#	"	2800'	"	2000 sx.
6-3/4"	5-1/2"	15.50#	"	6600'	"	500 sx.

If changes in the above plan become advisable we will notify you before cementing or landing casing. We estimate that the first productive oil or gas sand should occur at a depth of about **6600** feet.

Additional information:

Approved \_\_\_\_\_, 19\_\_\_\_  
except as follows:

Sincerely yours,

**Humble Oil & Refining Company**

Company or Operator

By

Position **Division Chief Clerk**

Send communications regarding well to

Name **J. W. House**Address **Box 1600, Midland, Texas**

OIL CONSERVATION COMMISSION

By

Title

**Roy Yarbrough**  
**Inspector**

APR 7 - 1950

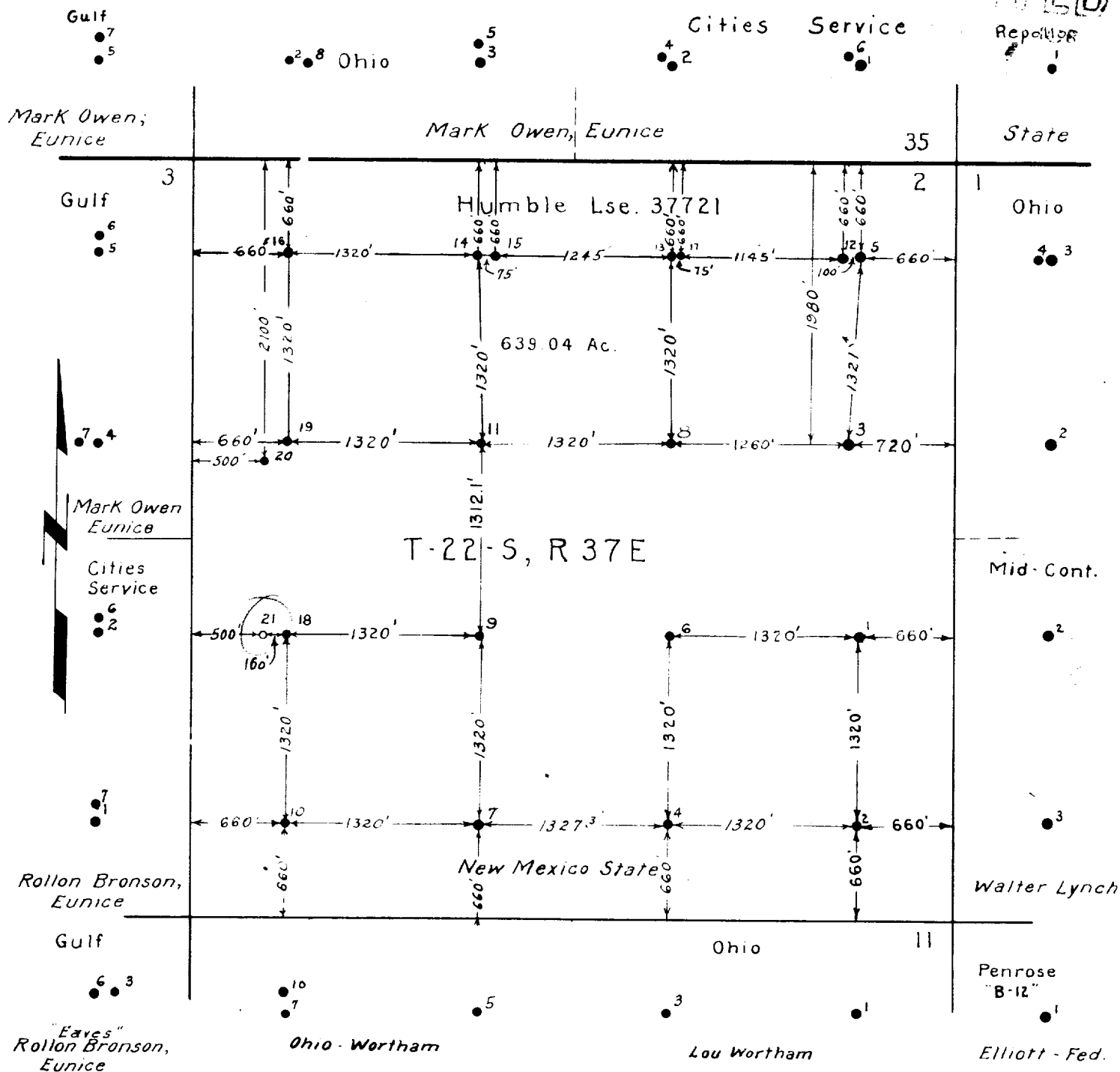

Note: The area shown hereon is a portion of Lease No. 37721 which covers 6023.83 acres, except Parker Drilling Co. owning rights to 4250' depth on SW/4 of SW/4 of Sec. 2, T22S, R37E, LeaCo., NM.

Humble New Mexico State "S" Lease No. 37721  
Sec. 2, T-22-S, R-37-E  
Lea Co., N.M.

HUMBLE OIL & REFINING COMPANY  
CIVIL ENGINEERING DEPARTMENT  
MIDLAND, TEXAS

DRAWN C. Watson  
CHECKED [Signature]  
APPR. [Signature]

SCALE 1" = 1000'  
DATE 10-8-45  
REVISED DL.M. 4-51

FILE NO.  
**WT-A-417**