

NEW MEXICO OIL CONSERVATION COMMISSION

Santa Fe, New Mexico

NOTICE OF INTENTION TO DRILL

Notice must be given to the Oil Conservation Commission or its proper agent and approval obtained before drilling begins. If changes in the proposed plan are considered advisable, a copy of this notice showing such changes will be returned to the sender. Submit this notice in triplicate. One copy will be returned following approval. See additional instructions in Rules and Regulations of the Commission.

Midland, Texas

May 8, 1950

Place

Date

OIL CONSERVATION COMMISSION,
Santa Fe, New Mexico,

Gentlemen:

You are hereby notified that it is our intention to commence the drilling of a well to be known as Lee #37721

Humble Oil & Refining Company, New Mexico State "S" Well No. 22 in SW/4 of SW/4
Company or Operator Lease

of Sec. 2, T. 22-S, R. R-37-N. M. P. M., Drinkard Field, Lee County.

N

The well is 800 feet (N.) (S.) of the South line and 660 feet
(E.) (W.) of the West line of SW/4 of SW/4 of Section 2

(Give location from section or other legal subdivision lines. Cross out wrong directions.)

If state land the oil and gas lease is No. _____ Assignment No. _____

If patented land the owner is _____

Address _____

If government land the permittee is _____

Address _____

The lessee is Humble Oil & Refining Company

Address Box 1600, Midland, Texas

We propose to drill well with drilling equipment as follows: _____

Rotary Rig

The status of a bond for this well in conformance with Rule 39 of the General Rules and Regulations of the Commission is as follows: Now on file in Commission office

We propose to use the following strings of casing and to land or cement them as indicated:

Size of Hole	Size of Casing	Weight Per Foot	New or Second Hand	Depth	Landed or Cemented	Sacks Cement
17-1/4"	10-3/4"	40.5#	New	300'	Cemented	300 sx.
9-7/8"	7-5/8"	26.40#	"	2800'	"	2000 sx.
6-3/4"	5-1/2"	15.50#	"	6600'	"	500 sx.

If changes in the above plan become advisable we will notify you before cementing or landing casing. We estimate that the first productive oil or gas sand should occur at a depth of about 6600 feet.

Additional information:

Approved MAY 9 1950, 19____
except as follows:

Sincerely yours,

Humble Oil & Refining Company
Company or Operator

By [Signature]

Position Division Superintendent

Send communications regarding well to

Name J. W. House

Address Box 1600, Midland, Texas

OIL CONSERVATION COMMISSION,

By [Signature]

Title Oil & Gas Inspector

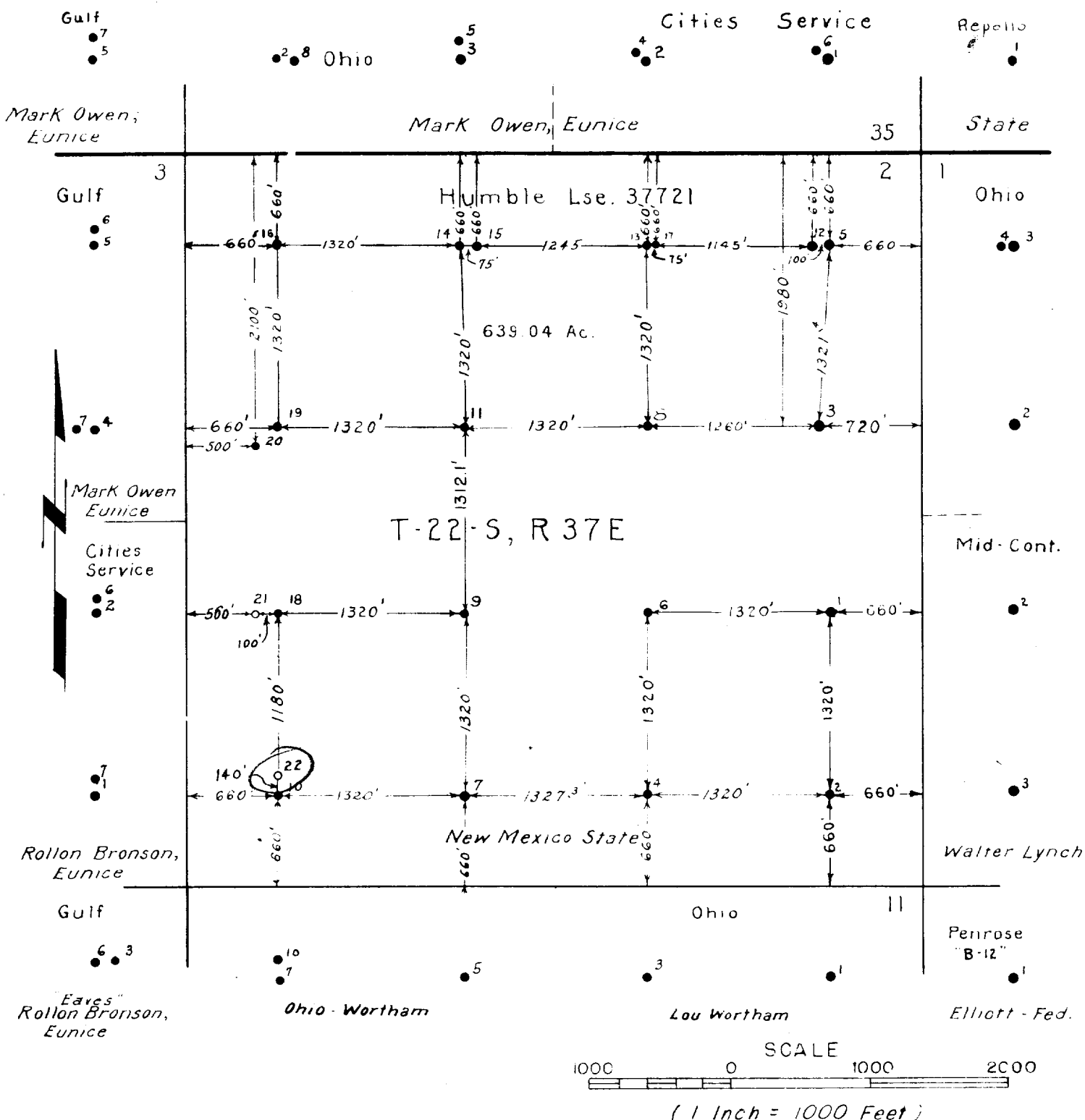

Note: The area shown hereon is a portion of Lease No 37721 which covers 6023.83 acres, except Parker Drilling Co. owning rights to 4250' depth on SW/4 of SW/4 of Sec. 2, T22S, R37E, Lea Co., NM

Humble New Mexico State "S" Lease No. 37721 Sec. 2, T-22-S, R-37-E Lea Co., N. M.		
HUMBLE OIL & REFINING COMPANY CIVIL ENGINEERING DEPARTMENT MIDLAND, TEXAS		
DRAWN <u>C. Watson</u> CHECKED <u> </u> APPR. <u> </u>	SCALE <u>1" = 1000'</u> DATE <u>10-8-45</u> REVISED <u>4</u>	FILE NO. WT-A-417