

WELL LOCATION AND ACREAGE DEDICATION PLAT

Supersedes C-129
Effective 10/1/75

All distances must be from the outer boundaries of the Section.

Operator John H. Hendrix			Lease Brunson C			Well No. #5		
Unit Letter 0	Section 3	Township 22-S	Range 37-E	County Lea				
Actual Well Location of Well:								
554		feet from the South		2086		feet from the East		Line
Ground Level Elev. 3400'		Producing Formation Blinebry		Fluid Blinebry (Gas)			Dedicated Acreage 160 Acres	

1. Outline the acreage dedicated to the subject well by colored pencil or hatchure marks on the plat below.
2. If more than one lease is dedicated to the well, outline each and identify the ownership thereof (both as to working interest and royalty).
3. If more than one lease of different ownership is dedicated to the well, have the interests of all owners been consolidated by communitization, unitization, force-pooling, etc?

☐ Yes ☐ No If answer is "yes," type of consolidation _____

If answer is "no," list the owners and tract descriptions which have actually been consolidated. (Use reverse side of this form if necessary.) _____

No allowable will be assigned to the well until all interests have been consolidated (by communitization, unitization, forced-pooling, or otherwise) or until a non-standard unit, eliminating such interests, has been approved by the Commission.

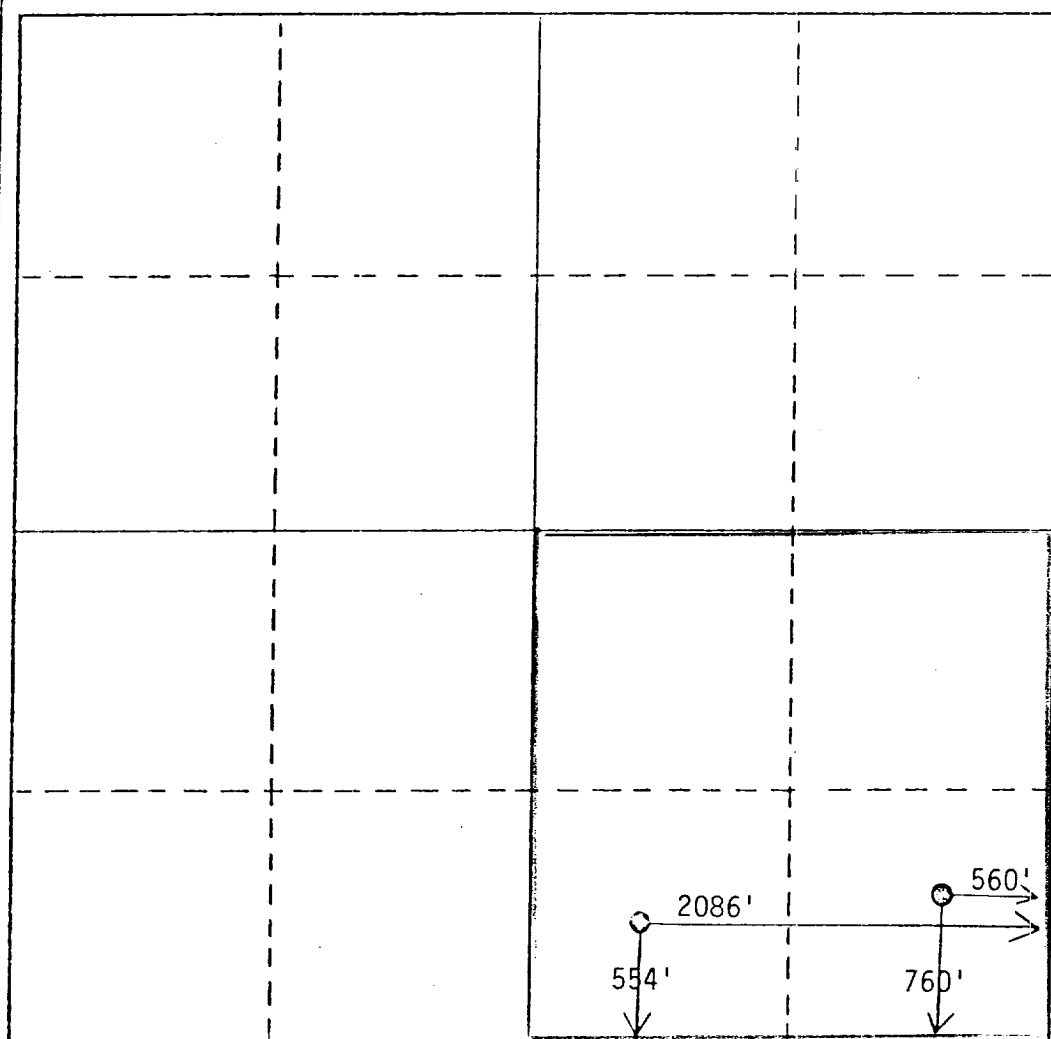

CERTIFICATION

I hereby certify that the information contained herein is true and complete to the best of my knowledge and belief.

Name: John H. Hendrix

Position: Production Clerk

Company: John H. Hendrix

Date: October 19, 1976

I hereby certify that the well location shown on this plat was plotted from field notes of actual surveys made by me or under my supervision, and that the same is true and correct to the best of my knowledge and belief.

Date Surveyed _____

Registered Professional Engineer and/or Land Surveyor

Certificate No. _____

0 550 600 650 700 750 800 850 900 950 1000 1050 1100 1150 1200 1250 1300 1350 1400 1450 1500 1550 1600 1650 1700 1750 1800 1850 1900 1950 2000