

NEW MEXICO OIL CONSERVATION COMMISSION

Well Location and Acreage Dedication Plat
HOBBS OFFICE OCC

Section A.

Date January 23, 1959

Operator Skelly Oil Company Lease 1959 JAN 23 PM 2:18
Well No. 4 Unit Letter L Section 4 Township 22 South Range 37 East NMPM
Located 2130 Feet From SOUTH Line, 810 Feet From WEST Line
County LEA G. L. Elevation 3456' D.F. Dedicated Acreage 40 Acres
Name of Producing Formation Joins (SIMPSON) Pool NARE

1. Is the Operator the only owner* in the dedicated acreage outlined on the plat below?
Yes X No .
2. If the answer to question one is "no," have the interests of all the owners been consolidated by communitization agreement or otherwise? Yes No . If answer is "yes," Type of Consolidation
3. If the answer to question two is "no," list all the owners and their respective interests below:

Owner

Land Description

Section B

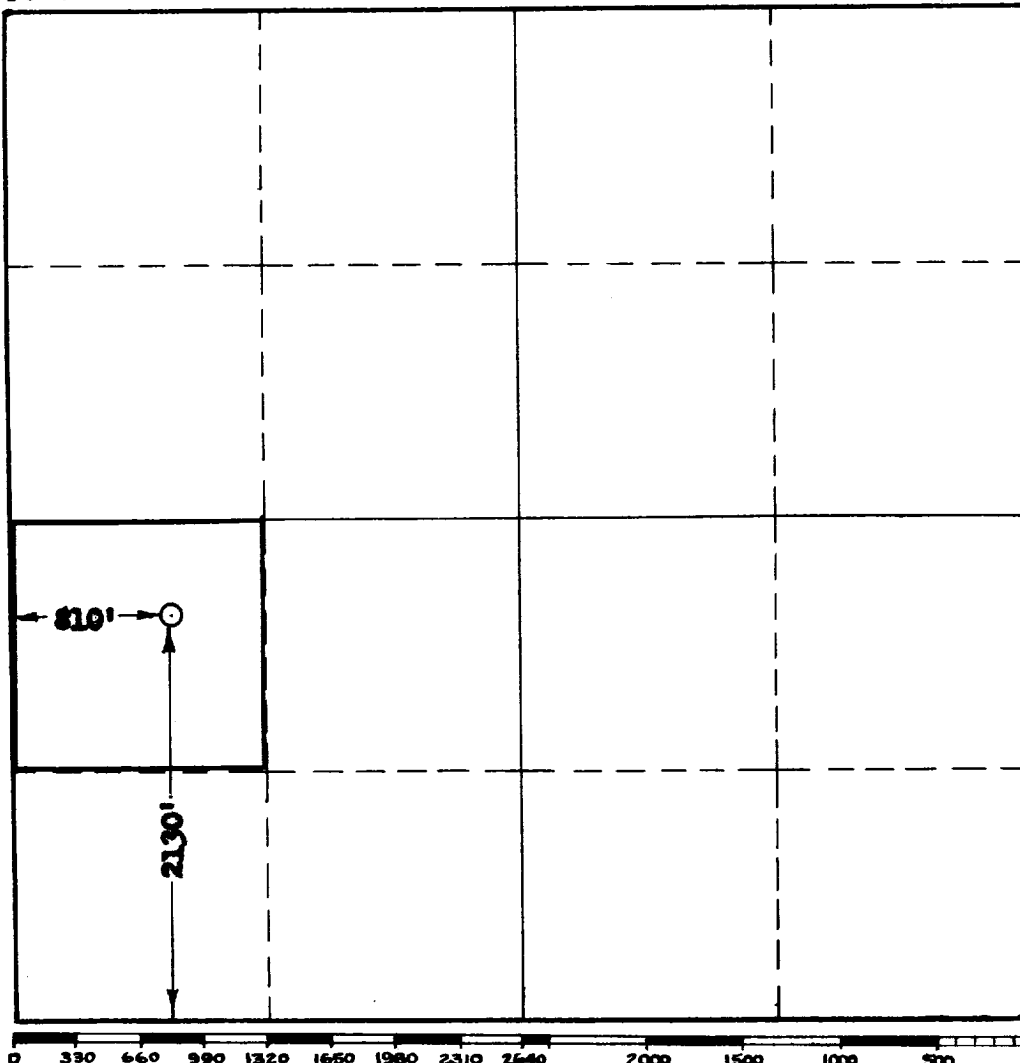

This is to certify that the information in Section A above is true and complete to the best of my knowledge and belief.

Skelly Oil Company
(Operator)

J. J. Amerson
(Representative)

Box 38 - Hobbs, New Mexico
Address

This is to certify that the well location shown on the plat in Section B was plotted from field notes of actual surveys made by me or under my supervision and that the same is true and correct to the best of my knowledge and belief.

Date Surveyed 12-26-1946

Robert S. Blynn
Registered Professional
Engineer and/or Land Surveyor.

Certificate No.

(See instructions for completing this form on the reverse side)

INSTRUCTIONS FOR COMPLETION:

1. Operator shall furnish and certify to the information called for in Section A.
2. Operator shall outline the dedicated acreage for both oil and gas wells on the plat in Section B.
3. A registered professional engineer or land surveyor registered in the State of New Mexico or approved by the Commission shall show on the plat the location of the well and certify this information in the space provided.
4. All distances shown on the plat must be from the outer boundaries of Section.
5. If additional space is needed for listing owners and their respective interests as required in question 3, Section A, please use space below

* "Owner" means the person who has the right to drill into and to produce from any pool and to appropriate the production either for himself or for himself and another. (65-3-29 (e) NMSA 1953 Comp.)