

Submit to Appropriate

District Office

State Lease-6 copies

Fee Lease-5 copies

State of New Mexico  
Energy, Minerals and Natural Resources Department

Form C-101

Revised 1-1-89

## OIL CONSERVATION DIVISION

P.O. Box 2088

Santa Fe, New Mexico 87504-2088

## DISTRICT I

P.O. Box 1880, Hobbs, NM 88240

## DISTRICT II

P.O. Drawer Dd, Artesia, NM 88210

## DISTRICT III

1000 Rio Brazos Rd., Aztec, Nm 87410

API NO. (assigned by OCD on New Wells)

30-025-10092

5. Indicate Type of Lease

STATE

☐ FEE☒ X

6. State Oil &amp; Gas Lease No.

N/A

7. Lease Name or Unit Agreement Name

ARROWHEAD GRAYBURG UNIT

8. Well No.

198

9. Pool name or Wildcat

ARROWHEAD GRAYBURG

## APPLICATION FOR PERMIT TO DRILL, DEEPEN, OF PLUG BACK

1a. Type of Work:

DRILL ☐RE-ENTER ☐DEEPEN ☒PLUG BACK ☐

b. Type of Well:

OIL

GAS

OTHER

SINGLE

MULTIPLE

WELL ☐WELL ☐

INJECTOR

ZONE ☐ZONE ☐

2. Name of Operator

CHEVRON U.S.A. INC.

3. Address of Operator

P.O. BOX 1150, MIDLAND, TX 79702 ATTN: P.R. MATTHEWS

4. Well Location

Unit Letter E : 2310 Feet From The NORTH Line and 330 Feet From The WEST Line  
 Section 7 Township 22S Range 37E NMPM LEA County

10. Proposed depth

4500

11. Formation

GRAYBURG

12. Rotary or C.T.

ROTARY

13. Elevation (Show DF, RT, GR, etc.)

3455 DF

14. Kind &amp; Status Plug Bond

N/A

15. Dril Contractor

UNKNOWN

16. Date Work will start

ASAP

## 17 PROPOSED CASING AND CEMENT PROGRAM

SIZE OF HOLE	SIZE OF CASING	WEIGHT PER FOOT	SETTING DEPTH	SACKS OF CEMENT	EST. TOP
UNK.	9 5/8"	25.7	290	200	SURFACE
UNK.	5 1/2"	14	3670	350	SURFACE

DEEPEN WELL TO 4500' WITH 4 3/4" BIT UNDER-REAM TO 6 1/2" HOLE.

LOG AND PERF &amp; ACIDIZE.

2000 PSI BOPE.

MIST AND BRINE MUD SYSTEM.

WELL NAME CHANGE FROM CHEVRON H.T. MATTERN D#2..

CONVERT TO INJECTION.

IN ABOVE SPACE DESCRIBE PROPOSED PROG IF PROPOSAL IS TO DEEPEN OR PLUG BACK, GIVE DATA ON PRESENT PRODUCTIVE ZONE AND PROPOSED  
 NEW PRODUCTIVE ZONE. GIVE BLOWOUT PREVENTER PROGRAM, IF ANY.

I hereby certify that the information above is true and complete to the best of my knowledge and belief.

SIGNATURE P. R. Matthews TITLE TECHNICAL ASSISTANTDATE '03-12-92TYPE OR PRINT NAME P.R. MATTHEWSTELEPHONE NO. (915)687-7812

ORIGINAL SIGNED BY JERRY DEXTON

DISTRICT I SUPERVISOR

APPROVED BY

DATE

MAR 16 '92

CONDITIONS OF APPROVAL, IF ANY:

R-9483 Sng

RECEIVED

MAR 18 1992

DD FORM 100-10

Submit to Appropriate  
District Office  
State Lease - 4 copies  
Fee Lease - 3 copies

State of New Mexico  
Energy, Minerals and Natural Resources Department

Form C-102  
Revised 1-1-89

OIL CONSERVATION DIVISION

P.O. Box 2088  
Santa Fe, New Mexico 87504-2088

DISTRICT I  
P.O. Box 1980, Hobbs, NM 88240

DISTRICT II  
P.O. Drawer DD, Artesia, NM 88210

DISTRICT III  
1000 Rio Brazos Rd., Aztec, NM 87410

WELL LOCATION AND ACREAGE DEDICATION PLAT

All Distances must be from the outer boundaries of the section

Operator CHEVRON U.S.A. INC.		Lease ARROWHEAD GRAYBURG UNIT		Well No. 198
Unit Letter E	Section 7	Township 22S	Range 37E	County LEA
Actual Footage Location of Well: 2310 feet from the NORTH line and 330 feet from the WEST line				
Ground level Elev. 3455 DF	Producing Formation GRAYBURG	Pool ARROWHEAD GRAYBURG	Dedicated Acreage: 40 Acres	

1. Outline the acreage dedicated to the subject well by colored pencil or hatchure marks on the plat below.
2. If more than one lease is dedicated to the well, outline each and identify the ownership thereof (both as to working interest and royalty).
3. If more than one lease of different ownership is dedicated to the well, have the interest of all owners been consolidated by communitization, unitization, force-pooling, etc?  
☐ Yes ☐ No If answer is "yes" type of consolidation \_\_\_\_\_  
If answer is "no" list the owners and tract descriptions which have actually been consolidated. (Use reverse side of this form if necessary.)  
No allowable will be assigned to the well until all interests have been consolidated (by communitization, unitization, forced-pooling, or otherwise) or until a non-standard unit, eliminating such interest, has been approved by the Division.

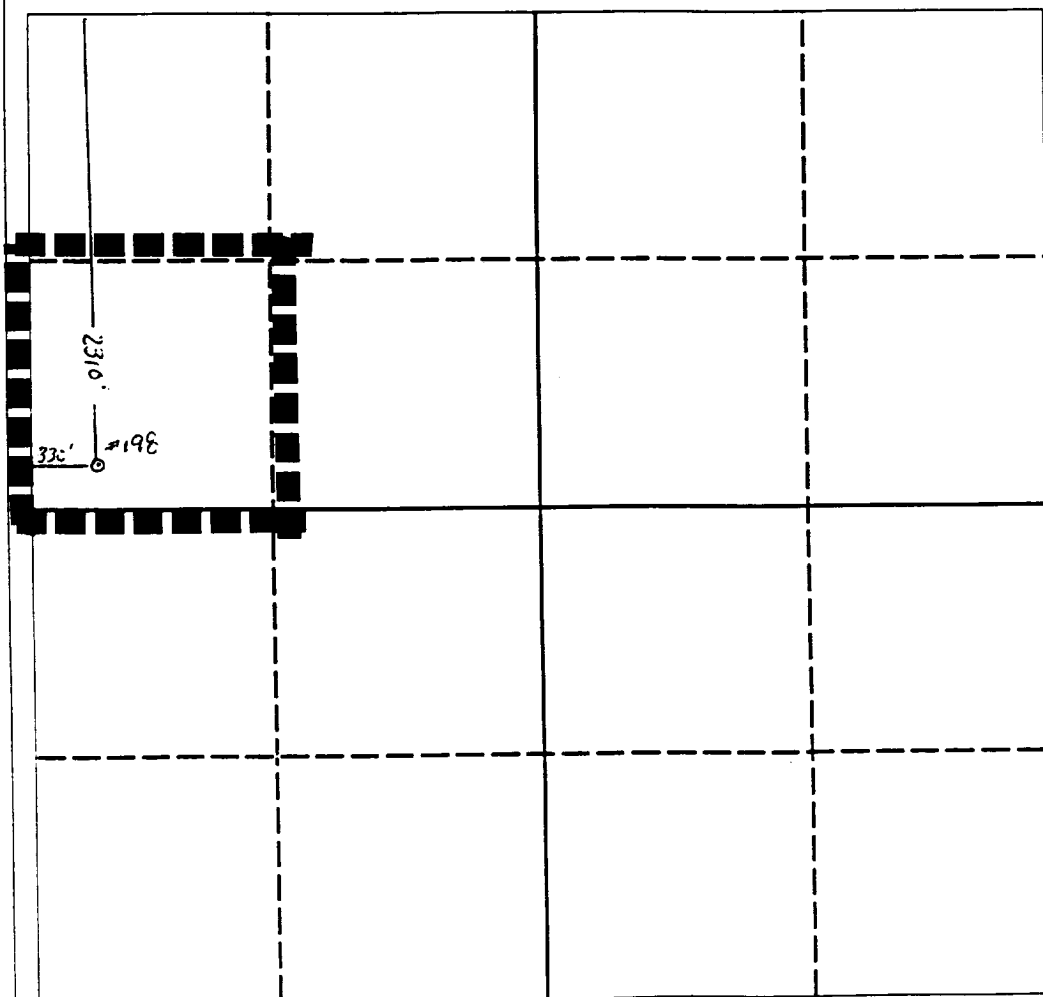

OPERATOR CERTIFICATION

I hereby certify that the information contained herein is true and complete to the best of my knowledge and belief.

Signature  
*P. R. Matthews*  
Printed Name  
P. R. MATTHEWS  
Position  
TECHNICAL ASSISTANT  
Company  
CHEVRON U.S.A. INC  
Date  
3-12-92

SURVEYOR CERTIFICATION

I hereby certify that the well location shown on this plat was plotted from field notes of actual surveys made by me or under my supervision, and that the same is true and correct to the best of my knowledge and belief.

Date Surveyed  
Signature & Seal of Professional Surveyor  
Certificate No.

0 330 660 990 1320 1650 1980 2310 2640 2000 1500 1000 500 0