

DEPARTMENT OF THE INTERIOR
GEOLOGICAL SURVEY

SUNDRY NOTICES AND REPORTS ON WELLS

NOTICE OF INTENTION TO DRILL.....	<input checked="" type="checkbox"/>	SUBSEQUENT REPORT OF WATER SHUT-OFF.....	
NOTICE OF INTENTION TO CHANGE PLANS.....		SUBSEQUENT REPORT OF SHOOTING OR ACIDIZING.....	
NOTICE OF INTENTION TO TEST WATER SHUT-OFF.....		SUBSEQUENT REPORT OF ALTERING CASING.....	
NOTICE OF INTENTION TO RE-DRILL OR REPAIR WELL.....		SUBSEQUENT REPORT OF REDRILLING OR REPAIR.....	
NOTICE OF INTENTION TO SHOOT OR ACIDIZE.....		SUBSEQUENT REPORT OF ABANDONMENT.....	
NOTICE OF INTENTION TO PULL OR ALTER CASING.....		SUPPLEMENTARY WELL HISTORY.....	
NOTICE OF INTENTION TO ABANDON WELL.....			

(INDICATE ABOVE BY CHECK MARK NATURE OF REPORT, NOTICE, OR OTHER DATA)

Elliott

August 28, 1946

Well No. B-9 #5 is located 660 ft. from ^N~~W~~ line and 2130 ft. from ^W~~N~~ line of sec. 9

NW¹ sect. 9
(14 Sec. and 8th No.)

22S
(Twp)

37E
(Range)

N. M. P. M.
(Meridian)

Brunson Drinkard
(Field)

Lea

(County or Subdivision)

New Mexico
(State or Territory)

The elevation of the derrick floor above sea level is _____ ft.

DETAILS OF WORK

(State names of and expected depths to objective sands; show sizes, weights, and lengths of proposed casings; indicate mudding jobs, cementing points, and all other important proposed work)

We plan to drill this test to a depth of approximately 6550' with rotary tools throughout.

We will set 150' of 13-3/8" surface casing and cement same to surface. We will set approximately 2800' of 32# 8-5/8" casing and cement with 1000 sacks. We will set and cement 5 1/2" casing on bottom with 450 sacks.

We plan to perforate casing opposite the pay section and produce well through perforations.

I understand that this plan of work must receive approval in writing by the Geological Survey before operations may be commenced.

Company *N. G. Penrose, Inc.*

Address *1814 Fair Building*

Ft. Worth, Texas.

By *Charles P. Miller*

Title *Agent*

ILLEGIBLE

Scale 1"=60'

NW Corner
Sec. 9-22S-37E

NE 1/4 Corner
Sec. 9-22S-37E

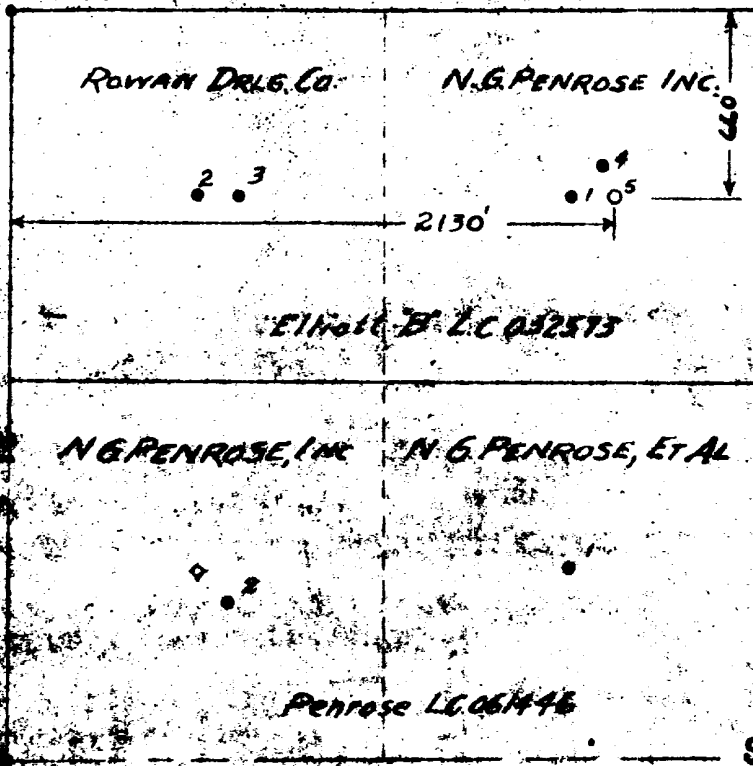

NW Corner
Sec. 9-22S-37E

I, Charles R. Miller, a licensed surveyor of the State of Texas, hereby certify that I have surveyed on the ground the location shown on this plat as N. G. Penrose, Inc. Elliott "B" #5, located within the N. 1/4, Section 9, T. 22 S., R. 37 E., and that same is located as shown.

In witness whereof I hereunto affix my hand and seal.

August 28, 1946.

Charles R. Miller

Charles R. Miller