

## APPLICATION FOR DUAL COMPLETION

Field Name		County <b>Lea</b>		Date <b>March 2, 1961</b>
Operator <b>Gulf Oil Corporation</b>		Lease <b>Nelson Brunson</b>		Well No. <b>4</b>
Location of Well	Unit <b>0</b>	Section <b>10</b>	Township <b>22-S</b>	Range <b>37-E</b>

1. Has the New Mexico Oil Conservation Commission heretofore authorized the dual completion of a well in these same pools or in the same zones within one mile of the subject well? YES ☒ NO ☐
2. If answer is yes, identify one such instance: Order No. **DC-1009**; Operator, Lease, and Well No.:

**Gulf Oil Corporation, Drinkard (NCT-B) No. 2**

3. The following facts are submitted:	Upper Zone	Lower Zone
a. Name of reservoir	<b>Elinchry</b>	<b>Drinkard</b>
b. Top and Bottom of Pay Section (Perforations)	<b>5650-5830'</b>	<b>6440-6516'</b>
c. Type of production (Oil or Gas)	<b>Oil</b>	<b>Oil</b>
d. Method of Production (Flowing or Artificial Lift)	<b>Flowing</b>	<b>Flowing</b>

4. The following are attached. (Please mark YES or NO)

- Yes** a. Diagrammatic Sketch of the Dual Completion, showing all casing strings, including size and setting, top of cement, perforated intervals, tubing strings, including diameters and setting depth, location and type of packers and side door chokes, and such other information as may be pertinent.
- Yes** b. Plat showing the location of all wells on applicant's lease, all offset wells on offset leases, and the names and addresses of operators of all leases offsetting applicant's lease.
- Yes** c. Waivers consenting to such dual completion from each offset operator, or in lieu thereof, evidence that said offset operators have been furnished copies of the application.\*
- No** d. Electrical log of the well or other acceptable log with tops and bottoms of producing zones and intervals of perforation indicated thereon. (If such log is not available at the time application is filed, it shall be submitted as provided by Rule 112-A.)

5. List all offset operators to the lease on which this well is located together with their correct mailing address.

**Mobile Oil Co., Box 2406, Hobbs, New Mexico**

**Skelly Oil Co., Box 38, Hobbs, New Mexico**

**Amerada Petroleum Corp. Drawer D, Monument, New Mexico**

**Cities Service Oil Co. Box 97, Hobbs, New Mexico**

**Sinclair Oil & Gas Co. Craig Electric Co. Bldg., Hobbs, New Mexico**

6. Were all operators listed in Item 5 above notified and furnished a copy of this application? YES ☒ NO ☐ . If answer is yes, give date of such notification **March 2, 1961** .

CERTIFICATE: I, the undersigned, state that I am the **Area Production Manager** of the **Gulf Oil Corporation** (company), and that I am authorized by said company to make this report; and that this report was prepared under my supervision and direction and that the facts stated therein are true, correct and complete to the best of my knowledge.

ORIGINAL SIGNED  
-BY-  
**J. M. RUSSELL**  
Signature

\* Should waivers from all offset operators not accompany an application for administrative approval, the New Mexico Oil Conservation Commission will hold the application for a period of twenty (20) days from date of receipt by the Commission's Santa Fe office. If, after said twenty-day period, no protest nor request for hearing is received by the Santa Fe office, the application will then be processed.

NOTE: If the proposed dual completion will result in an unorthodox well location and/or a non-standard proration unit in either or both of the producing zones, then separate application for approval of the same should be filed simultaneously with this application.

SCHEMATIC DIAGRAM OF PROPOSED DUAL COMPLETION  
ROLLON BRUNSON NO. 4  
DRINKARD OIL - BLINEBRY OIL

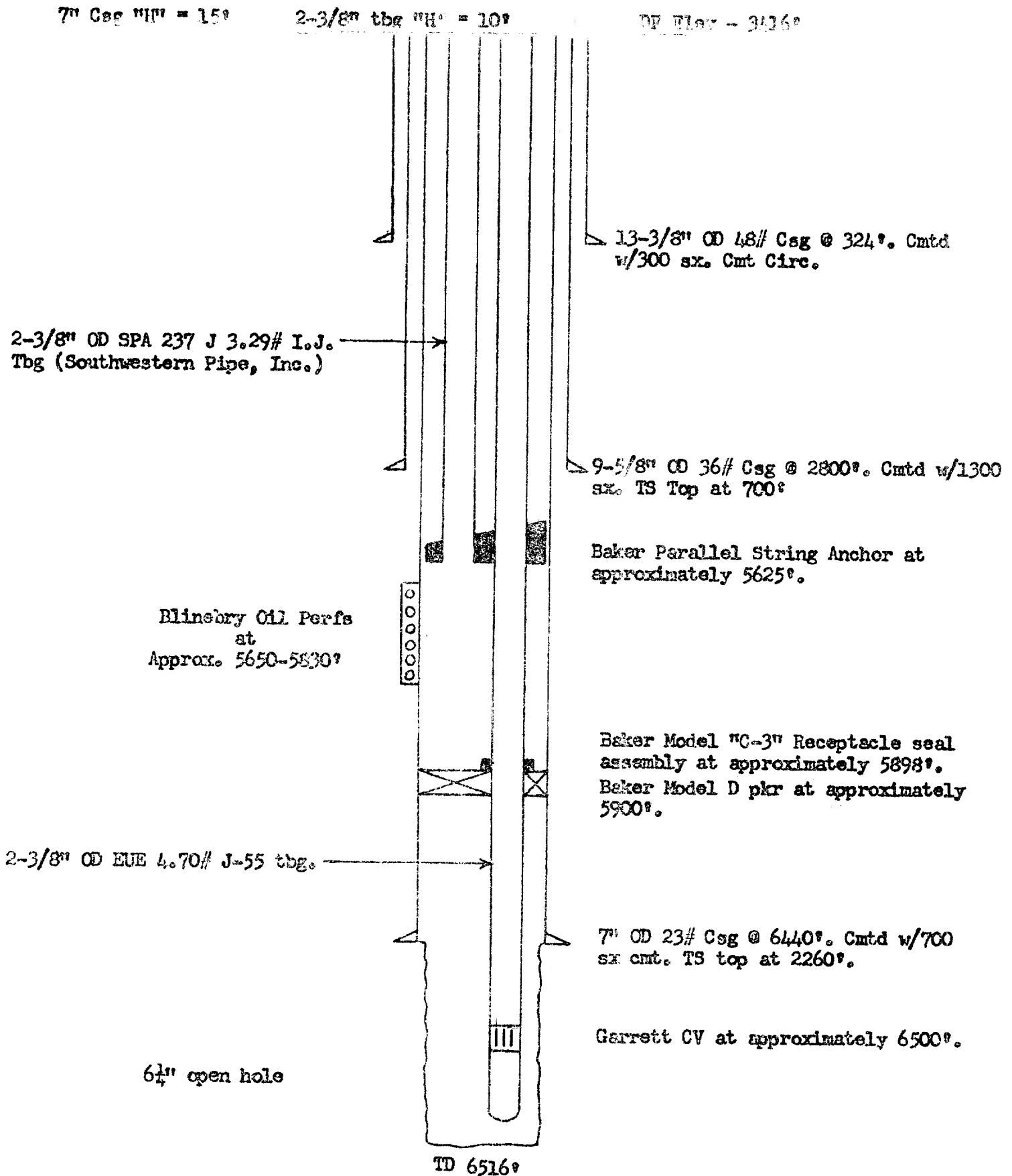

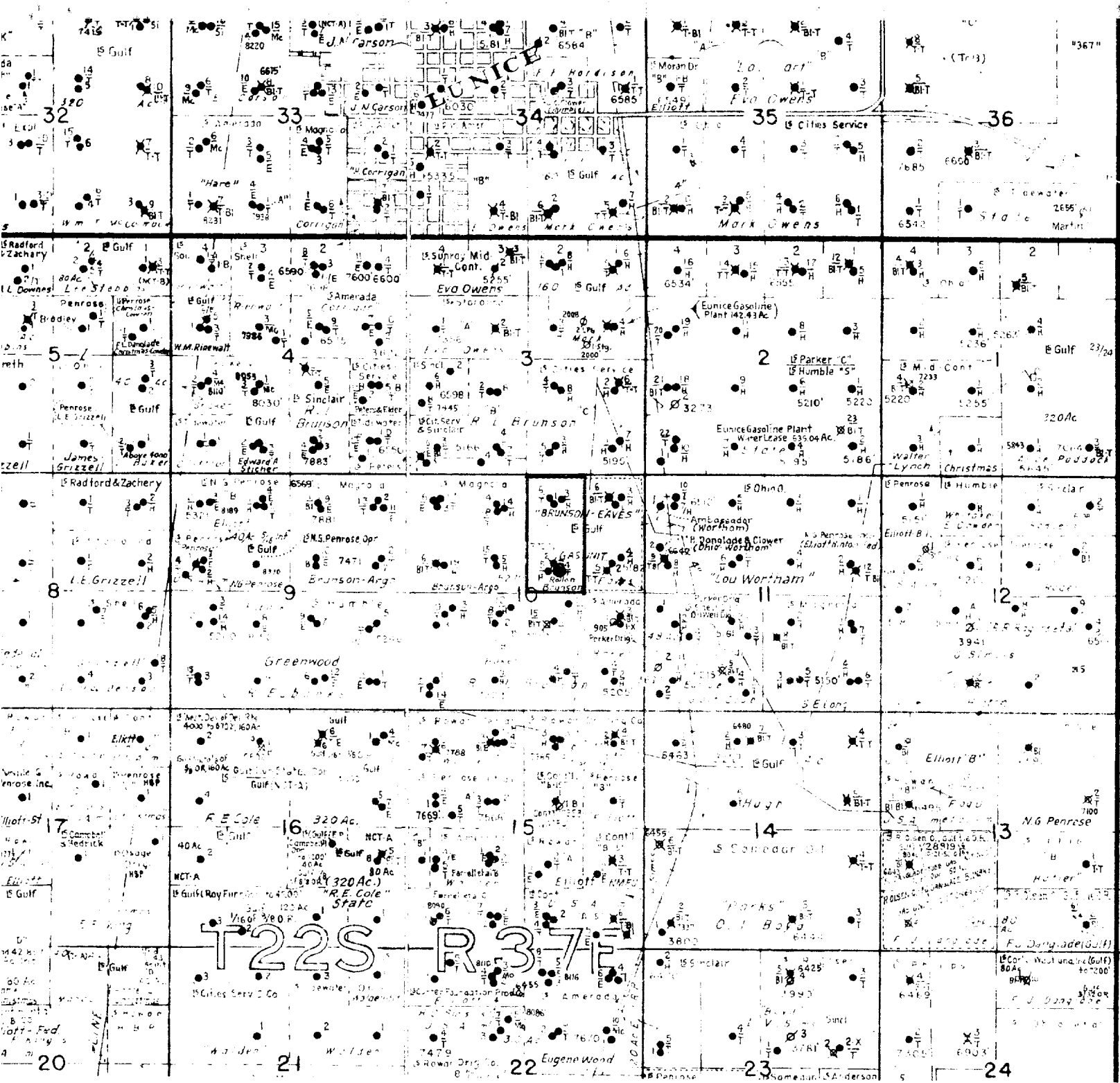

# LEASE PLAT

R. BRUNSON  
DRINKARD & BLINNERY OIL POOLS  
Lea County, New Mexico

## - LEGEND -

- Pertinent Gulf Lease
- Pertinent Gulf Well

Gulf Oil Corporation