

NO. OF COPIES RECEIVED		
DISTRIBUTION		
SANTA FE		
FILE		
U.S.G.S.		
LAND OFFICE		
OPERATOR		

NEW MEXICO OIL CONSERVATION COMMISSION

Form C-101
Revised 1-1-65

5A. Indicate Type of Lease	
STATE <input type="checkbox"/>	FED <input checked="" type="checkbox"/>

5. State Oil & Gas Lease No.

APPLICATION FOR PERMIT TO DRILL, DEEPEN, OR PLUG BACK

1a. Type of Work		7. Unit Agreement Name	
b. Type of Well OIL WELL <input type="checkbox"/> GAS WELL <input checked="" type="checkbox"/> OTHER <input type="checkbox"/>		8. Farm or Lease Name Brunson-Argo	
2. Name of Operator Mobil Oil Corporation		9. Well No. 6	
3. Address of Operator P. O. Box 633, Midland, Texas 79701		10. Field and Pool, or Wildcat Drinkard	
4. Location of Well UNIT LETTER <u>E</u> LOCATED <u>660'</u> FEET FROM THE <u>West</u> LINE AND <u>1980'</u> FEET FROM THE <u>North</u> LINE OF SEC. <u>10</u> TWP. <u>22-S</u> RGE. <u>37-E</u> NMPM		12. County Lea	
19. Proposed Depth 6562'		19A. Formation Drinkard	
20. Rotary or C.T. Rotary		21. Elevations (Show whether Dr. RT, etc.) 3420' - Ground	
21A. Kind & Status Plug. Bond On File		21B. Drilling Contractor Unknown	
22. Approx. Date Work will start July 24, 1973			

PROPOSED CASING AND CEMENT PROGRAM

SIZE OF HOLE	SIZE OF CASING	WEIGHT PER FOOT	SETTING DEPTH	SACKS OF CEMENT	EST. TOP

This well is presently dually completed in the Tubb and Blinbry formations. The Blinbry produces 1 BOPD and the Tubb is shut in. Permission is requested to plug and abandon the Tubb, stimulate the Blinbry, deepen to 6562 ft, perforate the Drinkard and complete as a dual gas well.

APPROVAL VALID
FOR 90 DAYS UNLESS
DRILLING COMMENCED,

EXPIRES 10-23-73

IN ABOVE SPACE DESCRIBE PROPOSED PROGRAM: IF PROPOSAL IS TO DEEPEN OR PLUG BACK, GIVE DATA ON PRESENT PRODUCTIVE ZONE AND PROPOSED NEW PRODUCTIVE ZONE. GIVE BLOWOUT PREVENTER PROGRAM, IF ANY.

I hereby certify that the information above is true and complete to the best of my knowledge and belief.

Signed A. D. Bond A. D. Bond Title Proration Staff Assistant Date July 20, 1973

(This space for State Use)

APPROVED BY [Signature] TITLE SUPERVISOR DATE

CONDITIONS OF APPROVAL, IF ANY:

NEW MEXICO OIL CONSERVATION COMMISSION
WELL LOCATION AND ACREAGE DEDICATION AT

Form C-100
Supersedes C-124
Effective 1-1-63

All distances must be from the outer boundaries of the Section.

Operator Mobil Oil Corporation			Location Brunson-Argo		Well No. 6
Unit Letter E	Section 10	Township 22-S	Range 37-E	County Lea	
Actual Footage Location of Well: 660 feet from the West line of 1980 feet from the North line					
Ground Level Elev. 3420'	Producing Formation Drinkard		Pool Drinkard	Dedicated Acreage: 40 Acres	

1. Outline the acreage dedicated to the subject well by colored pencil or hachure marks on the plat below.
2. If more than one lease is dedicated to the well, outline each and identify the ownership thereof (both as to working interest and royalty).
3. If more than one lease of different ownership is dedicated to the well, have the interests of all owners been consolidated by communitization, unitization, force-pooling, etc?

☐ Yes ☐ No If answer is "yes," type of consolidation _____

If answer is "no," list the owners and tract descriptions which have actually been consolidated. (Use reverse side of this form if necessary.) _____

No allowable will be assigned to the well until all interests have been consolidated (by communitization, unitization, forced-pooling, or otherwise) or until a non-standard unit, eliminating such interests, has been approved by the Commission.

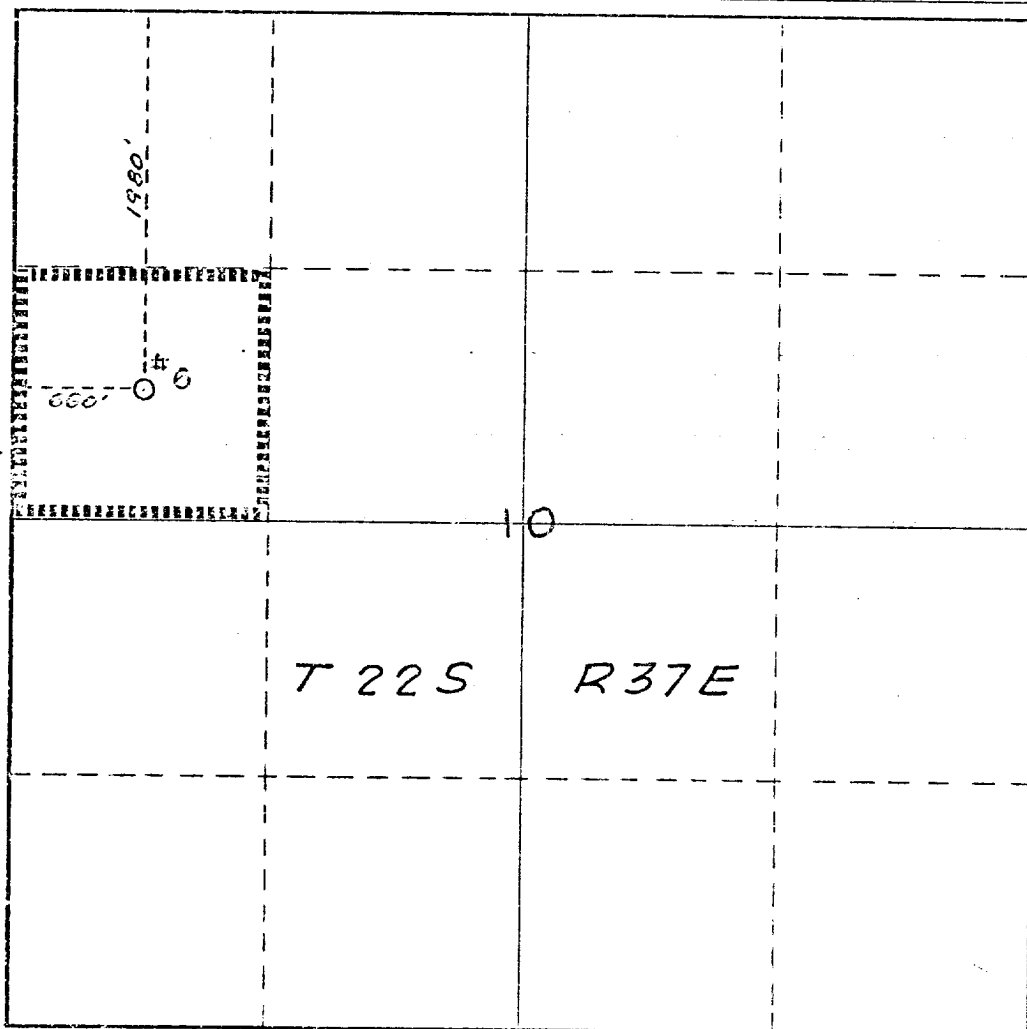

CERTIFICATION

I hereby certify that the information contained herein is true and complete to the best of my knowledge and belief.

A. D. Bond

Name
A. D. Bond
Position
Proration Staff Assistant
Company
Mobil Oil Corporation

Date
July 20, 1973

I hereby certify that the well location shown on this plat was plotted from field notes of actual surveys made by me or under my supervision, and that the same is true and correct to the best of my knowledge and belief.

Date Surveyed

Registered Professional Engineer and/or Land Surveyor

Certificate No.

