

NEW MEXICO
OIL CONSERVATION COMMISSION

Form C-128

Well Location and/or Gas Proration Plat

Date **August 3, 1956**

Operator **Shelly Oil Company**

Lease ~~Baker~~ ~~type~~

~~1968 AUG 15 PM 2:45~~

Well No. **2** Section **10** Township **22S** Range **37E** NMPM

Located 1980 Feet From South Line, 1980 Feet From West Line,

County, New Mexico. ~~SPK~~ Elevation 3404' BP

| | | | | | |
|-----------------------------|--------------|------|---------------|-------------------|------------|
| Name of Producing Formation | Queen | Pool | Tades. | Dedicated Acreage | 240 |
|-----------------------------|--------------|------|---------------|-------------------|------------|

(Note: All distances must be from outer boundaries of Section)

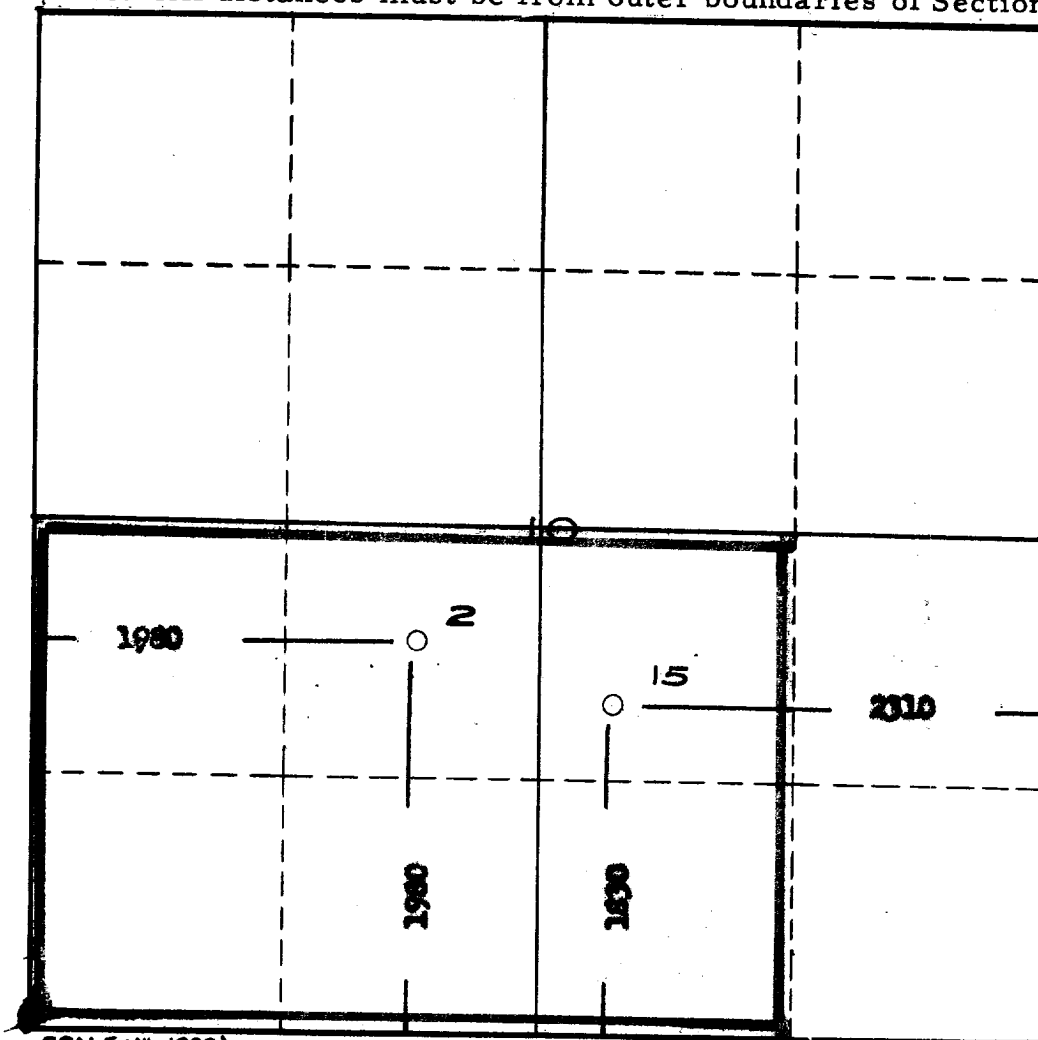

SCALE: 1" = 1000'

1. Is this Well a Dual Comp. ? Yes X No .
2. If the answer to Question 1 is yes, are there any other dually completed wells within the dedicated acreage? Yes X No .

Well #15 Kinestery & Tubo Dual Completions

This is to certify that the above plat was prepared from field notes of actual surveys made by me or under my supervision and that the same are true and correct to the best of my knowledge and belief.

Date Surveyed _____

Registered Professional Engineer and/or
Land Surveyor

Name J. J. Sullivan
Position Dist. Supt.
Representing Shelly Oil Co.
Address Box 38, Hobbs, N. M.