

Submit to Appropriate  
District Office  
State Lease - 6 copies  
Fee Lease - 5 copies

State of New Mexico  
Energy, Minerals and Natural Resources Department

Form C-101  
Revised 1-1-89

DISTRICT I  
P.O. Box 1980, Hobbs, NM 88240

DISTRICT II  
P.O. Drawer DD, Artesia, NM 88210

DISTRICT III  
1000 Rio Brazos Rd., Aztec, NM 87410

OIL CONSERVATION DIVISION  
P.O. Box 2088  
Santa Fe, New Mexico 87504-2088

API NO. (assigned by OCD on New Wells)
30 025 10192 ✓
5. Indicate Type of Lease STATE <input type="checkbox"/> FEE <input checked="" type="checkbox"/>
6. State Oil & Gas Lease No.

APPLICATION FOR PERMIT TO DRILL, DEEPEN, OR PLUG BACK

1a. Type of Work: DRILL <input type="checkbox"/> RE-ENTER <input type="checkbox"/> DEEPEN <input type="checkbox"/> PLUG BACK <input checked="" type="checkbox"/>		7. Lease Name or Unit Agreement Name  Baker B			
b. Type of Well: OIL WELL <input checked="" type="checkbox"/> GAS WELL <input type="checkbox"/> OTHER <input type="checkbox"/> SINGLE ZONE <input checked="" type="checkbox"/> MULTIPLE ZONE <input type="checkbox"/>		8. Well No. 12			
2. Name of Operator Texaco Exploration & Production Inc		9. Pool name or Wildcat Eunice San Andres, South			
3. Address of Operator Box 730 Hobbs, NM 88240					
4. Well Location Unit Letter <u>K</u> : <u>2310</u> Feet From The <u>S</u> Line and <u>2310</u> Feet From The <u>W</u> Line Section <u>10</u> Township <u>22S</u> Range <u>37E</u> NMPM <u>Lea</u> County					
10. Proposed Depth Current TD 5210'		11. Formation			
12. Rotary or C.T.					
13. Elevations (Show whether DF, RT, GR, etc.) 3393' GL		14. Kind & Status Plug. Bond			
15. Drilling Contractor		16. Approx. Date Work will start June 1993			
17. PROPOSED CASING AND CEMENT PROGRAM					
SIZE OF HOLE	SIZE OF CASING	WEIGHT PER FOOT	SETTING DEPTH	SACKS OF CEMENT	EST. TOP
17	13 3/8	44.5	156	150	Circ
12 1/4	9 5/8	36	2704	1000	715
8	7	23	5210	350	3150

Current Paddock completion 5038' - 5190'

- 1) Set CIBP @ 5040' & cap w/100' cement
- 2) Perf Eunice San Andres South zone 3855' - 3988'
- 3) Acidize perms w/10K gal 20% HCL
- 4) Place well on production

IN ABOVE SPACE DESCRIBE PROPOSED PROGRAM: IF PROPOSAL IS TO DEEPEN OR PLUG BACK, GIVE DATA ON PRESENT PRODUCTIVE ZONE AND PROPOSED NEW PRODUCTIVE ZONE. GIVE BLOWOUT PREVENTER PROGRAM, IF ANY.

I hereby certify that the information above is true and complete to the best of my knowledge and belief.

SIGNATURE L.W. Johnson TITLE Engr Asst DATE 06-10-93  
TYPE OR PRINT NAME L.W. Johnson TELEPHONE NO. 505-393-7191

(This space for State Use)

Orig. Signed by  
Paul Kautz  
Geologist

APPROVED BY \_\_\_\_\_ TITLE \_\_\_\_\_ DATE \_\_\_\_\_

CONDITIONS OF APPROVAL, IF ANY:

JUN 14 1993

Permit Expires 6 Months From Approval  
Date Unless ~~Setting~~ Underway.

Submit to Appropriate  
District Office  
State Lease - 4 copies  
Fee Lease - 3 copies

State of New Mexico  
Energy, Minerals and Natural Resources Department

Form C-102  
Revised 1-1-89

OIL CONSERVATION DIVISION

P.O. Box 2088  
Santa Fe, New Mexico 87504-2088

DISTRICT I  
P.O. Box 1980, Hobbs, NM 88240

DISTRICT II  
P.O. Drawer DD, Artesia, NM 88210

DISTRICT III  
1000 Rio Brazos Rd., Aztec, NM 87410

WELL LOCATION AND ACREAGE DEDICATION PLAT

All Distances must be from the outer boundaries of the section

Operator Texaco Exploration & Production Inc.			Lease Baker B		Well No. 12
Unit Letter K	Section 10	Township 22S	Range 37E	County NMPM	Lea
Actual Footage Location of Well: 2310 feet from the South line and 2310 feet from the West line					
Ground level Elev. 3393'	Producing Formation San Andres		Pool Eunice San Andres, South	Dedicated Acreage: 80 Acres	

- Outline the acreage dedicated to the subject well by colored pencil or hachure marks on the plat below.
- If more than one lease is dedicated to the well, outline each and identify the ownership thereof (both as to working interest and royalty).
- If more than one lease of different ownership is dedicated to the well, have the interest of all owners been consolidated by communitization, unitization, force-pooling, etc?  
☐ Yes ☐ No If answer is "yes" type of consolidation \_\_\_\_\_  
If answer is "no" list the owners and tract descriptions which have actually been consolidated. (Use reverse side of this form if necessary.)  
No allowable will be assigned to the well until all interests have been consolidated (by communitization, unitization, forced-pooling, or otherwise) or until a non-standard unit, eliminating such interest, has been approved by the Division.

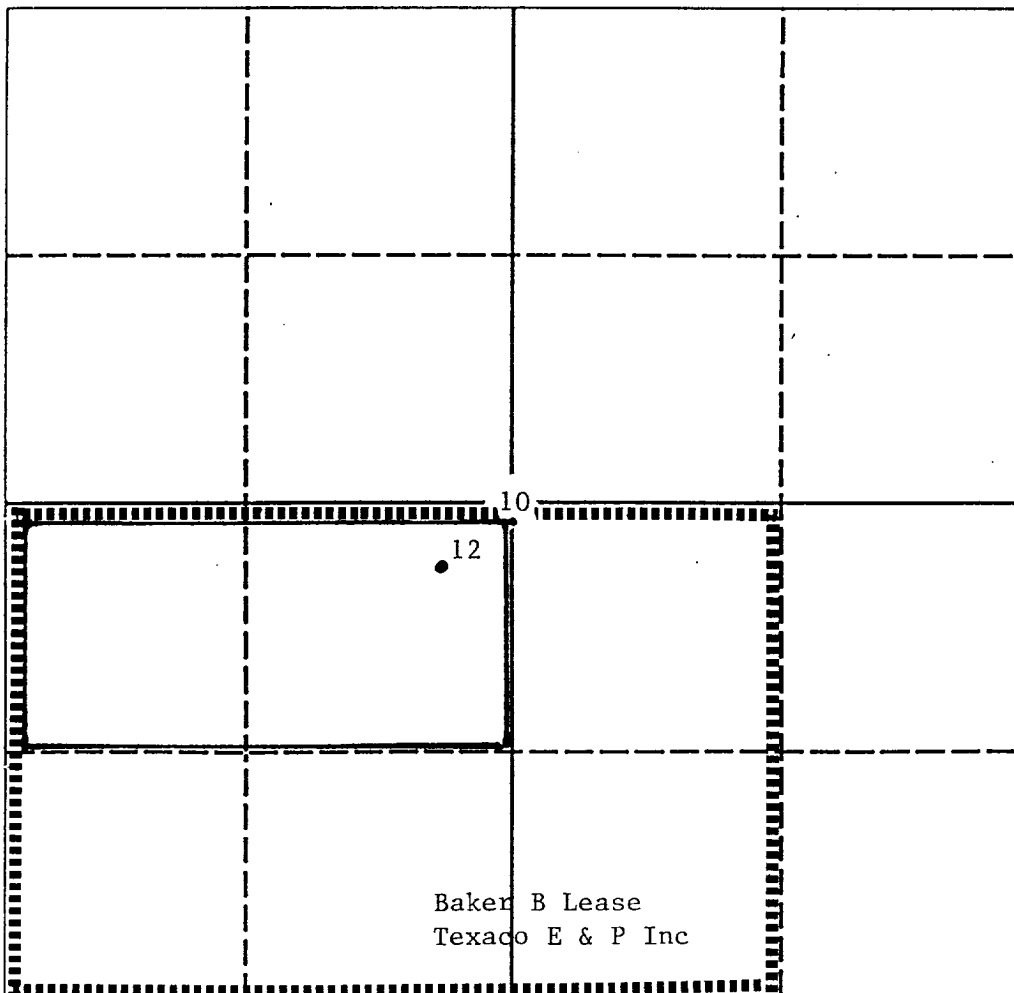

OPERATOR CERTIFICATION

I hereby certify that the information contained herein is true and complete to the best of my knowledge and belief.

Signature

*L.W. Johnson*

Printed Name

L.W. Johnson

Position

Engr. Asst.

Company

Texaco E & P Inc.

Date

06-09-93

SURVEYOR CERTIFICATION

I hereby certify that the well location shown on this plat was plotted from field notes of actual surveys made by me or under my supervision, and that the same is true and correct to the best of my knowledge and belief.

Date Surveyed

Signature & Seal of  
Professional Surveyor

Certificate No.

JUN 10 1993

OCD HOBBS OFFICE