

NO. OF COPIES RECEIVED	
DISTRIBUTION	
SANTA FE	
FILE	
U.S.G.S.	
LAND OFFICE	
OPERATOR	

# NEW MEXICO OIL CONSERVATION COMMISSION

Form C-101  
Revised 1-1-65

5A. Indicate Type of Lease	
STATE <input type="checkbox"/>	FEE <input checked="" type="checkbox"/>

5. State Oil & Gas Lease No.
------------------------------

## APPLICATION FOR PERMIT TO DRILL, DEEPEN, OR PLUG BACK

1a. Type of Work		7. Unit Agreement Name	
b. Type of Well DRILL <input type="checkbox"/> DEEPEN <input checked="" type="checkbox"/> PLUG BACK <input type="checkbox"/> OIL WELL <input checked="" type="checkbox"/> GAS WELL <input checked="" type="checkbox"/> OTHER <input type="checkbox"/> SINGLE ZONE <input type="checkbox"/> MULTIPLE ZONE <input checked="" type="checkbox"/>		8. Farm or Lease Name S. E. Long	
2. Name of Operator Mobil Oil Corporation		9. Well No. 7	
3. Address of Operator P. O. Box 633, Midland, Texas 79701		10. Field and Pool, or Wildcat Wantz-Granite Wash	
4. Location of Well UNIT LETTER I LOCATED 660 FEET FROM THE East LINE AND 1780 FEET FROM THE South LINE OF SEC. 11 TWP. 22S RGE. 37E NMPM		11. County Lea	
19. Proposed Depth 7,300'		13A. Formation granite Wash	
21. Elevations (show whether DE, FI, etc.) 3348' Ground		22. Approx. Date Work will start As soon as possible	
21A. Kind & Status Plug. Bond On File		21B. Drilling Contractor Unknown	

23. PROPOSED CASING AND CEMENT PROGRAM					
SIZE OF HOLE	SIZE OF CASING	WEIGHT PER FOOT	SETTING DEPTH	SACKS OF CEMENT	EST. TOP

This well is presently completed as a gas well in the Drinkard Pool. Permission is requested to deepen to approximately 7,300' and dually complete as a Drinkard (Gas) and Granite Wash (Oil) producer.

### BLOWOUT PREVENTER PROGRAM

Casing String	Equip. Size & API Series	No. & Type	Test Pressure PSI
Surface	10"	900	1-Blank Ram 1-Pipe Ram

APPROVAL VALID 6000  
FOR 90 DAYS UNLESS  
DRILLING COMMENCED,  
EXPIRES 6-24-75

IN ABOVE SPACE DESCRIBE PROPOSED PROGRAM: IF PROPOSAL IS TO DEEPEN OR PLUG BACK, GIVE DATA ON PRESENT PRODUCTIVE ZONE AND PROPOSED NEW PRODUCTIVE ZONE, GIVE BLOWOUT PREVENTER PROGRAM, IF ANY.

I hereby certify that the information above is true and complete to the best of my knowledge and belief.

Signed A. D. Bond Title Proration Staff Assistant Date March 21, 1975

(This space for State Use)

APPROVED BY [Signature] TITLE  DATE

CONDITIONS OF APPROVAL, IF ANY:

**NEW MEXICO OIL CONSERVATION COMMISSION**  
**WELL LOCATION AND ACREAGE DEDICATION PLAT**

Form C-102  
 Supersedes C-128  
 Effective 1-1-65

All distances must be from the outer boundaries of the Section.

Operator <b>Mobil Oil Corporation</b>			Lease <b>S. E. Long</b>		Well No. <b>7</b>
Unit Letter <b>I</b>	Section <b>11</b>	Township <b>22S</b>	Range <b>37E</b>	County <b>Lea</b>	
Actual Postage Location of Well: <b>660</b> feet from the <b>East</b> line and <b>1780</b> feet from the <b>South</b> line					
Ground Level Elev. <b>3348'</b>	Producing Formation <b>Granite Wash</b>		Pool <b>Wantz-Granite Wash</b>		Dedicated Acreage: <b>40</b> Acres

1. Outline the acreage dedicated to the subject well by colored pencil or hachure marks on the plat below.
2. If more than one lease is dedicated to the well, outline each and identify the ownership thereof (both as to working interest and royalty).
3. If more than one lease of different ownership is dedicated to the well, have the interests of all owners been consolidated by communitization, unitization, force-pooling, etc?

☐ Yes    ☐ No    If answer is "yes," type of consolidation \_\_\_\_\_

If answer is "no," list the owners and tract descriptions which have actually been consolidated. (Use reverse side of this form if necessary.) \_\_\_\_\_

No allowable will be assigned to the well until all interests have been consolidated (by communitization, unitization, forced-pooling, or otherwise) or until a non-standard unit, eliminating such interests, has been approved by the Commission.

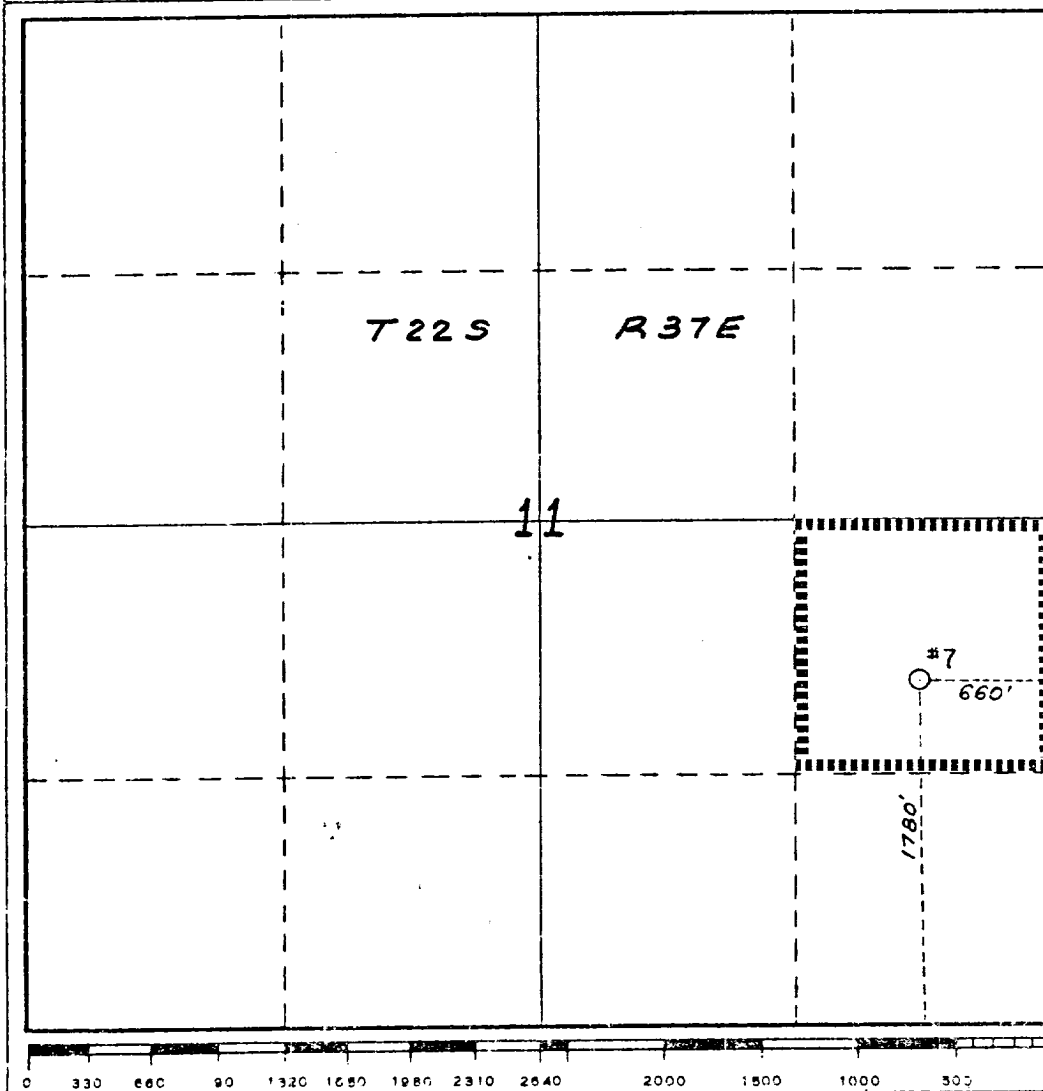

**CERTIFICATION**

*I hereby certify that the information contained herein is true and complete to the best of my knowledge and belief.*

*A. D. Bond*

Name  
**A. D. Bond**

Position  
**Proration Staff Assistant**

Company  
**Mobil Oil Corporation**

Date  
**March 21, 1975**

*I hereby certify that the well location shown on this plat was plotted from field notes of actual surveys made by me or under my supervision, and that the same is true and correct to the best of my knowledge and belief.*

Date Surveyed

Registered Professional Engineer  
and/or Land Surveyor

Certificate No.