



P.O. Box 2490
Hobbs, New Mexico 88240
Telephone 505/393-7106

April 6, 1999

**Application to Simultaneously Dedicate
Blinebry Oil & Gas Pool Production**

Lou Worthan Well No. 5
Unit Letter 'C', 660' FNL & 1980' FWL
Section 11, T-22-S, R-37-E
Lea County, New Mexico

Lou Worthan Well No. 9
Unit Letter 'E', 1905' FNL & 440' FWL
Section 11, T-22-S, R-37-E
Lea County, New Mexico

Lou Worthan Well No. 19
Unit Letter 'D', 680' FNL & 880' FWL
Section 11, T-22-S, R-37-E
Lea County, New Mexico

Mr. Michael Stogner
State of New Mexico
Oil Conservation Division
2040 South Pacheco
Santa Fe, New Mexico 87505

Dear Mr. Stogner:

Marathon Oil Company respectfully requests authorization to simultaneously dedicate Blinebry Oil & Gas Pool Production to a 160 acre gas proration unit. This gas proration unit will be comprised of the NW/4 of Section 11, T-22-S, R-37-E in Lea County, New Mexico.

Currently Administrative Order NSL-1261 apply to Lou Worthan Well No. 9 for a non-standard location of a gas well. A recent workover/recompletion on Lou Worthan Well No. 19 has made it a Blinebry gas well. The wells on this lease to be simultaneously dedicate to this standard gas proration unit for the Blinebry Oil & Gas Pool Production are:

Lou Worthan Well No. 5	API No. 30-025-10214
Lou Worthan Well No. 9	API No. 30-025-10218
Lou Worthan Well No. 19	API No. 30-025-29469

This lease has 320 acres. A Blinebry Pool oil well (Lou Worthan Well No. 4, API No. 30-025-10213) has 40 acres dedicated to it in the SW portion of the NE/4 portion of Section 11. The other 120 acres in the NE/4 of Section 11, is simultaneously dedicated to another Blinebry Gas Proration Unit Pool which includes Lou Worthan Well No. 12, API No. 30-025-10221 and Lou Worthan Well No. 21, API No. 30-025-33426.

Marathon also request a 30 day exception for theses well while awaiting approval. Attached are C-102's for each well showing the locations and footage for the three wells. Also we have sent this same information to the offset operators. If you have any questions or have need of additional data, please contact me at (505) 393-7106 ext. 201.

Sincerely,

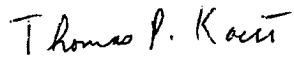
Handwritten signature of Thomas P. Kacir in black ink.

Thomas P. Kacir
Production Engineer

OFFSET OPERATORS
Lease NM - 377 -
Lou Worthan
N/2 Section 11,
T-22-S, R-37-E, N.M.P.M.
Lea County, New Mexico
Drinkard Field

T-22-S, R-37-E

Section 2:

Exxon Corporation
P.O. Box 4697
Houston, Texas 77210-4697

Section 3:

John H. Hendrix Corp.
223 West Wall Ste. 525
Midland, Texas 79701

Section 10:

Chevron USA Inc.
P.O. Box 1150
Midland, Texas 79702

Texaco Exploration & Production Co., Inc.
P.O. Box 3109
Midland, Texas 79702

Collins and Ware
508 W. Wall Ste. 1200
Midland, Texas 79701

Section 11:

Apache Corp.
2000 Post Oak Blvd. #100
Houston, Texas 77056-4400

John H. Hendrix Corp.

Section 12:

John H. Hendrix Corp.

Section 1:

John H. Hendrix Corp.

State of New Mexico

Energy, Minerals & Natural Resources Department

Form C-102

Revised October 18, 1994

Instructions on back

Submit to Appropriate District Office

State Lease - 4 Copies

Fee Lease - 3 Copies

District I

PO Box 1980, Hobbs, NM 88241-1980

District II

811 S. 1st Street, Artesia, NM 88210-2834

District III

1000 Rio Brazos Rd., Aztec, NM 87410

District IV

2040 South Pacheco, Santa Fe, NM 87505

OIL CONSERVATION DIVISION
2040 South Pacheco
Santa Fe, NM 87505☐ AMENDED REPORT

WELL LOCATION AND ACREAGE DEDICATION PLAT

¹ API Number 30-025-10214	² Pool Code 72480	³ Pool Name Blinebry Oil & Gas
⁴ Property Code 6488	⁵ Property Name Lou Worthan	⁶ Well Number 5
⁷ OGRID No. 014021	⁸ Operator Name Marathon Oil Company	⁹ Elevation GL: 3353'

¹⁰ Surface Location

UL or lot no. C	Section 11	Township 22-S	Range 37-E	Lot. Idn	Feet from the 660	North/South Line North	Feet from the 1980	East/West line West	County Lea
---------------------------	----------------------	-------------------------	----------------------	----------	-----------------------------	----------------------------------	------------------------------	-------------------------------	----------------------

¹¹ Bottom Hole Location If Different From Surface

UL or lot no.	Section	Township	Range	Lot. Idn	Feet from the	North/South Line	Feet from the	East/West line	County
¹² Dedicated Acres 160	¹³ Joint or Infill Y	¹⁴ Consolidation Code	¹⁵ Order No.						

NO ALLOWABLE WILL BE ASSIGNED TO THIS COMPLETION UNTIL ALL INTERESTS HAVE BEEN CONSOLIDATED
OR A NON--STANDARD UNIT HAS BEEN APPROVED BY THE DIVISION

	¹⁷ OPERATOR CERTIFICATION I hereby certify that the information contained herein is true and complete to the best of my knowledge and belief. <i>Thomas P. Kacir</i> Signature Thomas P. Kacir Printed Name Production Engineer Title 3/31/99 Date	
	¹⁸ SURVEYOR CERTIFICATION I hereby certify that the well location shown on this plat was plotted from field notes of actual surveys made by me or under my supervision, and that the same is true and correct to the best of my belief. Date of Survey Signature and Seal of Professional Surveyor: Certificate Number	

District I
PO Box 1980, Hobbs, NM 88241-1980

District II
811 S. 1st Street, Artesia, NM 88210-2834

District III
1000 Rio Brazos Rd., Aztec, NM 87410

District IV
2040 South Pacheco, Santa Fe, NM 87505

State of New Mexico
Energy, Minerals & Natural Resources Department

OIL CONSERVATION DIVISION
2040 South Pacheco
Santa Fe, NM 87505

Form C-102
Revised October 18, 1994
Instructions on back
Submit to Appropriate District Office
State Lease - 4 Copies
Fee Lease - 3 Copies

☐ AMENDED REPORT

WELL LOCATION AND ACREAGE DEDICATION PLAT

¹ API Number 30-025-10218		² Pool Code 72480		³ Pool Name Blinbry Oil & Gas	
⁴ Property Code 6488		⁵ Property Name Lou Worthan			⁶ Well Number 9
⁷ OGRID No. 014021		⁸ Operator Name Marathon Oil Company			⁹ Elevation GL: 3366'

¹⁰ Surface Location									
UL or lot no. E	Section 11	Township 22-S	Range 37-E	Lot. Idn	Feet from the 1905	North/South Line North	Feet from the 440	East/West line West	County Lea

¹¹ Bottom Hole Location If Different From Surface									
UL or lot no.	Section	Township	Range	Lot. Idn	Feet from the	North/South Line	Feet from the	East/West line	County
¹² Dedicated Acres 160		¹³ Joint or Infill Y		¹⁴ Consolidation Code		¹⁵ Order No.			

NO ALLOWABLE WILL BE ASSIGNED TO THIS COMPLETION UNTIL ALL INTERESTS HAVE BEEN CONSOLIDATED
OR A NON--STANDARD UNIT HAS BEEN APPROVED BY THE DIVISION

				<p>¹⁷ OPERATOR CERTIFICATION I hereby certify that the information contained herein is true and complete to the best of my knowledge and belief.</p> <p><i>Thomas P. Kacir</i> Signature Thomas P. Kacir Printed Name Production Engineer Title 4/5/99 Date</p>	
<p>¹⁸ SURVEYOR CERTIFICATION I hereby certify that the well location shown on this plat was plotted from field notes of actual surveys made by me or under my supervision, and that the same is true and correct to the best of my belief.</p> <p>_____ Date of Survey _____ Signature and Seal of Professional Surveyer: _____ Certificate Number</p>					

District I
PO Box 1980, Hobbs, NM 88241-1980
District II
811 S. 1st Street, Artesia, NM 88210-2834
District III
1000 Rio Brazos Rd., Aztec, NM 87410
District IV
2040 South Pacheco, Santa Fe, NM 87505

State of New Mexico
Energy, Minerals & Natural Resources Department

OIL CONSERVATION DIVISION
2040 South Pacheco
Santa Fe, NM 87505

Form C-102
Revised October 18, 1994
Instructions on back
Submit to Appropriate District Office
State Lease - 4 Copies
Fee Lease - 3 Copies

☐ AMENDED REPORT

WELL LOCATION AND ACREAGE DEDICATION PLAT

¹ API Number 30-025-29469		² Pool Code 72480		³ Pool Name Blinebry Oil & Gas	
⁴ Property Code 6488		⁵ Property Name Lou Worthan			⁶ Well Number 19
⁷ OGRID No. 014021		⁸ Operator Name Marathon Oil Company			⁹ Elevation GL: 3368'

¹⁰ Surface Location

UL or lot no. D	Section 11	Township 22-S	Range 37-E	Lot. Idn	Feet from the 680	North/South Line North	Feet from the 880	East/West line West	County Lea
--------------------	---------------	------------------	---------------	----------	----------------------	---------------------------	----------------------	------------------------	---------------

¹¹ Bottom Hole Location If Different From Surface

UL or lot no.	Section	Township	Range	Lot. Idn	Feet from the	North/South Line	Feet from the	East/West line	County
---------------	---------	----------	-------	----------	---------------	------------------	---------------	----------------	--------

¹² Dedicated Acres 160	¹³ Joint or Infill Y	¹⁴ Consolidation Code	¹⁵ Order No.
--------------------------------------	------------------------------------	----------------------------------	-------------------------

NO ALLOWABLE WILL BE ASSIGNED TO THIS COMPLETION UNTIL ALL INTERESTS HAVE BEEN CONSOLIDATED
OR A NON-STANDARD UNIT HAS BEEN APPROVED BY THE DIVISION

				<p>¹⁷ OPERATOR CERTIFICATION I hereby certify that the information contained herein is true and complete to the best of my knowledge and belief.</p> <p><i>Thomas P. Kacir</i> Signature Thomas P. Kacir Printed Name Production Engineer Title 4/5/99 Date</p>	
<p>Proration unit</p>				<p>¹⁸ SURVEYOR CERTIFICATION I hereby certify that the well location shown on this plat was plotted from field notes of actual surveys made by me or under my supervision, and that the same is true and correct to the best of my belief.</p> <p>Date of Survey Signature and Seal of Professional Surveyer:</p>	
				<p>Certificate Number</p>	

Marathon Oil Co.
Lou Worthan Lease
N/2 Section 11

T-22-S, R-37-E, N.M.P.M.
Lea County, New Mexico

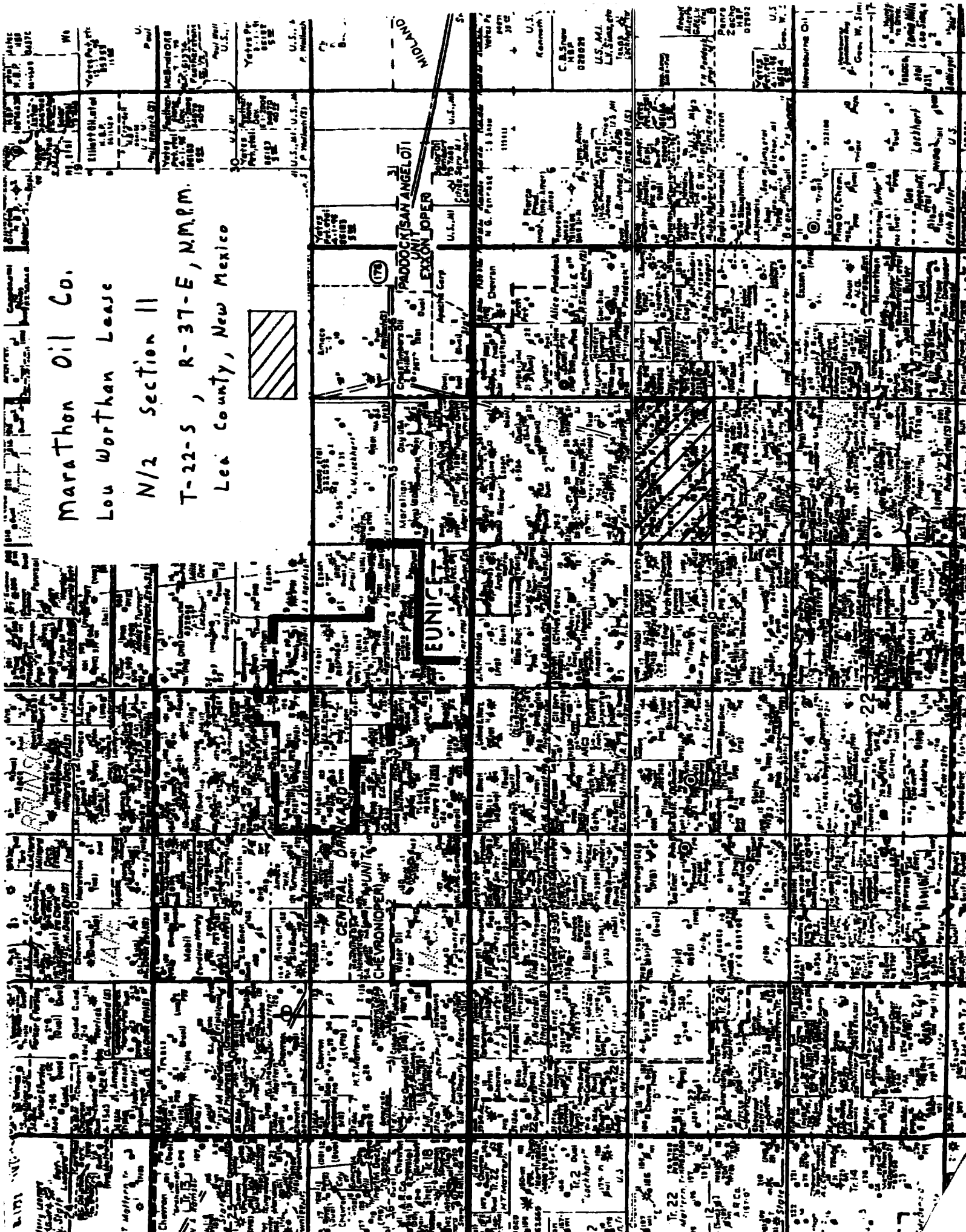

State of New Mexico
Energy, Minerals and Natural Resources Department
OIL CONSERVATION DIVISION
2040 Pacheco St.
Santa Fe, NM 87505

Submit 2 copies to Appropriate
District Office.
DISTRICT I
P.O. Box 1980, Hobbs, NM 88240
DISTRICT II
811 S. 1st Street, Artesia, NM 88210-2834
DISTRICT III
1000 Rio Brazos Rd., Aztec, NM 87410

Form C-116
Revised 1/1/89

GAS - OIL RATIO TEST

Operator Marathon Oil Company		Pool Blinberry Oil & Gas (gas)		County Lea											
Address P.O. Box 2490 Hobbs, NM 88241		TYPE OF TEST - (X)		Completion <input type="checkbox"/> Special <input checked="" type="checkbox"/>											
LEASE NAME Lou Worthan	WELL NO. 5 9 19	LOCATION			DATE OF TEST 3/1/99 3/6/99 3/27/99	TYPE OF TEST - (X) F P P	CHOKE SIZE 165 200 350	DAILY ALLOW-ABLE M M M	LENGTH OF TEST HOURS 24 24 24	PROD. DURING TEST			GAS-OIL RATIO CU FT/ BBL 64,950 579,000 63,200		
		U	S	T						R	WATER BBLs.	GRAV. OIL		OIL BBLs.	GAS M.C.F.

For Information Only

Instructions:

During gas-oil ratio test, each well shall be produced at a rate not exceeding the top unit allowable for the pool in which well is located by more than 25 percent. Operator is encouraged to take advantage of this 25 percent tolerance in order that well can be assigned increased allowables when authorized by the Division.

Gas volumes must be reported in MCF measured at a pressure base of 15.025 psia and a temperature of 60 °F. Specific gravity base will be 0.60.

Report casing pressure in lieu of tubing pressure for any well producing through casing.

See Rule 301, Rule 1116 & appropriate pool rules.)

I hereby certify that the above information is true and complete to the best of my knowledge and belief.

Thomas P. Kacir
Signature

Thomas P. Kacir **Production Engineer**
Printed name and title
April 6, 1999 **393-7106**
Date Telephone No.

Houston Division
Production Operations, United States



**Marathon
Oil Company**

P.O. Box 2490
Hobbs, New Mexico 88240
Telephone 505/393-7106

April 6, 1999

Apache Corp.
2000 Post Oak Blvd. #100
Houston, Texas 77056-4400

RE: Application to Simultaneously Dedicate
Blinberry Oil & Gas Pool Production

Lou Worthan Well No. 5
Unit Letter C, 660' FNL & 1980' FWL
Section 11, T-22-S, R-37-E
Lea County, New Mexico

Lou Worthan Well No. 9
Unit Letter E, 1905' FNL & 440' FWL
Section 11, T-22-S, R-37-E
Lea County, New Mexico

Lou Worthan Well No. 19
Unit Letter D, 680' FNL & 880' FWL
Section 11, T-22-S, R-37-E
Lea County, New Mexico

Ladies and/or Gentlemen:

Marathon Oil Company has filed an application with the New Mexico Oil Conservation division to simultaneously dedicate Blinberry Oil & Gas Pool Production to a 160 acre standard gas proration unit. Please find enclosed a copy of the application.

If you are in agreement and waive all objections to the simultaneously dedicated wells, please sign below and mail the original to the NMOCD in the enclosed addressed envelope. Also, please return one copy to Marathon at the letterhead address.

Sincerely,

A handwritten signature in cursive script, reading 'Thomas P. Kacir'.

Thomas P. Kacir
Production Engineer

TPK/
Enclosure

Agreed and accepted this _____ day of _____ 1999

by _____, as representative of

Houston Division
Production Operations, United States



**Marathon
Oil Company**

P.O. Box 2490
Hobbs, New Mexico 88240
Telephone 505/393-7106

April 6, 1999

Chevron USA Inc.
P. O. Box 1150
Midland, Texas 79702

RE: Application to Simultaneously Dedicate
Blinebry Oil & Gas Pool Production

Lou Worthan Well No. 5
Unit Letter C, 660' FNL & 1980' FWL
Section 11, T-22-S, R-37-E
Lea County, New Mexico

Lou Worthan Well No. 9
Unit Letter E, 1905' FNL & 440' FWL
Section 11, T-22-S, R-37-E
Lea County, New Mexico

Lou Worthan Well No. 19
Unit Letter D, 680' FNL & 880' FWL
Section 11, T-22-S, R-37-E
Lea County, New Mexico

Ladies and/or Gentlemen:

Marathon Oil Company has filed an application with the New Mexico Oil Conservation division to simultaneously dedicate Blinebry Oil & Gas Pool Production to a 160 acre standard gas proration unit. Please find enclosed a copy of the application.

If you are in agreement and waive all objections to the simultaneously dedicated wells, please sign below and mail the original to the NMOCD in the enclosed addressed envelope. Also, please return one copy to Marathon at the letterhead address.

Sincerely,

A handwritten signature in cursive script that reads 'Thomas P. Kacir'.

Thomas P. Kacir
Production Engineer

TPK/
Enclosure

Agreed and accepted this _____ day of _____ 1999

by _____, as representative of

Houston Division
Production Operations, United States



P.O. Box 2490
Hobbs, New Mexico 88240
Telephone 505/393-7106

April 6, 1999

Collins and Ware
508 W. Wall Ste. 1200
Midland, Texas 79701

RE: Application to Simultaneously Dedicate
Blinebry Oil & Gas Pool Production

Lou Worthan Well No. 5
Unit Letter C, 660' FNL & 1980' FWL
Section 11, T-22-S, R-37-E
Lea County, New Mexico

Lou Worthan Well No. 9
Unit Letter E, 1905' FNL & 440' FWL
Section 11, T-22-S, R-37-E
Lea County, New Mexico

Lou Worthan Well No. 19
Unit Letter D, 680' FNL & 880' FWL
Section 11, T-22-S, R-37-E
Lea County, New Mexico

Ladies and/or Gentlemen:

Marathon Oil Company has filed an application with the New Mexico Oil Conservation division to simultaneously dedicate Blinebry Oil & Gas Pool Production to a 160 acre standard gas proration unit. Please find enclosed a copy of the application.

If you are in agreement and waive all objections to the simultaneously dedicated wells, please sign below and mail the original to the NMOCD in the enclosed addressed envelope. Also, please return one copy to Marathon at the letterhead address.

Sincerely,

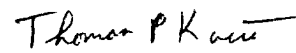
Thomas P. Kacir
Production Engineer

TPK/
Enclosure

Agreed and accepted this _____ day of _____ 1999

by _____, as representative of

Houston Division
Production Operations, United States



P.O. Box 2490
Hobbs, New Mexico 88240
Telephone 505/393-7106

April 6, 1999

Exxon Corporation
P. O. Box 4697
Houston, Texas 77210-4697

RE: Application to Simultaneously Dedicate
Blinberry Oil & Gas Pool Production

Lou Worthan Well No. 5
Unit Letter C, 660' FNL & 1980' FWL
Section 11, T-22-S, R-37-E
Lea County, New Mexico

Lou Worthan Well No. 9
Unit Letter E, 1905' FNL & 440' FWL
Section 11, T-22-S, R-37-E
Lea County, New Mexico

Lou Worthan Well No. 19
Unit Letter D, 680' FNL & 880' FWL
Section 11, T-22-S, R-37-E
Lea County, New Mexico

Ladies and/or Gentlemen:

Marathon Oil Company has filed an application with the New Mexico Oil Conservation division to simultaneously dedicate Blinberry Oil & Gas Pool Production to a 160 acre standard gas proration unit. Please find enclosed a copy of the application.

If you are in agreement and waive all objections to the simultaneously dedicated wells, please sign below and mail the original to the NMOCD in the enclosed addressed envelope. Also, please return one copy to Marathon at the letterhead address.

Sincerely,

A handwritten signature in cursive script that reads 'Thomas P. Kacir'.

Thomas P. Kacir
Production Engineer

TPK/
Enclosure

Agreed and accepted this _____ day of _____ 1999

by _____, as representative of

Houston Division
Production Operations, United States



**Marathon
Oil Company**

P.O. Box 2490
Hobbs, New Mexico 88240
Telephone 505/393-7106

April 6, 1999

John H. Hendrix Corp.
223 West Wall Ste 525
Midland, Texas 79701

RE: Application to Simultaneously Dedicate
Blinebry Oil & Gas Pool Production

Lou Worthan Well No. 5
Unit Letter C, 660' FNL & 1980' FWL
Section 11, T-22-S, R-37-E
Lea County, New Mexico

Lou Worthan Well No. 9
Unit Letter E, 1905' FNL & 440' FWL
Section 11, T-22-S, R-37-E
Lea County, New Mexico

Lou Worthan Well No. 19
Unit Letter D, 680' FNL & 880' FWL
Section 11, T-22-S, R-37-E
Lea County, New Mexico

Ladies and/or Gentlemen:

Marathon Oil Company has filed an application with the New Mexico Oil Conservation division to simultaneously dedicate Blinebry Oil & Gas Pool Production to a 160 acre standard gas proration unit. Please find enclosed a copy of the application.

If you are in agreement and waive all objections to the simultaneously dedicated wells, please sign below and mail the original to the NMOCD in the enclosed addressed envelope. Also, please return one copy to Marathon at the letterhead address.

Sincerely,

A handwritten signature in cursive script that reads 'Thomas P. Kacir'.

Thomas P. Kacir
Production Engineer

TPK/
Enclosure

Agreed and accepted this _____ day of _____ 1999

by _____, as representative of

Houston Division
Production Operations, United States



P.O. Box 2490
Hobbs, New Mexico 88240
Telephone 505/393-7106

April 6, 1999

Texaco Exploration & Production Co., Inc.
P. O. Box 3109
Midland, Texas 79702

RE: Application to Simultaneously Dedicate
Blinberry Oil & Gas Pool Production

Lou Worthan Well No. 5
Unit Letter C, 660' FNL & 1980' FWL
Section 11, T-22-S, R-37-E
Lea County, New Mexico

Lou Worthan Well No. 9
Unit Letter E, 1905' FNL & 440' FWL
Section 11, T-22-S, R-37-E
Lea County, New Mexico

Lou Worthan Well No. 19
Unit Letter D, 680' FNL & 880' FWL
Section 11, T-22-S, R-37-E
Lea County, New Mexico

Ladies and/or Gentlemen:

Marathon Oil Company has filed an application with the New Mexico Oil Conservation division to simultaneously dedicate Blinberry Oil & Gas Pool Production to a 160 acre standard gas proration unit. Please find enclosed a copy of the application.

If you are in agreement and waive all objections to the simultaneously dedicated wells, please sign below and mail the original to the NMOCD in the enclosed addressed envelope. Also, please return one copy to Marathon at the letterhead address.

Sincerely,

A handwritten signature in cursive script that reads 'Thomas P. Kacir'.

Thomas P. Kacir
Production Engineer

TPK/
Enclosure

Agreed and accepted this _____ day of _____ 1999

by _____, as representative of
