

All distances must be from the outer boundaries of the Section.

Operator ZACHARY OIL OPERATING COMPANY		Lease HINTON		Well No. 5
Unit Letter P	Section 12	Township 22S	Range 37E	County LEA
Actual Postage Location of Well: 990 feet from the South line and 990 feet from the East line				
Ground Level Elev. 3332	Producing Formation BLINEBRY		Pool BLINEBRY OIL	Dedicated Acreage: 40 Acres

1. Outline the acreage dedicated to the subject well by colored pencil or hachure marks on the plat below.
2. If more than one lease is dedicated to the well, outline each and identify the ownership thereof (both as to working interest and royalty).
3. If more than one lease of different ownership is dedicated to the well, have the interests of all owners been consolidated by communitization, unitization, force-pooling, etc?

☐ Yes ☐ No If answer is "yes," type of consolidation _____

If answer is "no," list the owners and tract descriptions which have actually been consolidated. (Use reverse side of this form if necessary.) _____

No allowable will be assigned to the well until all interests have been consolidated (by communitization, unitization, forced-pooling, or otherwise) or until a non-standard unit, eliminating such interests, has been approved by the Division.

CERTIFICATION

I hereby certify that the information contained herein is true and complete to the best of my knowledge and belief.

Name
Raya Pierce
Position
PROD. SUPT.

Company
ZACHARY OIL OPERATING CO.

Date
12-19-84

I hereby certify that the well location shown on this plat was plotted from field notes of actual surveys made by me or under my supervision, and that the same is true and correct to the best of my knowledge and belief.

10-27, 1953

Date Surveyed
JOHN W. WEST

Registered Professional Engineer and/or Land Surveyor

PE & LS No. 676

Certificate No.

RECEIVED
DEC 20 1984
O.C.D.
HOBBS OFFICE

NEW MEXICO OIL CONSERVATION COMMISSION
Well Location and Acreage Dedication Plat

Form G-128
Revised 5/1/57

Section A.

Date February 18, 1958

Operator Neville G. Penrose, Inc. Lease Hinton
Well No. 5 Unit Letter P Section 12 Township 22S Range 37E NMPM
Located 990 Feet From south Line, 990 Feet From east Line
County Lea G. L. Elevation _____ Dedicated Acreage 120 Acres
Name of Producing Formation Blinebry Pool Blinebry

1. Is the Operator the only owner* in the dedicated acreage outlined on the plat below?
Yes _____ No X.
2. If the answer to question one is "no," have the interests of all the owners been consolidated by communitization agreement or otherwise? Yes X No _____. If answer is "yes," Type of Consolidation joint venture
3. If the answer to question two is "no," list all the owners and their respective interests below:

Owner

Land Description

Section B

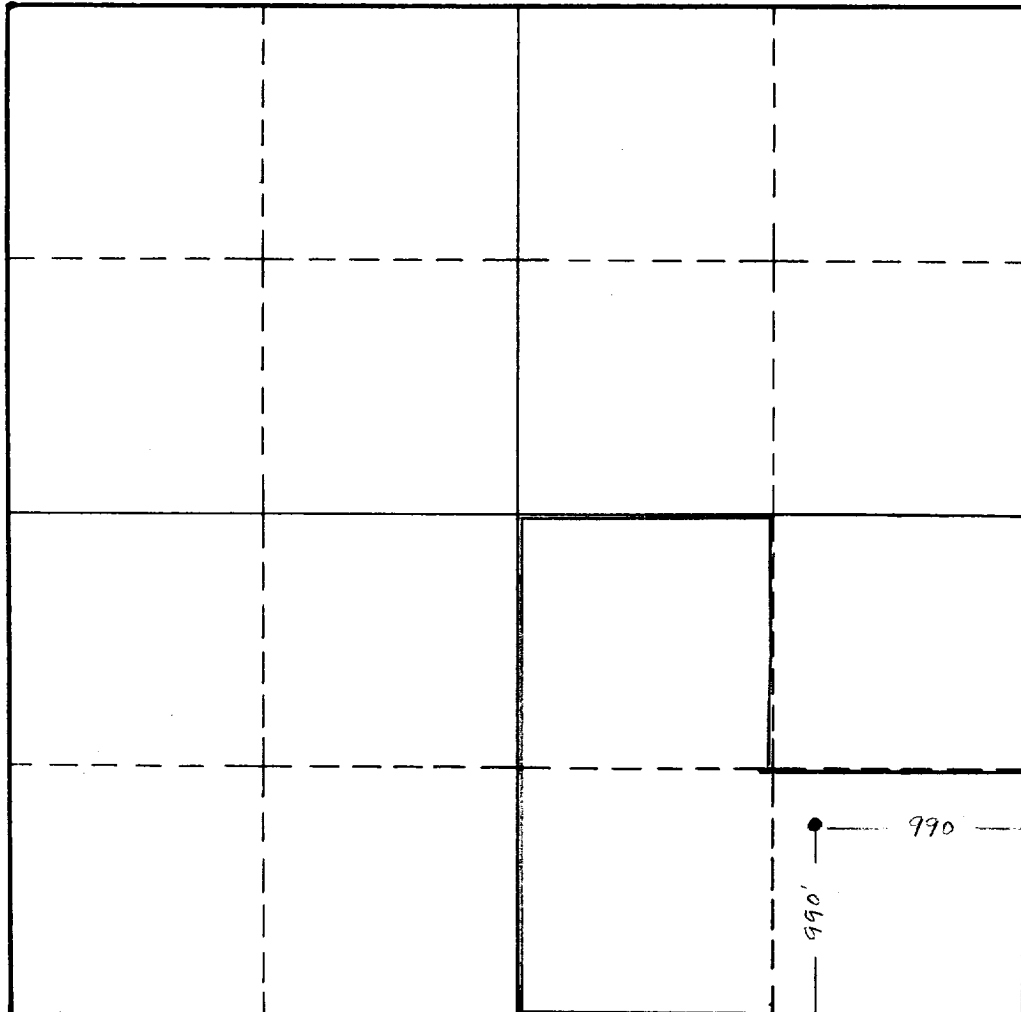

This is to certify that the information in Section A above is true and complete to the best of my knowledge and belief.

Neville G. Penrose, Inc.
(Operator)

Blair B. Reice
(Representative)

Box 988

Eunice, New Mexico

Address

This is to certify that the well location shown on the plat in Section B was plotted from field notes of actual surveys made by me or under my supervision and that the same is true and correct to the best of my knowledge and belief.

Date Surveyed 10-27-53

John W. West

Registered Professional
Engineer and/or Land Surveyor.

Certificate No. 676

(See instructions for completing this form on the reverse side)

INSTRUCTIONS FOR COMPLETION:

1. Operator shall furnish and certify to the information called for in Section A.
2. Operator shall outline the dedicated acreage for both oil and gas wells on the plat in Section B.
3. A registered professional engineer or land surveyor registered in the State of New Mexico or approved by the Commission shall show on the plat the location of the well and certify this information in the space provided.
4. All distances shown on the plat must be from the outer boundaries of Section.
5. If additional space is needed for listing owners and their respective interests as required in question 3, Section A, please use space below

* "Owner" means the person who has the right to drill into and to produce from any pool and to appropriate the production either for himself or for himself and another. (65-3-29 (e) NMSA 1953 Comp.)

NEW MEXICO
OIL CONSERVATION COMMISSION

Gas Well Plat

Date March 23, 1954

Neville G. Penrose, Inc.

Hinton

5

Operator

Lease

Well No.

Name of Producing Formation Tubb Pool Tubb

No. Acres Dedicated to the Well 300 80

SECTION 12 TOWNSHIP 22S RANGE 37E

I hereby certify that the information given above is true and complete to the best of my knowledge.

Name

Position

Representing

Address

John P. McNaughton

John P. McNaughton - Engineer

Neville G. Penrose, Inc.

1813 Fair Bldg., Ft. Worth, Tex.

(over)

INSTRUCTIONS

1. Is this gas well a dual completion? Yes _____ No **X**
2. If the answer to Question 1 is Yes, are there any other
dually completed wells within the dedicated acreage?
Yes _____ No **X**

A separate plat must be filed for each gas well, outlining the area dedicated to such well and showing the location of all other wells (oil and gas) within the outlined area.

Mail in duplicate to the district office for the district in which the well is located.

NEW MEXICO
OIL CONSERVATION COMMISSION

Gas Well Plat

HOBBS OFFICE OCC

Date May 20, 1954

Neville G. Penrose, Inc. Hinton 1954 MAY 21 PM 5:24
Operator Lease Well No.

Name of Producing Formation Tubb Pool Tubb

No. Acres Dedicated to the Well 160

SECTION 12 TOWNSHIP 22S RANGE 37E

I hereby certify that the information given above is true and complete to the best of my knowledge.

Name John P. McNaughton
Position Engineer
Representing Neville G. Penrose, Inc.
Address 1813 Fair Bldg., Ft. Worth, Texas

(over)

INSTRUCTIONS

1. Is this gas well a dual completion? Yes _____ No X
2. If the answer to Question 1 is Yes, are there any other dually completed wells within the dedicated acreage? Yes _____ No _____

A separate plat must be filed for each gas well, outlining the area dedicated to such well and showing the location of all other wells (oil and gas) within the outlined area.

Mail in duplicate to the district office for the district in which the well is located.