

NO. OF COPIES RECEIVED	
DISTRIBUTION	
SANTA FE	
FILE	
U.S.G.S.	
LAND OFFICE	
OPERATOR	

# NEW MEXICO OIL CONSERVATION COMMISSION

Form C-101  
Revised 1-1-65

5A. Indicate Type of Lease	
STATE <input type="checkbox"/>	FEE <input checked="" type="checkbox"/>
5. State Oil & Gas Lease No.	

## APPLICATION FOR PERMIT TO DRILL, DEEPEN, OR PLUG BACK

1a. Type of Work			7. Unit Agreement Name		
b. Type of Well DRILL <input type="checkbox"/> DEEPEN <input checked="" type="checkbox"/> PLUG BACK <input type="checkbox"/> OIL WELL <input checked="" type="checkbox"/> GAS WELL <input type="checkbox"/> OTHER <input type="checkbox"/> SINGLE ZONE <input type="checkbox"/> MULTIPLE ZONE <input checked="" type="checkbox"/>			8. Farm or Lease Name Hinton 14		
2. Name of Operator Sohio Petroleum Company			9. Well No. 8		
3. Address of Operator P. O. Box 3000 Midland, Tx 79702			10. Field and Pool, or Wildcat Drinkard, Wantz Granite Wash		
4. Location of Well UNIT LETTER J LOCATED 2310 FEET FROM THE S LINE AND 2310 FEET FROM THE E LINE OF SEC. 12 TWP. 22S RGE. 3E NMPM			12. County Lea		
21. Elevations (Show whether DF, RT, etc.) 3349 KB		21A. Kind & Status Plug. Bond Blanket	19. Proposed Depth 7500'	19A. Formation Drinkard & Wantz Granite Wash	20. Rotary or C.T. Rotary
23.			21B. Drilling Contractor Unknown	22. Approx. Date Work will start ± 5/23/83	

## PROPOSED CASING AND CEMENT PROGRAM

SIZE OF HOLE	SIZE OF CASING	WEIGHT PER FOOT	SETTING DEPTH	SACKS OF CEMENT	EST. TOP
* 17	13-3/8	48	155	150	Surface
* 11	8-5/8	32	2761	1600	"
* 7-7/8	5 1/2	15 1/2	5206	200	3843
4-3/4	4"	11.6	7500	135	4500

\* Presently in place

This well was completed 9-17-46 in the Paddock as the Neville G. Penrose Hinton #8. It was acquired by Sohio in 1962. It is presently TA'd in the Exxon operated Paddock (San Angelo) Unit, well #84, and has been released back to Sohio. Sohio proposes to deepen this well from the Paddock, complete in the Drinkard and Wantz Granite Wash, and down hole commingle the zones. It will serve as a replacement well for the Hinton 14, located on unit J, which is to be plugged. The down hole assembly will permit individual zone test. This well is 2 locations East of the Sohio Hinton 13, which is commingled down hole in the Drinkard and Granit Wash.

IN ABOVE SPACE DESCRIBE PROPOSED PROGRAM: IF PROPOSAL IS TO DEEPEN OR PLUG BACK, GIVE DATA ON PRESENT PRODUCTIVE ZONE AND PROPOSED NEW PRODUCTION ZONE. GIVE BLOWOUT PREVENTER PROGRAM, IF ANY.

I hereby certify that the information above is true and complete to the best of my knowledge and belief.

Signed C. H. Allen Title District Manager Date May 5, 1983

(This space for State Use)

ORIGINAL SIGNED BY EDDIE SEAY

APPROVED BY OIL & GAS INSPECTOR TITLE

CONDITIONS OF APPROVAL, IF ANY:

DATE

MAY 16 1983

RECEIVED

MAY 9 1983

HOUSE OF REPRESENTATIVES

NEW MEXICO OIL CONSERVATION COMMISSION  
WELL LOCATION AND ACREAGE DEDICATION PLAT

Form C-102  
Supersedes C-128  
Effective 1-1-65

All distances must be from the outer boundaries of the Section.

Operator <b>Sohio Petroleum Company</b>			Lease <b>Hinton</b>		Well No. <b>8</b>
Unit Letter <b>J</b>	Section <b>12</b>	Township <b>22-S</b>	Range <b>37-E</b>	County <b>Lea</b>	
Actual Footage Location of Well: <b>2310</b> feet from the <b>S</b> line and <b>2310</b> feet from the <b>E</b> line					
Ground Level Elev. <b>3349 KB</b>	Producing Formation <b>Drinkard &amp; Wantz Granite Wash</b>		Pool <b>Drinkard, Granite Wash</b>		Dedicated Acreage: <b>40</b> Acres

1. Outline the acreage dedicated to the subject well by colored pencil or hachure marks on the plat below.
2. If more than one lease is dedicated to the well, outline each and identify the ownership thereof (both as to working interest and royalty).
3. If more than one lease of different ownership is dedicated to the well, have the interests of all owners been consolidated by communitization, unitization, force-pooling, etc?

☐ Yes    ☐ No    If answer is "yes," type of consolidation \_\_\_\_\_

If answer is "no," list the owners and tract descriptions which have actually been consolidated. (Use reverse side of this form if necessary.) \_\_\_\_\_

No allowable will be assigned to the well until all interests have been consolidated (by communitization, unitization, forced-pooling, or otherwise) or until a non-standard unit, eliminating such interests, has been approved by the Commission.

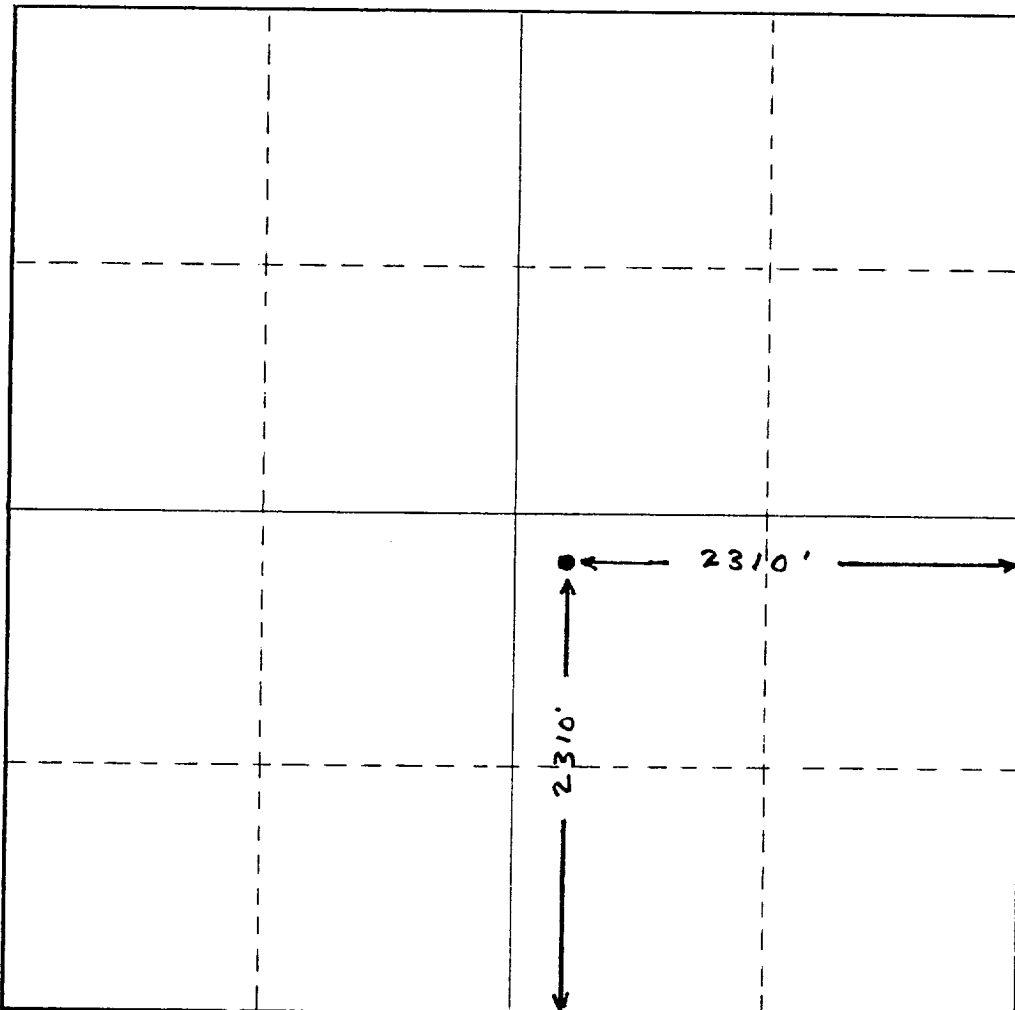

**CERTIFICATION**

*I hereby certify that the information contained herein is true and complete to the best of my knowledge and belief.*

**C. H. Allen**

Name

*C. H. Allen*

Position

**District Manager**

Company

**Sohio Petroleum Company**

Date

**May 5, 1983**

*I hereby certify that the well location shown on this plat was plotted from field notes of actual surveys made by me or under my supervision, and that the same is true and correct to the best of my knowledge and belief.*

Date Surveyed

Registered Professional Engineer  
and/or Land Surveyor

Certificate No.

