

District I  
PO Box 1988, Hobbs, NM 88241-1988  
District II  
PO Drawer DD, Artesia, NM 88211-8719  
District III  
1000 Rio Brazos Rd., Aztec, NM 87410  
District IV  
PO Box 2088, Santa Fe, NM 87504-2088

State of New Mexico  
Energy, Minerals & Natural Resources Department

OIL CONSERVATION DIVISION  
PO Box 2088  
Santa Fe, NM 87504-2088

Form C-102  
Revised February 10, 1994  
Instructions on back  
Submit to Appropriate District Office  
State Lease - 4 Copies  
Fee Lease - 3 Copies

☐ AMENDED REPORT

WELL LOCATION AND ACREAGE DEDICATION PLAT

API Number 30-025-10262	Pool Code 86440	Pool Name Tubb Oil & Gas
Property Code 2641	Property Name Hugh	Well Number 6
OGRID No. 4323	Operator Name Chevron USA Inc	Elevation

10 Surface Location

UL or lot no.	Section	Township	Range	Lot Ida	Feet from the	North/South line	Feet from the	East/West line	County
H	14	22S	37E		1980	North	760	East	Lea

11 Bottom Hole Location If Different From Surface

UL or lot no.	Section	Township	Range	Lot Ida	Feet from the	North/South line	Feet from the	East/West line	County

12 Ductile	13 Acres	14 Joint or Infill	15 Consolidation Code	16 Order No.
160		N		

NO ALLOWABLE WILL BE ASSIGNED TO THIS COMPLETION UNTIL ALL INTERESTS HAVE BEEN CONSOLIDATED  
OR A NON-STATUS HAS BEEN APPROVED BY THE DIVISION

16					1980' 760' #6	<b>7 OPERATOR CERTIFICATION</b> I hereby certify that the information contained herein is true and complete to the best of my knowledge and belief.  Signature L.V. Trautman Printed Name Sr Pet Eng Title 12/15/94 Date
						<b>11 SURVEYOR CERTIFICATION</b> I hereby certify that the well location shown on this plat was plotted from field notes of actual surveys made by me or under my supervision, and that the same is true and correct to the best of my belief.  Date of Survey Signature and Seal of Professional Surveyer:  Certificate Number

Submit to Appropriate  
District Office  
State Law - 4 copies  
Fee 1/2 min - 3 copies

State of New Mexico  
Energy, Minerals and Natural Resources Department

Form C-102  
Revised 1-1-89

# OIL CONSERVATION DIVISION

DISTRICT I  
P.O. Box 1980, Hobbs, NM 88240

DISTRICT II  
P.O. Drawer DD, Aramis, NM 88210

DISTRICT III  
1000 Rio Brazos Rd., Artes, NM 87410

P.O. Box 2088  
Santa Fe, New Mexico 87504-2088

## WELL LOCATION AND ACREAGE DEDICATION PLAT

All Distances must be from the outer boundaries of the section

Operator Chevron U.S.A., Inc.			Lease Hugh		Well No. 6
U.S. Letter H	Section 14	Township 22S	Range 37E	County NMFM Lea	
Actual Footage Location of Well: 1980 feet from the North line and 760 feet from the East line					
Ground level Elev. 3343'	Producing Formation Tubb		Pool Tubb Oil + GAS	Dedicated Acreage 40 Acres	

1. Outline the acreage dedicated to the subject well by colored pencil or hatchure marks on the plat below.

2. If more than one lease is dedicated to the well, outline each and identify the ownership thereof (both as to working interest and royalty).

3. If more than one lease of different ownership is dedicated to the well, have the interests of all owners been consolidated by communitization, unitization, force-pooling, etc.?

☐ Yes

☐ No

If answer is "yes" type of consolidation

If answer is "no" list the owners and tract descriptions which have actually been consolidated. (Use reverse side of this form if necessary.)

No allowable will be assigned to the well until all interests have been consolidated (by communitization, unitization, force-pooling, or otherwise) or until a non-standard unit, eliminating such interest, has been approved by the Division.

### OPERATOR CERTIFICATION

I hereby certify that the information contained herein is true and complete to the best of my knowledge and belief.

Signature

J. K. Ripley

Printed Name

J. K. Ripley

Position

T.A.

Company

Chevron U.S.A., Inc.

Date

11/29/93

### SURVEYOR CERTIFICATION

I hereby certify that the well location shown on this plat was plotted from field notes of actual surveys made by me or under my supervision, and that the same is true as correct to the best of my knowledge and belief.

Date Surveyed

Signature & Seal of  
Professional Surveyor

Certificate No.

NEW MEXICO OIL CONSERVATION COMMISSION  
WELL LOCATION AND ACREAGE DEDICATION PLAT

Form C-102  
Supersedes C-128  
Effective 1-1-65

All distances must be from the outer boundaries of the Section.

Operator <i>Gulf Oil Corp.</i>		Lease <i>Hugh</i>		Well No. <i>6</i>	
Unit Letter <i>H</i>	Section <i>14</i>	Township <i>22S</i>	Range <i>37E</i>	County <i>Lea</i>	
Actual Footage Location of Well: <i>1980</i> feet from the <i>North</i> line and <i>760</i> feet from the <i>East</i> line					
Ground Level Elev. <i>3343'</i>	Producing Formation <i>Blindburg</i>	Pool <i>Blindburg</i>	Dedicated Acreage: <i>40</i> Acres		

1. Outline the acreage dedicated to the subject well by colored pencil or hatchure marks on the plat below.
2. If more than one lease is dedicated to the well, outline each and identify the ownership thereof (both as to working interest and royalty).
3. If more than one lease of different ownership is dedicated to the well, have the interests of all owners been consolidated by communitization, unitization, force-pooling, etc?

☐ Yes ☐ No If answer is "yes," type of consolidation \_\_\_\_\_

If answer is "no," list the owners and tract descriptions which have actually been consolidated. (Use reverse side of this form if necessary.) \_\_\_\_\_

No allowable will be assigned to the well until all interests have been consolidated (by communitization, unitization, forced-pooling, or otherwise) or until a non-standard unit, eliminating such interests, has been approved by the Commission.

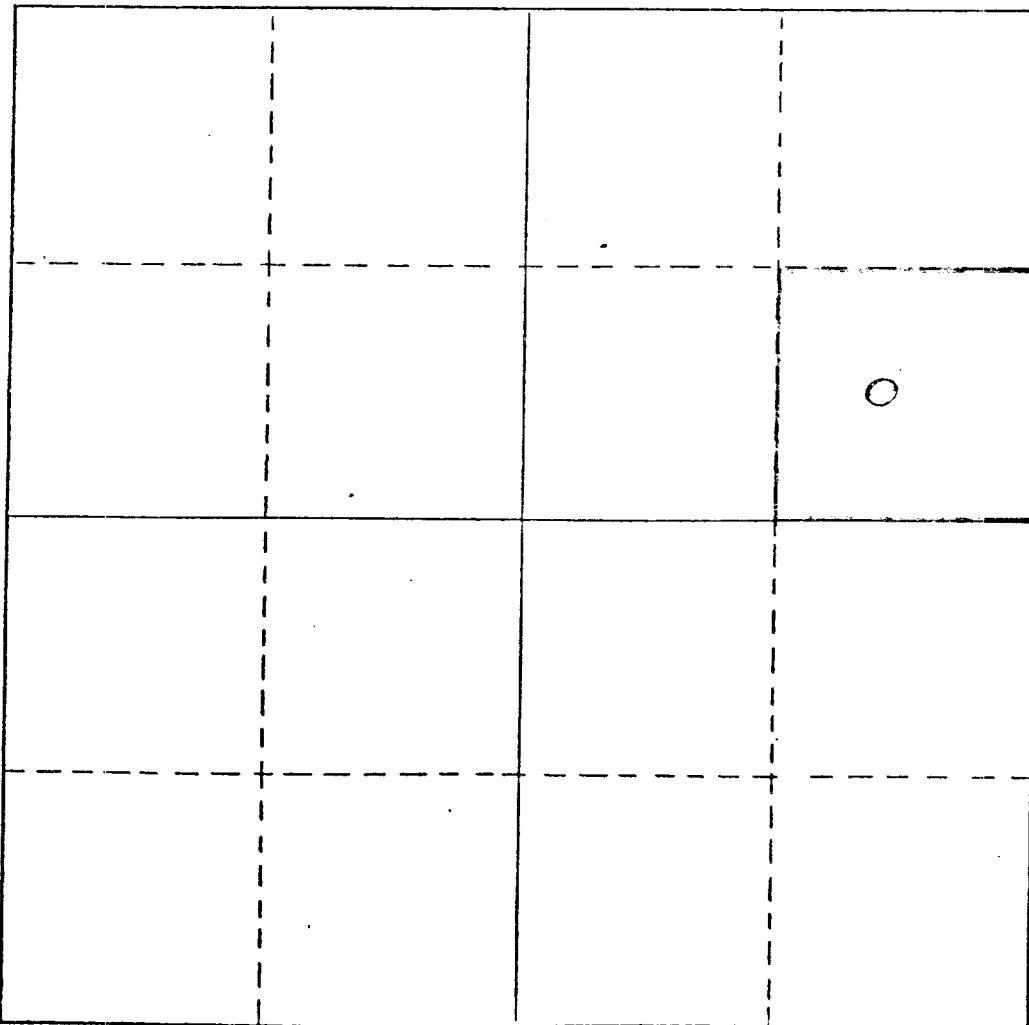

CERTIFICATION

I hereby certify that the information contained herein is true and complete to the best of my knowledge and belief.

*R.D. Pitre*

Name

*R.D. PITRE*

Position

*AREA ENGINEER*

Company

*GULF OIL CORP.*

Date

*5-20-85*

I hereby certify that the well location shown on this plat was plotted from field notes of actual surveys made by me or under my supervision, and that the same is true and correct to the best of my knowledge and belief.

Date Surveyed

Registered Professional Engineer and/or Land Surveyor

Certificate No.

0 330 660 990 1320 1650 1980 2310 2640 2970 3300 3630 3960 4290 4620 4950 5280 5610 5940 6270 6600

NEW MEXICO OIL CONSERVATION COMMISSION  
WELL LOCATION AND ACREAGE DEDICATION PLAT

Form C-102  
Supersedes C-128  
Effective 1-1-65

All distances must be from the outer boundaries of the Section.

Operator <i>Gulf Oil Corp.</i>			Lease <i>Hugh</i>		Well No. <i>6</i>
Unit Letter <i>H</i>	Section <i>14</i>	Township <i>22S</i>	Range <i>37E</i>	County <i>Lea</i>	
Actual Footage Location of Well: <i>1980</i> feet from the <i>North</i> line and <i>760</i> feet from the <i>East</i> line					
Ground Level Elev. <i>3343</i>	Producing Formation <i>Blinchury</i>		Pool <i>Blinchury Gas</i>	Dedicated Acreage: <i>120</i> Acres	

1. Outline the acreage dedicated to the subject well by colored pencil or hatchure marks on the plat below.
2. If more than one lease is dedicated to the well, outline each and identify the ownership thereof (both as to working interest and royalty).
3. If more than one lease of different ownership is dedicated to the well, have the interests of all owners been consolidated by communitization, unitization, force-pooling, etc?

☐ Yes ☐ No If answer is "yes," type of consolidation \_\_\_\_\_

If answer is "no," list the owners and tract descriptions which have actually been consolidated. (Use reverse side of this form if necessary.) \_\_\_\_\_

No allowable will be assigned to the well until all interests have been consolidated (by communitization, unitization, forced-pooling, or otherwise) or until a non-standard unit, eliminating such interests, has been approved by the Commission.

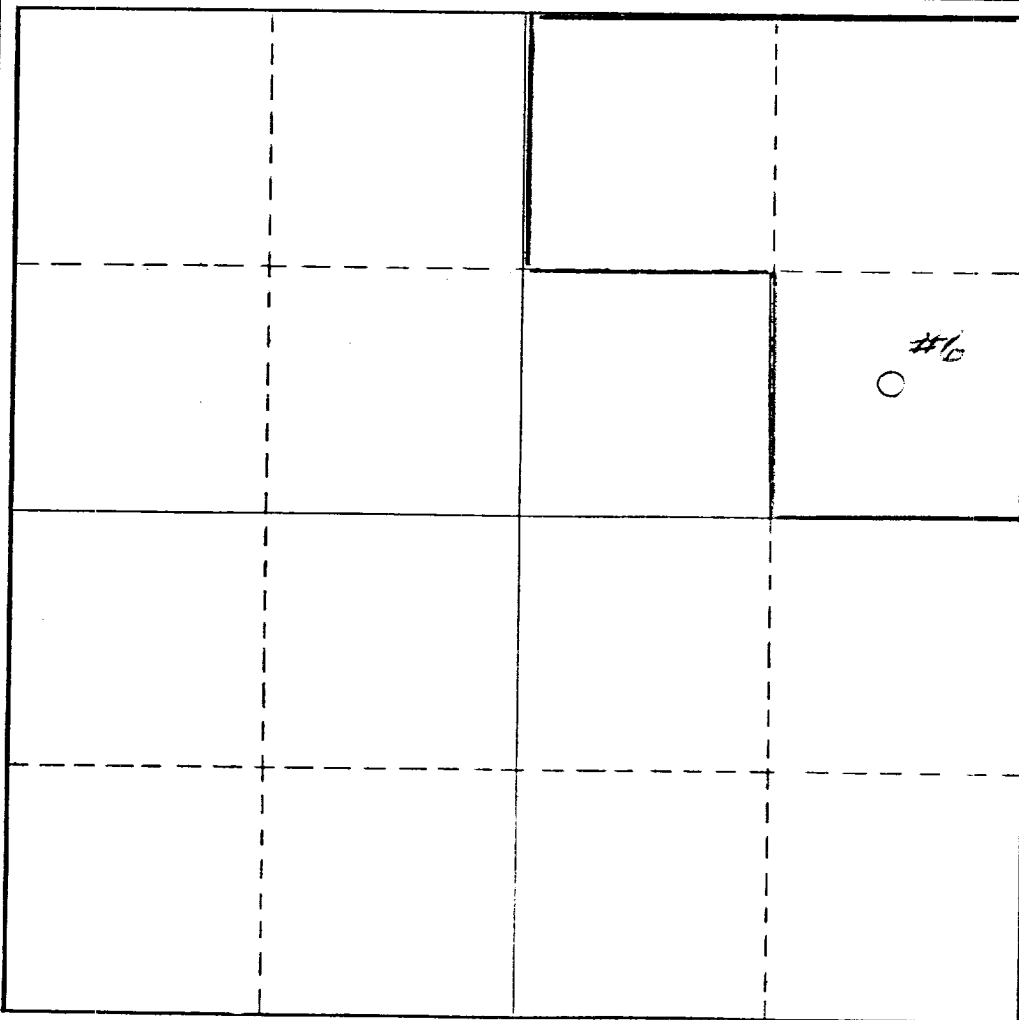

CERTIFICATION

I hereby certify that the information contained herein is true and complete to the best of my knowledge and belief.

*R.D. Pitre*

Name  
*R.D. PITRE*

Position  
*AREA ENGINEER*

Company  
*GULF OIL CORP*

Date  
*6-14-84*

I hereby certify that the well location shown on this plat was plotted from field notes of actual surveys made by me or under my supervision, and that the same is true and correct to the best of my knowledge and belief.

Date Surveyed

Registered Professional Engineer and/or Land Surveyor

Certificate No.



NUMBER OF COPIES RECEIVED	
DISTRIBUTION	
SANTA FE	
FILE	
U.S.G.S.	
LAND OFFICE	
TRANSPORTER	OIL GAS
PRODUCTION OFFICE	
OPERATOR	

# NEW MEXICO OIL CONSERVATION COMMISSION

FORM C-128  
Revised 5/1/57

## WELL LOCATION AND ACREAGE DEDICATION PLAT

SEE INSTRUCTIONS FOR COMPLETING THIS FORM ON THE REVERSE SIDE

HOBBS OFFICE O.C.C.  
APR 20 3 55 PM '64

### SECTION A

Operator <b>Gulf Oil Corporation</b>		Lease <b>Hugh</b>		Well No. <b>6</b>	
Unit Letter <b>H</b>	Section <b>14</b>	Township <b>22-S</b>	Range <b>37-E</b>	County <b>Lea</b>	
Actual Footage Location of Well: <b>1980</b> feet from the <b>North</b> line and <b>760</b> feet from the <b>East</b> line					
Ground Level Elev. <b>3343</b>	Producing Formation <b>Blinebry</b>		Pool <b>Blinebry Gas</b>		Dedicated Acreage: <b>160</b> Acres

1. Is the Operator the only owner in the dedicated acreage outlined on the plat below? YES ☒ NO \_\_\_\_ . ("Owner" means the person who has the right to drill into and to produce from any pool and to appropriate the production either for himself or for himself and another. (65-3-29 (e) NMSA 1935 Comp.)
2. If the answer to question one is "no," have the interests of all the owners been consolidated by communitization agreement or otherwise? YES \_\_\_\_ NO \_\_\_\_ . If answer is "yes," Type of Consolidation \_\_\_\_\_
3. If the answer to question two is "no," list all the owners and their respective interests below:

Owner	Land Description
<b>Acreage increase due to well No. 4 being reclassified as Blinebry <del>oil</del> Gas</b>	

### SECTION B

### CERTIFICATION

I hereby certify that the information in SECTION A above is true and complete to the best of my knowledge and belief.

Name	ORIGINAL SIGNED BY <b>W. D. BOHANNON</b>
Position	<b>Area Production Manager</b>
Company	<b>Gulf Oil Corporation</b>
Date	<b>April 17, 1964</b>

I hereby certify that the well location shown on the plat in SECTION B was plotted from field notes of actual surveys made by me or under my supervision, and that the same is true and correct to the best of my knowledge and belief.

Date Surveyed
Registered Professional Engineer and/or Land Surveyor

Certificate No.

0 330 660 990 1320 1650 1980 2310 2640 2000 1500 1000 500 0

## INSTRUCTIONS FOR COMPLETION OF FORM C-128

1. Operator shall furnish and certify to the information called for in Section A.
2. Operator shall outline the dedicated acreage for *both* oil and gas wells on the plat in Section B.
3. A registered professional engineer or land surveyor registered in the State of New Mexico or approved by the Commission shall show on the plat the location of the well and certify this information in the space provided.
4. All distances shown on the plat must be from the outer boundaries of the Section.
5. If additional space is needed for listing owners and their respective interests as required in question 3 of Section A, please use space below.

NUMBER OF COPIES RECEIVED	
DISTRIBUTION	
SANTA FE	
FILE	
U.S.G.S.	
LAND OFFICE	
TRANSPORTER	OIL
	GAS
PRODUCTION OFFICE	
OPERATOR	

**NEW MEXICO OIL CONSERVATION COMMISSION**  
**WELL LOCATION AND ACREAGE DEDICATION PLAT**  
 SEE INSTRUCTIONS FOR COMPLETING THIS FORM ON THE REVERSE SIDE

FORM C-128  
 Revised 5/1/57

<b>SECTION A</b>				
Operator <b>Gulf Oil Corporation</b>		Lease <b>High</b>		Well No. <b>6</b>
Unit Letter <b>H</b>	Section <b>14</b>	Township <b>22S</b>	Range <b>37E</b>	County <b>Lea</b>
Actual Footage Location of Well: <b>1980</b> feet from the <b>north</b> line and <b>760</b> feet from the <b>east</b> line				
Ground Level Elev. <b>3340</b>	Producing Formation <b>Hilobry</b>	Pool <b>Hilobry Gas</b>	Dedicated Acreage: <b>120</b> Acres	

1. Is the Operator the only owner in the dedicated acreage outlined on the plat below? YES ☒ NO \_\_\_\_ . ("Owner" means the person who has the right to drill into and to produce from any pool and to appropriate the production either for himself or for himself and another. (65-3-29 (e) NMSA 1935 Comp.)
2. If the answer to question one is "no," have the interests of all the owners been consolidated by communitization agreement or otherwise? YES \_\_\_\_ NO \_\_\_\_ . If answer is "yes," Type of Consolidation \_\_\_\_\_
3. If the answer to question two is "no," list all the owners and their respective interests below:

Owner	Land Description

**SECTION B**

**CERTIFICATION**

I hereby certify that the information in SECTION A above is true and complete to the best of my knowledge and belief.

Name <b>[Signature]</b>
Position <b>Area Production Manager</b>
Company <b>Gulf Oil Corporation</b>
Date <b>July 24, 1963</b>

I hereby certify that the well location shown on the plat in SECTION B was plotted from field notes of actual surveys made by me or under my supervision, and that the same is true and correct to the best of my knowledge and belief.

Date Surveyed
Registered Professional Engineer and/or Land Surveyor

Certificate No.
-----------------

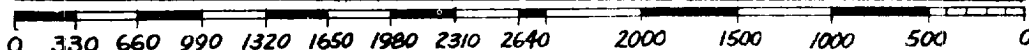

## INSTRUCTIONS FOR COMPLETION OF FORM C-128

1. Operator shall furnish and certify to the information called for in Section A.
2. Operator shall outline the dedicated acreage for *both* oil and gas wells on the plat in Section B.
3. A registered professional engineer or land surveyor registered in the State of New Mexico or approved by the Commission shall show on the plat the location of the well and certify this information in the space provided.
4. All distances shown on the plat must be from the outer boundaries of the Section.
5. If additional space is needed for listing owners and their respective interests as required in question 3 of Section A, please use space below.



NEW MEXICO  
OIL CONSERVATION COMMISSION

Form C-128

Well Location and/or Gas Proration Plat

Date 1-3-56

Operator Gulf Oil Corporation Lease Hugh

Well No. 6 Section 14 Township 22-S Range 37-E NMPM

Located 1980' Feet From North Line, 760' Feet From East Line,

Lea County, New Mexico. G. L. Elevation 3343'

Name of Producing Formation Blinebry Pool Blinebry Gas Dedicated Acreage 160

(Note: All distances must be from outer boundaries of Section)

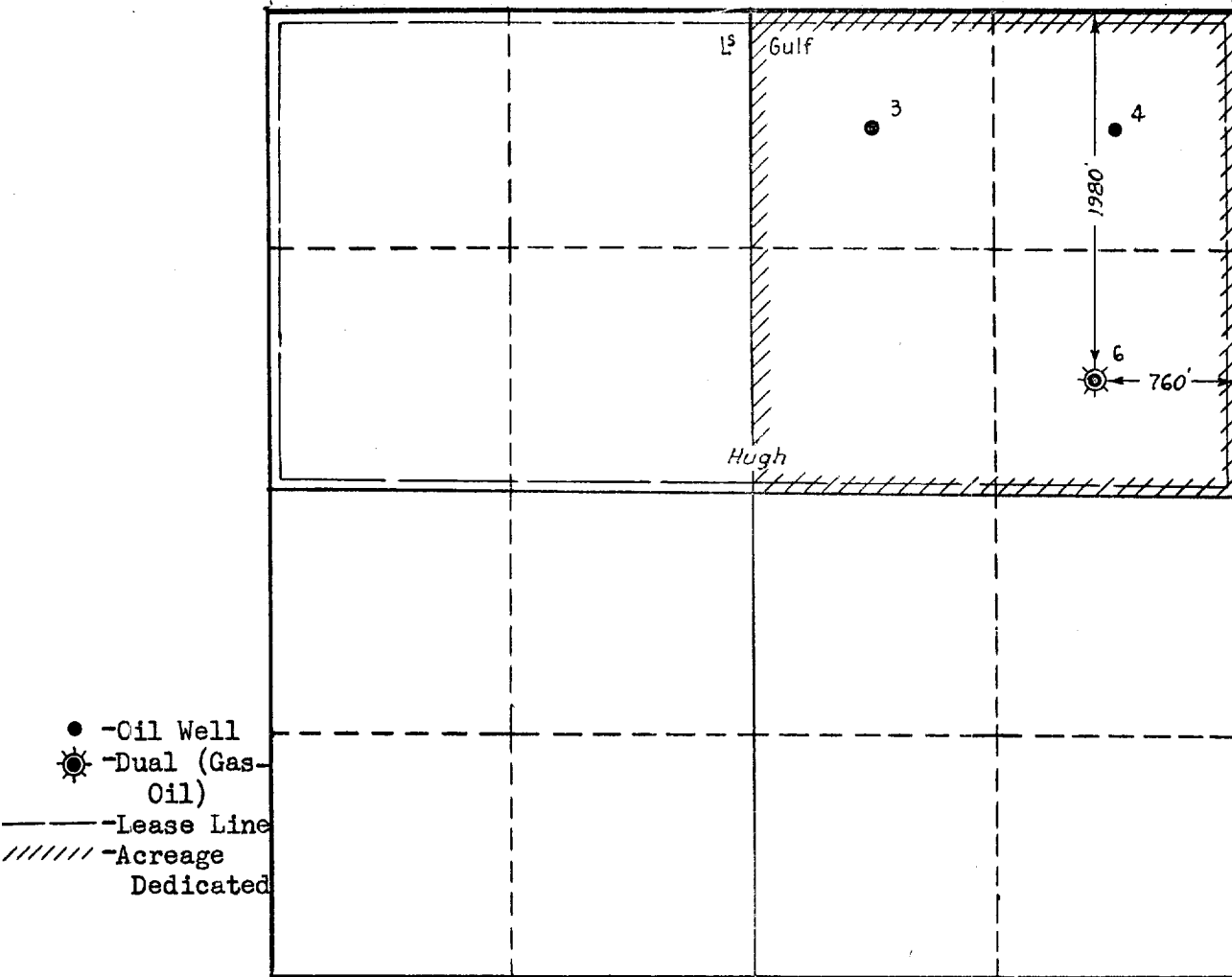

1. Is this Well a Dual Comp. ? Yes X No
2. If the answer to Question 1 is yes, are there any other dually completed wells within the dedicated acreage? Yes     No X

Name J. R. Sherman J. R. Sherman  
Position Division Gas Engineer  
Representing Gulf Oil Corporation  
Address PO. Box 1290, Fort Worth 1, Texas

This is to certify that the above plat was prepared from field notes of actual surveys made by me or under my supervision and that the same are true and correct to the best of my knowledge and belief.

Date Surveyed                       
                      
Registered Professional Engineer and/or  
Land Surveyor