

NEW MEXICO OIL CONSERVATION COMMISSION

Well Location and Acreage Dedication Plat

HOBBS OFFICE OCC

Section A.

Date 7-21-60

Operator Humble Oil & Refining Co. Lease New Mexico State 1960 JUL 23 PM 2:35
Well No. 24 Unit Letter "O" Section 19 Township 22-S Range 37-E NMPM
Located 660 Feet From South Line, 1980 Feet From East Line
County Lea G. L. Elevation Later Dedicated Acreage 40 Acres
Name of Producing Formation Queen Pool Langlic-Mattix

1. Is the Operator the only owner* in the dedicated acreage outlined on the plat below?
Yes ✓ No _____
2. If the answer to question one is "no", have the interests of all the owners been consolidated by communitization agreement or otherwise? Yes _____ No _____ If answer is "yes," Type of Consolidation _____
3. If the answer to question two is "no," list all the owners and thier respective interests below:

Owner

Land Description

Section B

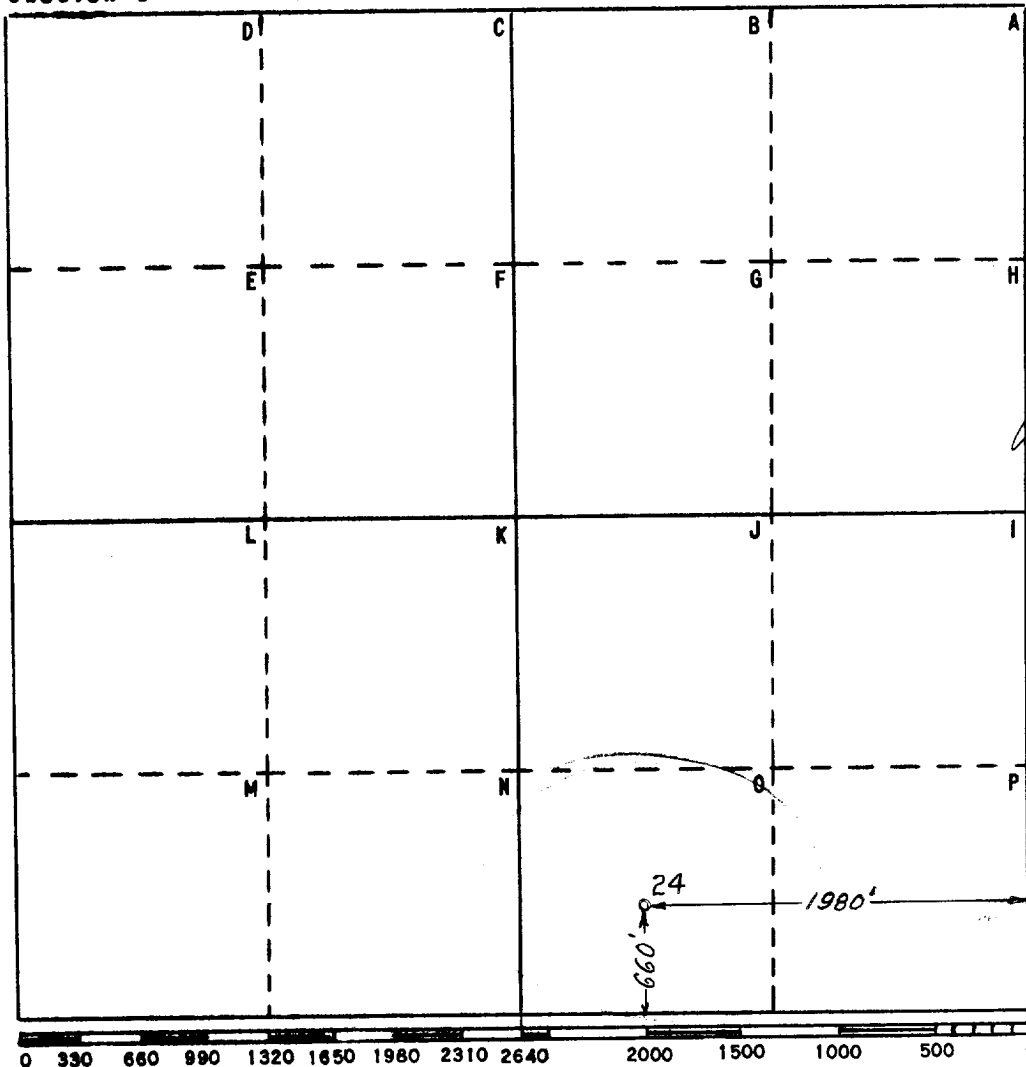

This is to certify that the information in Section A above is true and complete to the best of my knowledge and belief

HUMBLE OIL & REFG. CO.

(Operator)

J. S. Baldock
(Representative)

Box 1600 Midland, Texas
Address

This is to certify that the well location shown on the plat in Section B was plotted from field notes of actual surveys made by me or under my supervision and that the same is true and correct to the best of my knowledge and belief.

Date Surveyed 7-20-66

W. S. Hunterfield
Registered Professional
Engineer and/or Land Surveyor

Certificate No. 1382

FILE NO. W-A-7432