

Well Location and Acreage Dedication Plat

HOBBS OFFICE OCC
Date 5-17-61

Section A.

Operator Humble Oil & Refining Co. Lease New Mexico State M
Well No. 42 Unit Letter "E" Section 19 Township 22-S Range 37-E NMPM
Located 1650 Feet From North Line, 892 Feet From West Line
County Lea G. L. Elevation Later Dedicated Acreage 40 Acres
Name of Producing Formation Queen Pool Lungo - Matrix

1. Is the Operator the only owner* in the dedicated acreage outlined on the plat below?
Yes ✓ No
2. If the answer to question one is "no", have the interests of all the owners been consolidated by communitization agreement or otherwise? Yes No If answer is "yes," Type of Consolidation
3. If the answer to question two is "no," list all the owners and thier respective interests below:

Owner Land Description

Section B

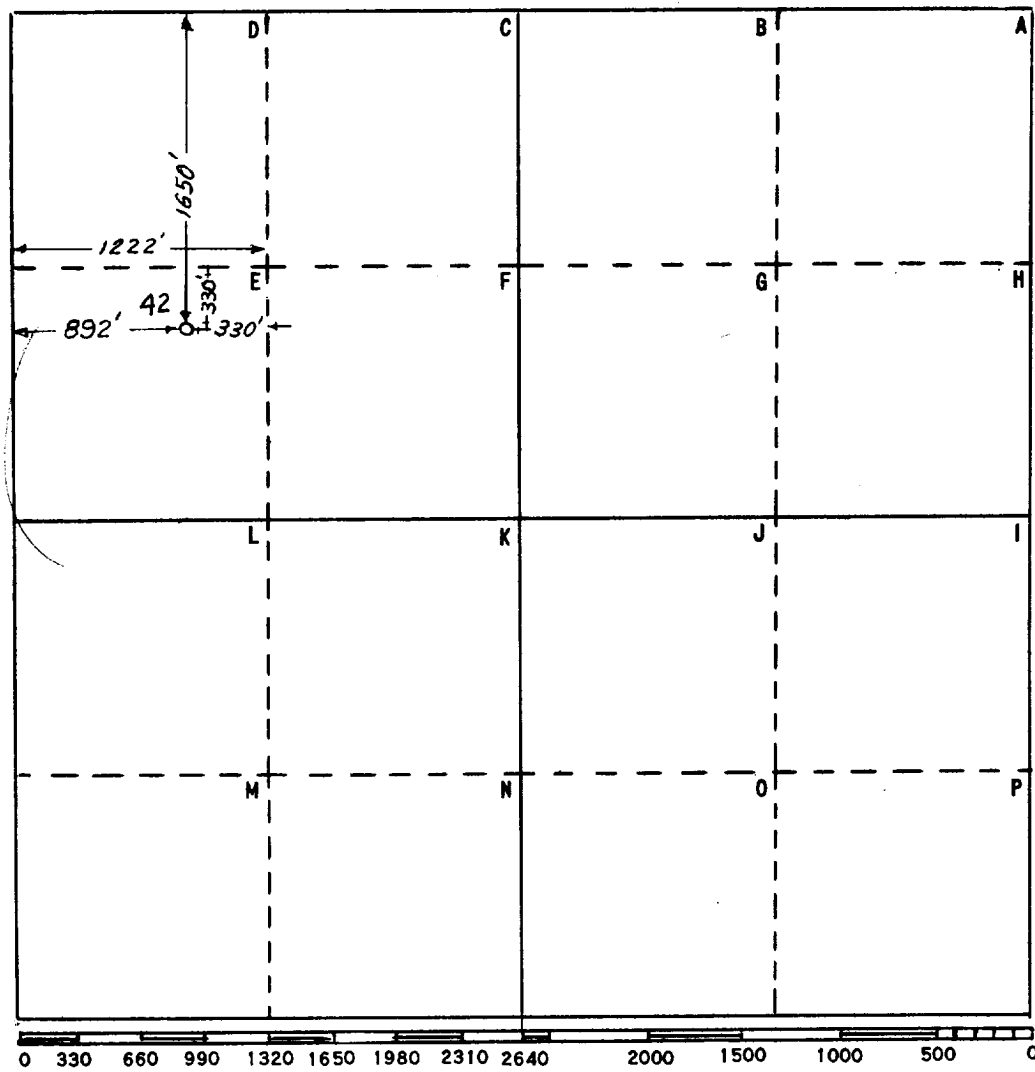

This is to certify that the information in Section A above is true and complete to the best of my knowledge and belief

HUMBLE OIL & REFG. CO.
(Operator)
Henry P. Meadows
(Representative)
Box 1600 Midland, Texas
Address

This is to certify that the well location shown on the plat in Section B was plotted from field notes of actual surveys made by me or under my supervision and that the same is true and correct to the best of my knowledge and belief.

Date Surveyed 5-12-61
H. S. Hesterfield
Registered Professional Engineer and/or Land Surveyor
Certificate No. 1382