

INSTRUCTIONS FOR COMPLETION.

1. Operator shall furnish and certify to the information called for in Section A.
2. Operator shall outline the dedicated acreage for both oil and gas wells on the plat in Section B.
3. A registered professional engineer or land surveyor registered in the State of New Mexico or approved by the Commission shall show on the plat the location of the well and certify this information in the space provided.
4. All distances shown on the plat must be from the outer boundaries of Section.
5. If additional space is needed for listing owners and their respective interests as required in question 3, Section A, please use space below

* "Owner" means the person who has the right to drill into and to produce from any pool and to appropriate the production either for himself or for himself and another. (65-3-29 (e) NMSA 1953 Comp.)

153 MAR 17 AM 9 35

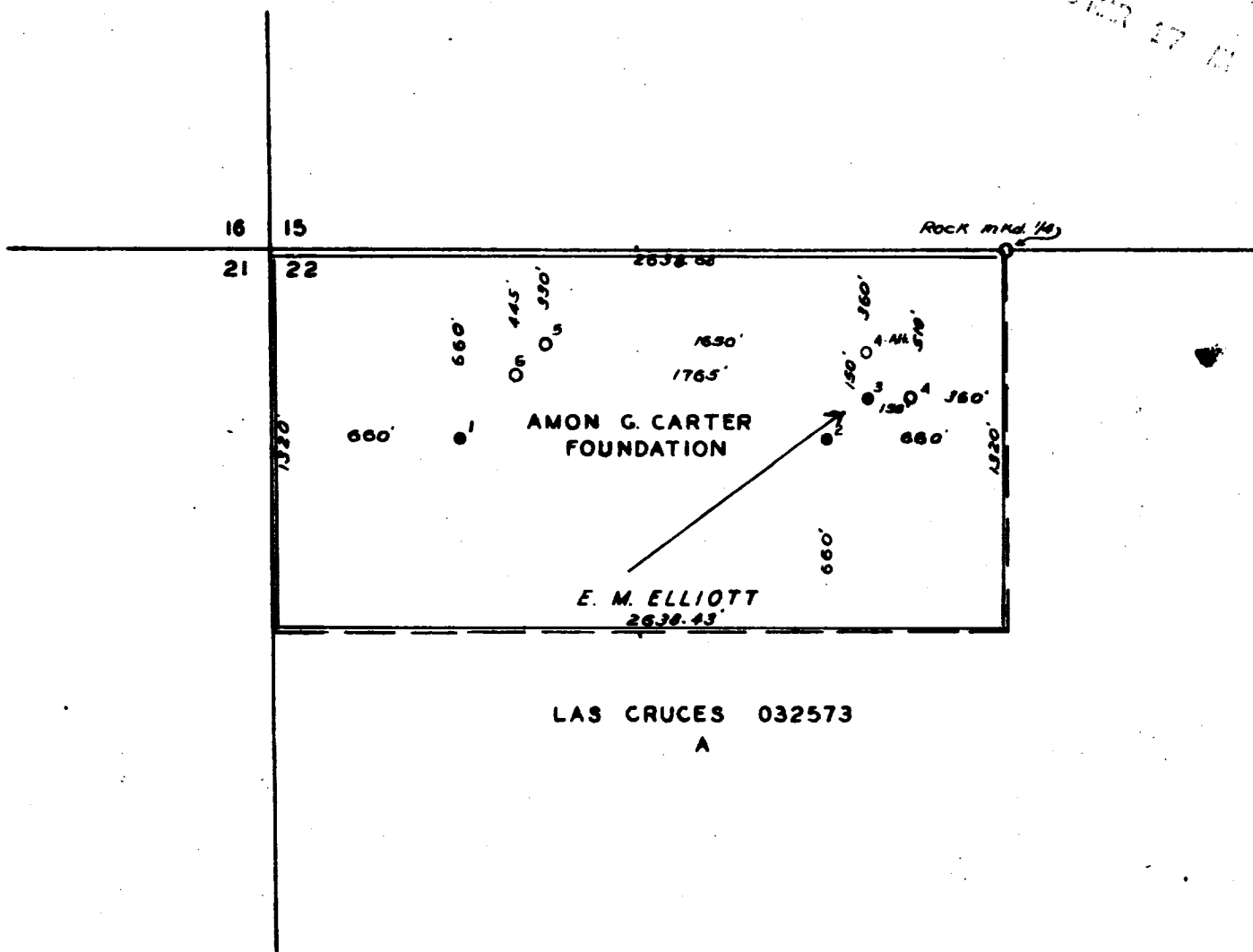

I, H. F. Johnson, hereby certify above
survey was made by me and is correct.

H. F. Johnson
License No. 918



AMON G. CARTER FOUNDATION
E. M. ELLIOTT LEASE
N/2 NW/4 SECTION 22
T-22-S R-37-E
LEA COUNTY, NEW MEXICO
SCALE: 1" = 600'