

NEW MEXICO
OIL CONSERVATION COMMISSION

CORRECTED

Form C-128

Well Location and/or Gas Proration Plat

Date 8-28-56

Operator Gulf Oil Corporation Lease O. I. Boyd

Well No. 3 Section 23 Township 22-S Range 37-E NMPM

Located 1980 Feet From South Line, 1980 Feet From West Line,

Lea County, New Mexico. G. L. Elevation 3330'

Name of Producing Formation Blinebry Pool Blinebry Gas Dedicated Acreage 160

(Note: All distances must be from outer boundaries of Section)

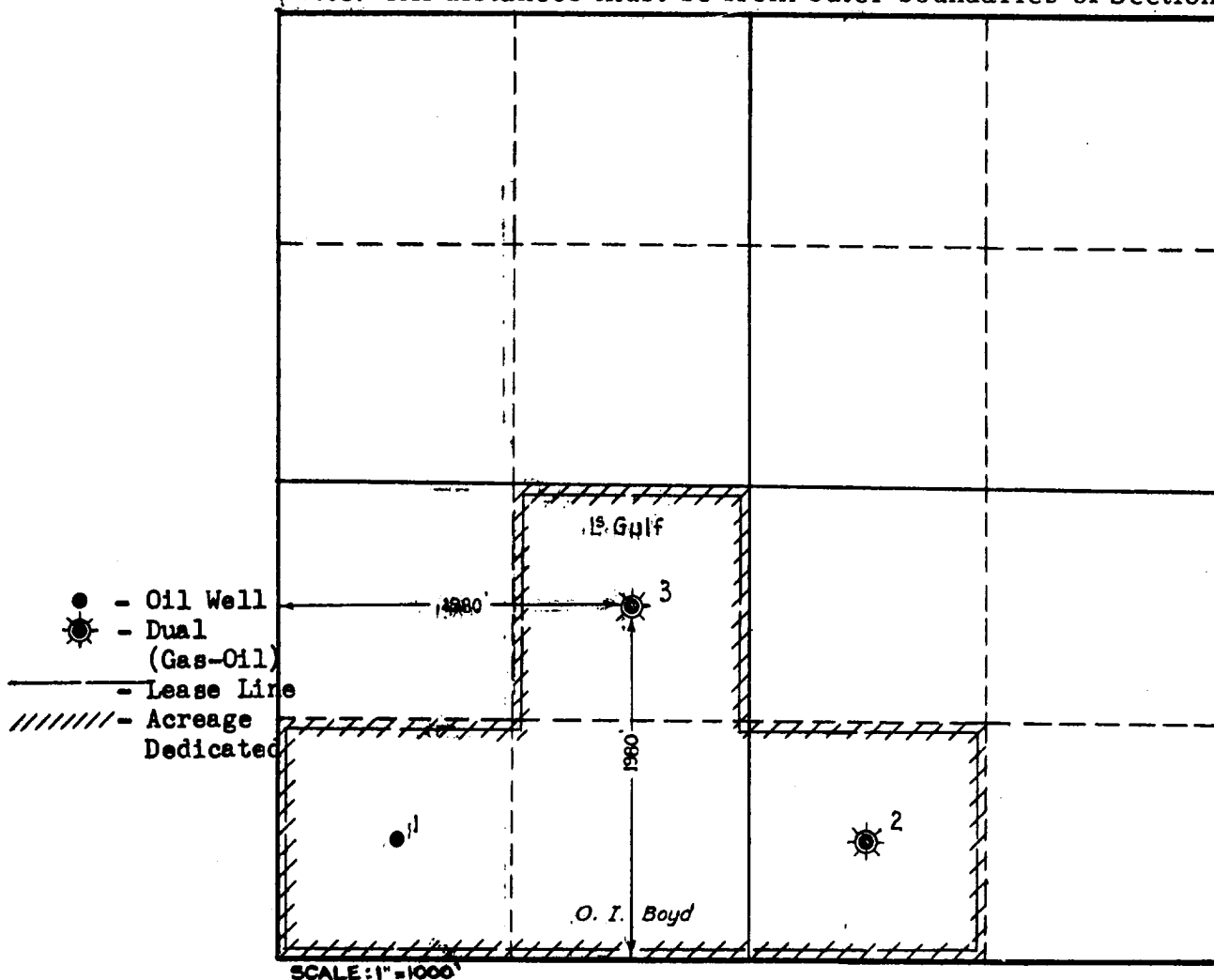

1. Is this Well a Dual Comp. ? Yes x No
2. If the answer to Question 1 is yes, are there any other dually completed wells within the dedicated acreage? Yes x NO Tubb Gas.

This is to certify that the above plat was prepared from field notes of actual surveys made by me or under my supervision and that the same are true and correct to the best of my knowledge and belief.

Name J. R. Sherman J. R. Sherman
Position Division Gas Engineer
Representing Gulf Oil Corporation
Address P. O. Box 1290, Fort Worth 1, Texas

Date Surveyed
Registered Professional Engineer and/or
Land Surveyor