

NEW MEXICO  
OIL CONSERVATION COMMISSION  
Gas Well Plat

Date 2-17-54

Gulf Oil Corporation Amenda 1

Operator Amenda Lease 1 Well No. 1

Name of Producing Formation Tubb Pool Tubb Gas

No. Acres Dedicated to the Well 120

SECTION 25 TOWNSHIP 22S RANGE 37E

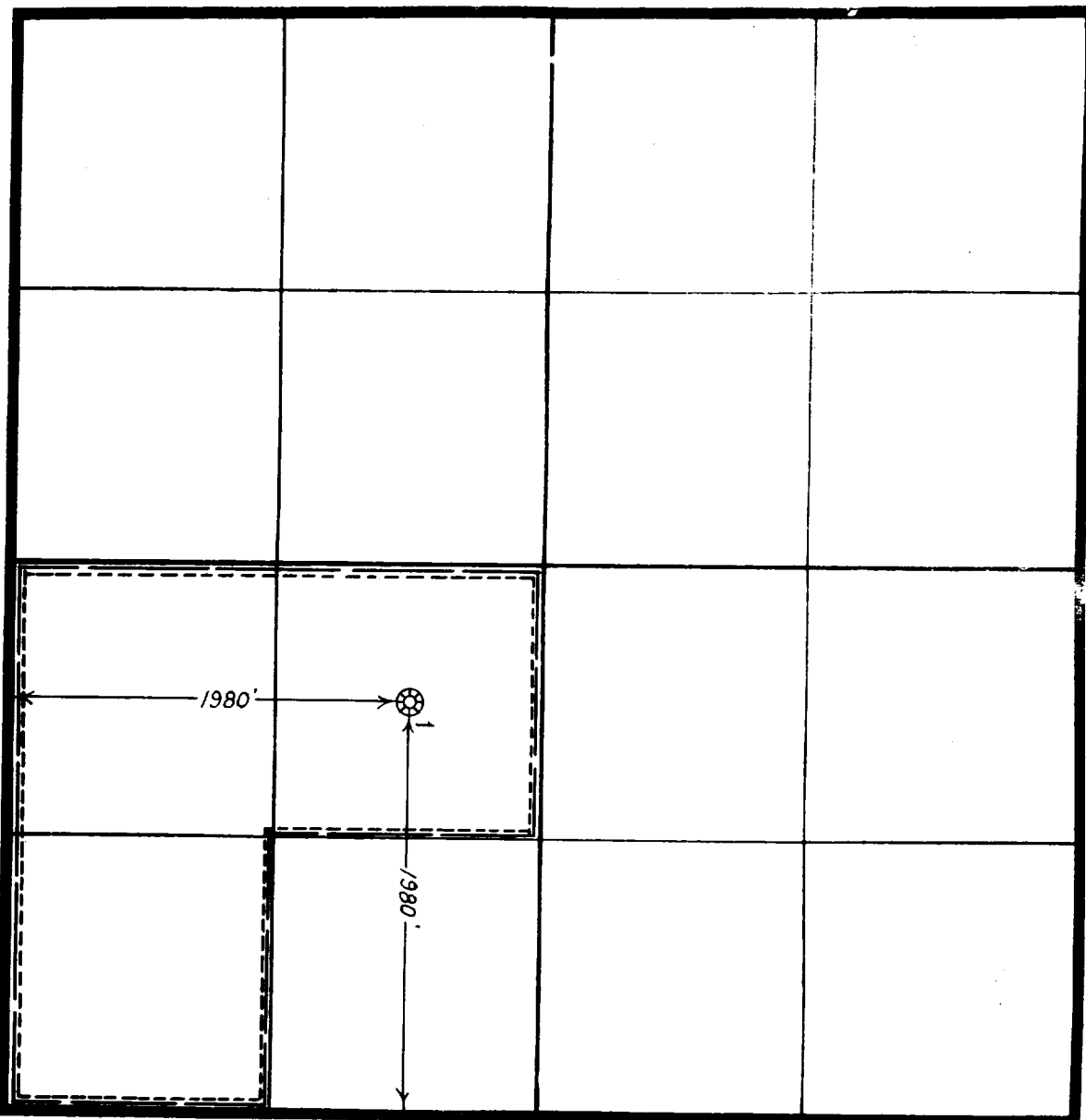

I hereby certify that the information given above is true and complete to the best of my knowledge.

- Ⓢ - Dual (Gas-Gas)  
- Lease Line  
- Acreage Dedicated

Name Will R. Rhodes T. M. Rhodes  
Position Div. Gas-Gasoline Supervisor  
Representing Gulf Oil Corporation  
Address P. O. Box 1290, Fort Worth, Texas

(over)

INSTRUCTIONS

1. Is this gas well a dual completion? Yes X No
2. If the answer to Question 1 is Yes, are there any other dually completed wells within the dedicated acreage? Yes    No X

A separate plat must be filed for each gas well, outlining the area dedicated to such well and showing the location of all other wells (oil and gas) within the outlined area.

Mail in duplicate to the district office for the district in which the well is located.