

Submit to Appropriate  
District Office  
State Lease - 6 copies  
Fee Lease - 5 copies

State of New Mexico  
Energy, Minerals and Natural Resources Department

Form C-101  
Revised 1-1-89

DISTRICT I  
P.O. Box 1980, Hobbs, NM 88240

DISTRICT II  
P.O. Drawer DD, Artesia, NM 88210

DISTRICT III  
1000 Rio Brazos Rd., Aztec, NM 87410

OIL CONSERVATION DIVISION

P.O. Box 2088  
Santa Fe, New Mexico 87504-2088

API NO. (assigned by OCD on New Wells)
5. Indicate Type of Lease STATE <input type="checkbox"/> FEE <input checked="" type="checkbox"/>
6. State Oil & Gas Lease No.
7. Lease Name or Unit Agreement Name Gulf Sims
8. Well No. #1
9. Pool name or Wildcat Blinebry Oil & Gas

APPLICATION FOR PERMIT TO DRILL, DEEPEN, OR PLUG BACK					
1a. Type of Work:					
b. Type of Well: DRILL <input type="checkbox"/> RE-ENTER <input type="checkbox"/> DEEPEN <input type="checkbox"/> PLUG BACK <input checked="" type="checkbox"/>					
OIL WELL <input checked="" type="checkbox"/> GAS WELL <input type="checkbox"/> OTHER <input type="checkbox"/> SINGLE ZONE <input checked="" type="checkbox"/> MULTIPLE ZONE <input type="checkbox"/>					
2. Name of Operator Chevron U.S.A. Inc.					
3. Address of Operator P.O. Box 670, Hobbs, NM 88240					
4. Well Location Unit Letter P : 660 Feet From The East Line and 990 Feet From The South Line					
Section 25 Township 22S Range 37E NMPM Lea Country					
10. Proposed Depth NC					
11. Formation Blinebry Oil & Gas					
12. Rotary or C.T.					
13. Elevations (Show whether DF, RT, GR, etc.) 3324					
14. Kind & Status Plug Bond					
15. Drilling Contractor NYK					
16. Approx. Date Work will start ASAP					
17. No change in csg.					
PROPOSED CASING AND CEMENT PROGRAM					
SIZE OF HOLE	SIZE OF CASING	WEIGHT PER FOOT	SETTING DEPTH	SACKS OF CEMENT	EST. TOP
17 1/4	13 3/8		205	200sx	
12 1/4	8 5/8		2798	950sx	
7 7/8	5 1/2		7025	550sx	

It is proposed to recomplete subject well in the Blinebry Oil & Gas as follows:  
Set CIBP @  $\pm$  6230 and cap w/35' cmt. RIH w/treating pkr. Test CIBP to 500psi.  
Tst csg to 500psi. If csg does not test, locate leak and squeeze. Drill out and  
test to 500psi. Perf Blinebry at 5607, 13, 16, 24, 28, 32, 80, 91, 5712, 29, 73,  
and 78 @ 1 JHPF (12 holes total). RIH w/trtg pkr, test to 6500psi. Set pkr at  $\pm$   
5550. Load BS w/8.6 CKF. Acidize perfs 5607-5778 w/3000 gallons 15% NEFE HCL.  
Swab back. Frac perfs 5607-5778 w/28,700 gallons 40# XL gel, and 66,500 # 20-40  
sand. Flow/swab back. Clean out sand. Tube per foreman's recommendation. Place  
on production and test.

IN ABOVE SPACE DESCRIBE PROPOSED PROGRAM: IF PROPOSAL IS TO DEEPEN OR PLUG BACK, GIVE DATA ON PRESENT PRODUCTIVE ZONE AND PROPOSED NEW PRODUCTIVE ZONE. GIVE BLOWOUT PREVENTER PROGRAM, IF ANY.

I hereby certify that the information above is true and complete to the best of my knowledge and belief.

SIGNATURE L. K. Elmore TITLE Technical Assistant DATE 2-17-89

TYPE OR PRINT NAME

TELEPHONE NO.

(This space for State Use)

ORIGINAL SIGNED BY JERRY SEXTON  
DISTRICT I SUPERVISOR

APPROVED BY \_\_\_\_\_ TITLE \_\_\_\_\_ DATE \_\_\_\_\_

CONDITIONS OF APPROVAL, IF ANY:

FEB 23 1989

Permit Expires 6 Months From Approval  
Date Unless Drilling Underway.

workover

9801 8 S G-1

RECEIVED  
FEB 22 1989  
OCD  
HOBBS OFFICE

# OIL CONSERVATION DIVISION

P.O. Box 2088  
Santa Fe, New Mexico 87504-2088

DISTRICT I  
P.O. Box 1980, Hobbs, NM 88240

DISTRICT II  
P.O. Drawer DD, Artesia, NM 88210

DISTRICT III  
1000 Rio Brazos Rd., Aztec, NM 87410

## WELL LOCATION AND ACREAGE DEDICATION PLAT

All Distances must be from the outer boundaries of the section

Operator <b>Chevron U.S.A. Inc.</b>			Lease <b>Gulf Sims</b>		Well No. <b>1</b>
Unit Letter <b>P</b>	Section <b>25</b>	Township <b>22S</b>	Range <b>37E</b>	County <b>NMPM Lea</b>	
Actual Footage Location of Well: <b>660</b> feet from the <b>East</b> line and <b>990</b> feet from the <b>South</b> line					
Ground level Elev. <b>3324</b>	Producing Formation <b>Blinebry</b>		Pool <b>Blinebry Oil &amp; Gas</b>		Dedicated Acreage: <b>40</b> Acres

- Outline the acreage dedicated to the subject well by colored pencil or hatchure marks on the plat below.
- If more than one lease is dedicated to the well, outline each and identify the ownership thereof (both as to working interest and royalty).
- If more than one lease of different ownership is dedicated to the well, have the interest of all owners been consolidated by communitization, unitization, force-pooling, etc.?  
☐ Yes ☒ No If answer is "yes" type of consolidation \_\_\_\_\_  
If answer is "no" list the owners and tract descriptions which have actually been consolidated. (Use reverse side of this form if necessary). \_\_\_\_\_  
No allowable will be assigned to the well until all interests have been consolidated (by communitization, unitization, forced-pooling, or otherwise) or until a non-standard unit, eliminating such interest, has been approved by the Division.

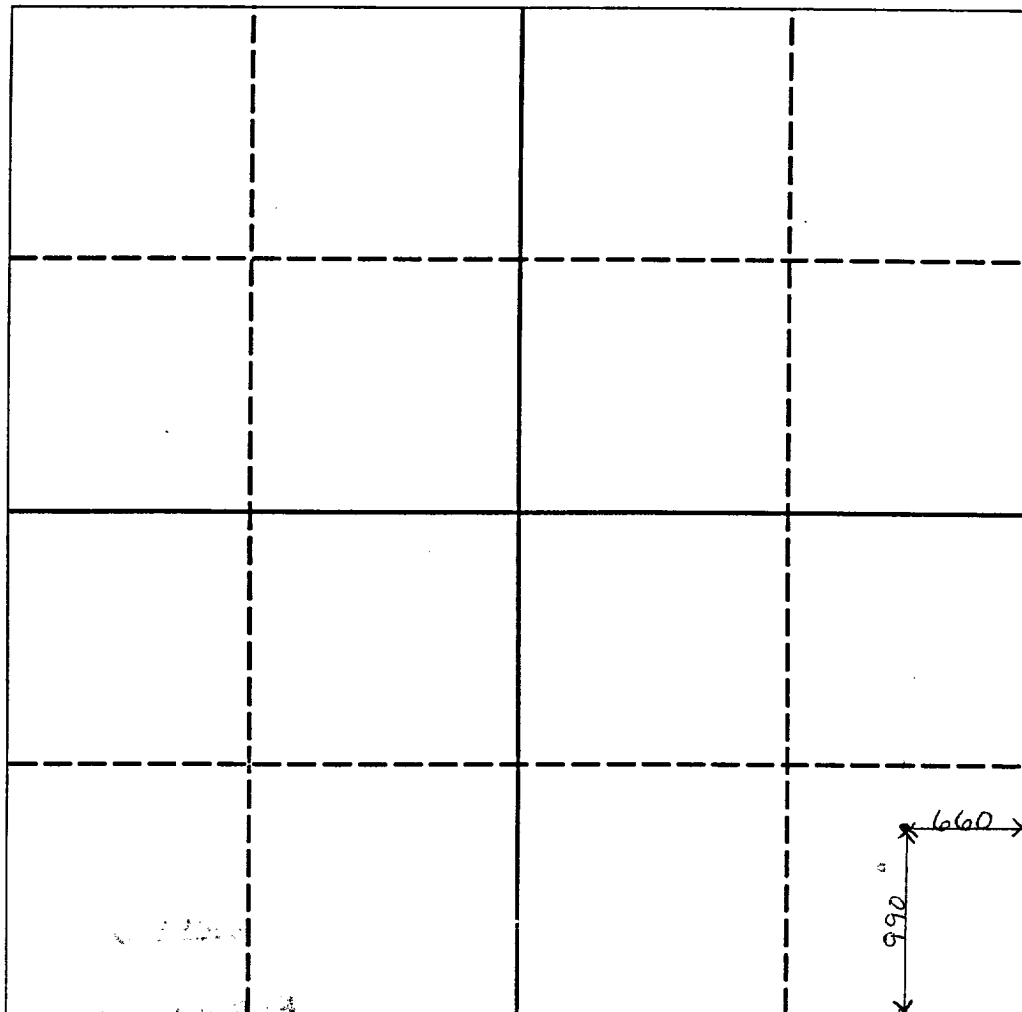

### OPERATOR CERTIFICATION

I hereby certify that the information contained herein is true and complete to the best of my knowledge and belief.

*L. K. Elmore*  
Signature

**L. K. Elmore**  
Printed Name

**Technical Asst./Drig.**  
Position

**Chevron U.S.A. Inc.**  
Company

**2/17/89**  
Date

### SURVEYOR CERTIFICATION

I hereby certify that the well location shown on this plat was plotted from field notes of actual surveys made by me or under my supervision, and that the same is true and correct to the best of my knowledge and belief.

Date Surveyed

Signature & Seal of  
Professional Surveyor

*see original  
plat*

Certificate No.

0 330 660 990 1320 1650 1980 2310 2640 2000 1500 1000 500 0

RECEIVED

FEB 22 1989

OCD  
HOBBS OFFICE