

Well Location and Acreage Dedication Plat

Section A.

HOBBS OFFICE OCC
Date 1-20-60 Rev. 2-4-60

Operator HUMBLE OIL & REFG. CO Lease New Mexico State 3143
Well No. 20 Unit Letter "F" Section 29 Township 22-5 Range 37-E NMP
Located 1930 Feet From North Line, 1980 Feet From West Line
County Lea G. L. Elevation - Dedicated Acreage 40 Acres
Name of Producing Formation Lower Clearfork Pool Langlie Mattix - Unders. Drinkard

1. Is the Operator the only owner* in the dedicated acreage outlined on the plat below?
Yes ☒ No ☐.
2. If the answer to question one is "no," have the interests of all the owners been consolidated by communitization agreement or otherwise? Yes ☐ No ☐. If answer is "yes," Type of Consolidation _____
3. If the answer to question two is "no," list all the owners and their respective interests below:

Owner

Land Description

Section B

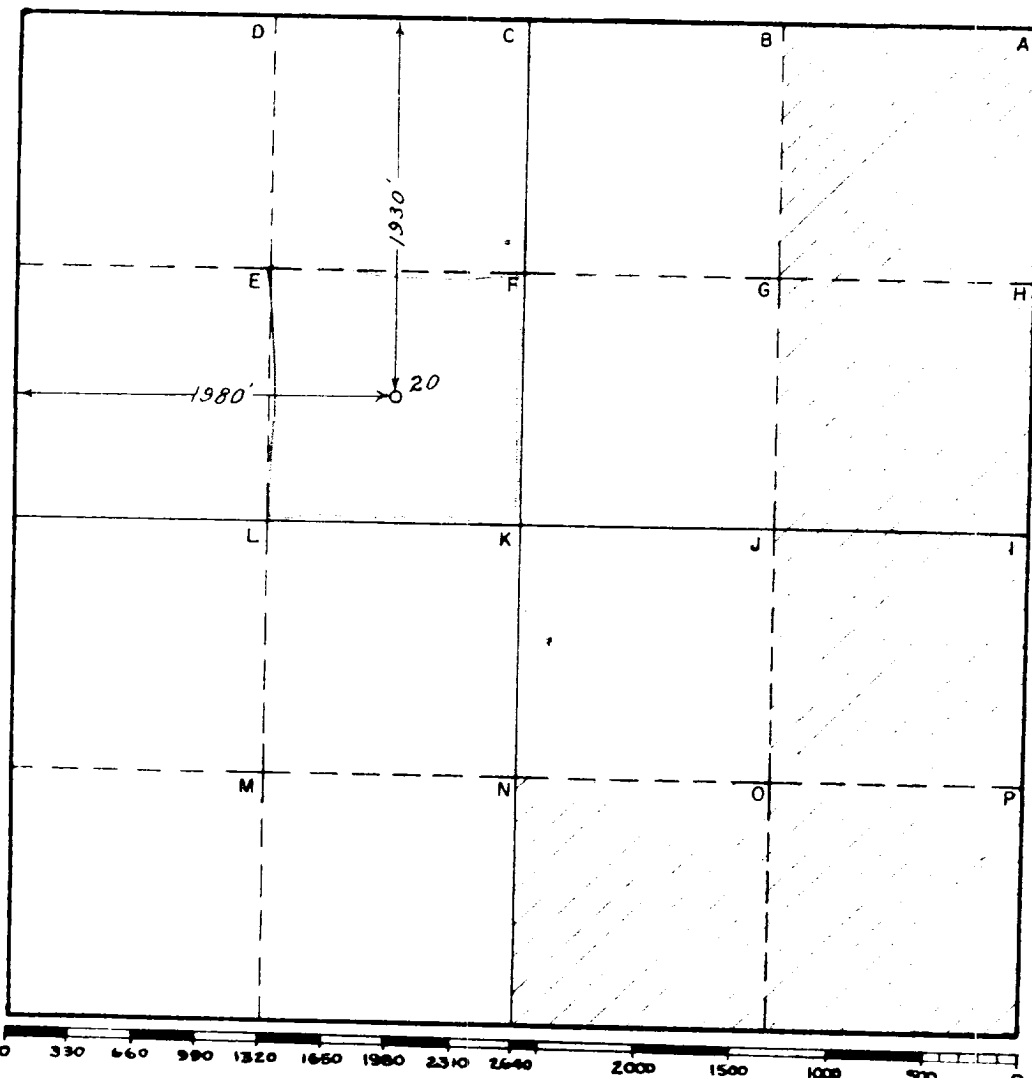

This is to certify that the information in Section A above is true and complete to the best of my knowledge and belief.

HUMBLE OIL & REFG. CO
(Operator)
[Signature]
(Representative)

Box 1600 Midland, Texas
Address

This is to certify that the well location shown on the plat in Section B was plotted from field notes of actual surveys made by me or under my supervision and that the same is true and correct to the best of my knowledge and belief.

Date Surveyed Jan 18, 1960

[Signature]
Registered Professional
Engineer and/or Land Surveyor.

Certificate No. 1382

LEASE NO. 37722

FILE NO. W.A. 2422