

STATE LEASE NO. B-934
FEDERAL LEASE NO. _____

Form C-128
Revised 5/1/57

NEW MEXICO OIL CONSERVATION COMMISSION

Well Location and Acreage Dedication Plat

Section A.

Date July 19, 1960

Operator Humble Oil & Refining Co Lease New Mexico State "M"
Well No. 23 Unit Letter "C" Section 29 Township 22 South Range 37 East NMPM
Located 660' Feet From North Line, 1980 Feet From West Line
County Lea G. L. Elevation Later Dedicated Acreage 40 Acres
Name of Producing Formation Queen Pool Langlie - Mattix

1. Is the Operator the only owner* in the dedicated acreage outlined on the plat below?

Yes ✓ No _____

2. If the answer to question one is "no", have the interests of all the owners been consolidated by communitization agreement or otherwise? Yes _____ No _____ If answer is "yes," Type of Consolidation _____

3. If the answer to question two is "no," list all the owners and thier respective interests below:

Owner

Land Description

Section B

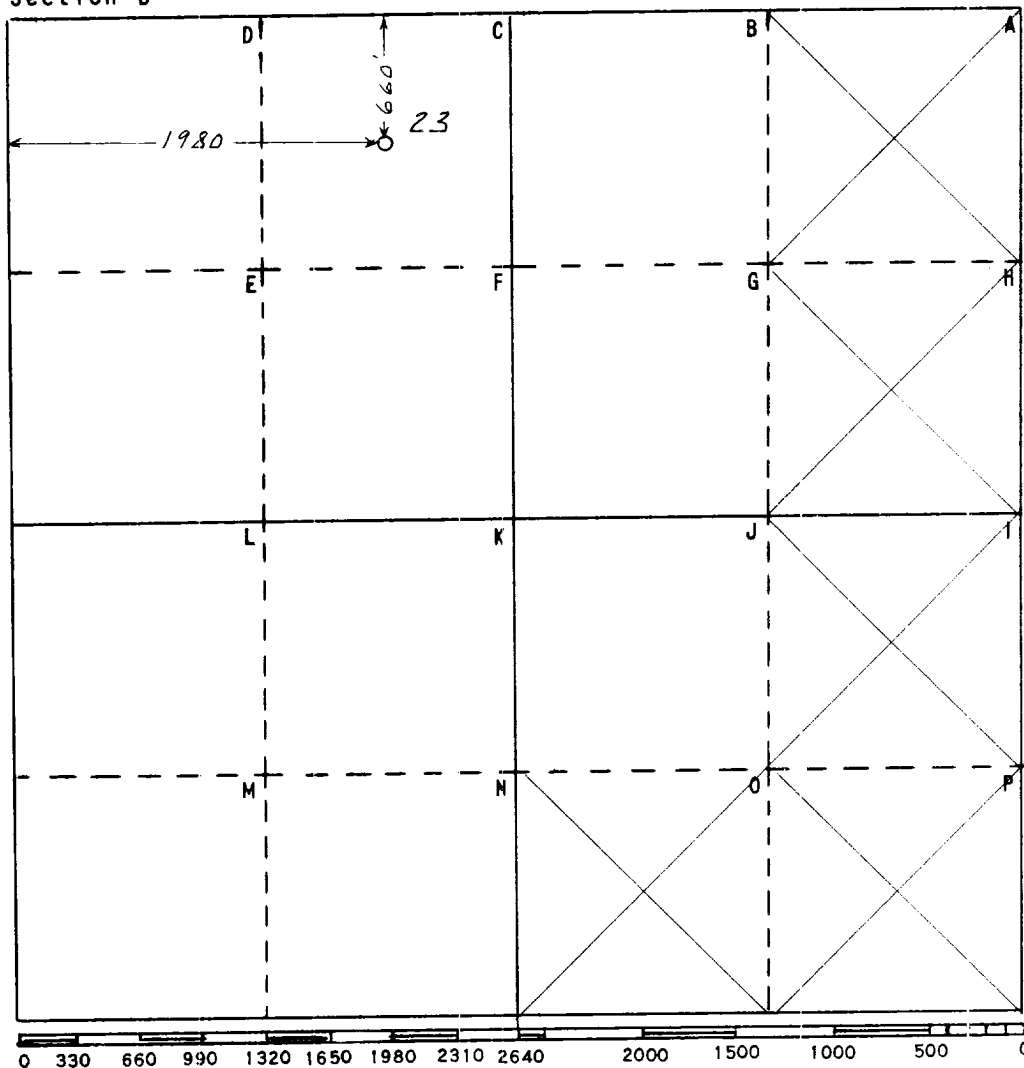

This is to certify that the information in Section A above is true and complete to the best of my knowledge and belief

HUMBLE OIL & REFG. CO.

(Operator)

H. S. Westerfield
(Representative)

Box 1600 Midland, Texas
Address

This is to certify that the well location shown on the plat in Section B was plotted from field notes of actual surveys made by me or under my supervision and that the same is true and correct to the best of my knowledge and belief.

Date Surveyed 7-18-60

H. S. Westerfield
Registered Professional
Engineer and/or Land Surveyor

Certificate No. 1382