

Section A.

Date, Sept 15, 1960

Operator Humble Oil & Refining Co Lease New Mexico State, "M"
 Well No. 27 Unit Letter "H" Section 30 Township 22 South Range 37 E NMPM
 Located 1980 Feet From North Line, 660 Feet From East Line
 County Lea G. L. Elevation Later Dedicated Acreage 40 Acres
 Name of Producing Formation Queen Pool Langlie - Mathis

1. Is the Operator the only owner* in the dedicated acreage outlined on the plat below?

Yes ☒ No ☐

2. If the answer to question one is "no", have the interests of all the owners been consolidated by communitization agreement or otherwise? Yes ☐ No ☐ If answer is "yes," Type of Consolidation _____

3. If the answer to question two is "no," list all the owners and thier respective interests below:

OwnerLand Description

Section B

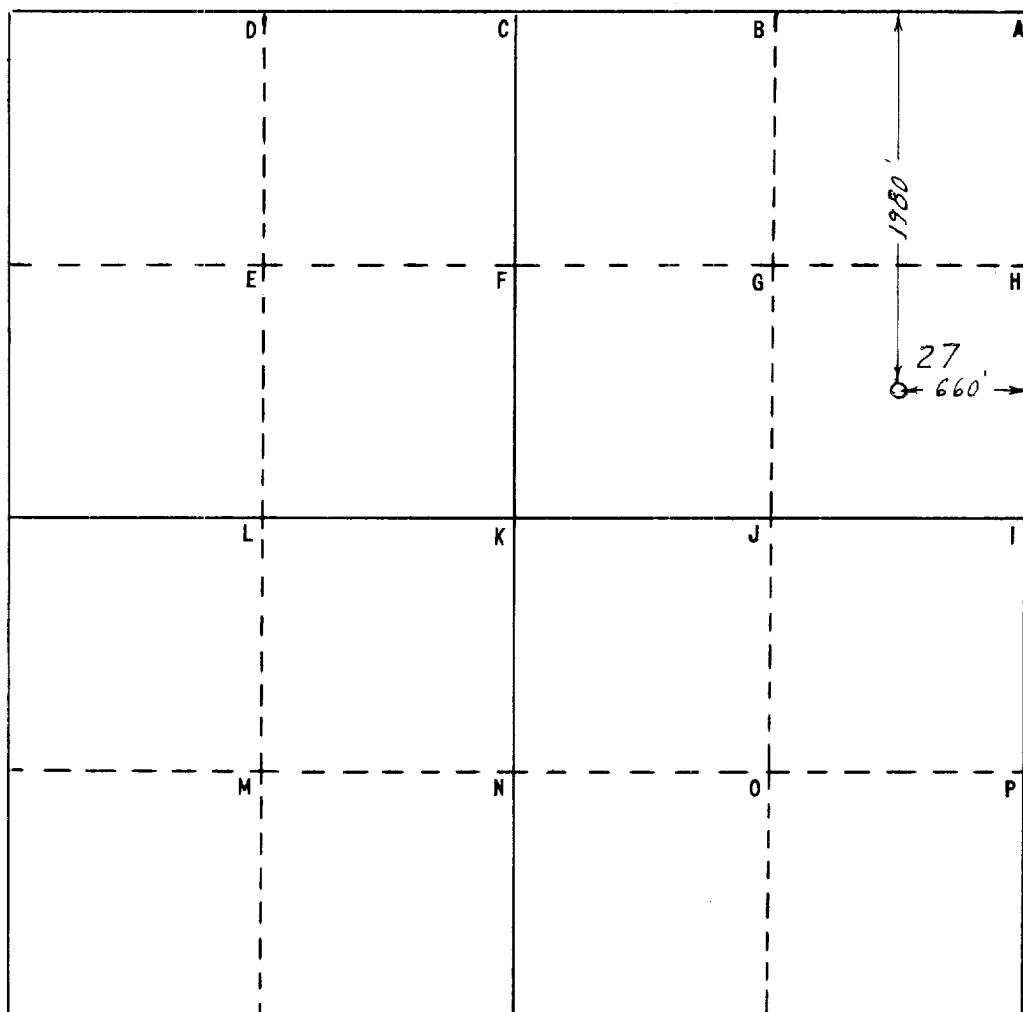

This is to certify that the information in Section A above is true and complete to the best of my knowledge and belief

HUMBLE OIL & REFG. CO.

(Operator)

Key E. Meador
(Representative)

Box 1600 Midland, Texas
Address

This is to certify that the well location shown on the plat in Section B was plotted from field notes of actual surveys made by me or under my supervision and that the same is true and correct to the best of my knowledge and belief.

Date Surveyed Sept. 9, 1960

W. S. Westefeld
Registered Professional
Engineer and/or Land Surveyor

Certificate No. 1382

0 330 660 990 1320 1650 1980 2310 2640 2000 1500 1000 500 0

FILE NO. W-A-2433