

NEW MEXICO  
OIL CONSERVATION COMMISSION

Form C-128

Well Location and/or Gas Proration Plat

Date August 8, 1956

Operator Roy Furr Lease State

Well No. 1 Section 32 Township 22-South Range 37 East NMPM

Located 2310 Feet From West Line, 990 Feet From South Line,

Lea County, New Mexico. G. L. Elevation                     

Name of Producing Formation Green Pool Undesignated Dedicated Acreage 40

(Note: All distances must be from outer boundaries of Section)

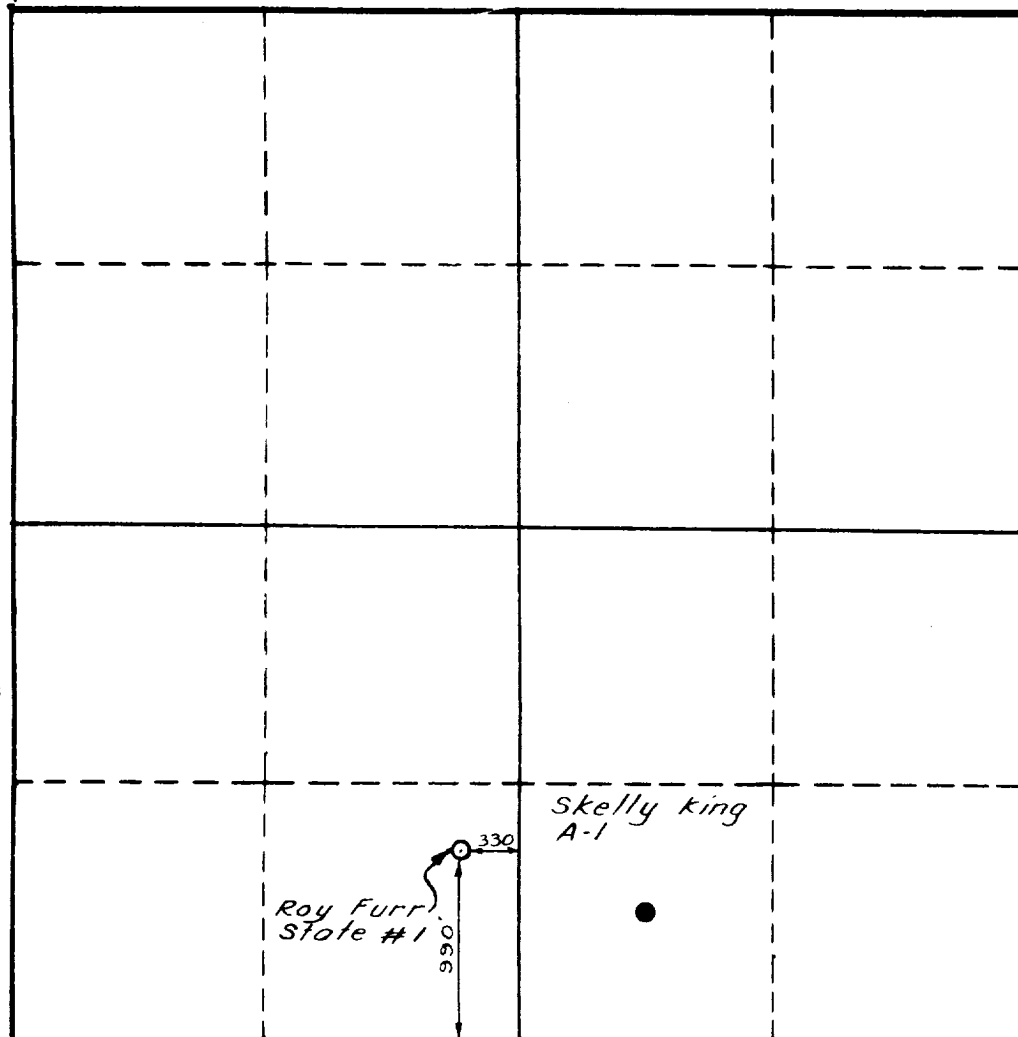

NOTE

This section of form is to be used for gas wells only.



SCALE: 1"=1000'

1. Is this Well a Dual Comp. ? Yes      No     .
2. If the answer to Question 1 is yes, are there any other dually completed wells within the dedicated acreage ? Yes      No     .

Name                       
Position                       
Representing                       
Address                     

This is to certify that the above plat was prepared from field notes of actual surveys made by me or under my supervision and that the same are true and correct to the best of my knowledge and belief.

Date Surveyed August 8, 1956  
Hermes E. [Signature]  
Registered Professional Engineer and/or Land Surveyor