

NEW MEXICO OIL CONSERVATION COMMISSION WELL LOCATION AND ACREAGE DEDICATION PLAT

FORM C-128
Revised 5-1-57

SEE INSTRUCTIONS FOR COMPLETING THIS FORM ON THE REVERSE SIDE

SECTION A

Operator Texas Pacific Coal & Oil Co.		Lease 1960 MAY 10 AM 9-11 50	
State 'A' Acct. #1		90	
Unit Letter A	Section 15	Township 23S	Range 36E
County Lea			
Actual Footage Location of Well: 660 feet from the North line and 990 feet from the East line			
Ground Level Elev.	Producing Formation 7-Rivers	Pool Langlie-Hettix	Dedicated Acreage: 40 Acres

1. Is the Operator the only owner in the dedicated acreage outlined on the plat below? YES ☒ NO ☐ ("Owner" means the person who has the right to drill into and to produce from any pool and to appropriate the production either for himself or for himself and another. (65-3-29 (e) NMSA 1935 Comp.)
2. If the answer to question one is "no," have the interests of all the owners been consolidated by communization agreement or otherwise? YES ☐ NO ☐ If answer is "yes," Type of Consolidation _____
3. If the answer to question two is "no," list all the owners and their respective interests below:

Owner	Land Description

SECTION B

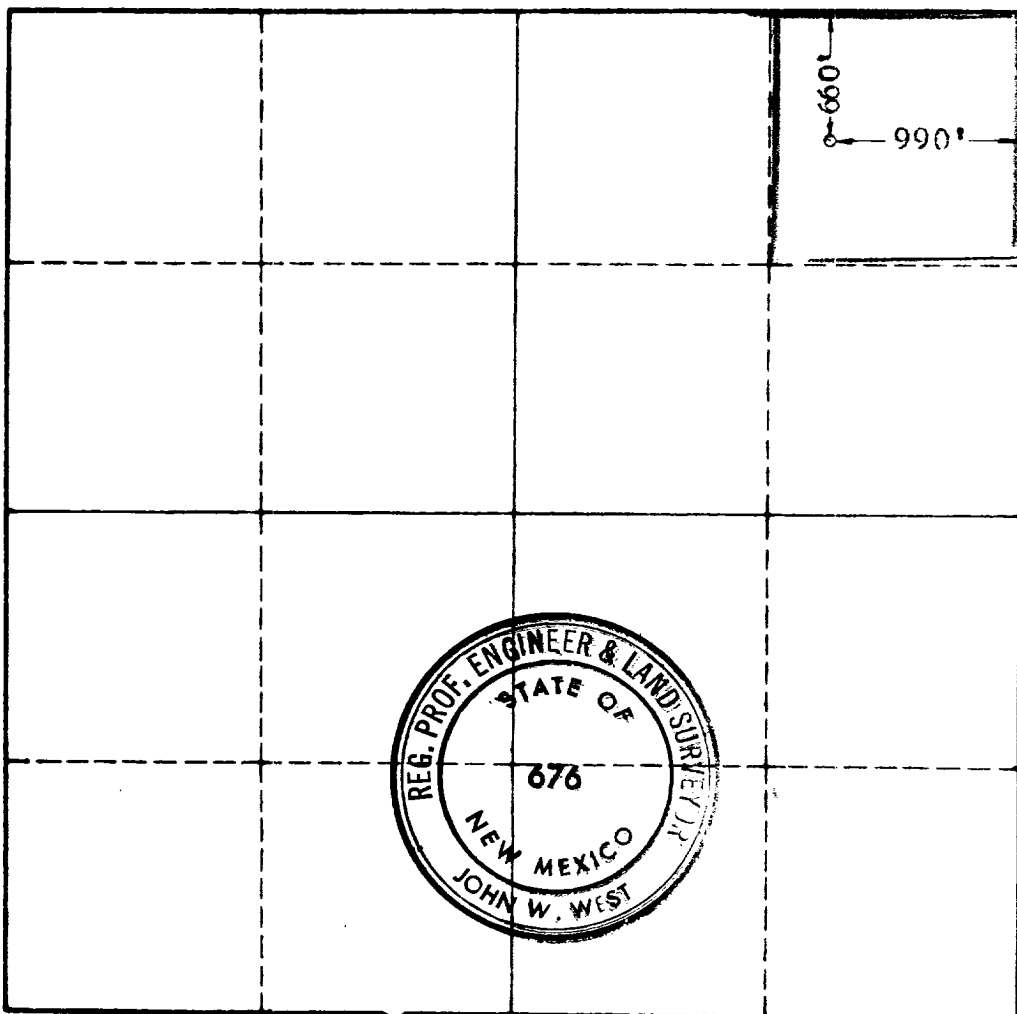

CERTIFICATION

I hereby certify that the information in SECTION A above is true and complete to the best of my knowledge and belief.

Name *[Signature]*
Position Manager of Production
Company Texas Pacific Coal & Oil Co.
Date May 9, 1960

I hereby certify that the well location shown on the plat in SECTION B was plotted from field notes of actual surveys made by me or under my supervision, and that the same is true and correct to the best of my knowledge and belief.

Date Surveyed 5/7/60
Registered Professional Engineer and/or Land Surveyor, JOHN W. WEST
[Signature]
Certificate No.
N.M. - P.E. & L.S. NO. 676

0 330 660 990 1320 1650 1980 2310 2640 2000 1500 1000 500 0

District 1
1625 N. French Dr., Hobbs. NM 88240

State of New Mexico
Energy, Minerals & Natural Resources Department

Revised February 21, 1994
instructions on back

District II
PO Drawer DD, Artesia, NM 88211-0719
District III
1000 Rio Brazos Rd. Aztec, NM 87410

OIL CONSERVATION DIVISION
PO Box 2088
Santa Fe, NM 87504-2088

Submit to Appropriate District Office
State Lease - 4 Copies
Fee Lease - 3 Copies

District IV
PO Box 2088, Santa Fe. NM 87504-2088

☐ AMENDED REPORT

WELL LOCATION AND ACREAGE DEDICATION PLAT

API Number 30-025- 16722		2 Pool Code 79240	3 Pool Name Jalmat: Tan-Yates-7 rvrs (Pro Gas)	
4 Property Code 24669	5 Property Name State "A" A/C 1			6 Well Number 90
7 OGRID No. 162791	8 Operator Name Raptor Resources			9 Elevation

10 Surface Location

UL or lot no.	Section	Township	Range	Lot Idn	Feet from the	North/South line	Feet from the	East/West line	County
A	15	23S	36E		660	North	940	East	Lea

11 Bottom Hole Location If Different From Surface

II Bottom Hole Location II Different From Surface									
UL or lot no.	Section	Township	Range	Lot Idn	Feet from the	North/South line	Feet from the	East/West line	County

12 Dedicated Acres	13 Joint or Infill	14 Consolidation Code	15 Order No.
480			

[illegible]

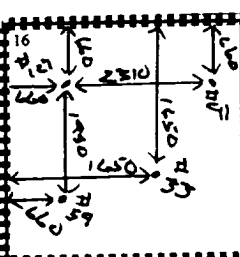
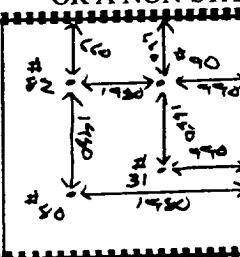
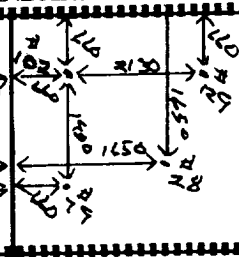
OR A NON-STANDARD UNIT HAS BEEN APPROVED BY THE STATE ENGINEER		<h3 style="margin: 0;">17 OPERATOR CERTIFICATION</h3> <p style="margin: 5px 0;">I hereby certify that the information contained herein is true and complete to the best of my knowledge and belief</p> <div style="margin-top: 20px;"> <p style="margin: 0;"><i>Bill R. Keathly</i></p> <p style="margin: 0;">Signature</p> <p style="margin: 0;">Bill R. Keathly</p> <p style="margin: 0;">Printed Name</p> <p style="margin: 0;">Regulatory Agent</p> <p style="margin: 0;">Title</p> <p style="margin: 0;">5-8-00</p> <p style="margin: 0;">Date</p> </div> <h3 style="margin: 20px 0;">18 SURVEYOR CERTIFICATION</h3> <p style="margin: 5px 0;">I hereby certify that the well location shown on this plan was plotted from field notes of actual surveys made by me or under my supervision, and that the same is true and correct to the best of my belief.</p> <div style="margin-top: 20px;"> <p style="margin: 0;">Date of Survey</p> <p style="margin: 0;">Signature and Seal of Professional Surveyor:</p> </div> <div style="margin-top: 20px;"> <p style="margin: 0;">Certificate Number</p> </div>	
			
Section 15	Section 14		

District I
PO Box 1980, Hobbs. NM 88241-1980

District II
PO Drawer DD, Artesia, NM 88211-0719

District III
1000 Rio Brazos Rd. Aztec, NM 87410

District IV
PO Box 2088, Santa Fe. NM 87504-2088

State of New Mexico
Energy, Minerals & Natural Resources Department

OIL CONSERVATION DIVISION
PO Box 2088
Santa Fe, NM 87504-2088

Revised February 21, 1964
instructions on back

Submit to Appropriate District Office
State Lease - 4 Copies
Fee Lease - 3 Copies

☐ AMENDED REPORT

WELL LOCATION AND ACREAGE DEDICATION PLAT

API Number 30-025- 10722		2 Pool Code 79240	3 Pool Name Jalmat, Tnsl, Yts, 7-Rivers (Pro Gas)	
4 Property Code 24669	5 Property Name State 'A' A/C 1			6 Well Number 90
7 OGRID No. 162791	8 Operator Name Raptor Resources, Inc,			9 Elevation

10 Surface Location

UL or lot no.	Section	Township	Range	Lot Idn	Feet from the	North/South line	Feet from the	East/West line	County
A	15	23S	36E		660	North	790	East East	Lea

11 Bottom Hole Location If Different From Surface		North/South line	Feet from the
---	--	------------------	---------------

11 Bottom Hole Location If Different From Surface									
UL or lot no.	Section	Township	Range	Lot Idn	Feet from the	North/South line	Feet from the	East/West line	County
12 Dedicated Acres		13 Joint or Infill		14 Consolidation Code		15 Order No.			
480				WSL-273D-C(SD)		Applied For			
RE ASSIGNED TO THIS COMPLETION UNTIL ALL INTERESTS HAVE BEEN CONSOLIDATED									

480		USL-273D-C(SD)	Applied for
NO ALLOWABLE WILL BE ASSIGNED TO THIS COMPLETION UNTIL ALL INTERESTS HAVE BEEN CONSOLIDATED OR A NON-STANDARD UNIT HAS BEEN APPROVED BY THE DIVISION			

OR A NON-STANDARD UNIT HAS BEEN ENTERED

--

17 OPERATOR CERTIFICATION

I hereby certify that the information contained herein is true and complete to the best of my knowledge and belief

Bill R. Foxley

Signature

Bill R. Keathly

Printed Name _____

Regulatory Agent - Raptor

Title	Date	Time	Place	Remarks
1.
2.
3.
4.
5.
6.
7.
8.
9.
10.
11.
12.
13.
14.
15.
16.
17.
18.
19.
20.
21.
22.
23.
24.
25.
26.
27.
28.
29.

11-18-99

Date _____

18 SURVEYOR CERTIFICATION

I hereby certify that the well location shown on this plat was plotted from field notes of actual surveys made by me or under my supervision, and that the same is true and correct to the best of my belief.

Date of Survey

Signature and Seal of Professional Surveyor:

Certificate Number