

NEW MEXICO OIL CONSERVATION COMMISSION
Santa Fe, New Mexico

Form C-101
Revised (12/1/55)

NOTICE OF INTENTION TO DRILL

Notice must be given to the District Office of the Oil Conservation Commission and approval obtained before drilling or recompletion begins. If changes in the proposed plan are considered advisable, a copy of this notice showing changes will be returned to the sender. Submit this notice in QUINTUPPLICATE. One copy will be returned following approval. See additional instructions in Rules and Regulations of the Commission. If State Land submit 6 Copies Attach Form C-128 in triplicate to first 3 copies of form C-101

Fort Worth, Texas

(Place)

January 18, 1960

(Date)

OIL CONSERVATION COMMISSION
SANTA FE, NEW MEXICO

Gentlemen:

You are hereby notified that it is our intention to commence the Drilling of a well to be known as

Texas Pacific Coal and Oil Company

(Company or Operator)

State of New Mexico "A" A/c-1

(Lease)

Well No. 82

in B (Unit)

The well is

located 660 feet from the North line and 1,980 feet from the East

line of Section 15, T. 23-S, R. 36-E, NMPM.

(GIVE LOCATION FROM SECTION LINE)

Langlie-Hattix

Pool,

Lee

County

If State Land the Oil and Gas Lease is No. A-983

If patented land the owner is

Address

We propose to drill well with drilling equipment as follows: Rotary Rig to top of pay. Drill in with Cable Tools.

The status of plugging bond is Required Bond on File.

Drilling Contractor F. W. A. Drilling Co., Inc.

1st National Bank Building

Wichita Falls, Texas

We intend to complete this well in the 7-Rivers

formation at an approximate depth of 4,000 feet.

CASING PROGRAM

We propose to use the following strings of Casing and to cement them as indicated:

Size of Hole	Size of Casing	Weight per Foot	New or Second Hand	Depth	Sacks Cement
12"	9 5/8"	36#	New	300'	300
8 3/4"	7"	20#	New	3,800'	250

If changes in the above plans become advisable we will notify you immediately.

ADDITIONAL INFORMATION (If recompletion give full details of proposed plan of work.)

Approved _____, 19____
Except as follows:

Sincerely yours,

TEXAS PACIFIC COAL AND OIL COMPANY

By _____

Position _____

and Communications regarding well to

Name _____ D. A. Bernay

Address P.O. Box 2110, Fort Worth 1, Texas

OIL CONSERVATION COMMISSION

By _____

NEW MEXICO OIL CONSERVATION COMMISSION

FORM C-128
Revised 5/1/57

WELL LOCATION AND ACREAGE DEDICATION PLAT

SEE INSTRUCTIONS FOR COMPLETING THIS FORM ON THE REVERSE

HOBBS OFFICE OCC

SECTION A

Operator Texas Pacific Coal & Oil Co.		Lease State of N.M.		1960 JAN 19 PM 2:48 # 82	
Unit Letter B	Section 15	Township 23 South	Range 36 East	County Lea County	
Actual Footage Location of Well: 660 feet from the North line and 1980' feet from the East line					
Ground Level Elev. 3394.0	Producing Formation Serrano River		Pool Langlie-Mattix	Dedicated Acreage: 40 Acres	

1. Is the Operator the only owner in the dedicated acreage outlined on the plat below? YES ☒ NO ____ ("Owner" means the person who has the right to drill into and to produce from any pool and to appropriate the production either for himself or for himself and another. (65-3-29 (e) NMSA 1935 Comp.)
2. If the answer to question one is "no," have the interests of all the owners been consolidated by communitization agreement or otherwise? YES ____ NO ____ If answer is "yes," Type of Consolidation ____
3. If the answer to question two is "no," list all the owners and their respective interests below:

Owner	Land Description

SECTION B

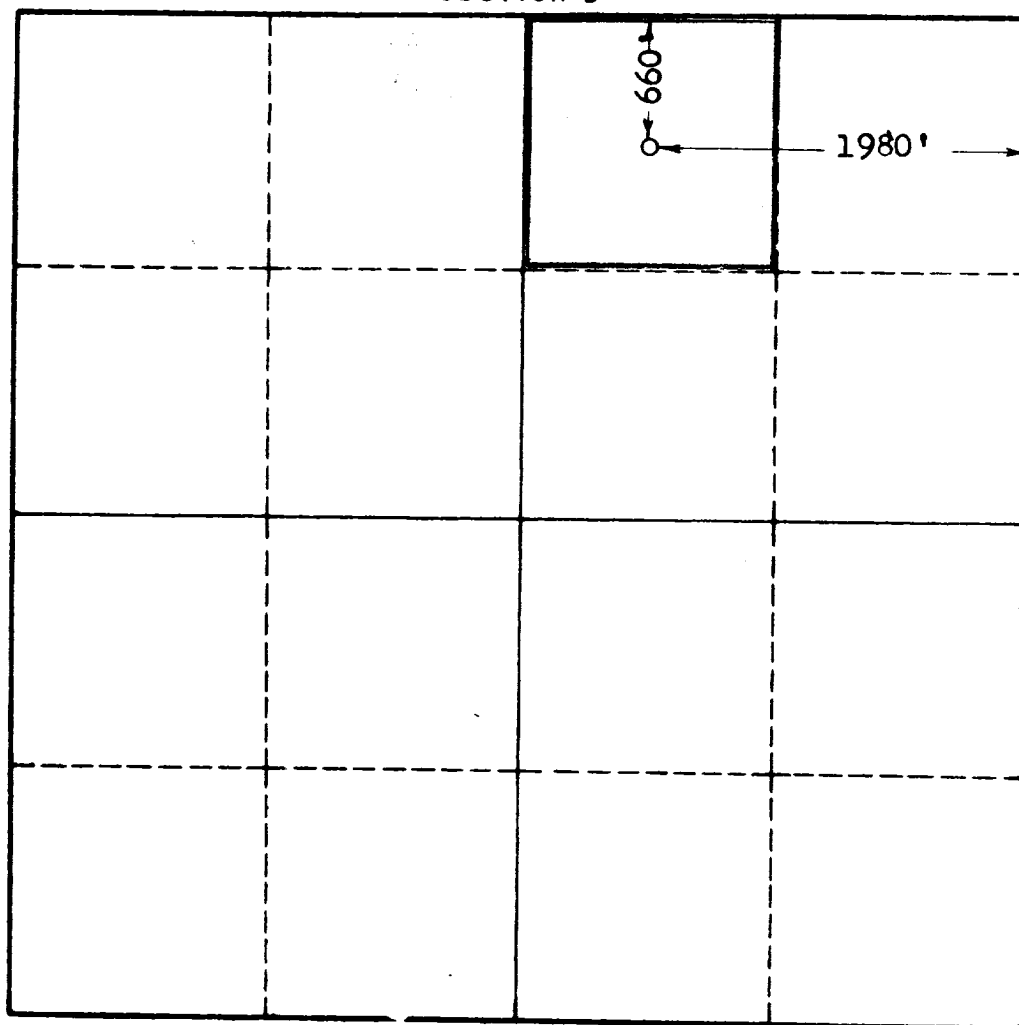

CERTIFICATION

I hereby certify that the information in SECTION A above is true and complete to the best of my knowledge and belief.

Name *[Signature]*
Position
Manager of Production
Company
Texas Pacific Coal & Oil Co.
Date
January 18, 1960

I hereby certify that the well location shown on the plat in SECTION B was plotted from field notes of actual surveys made by me or under my supervision, and that the same is true and correct to the best of my knowledge and belief.

Date Surveyed
1-11-60
Registered Professional Engineer
and/or Land Surveyor, JOHN W. WEST
[Signature]
Certificate No.
N.M. - P.E. & L.S. NO. 676