

NEW MEXICO OIL CONSERVATION COMMISSION  
Santa Fe, New Mexico

Form O-101  
Revised (12/1/55)

NOTICE OF INTENTION TO DRILL

Notice must be given to the District Office of the Oil Conservation Commission and approval obtained before drilling or recompletion begins. If changes in the proposed plan are considered advisable, a copy of this notice showing such changes will be returned to the sender. Submit this notice in QUINTUPLICATE. One copy will be returned following approval. See additional instructions in Rules and Regulations of the Commission. If State Land submit 6 Copies Attach Form O-128 in triplicate to first 3 copies of form O-101

Fort Worth, Texas

(Place)

September 22, 1959

(Date)

OIL CONSERVATION COMMISSION  
SANTA FE, NEW MEXICO

Gentlemen:

You are hereby notified that it is our intention to commence the Drilling of a well to be known as

Texas Pacific Coal and Oil Company

(Company or Operator)

New Mexico State "A" A/c-1

(Lease)

Well No. 70

(Unit)

located 1,980 feet from the

East

North

line and

660

feet from the

line of Section 15

T. 23-S

R. 36-E

NMPM.

(GIVE LOCATION FROM SECTION LINE)

Langlie-Mattix

Pool,

Lee

County

If State Land the Oil and Gas Lease is No. A-983

If patented land the owner is

Address

We propose to drill well with drilling equipment as follows: Rotary Rig to top of pay. Drill in with Cable Tools.

The status of plugging bond is Required Bond on File.

Drilling Contractor F W A Drilling Co., Inc.

We intend to complete this well in the 7-Rivers formation at an approximate depth of 4,000 feet.

CASING PROGRAM

We propose to use the following strings of Casing and to cement them as indicated:

Size of Hole	Size of Casing	Weight per Foot	New or Second Hand	Depth	Sacks Cement
12"	9 5/8"	36#	New	300'	300
8 3/4"	7"	20#	New	3,700'	250

If changes in the above plans become advisable we will notify you immediately.

ADDITIONAL INFORMATION (If recompletion give full details of proposed plan of work.)

Approved \_\_\_\_\_, 19\_\_\_\_\_  
Except as follows:

OIL CONSERVATION COMMISSION

Engineer District 1

Sincerely yours,

TEXAS PACIFIC COAL AND OIL COMPANY

(Company or Operator)

By

Position Manager of Production

Send Communications regarding well to

Name R. W. Hines

Address P. O. Box 2110, Fort Worth 1, Tex.

## NEW MEXICO OIL CONSERVATION COMMISSION

FORM C-128  
Revised 5/1/57

## WELL LOCATION AND ACREAGE DEDICATION PLAT

SEE INSTRUCTIONS FOR COMPLETING THIS FORM ON THE REVERSE SIDE

## SECTION A

Operator Texas Pacific Coal and Oil Co.		Lease State "A" Account		1959 SEP 23 PM 3:0370	
Unit Lease H	Section 15	Township 23 S	Range 36 E	County Lea	
Actual Footage Location of Well: 1980 feet from the North line and 660 feet from the East line					
Ground Level Elev. 3,382	Producing Formation 7-Rivers		Pool Langlie-Mattix		Dedicated Acreage: 40 Acres

1. Is the Operator the only owner in the dedicated acreage outlined on the plat below? YES ☒ NO ☐ ("Owner" means the person who has the right to drill into and to produce from any pool and to appropriate the production either for himself or for himself and another. (65-3-29 (e) NMSA 1935 Comp.)
2. If the answer to question one is "no," have the interests of all the owners been consolidated by communization agreement or otherwise? YES ☐ NO ☐ If answer is "yes," Type of Consolidation \_\_\_\_\_
3. If the answer to question two is "no," list all the owners and their respective interests below:

Owner	Land Description

## SECTION B

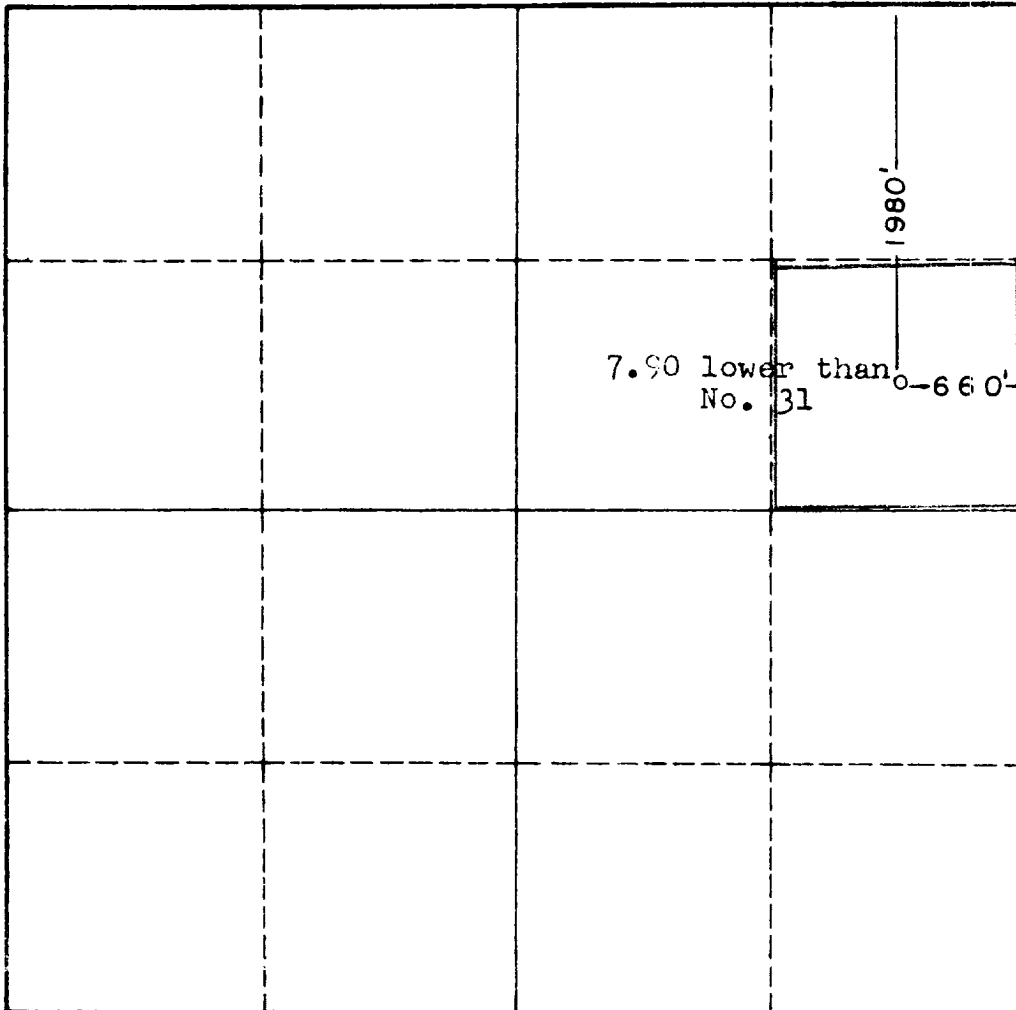

## CERTIFICATION

I hereby certify that the information in SECTION A above is true and complete to the best of my knowledge and belief.

Name *R. W. Davis*  
Position  
**Manager of Production**  
Company  
**Texas Pacific Coal & Oil Co.**  
Date  
**September 22, 1959**

I hereby certify that the well location shown on the plat in SECTION B was plotted from field notes of actual surveys made by me or under my supervision, and that the same is true and correct to the best of my knowledge and belief.

Date Surveyed  
*9-22-1959*  
Registered Professional Engineer  
and/or Land Surveyor, **JOHN W. WEST**  
*John W. West*  
Certificate No.  
**N.M. - P.E. & L.S. NO. 676**

330 660 990 1320 1650 1980 2310 2640 2000 1500 1000 500 0