

F.R.O. 11-22-75 OWWO
(Drinkard)
(Orig. Ohio Oil Co., The, comp 3-1-47 from
(Drinkard) OH 6794-7000', OTD 7000'; OWWO &
Re-Comp 3-4-55 dual thru (Blinestry) Parfs 5483-
5544' & (Drinkard) OH 6794-7000', OTD 7000')
11-17-75 ID 7000'; PED 6570'; Complete
Sqzd 5483-5544' w/150 ss
DO to 6570'
Parf (Drinkard) @ 6438', 6440', 6448', 6450',
6457', 6459', 6468', 6470', 6478', 6492', 6504',
6506', 6510', 6519', 6521', 6532', 6536', 6538',
6550', 6560' w/1 SPI
Acid (6438-6560') 4000 gals
Frac (6438-6560') 20,000 gals wtr + 30,000# sd
11-22-75 COMPLETION ISSUED
11-4-21 NM

NEW MEXICO OIL CONSERVATION COMMISSION
WELL LOCATION AND ACREAGE DEDICATION PLAT

FORM C-128
Revised 5/1/57

SEE INSTRUCTIONS FOR COMPLETING THIS FORM ON THE REVERSE SIDE

SECTION A

Operator MARATHON OIL COMPANY		Lease EDITH BUTLER "A"		Well No. 1
Unit Letter L	Section 18	Township 22 SOUTH	Range 38 EAST	County LEA
Actual Footage Location of Well: 660 feet from the WEST line and 1980 feet from the SOUTH line				
Ground Level Elev.	Producing Formation BLINEBRY	Pool BLINEBRY (OIL)	Dedicated Acreage: 40 Acres	

1. Is the Operator the only owner in the dedicated acreage outlined on the plat below? YES _____ NO X. ("Owner" means the person who has the right to drill into and to produce from any pool and to appropriate the production either for himself or for himself and another. (65-3-29 (e) NMSA 1935 Comp.)
2. If the answer to question one is "no," have the interests of all the owners been consolidated by communitization agreement or otherwise? YES X NO _____. If answer is "yes," Type of Consolidation Unitized (Tubb and Blinebry Zones)
3. If the answer to question two is "no," list all the owners and their respective interests below:

Owner	Land Description

SECTION B

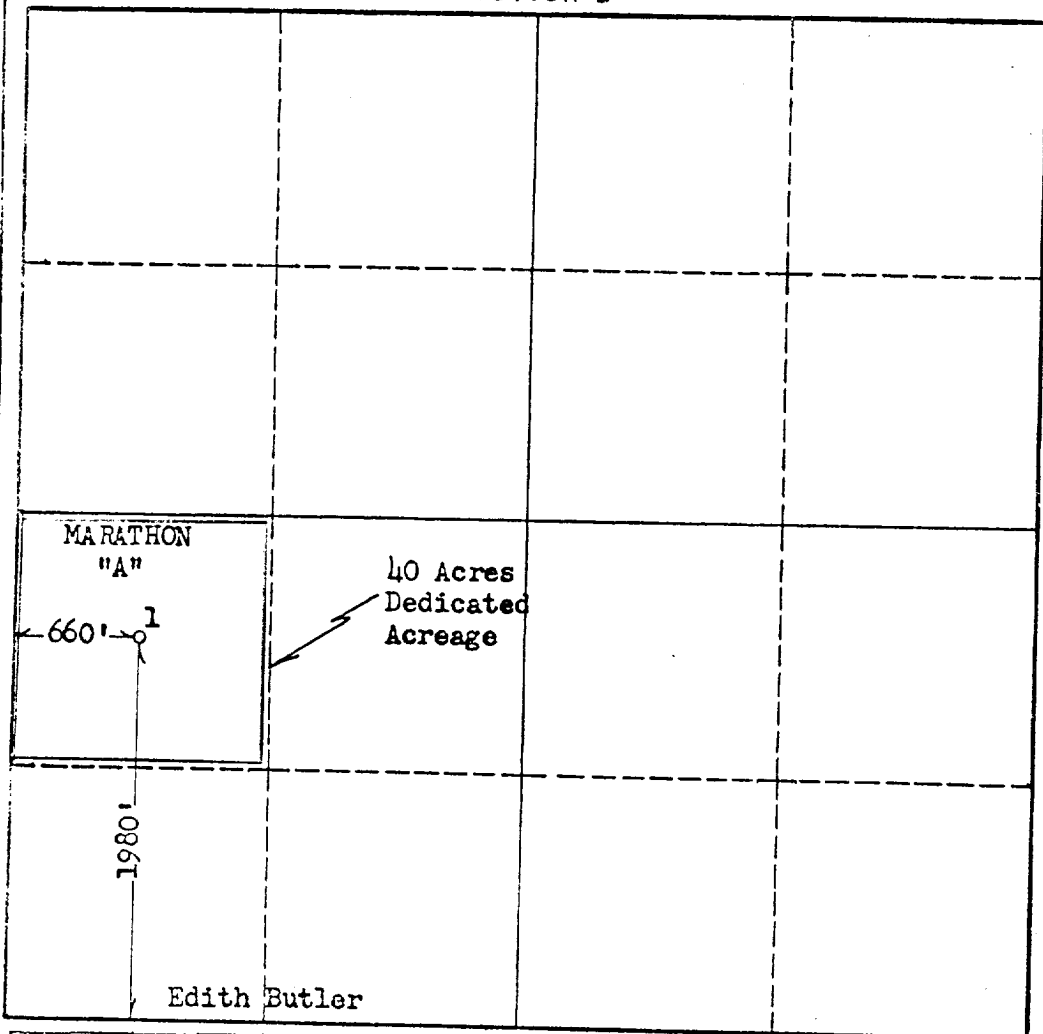

CERTIFICATION

I hereby certify that the information in SECTION A above is true and complete to the best of my knowledge and belief.

Name
J. R. Barber
Position
Area Petroleum Engineer
Company
Marathon Oil Company
Date
9-10-64

I hereby certify that the well location shown on the plat in SECTION B was plotted from field notes of actual surveys made by me or under my supervision, and that the same is true and correct to the best of my knowledge and belief.

Date Surveyed
Registered Professional Engineer and/or Land Surveyor
Certificate No.

0 330 660 990 1320 1650 1980 2310 2640 2000 1500 1000 500 0

New Mexico OCC
J. A. Grimes
L. H. Shearer
H. J. Brunt
D. K. Spellman Jr.
W. M. Kearley Jr.

NEW MEXICO
OIL CONSERVATION COMMISSION

Gas Well Plat

HOBBS OFFICE OCC

Date Sept. 24, 1954

1954 OCT 1 6 AM 9:41

The Ohio Oil Co.

Operator

Edith Butler "A"

Lease

Well No.

Name of Producing Formation Blinebry

Pool Blinebry

No. Acres Dedicated to the Well 160

SECTION 18

TOWNSHIP 22S

RANGE 38E

Producing from Drinkard - 1, *3, *4
Producing from Paddock - *1
Producing from Blinebry Gas - 1

*Operated by Cosden

Well No. 1 dual completed
Blinebry Gas and Drinkard oil.

Dedicated Acreage

I hereby certify that the information given above is true and complete to the best of my knowledge.

Name D. K. Spellman Jr.

Position Petroleum Engineer

Representing The Ohio Oil Company

Address P. O. Box 552, Midland, Texas

CCC
J. H. Shearer
L. H. Shearer
H. J. Brunt
D. K. Spellman Jr.
W. M. Keesley Jr.

NEW MEXICO
OIL CONSERVATION COMMISSION

Gas Well Plat

RECORDS OFFICE CCC
Date Sept. 24, 1951

The Ohio Oil Co. Operator
Edith Butler "A" Lease
1 11 9:41
Well No.

Name of Producing Formation Blinebry Pool Blinebry

No. Acres Dedicated to the Well 160

SECTION 18 TOWNSHIP 22S RANGE 38E

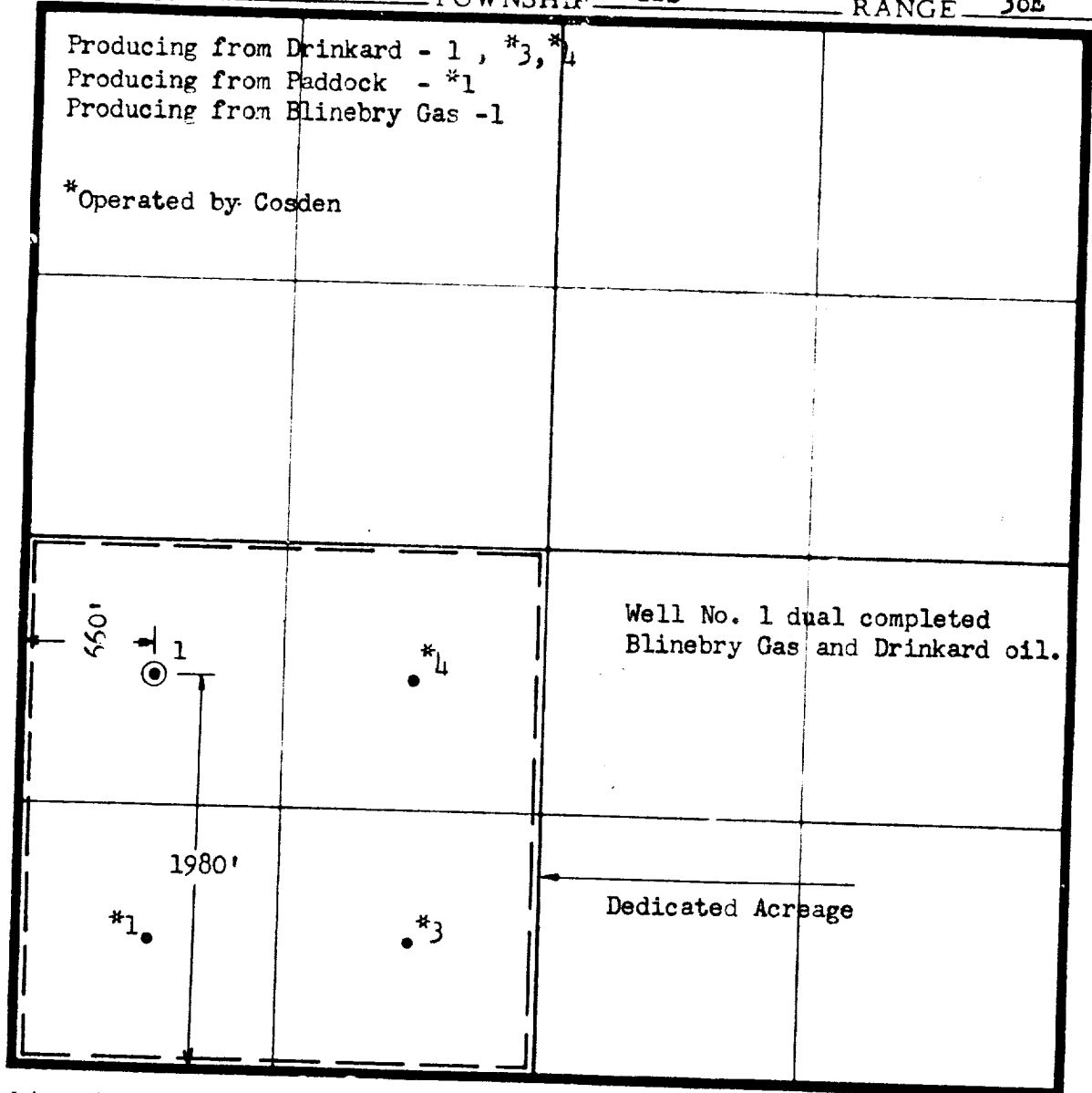

I hereby certify that the information given above is true and complete to the best of my knowledge.

Name D. K. Spellman Jr.
Position Petroleum Engineer
Representing The Ohio Oil Company
Address P. O. Box 552, Midland, Texas