

UNITED STATES
DEPARTMENT OF THE INTERIOR
BUREAU OF LAND MANAGEMENT

FOR INFORMATION ONLY
APPROVED
Budget Bureau No. 1004-0135

Expires: March 31, 1993

SUNDRY NOTICES AND REPORTS ON WELLS

Do not use this form for proposals to drill or to deepen or reentry to a different reservoir.

Use "APPLICATION FOR PERMIT -" for such proposals

SUBMIT IN TRIPLICATE

1. Type of Well: ☒ OIL WELL ☒ GAS WELL ☐ OTHER

2. Name of Operator
TEXACO EXPLORATION & PRODUCTION INC.

3. Address and Telephone No.
P.O. BOX 730, HOBBS, NM 88240 397-0442

4. Location of Well (Footage, Sec., T., R., M., or Survey Description)
Unit Letter H : 1980 Feet From The NORTH Line and 989 Feet From The
EAST Line Section 19 Township 22S Range 38E

5. Lease Designation and Serial No.

LC032104

6. If Indian, Allottee or Tribe Name

7. If Unit or CA, Agreement Designation

8. Well Name and Number

BLINEBRY, A. H. FEDERAL NCT-1 /

12

9. API Well No.

30-025-12140 /

10. Field and Pool, Exploratory Area
TUBB OIL AND GAS

11. County or Parish, State

LEA, NEW MEXICO

12. Check Appropriate Box(s) To Indicate Nature of Notice, Report, or Other Data

TYPE OF SUBMISSION

- ☒ Notice of Intent
☐ Subsequent Report
☐ Final Abandonment Notice

TYPE OF ACTION

- ☐ Abandonment
☐ Recompletion
☒ Plugging Back
☐ Casing Repair
☐ Altering Casing
☐ OTHER:
☐ Change of Plans
☐ New Construction
☐ Non-Routine Fracturing
☐ Water Shut-Off
☐ Conversion to Injection
☐ Dispose Water

(Note: Report results of multiple completion on Well Completion or Recompletion Report and Log Form.)

13. Describe Proposed or Completed Operations (Clearly state all pertinent details, and give pertinent dates, including estimated date of starting any proposed work. If well is directionally drilled, give subsurface locations and measured and true vertical depths for all markers and zones pertinent to this work.) *

1. MIRU pulling unit. TOH w/rods and pump. NU 3000# manual double ram BOP. Release tbg anchor, TOH w/2-3/8" tbg.
2. TIH w/7" CIBP and 7" packer on tbg. Set CIBP above openhole section @ +/- 6835'.
3. Pull bottom of tbg up hole to 5691' (bottom Blinebry perf). Spot 300 gallons 15% NEFE across perforated interval. Pull uphole and set @ +/- 5500'.
4. TIH w/7" cmt retainer on tbg. Set retainer @ +/- 5575' (top perf @ 5591'). Squeeze Blinebry perfs 5591'-5691'. TOH. WOC.
5. TIH w/6-1/4" bit, 6 3-1/2" DC's on tbg. RU reverse unit w/power swivel. Drill out cement retainer and cement through perforated interval. TOH
6. MIRU wireline w/packoff. TIH w/dump bailer and dump 35' cement on top of CIBP @ 6835' for new PBTD = 6800'. TOH w/bailer.
7. TIH w/GR-CCL and log from 6500'-5500' (or minimum charge, whichever is greater). TOH w/log.
8. TIH w/4" casing gun and perforate the Tubb Oil & Gas w/2 JSPF, 120 deg. spiral phasing from 6130' - 6258' (176 Shots) RD wireline.
9. TIH w/6K treating packer and SN. Place bottom of packer at 6258' (lower most perf). Spot 300 gallons 15% NEFE across perforated interval.
10. RU DS. Acidize Tubb perfs 6130'-6258' w/4000 gallons 15% NEFE carrying 264 7/8" 1.3 s.g. ballsealers with an average rate of 4-5 BPM w/max. press=4000#. RD DS. Release packer, run packer through perforated interval to knock off any ball sealers. TOH w/2-3/8" tbg.
11. TIH w/10k treating packer and SN. Set packer @ +/- 6000'. Load backside and test packer to 500#.
12. RU DS. RU pressure relief valve on backside set at 2000#. Place 500# on backside and monitor throughout job.
13. Frac Tubb perfs 6130'-6258' w/47,500 gallons 35# borate XLG 2% KCL carrying 153,000# 20/40 Ottawa sand and tail in w/40,000# curable resin coated sand at an average rate of 35 BPM w/max pressure not to exceed 8000#
14. Flow back well until dies. Release pkr, TOH and lay down 3-1/2" tbg and packer.
15. TIH w/production tbg, pump and rods. Place on test.

14. I hereby certify that the foregoing is true and correct

SIGNATURE Paul R. Wilcox TITLE Field Technician

DATE 4/11/96

TYPE OR PRINT NAME Paul R. Wilcox

(This space for Federal or State office use)

APPROVED BY Orig. Signed by Shannon J. Shaw TITLE FIELD ENGINEER

DATE 5/17/96

CONDITIONS OF APPROVAL, IF ANY:

Title 18 U.S.C. Section 1001, makes it a crime for any person knowingly and willfully to make to any department or agency of the United States any false, fictitious or fraudulent statements or representations as to any matter within its jurisdiction.

DISTRICT I

P.O. Box 1980, Hobbs, NM 88241-1980

DISTRICT II

P.O. Box Drawer DD, Artesia, NM 88211-0719

DISTRICT III

1000 Rio Brazos Rd., Aztec, NM 87410

DISTRICT IV

P.O. Box 2088, Santa Fe, NM 87504-2088

State of New Mexico

Energy, Minerals and Natural Resources Department

Form C-102

Revised February 10, 1994

Instructions on back

Submit to Appropriate District Office

State Lease - 4 Copies

Fee Lease - 3 Copies

☐ AMENDED REPORT

OIL CONSERVATION DIVISION

P.O. Box 2088

Santa Fe, New Mexico 87504-2088

WELL LOCATION AND ACREAGE DEDICATION PLAT

¹ API Number 30-025-12140	² Pool Code 60240	³ Pool Name TUBB OIL AND GAS
⁴ Property Code 010899	⁵ Property Name BLINEBRY, A. H. FEDERAL NCT-1	⁶ Well No. 12
⁷ OGRID Number 022351	⁸ Operator Name TEXACO EXPLORATION & PRODUCTION INC.	⁹ Elevation 3374' GL

¹⁰ Surface Location

UI or lot no.	Section	Township	Range	Lot.Idn	Feet From The	North/South Line	Feet From The	East/West Line	County
H	19	22S	38E		1980	NORTH	989	EAST	LEA

¹¹ Bottom Hole Location If Different From Surface

UI or lot no.	Section	Township	Range	Lot.Idn	Feet From The	North/South Line	Feet From The	East/West Line	County

¹² Dedicated Acres 40	¹³ Joint or Infill No	¹⁴ Consolidation Code	¹⁵ Order No.
-------------------------------------	-------------------------------------	----------------------------------	-------------------------

NO ALLOWABLE WILL BE ASSIGNED TO THIS COMPLETION UNTIL ALL INTERESTS HAVE BEEN CONSOLIDATED
OR A NON-STANDARD UNIT HAS BEEN APPROVED BY THE DIVISION

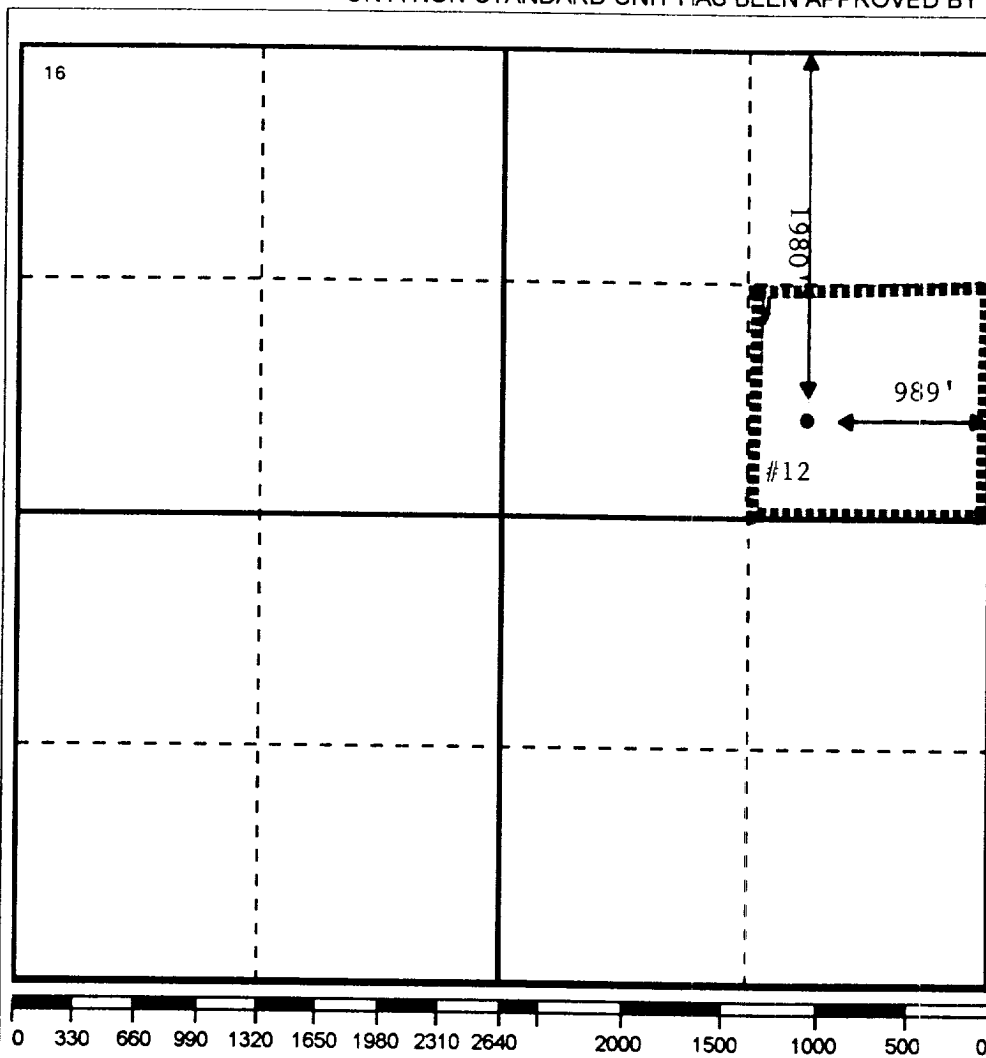

17 OPERATOR CERTIFICATION

I hereby certify that the information contained herein is true and complete to the best of my knowledge and belief

Signature

Printed Name

Paul R. Wilcox

Position

Field Technician

Date

4/11/96

18 SURVEYOR CERTIFICATION

I hereby certify that the well location shown on this plat was plotted from field notes of actual surveys made by me or under my supervision, and that the same is true and correct to the best of my knowledge and belief.

Date Surveyed

Signature & Seal of Professional Surveyor

Certificate No.

