

APPROVED
Form 4-58
(Feb. 1951)

NOV 20 1959

A. P. KLEEMAN
DISTRICT ENGINEER

REVISED*
(SUBMIT IN TRIPLICATE)

UNITED STATES
DEPARTMENT OF THE INTERIOR
GEOLOGICAL SURVEY

Budget Bureau No. 42-R358.4.
Approval expires 12-31-60.

Land Office **Las Cruces**

Lease No. **032104**

Unit **U. S. GEOLOGICAL SURVEY**

SUNDRY NOTICES AND REPORTS ON WELLS

NOTICE OF INTENTION TO DRILL	<input checked="" type="checkbox"/>	SUBSEQUENT REPORT OF WATER SHUT-OFF	
NOTICE OF INTENTION TO CHANGE PLANS		SUBSEQUENT REPORT OF SHOOTING OR ACIDIZING	
NOTICE OF INTENTION TO TEST WATER SHUT-OFF		SUBSEQUENT REPORT OF ALTERING CASING	
NOTICE OF INTENTION TO RE-DRILL OR REPAIR WELL		SUBSEQUENT REPORT OF RE-DRILLING OR REPAIR	
NOTICE OF INTENTION TO SHOOT OR ACIDIZE		SUBSEQUENT REPORT OF ABANDONMENT	
NOTICE OF INTENTION TO PULL OR ALTER CASING		SUPPLEMENTARY WELL HISTORY	
NOTICE OF INTENTION TO ABANDON WELL			

(INDICATE ABOVE BY CHECK MARK NATURE OF REPORT, NOTICE, OR OTHER DATA)

Lease No. 41655
A. H. Blinebry

November 19, 1959

Well No. 11-NCT-1 is located 1980 ft. from ☒ S line and 330 ft. from ☒ W line of sec. 28

NW/4 SW/4, Sec. 28 T-22-S R-38-E NMPM
(Of Sec. and Sec. No.) (Twp.) (Range) (Meridian)

Drinkard (Oil) Tubb (Gas)
(Field)

Lea New Mexico
(County or Subdivision) (State or Territory)

The elevation of the derrick floor above sea level is 3389 ft.

DETAILS OF WORK

(State names of and expected depths to objective sands; show sizes, weights, and lengths of proposed casings; indicate mudding jobs, cementing points, and all other important proposed work)

FORMATIONS EXPECTED		SIZE CASING		CASING PROGRAM (Approx.)	
				Set at	Cement
Top of Anhydrite	1390'	13-3/8"	48#	New 300'	300 sx.
" Yates	2720'	9-5/8"	32.3 & 36#	New 3150'	1900 sx.
" San Andres	4155'	7"	23#	New 7200'	500 sx.
" Glorieta	5290'				
" Blinebry	5715'				
" Tubb	6230'				
" Drinkard	6570'				
Total Depth	7200'				

* Revised. Plat dated 10/31/59 submitted with original notice dated 11/2/59 showed field as Blinebry (Oil) & Tubb (Gas), whereas it should have been Drinkard (Oil) & Tubb (Gas).

Understand that this plan of work must receive approval in writing by the Geological Survey before operations may be commenced.

Company **TEXACO Inc.**
Address **P. O. Box 3109
Midland, Texas**

TEXACO Inc.

By *J. J. Velten*
J. J. Velten
Title **Division Civil Engineer**

NE TEXICO OIL CONSERVATION COMMISS

Well Location and Acreage Dedication Plat

Section A.

Date 11-11-59

Operator TEXACO Inc. Lease A. E. Blinebry NCT-1
Well No. 11 Unit Letter L Section 28 Township 28-South Range 38-East NMPM
Located 1980 Feet From South Line, 330 Feet From West Line
County Lea G. L. Elevation 3378' Dedicated Acreage 40 Acres
Name of Producing Formation Delinford Pool Drinford (Oil)

1. Is the Operator the only owner* in the dedicated acreage outlined on the plat below?
Yes X No .
2. If the answer to question one is "no," have the interests of all the owners been consolidated by communitization agreement or otherwise? Yes No . If answer is "yes," Type of Consolidation
3. If the answer to question two is "no," list all the owners and their respective interests below:

Owner

Land Description

NOV 20 1959

SURVEY
NOB...

Section B

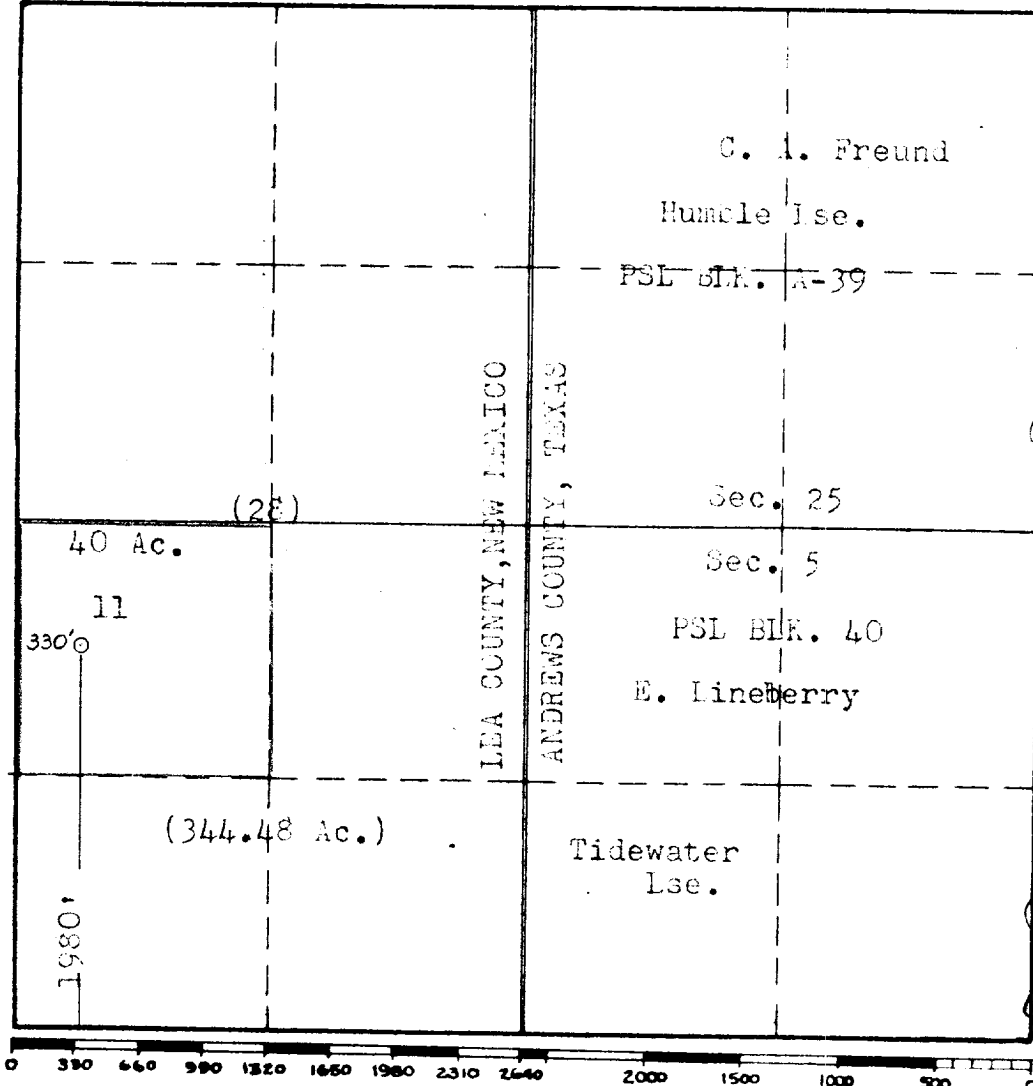

This is to certify that the information in Section A above is true and complete to the best of my knowledge and belief.

TEXACO Inc.

(Operator)

(Representative)

Division Civil Engineer
P.O. Box 3109, Midland, Texas
Address

This is to certify that the well location shown on the plat in Section B was plotted from field notes of actual surveys made by me or under my supervision and that the same is true and correct to the best of my knowledge and belief.

Date Surveyed 10-31-59

Registered Professional
Engineer and/or Land Surveyor.

Certificate No. 8174