

CO. TO O. C. C.

(SUBMIT IN TRIPLICATE)
HOBBS
UNITED STATES
DEPARTMENT OF THE INTERIOR
GEOLOGICAL SURVEY

Budget Bureau No. 42-R358.4.
Approval expires 12-31-60.

Las Cruces

Land Office

Lease No. **032104**

Unit

RECEIVED**NOV 3 1959****U. S. GEOLOGICAL SURVEY**
HOBBS, NEW MEXICO**SUNDRY NOTICES AND REPORTS ON WELLS**

NOTICE OF INTENTION TO DRILL	<input checked="" type="checkbox"/>	SUBSEQUENT REPORT OF WATER SHUT-OFF
NOTICE OF INTENTION TO CHANGE PLANS	<input type="checkbox"/>	SUBSEQUENT REPORT OF SHOOTING OR ACIDIZING
NOTICE OF INTENTION TO TEST WATER SHUT-OFF	<input type="checkbox"/>	SUBSEQUENT REPORT OF ALTERING CASING
NOTICE OF INTENTION TO RE-DRILL OR REPAIR WELL	<input type="checkbox"/>	SUBSEQUENT REPORT OF RE-DRILLING OR REPAIR
NOTICE OF INTENTION TO SHOOT OR ACIDIZE	<input type="checkbox"/>	SUBSEQUENT REPORT OF ABANDONMENT
NOTICE OF INTENTION TO PULL OR ALTER CASING	<input type="checkbox"/>	SUPPLEMENTARY WELL HISTORY
NOTICE OF INTENTION TO ABANDON WELL	<input type="checkbox"/>	

(INDICATE ABOVE BY CHECK MARK NATURE OF REPORT, NOTICE, OR OTHER DATA)

Lease No. **41655**
A. H. Blinebry

November 2, 19**59**

Well No. **11-NOT-1** is located **1980** ft. from **S** line and **330** ft. from **W** line of sec. **28**

NW/4 SW/4, Sec. 28**T-22-S**
(Twp.)**R-38-E**
(Range)**NMPM**
(Meridian)**Blinebry (oil)**
Tubb (Gas)
(Field)**Lea**
(County or Subdivision)**New Mexico**
(State or Territory)

The elevation of the derrick floor above sea level is _____ ft. (Will be furnished about 11/5)

DETAILS OF WORK

(State names of and expected depths to objective sands; show sizes, weights, and lengths of proposed casings; indicate mudding jobs, cementing points, and all other important proposed work)

FORMATIONS EXPECTED

Top Anhydrite	1390'
" Yates	2720'
" San Andres	4155'
" Glorieta	5290'
" Blinebry	5715'
" Tubb	6230'
" Drinkard	6570'
Total Depth	7200'

SIZE CASING

13-3/8"	48#	New
9-5/8"	32.3 & 36#	New
7"	23#	New

CASINO PROGRAM (Approx.)

Set at	Cement
300'	300 sx.
3150'	1900 sx.
7200'	500 sx.

I understand that this plan of work must receive approval in writing by the Geological Survey before operations may be commenced.

Company **TEXACO Inc.**
Address **P. O. Box 3109**
Midland, Texas

TEXACO Inc.
By **J. J. Volten**
Title **Division Civil Engineer**

NEW MEXICO OIL CONSERVATION COMMISSION

Well Location and Acreage Dedication Plat

Section A.

Date 10-31-59

Operator TEXACO Inc. Lease A. E. Elinebry NCT-1
Well No. 11 Unit Letter 1 Section 28 Township 22-South Range 30-East NMPM
Located 1980 Feet From South Line, 330 Feet From West Line
County Lea G. L. Elevation _____ Dedicated Acreage 40 Acres
Name of Producing Formation Elinebry Pool Elinebry (Oil)

1. Is the Operator the only owner* in the dedicated acreage outlined on the plat below?
Yes X No _____.
2. If the answer to question one is "no," have the interests of all the owners been consolidated by communitization agreement or otherwise? Yes _____ No _____. If answer is "yes," Type of Consolidation _____
3. If the answer to question two is "no," list all the owners and their respective interests below:

Owner

Land Description

RECEIVED

NOV 3 1959

U. S. GEOLOGICAL SURVEY

HOBBS, NEW MEXICO

Section B

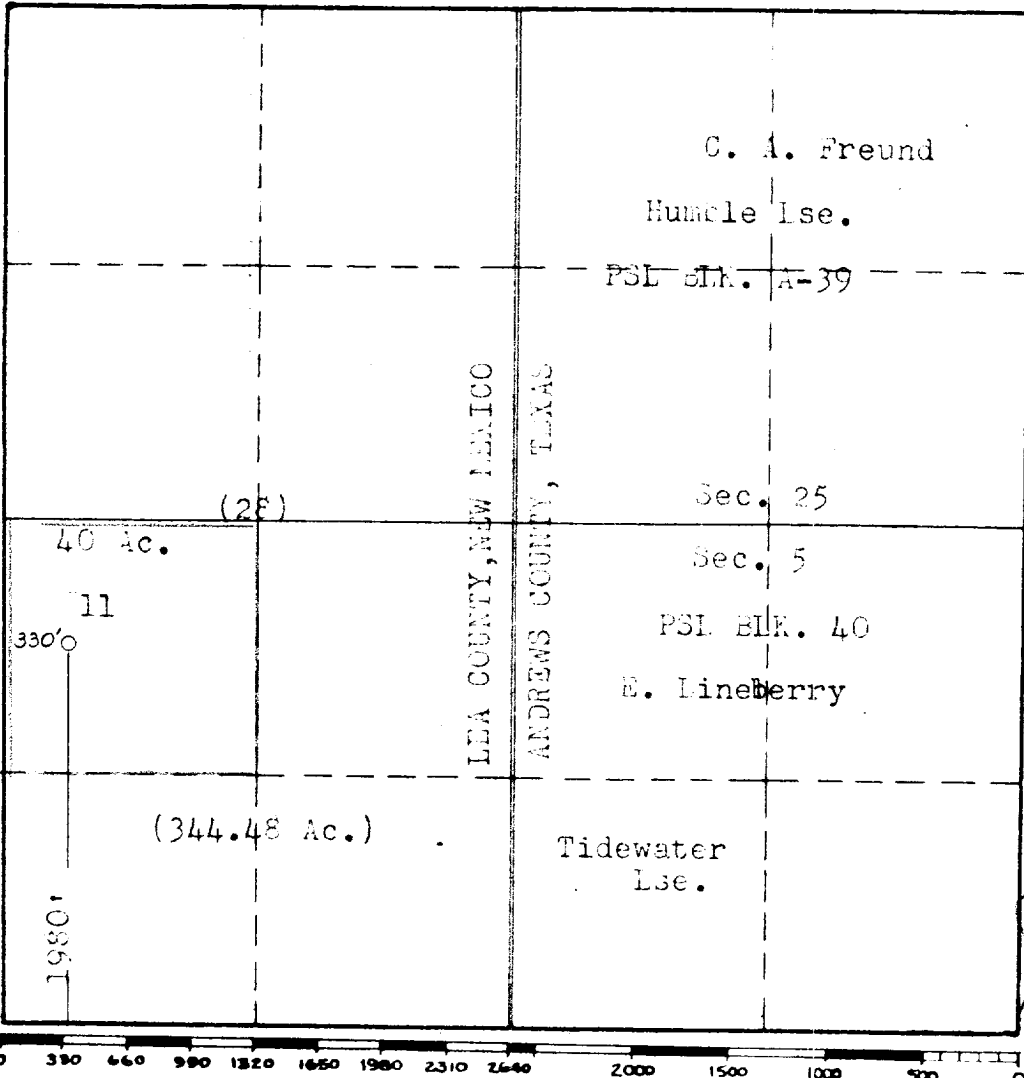

This is to certify that the information in Section A above is true and complete to the best of my knowledge and belief.

TEXACO Inc.

(Operator)

(Representative)

Division Civil Engineer
P.O. Box 3109, Midland, Texas
Address

This is to certify that the well location shown on the plat in Section B was plotted from field notes of actual surveys made by me or under my supervision and that the same is true and correct to the best of my knowledge and belief.

Date Surveyed 10-31-59

Registered Professional
Engineer and/or Land Surveyor.

Certificate No. 8174

Date 10-31-59

1. Is the Operator the only owner* in the dedicated acreage outlined on the plat below? Yes X No _____.

2. If the answer to question one is "no," have the interests of all the owners been consolidated by communitization agreement or otherwise? Yes _____ No _____. If answer is "yes," Type of Consolidation _____

3. If the answer to question two is "no," list all the owners and their respective interests below:

U. S. GEOLOGICAL SURVEY
HOBBS, NEW MEXICO

Registered Professional
Engineer and/or Land Surveyor.

8, 14