

COUN: LEA FIELD Tubb STATE NM
 OPR GULF OIL CORP. API 30-025-12172
 NO 4 LEASE Scarborough Estate MAP
 Sec 31, T22S, R38E CO-ORD
 1980 FNL, 1980 FWL of Sec 5-3-26 NM
 7 mi SE/Eunice RE-SPD 4-28-83 RE-CMP 5-2-83

SC

13 3/8-365-400 sx

8 5/8-3200-1625 sx

5 1/2-7083-830 sx

WELL CLASS: INIT DX FIN DG LSE. CODE			
FORMATION		DATUM	
ID 7085 (WFMP)		PBD 7078	

IP (Tubb) Perfs 5940-6204 P 69 MCFGPD. Pot based on 24 hr test. GOR (NR); gty (Gas) (NR); (Cond) (NR)

CONTR OPRSELEV 3324 GL sub-s

5-16-83 F.R.C. 5-21-83 OWWO
 PD 7078 WO
 (Orig. Cmp. 12-22-58 dual thru (Blinebry)
 Perfs 5395-5506 & thru (Tubb) Perfs 5940-
 6204, OTD 7085, OPB 7078)
 TD 7085; PBD 7078; Complete
 Sqzd (5395-5506) 166 sx & DOC
 No other work performed
 5-21-83 COMPLETION ISSUED

5-3-26 NM
 IC 30-025-70306-83

COUNTY: LEA FIELD: Brunson, S. STATE: NM
 OPR: GULF OIL CORP. API: 30-025-12172
 NO: 4 LEASE: Scarborough Estate MAP:
 Sec 31, T22S, R38E COORD: 8-1-35 NM
1980 FNL, 1980 FWL of Sec
7 ml SE/Eunice RECD: 6-1-83 RECD: 6-10-83

CSC:
 13 3/8-365-400 sx
 8 5/8-3200-1625 sx
 5 1/2-7083-830 sx

WELL CLASS: INIT DX FIN DO LSE CODE			
FORMATION	DATUM	FORMATION	DATUM
ID 7085 (WFMP)		PBD 7078	

IP (Abo) Perfs 6671-7065 P 12 BOPD + 3 BW. Pot based on 24 hr test. GOR TSTM; gty (NR)

CONTR: OPRS ELEV: 3324 GL sub-s

8-1-83 F.R.C. 8-6-83 OWWO
 PD 7078 WO
 (Orig. Cmp 12-22-58 dual thru (Blinbry) Perfs 5395-5506 & (Tubb) Perfs 5940-6204, OTD 7085, OPB 7078; OWWO & Re-Cmp 5-2-83 thru (Tubb) Perfs 5940-6204, OTD 7085, O - 7078)
 TD 7085; PBD 7078; Complete
 Sqzd (5940-6204)
 DO to 7078
 Perf (Abo) 6671-7065
 Acid (6671-7065) 10,000 gals
 Frac (6671-7065) 16,000 gals + 400 lb gel
 + 24,000 gals slick acid, no ad
 8-6-83 COMPLETION ISSUED

8-1-83
 ID 7085 6-10-83

NUMBER OF COPIES RECEIVED	
DISTRIBUTION	
SANTA FE	
FILE	
U.S.G.S.	
LAND OFFICE	
TRANSPORTER	OIL
	GAS
PRODUCTION OFFICE	
OPERATOR	

NEW MEXICO OIL CONSERVATION COMMISSION
WELL LOCATION AND ACREAGE DEDICATION PLAT
 SEE INSTRUCTIONS FOR COMPLETING THIS FORM ON THE REVERSE SIDE

FORM C-128
 Revised 5/1/57

SECTION A

Operator Gulf Oil Corporation			Lease Seaborough Estate		Well No. 4
Unit Letter F	Section 31	Township 22-S	Range 38-E	County Lea	
Actual Footage Location of Well: 1980 feet from the North line and 1980 feet from the West line					
Ground Level Elev. 3324	Producing Formation Elmabry		Pool Elmabry		Dedicated Acreage: 40 Acres

1. Is the Operator the only owner in the dedicated acreage outlined on the plat below? YES **X** NO ____ . ("Owner" means the person who has the right to drill into and to produce from any pool and to appropriate the production either for himself or for himself and another. (65-3-29 (e) NMSA 1935 Comp.)
2. If the answer to question one is "no," have the interests of all the owners been consolidated by communitization agreement or otherwise? YES ____ NO ____ . If answer is "yes," Type of Consolidation _____
3. If the answer to question two is "no," list all the owners and their respective interests below:

Owner	Land Description

SECTION B

CERTIFICATION

I hereby certify that the information in SECTION A above is true and complete to the best of my knowledge and belief.

Name <i>[Signature]</i>
Position Area Production Manager
Company Gulf Oil Corporation
Date March 25, 1963

I hereby certify that the well location shown on the plat in SECTION B was plotted from field notes of actual surveys made by me or under my supervision, and that the same is true and correct to the best of my knowledge and belief.

Date Surveyed
Registered Professional Engineer and/or Land Surveyor

Certificate No.

0 330 660 990 1320 1650 1980 2310 2640 2000 1500 1000 500 0

INSTRUCTIONS FOR COMPLETION OF FORM C-128

1. Operator shall furnish and certify to the information called for in Section A.
2. Operator shall outline the dedicated acreage for *both* oil and gas wells on the plat in Section B.
3. A registered professional engineer or land surveyor registered in the State of New Mexico or approved by the Commission shall show on the plat the location of the well and certify this information in the space provided.
4. All distances shown on the plat must be from the outer boundaries of the Section.
5. If additional space is needed for listing owners and their respective interests as required in question 3 of Section A, please use space below.

NUMBER OF COPIES RECEIVED	
DISTRIBUTION	
SANTA FE	
FILE	
U.S.G.S.	
LAND OFFICE	
TRANSPORTER	OIL GAS
PRODUCTION OFFICE	
OPERATOR	

NEW MEXICO OIL CONSERVATION COMMISSION
WELL LOCATION AND ACREAGE DEDICATION PLAT
 SEE INSTRUCTIONS FOR COMPLETING THIS FORM ON THE REVERSE SIDE

FORM C-128
 Revised 5/1/57

SECTION A

1962 DEC 5 PM 10 09

Operator Gulf Oil Corporation		Lease Scarborough Estate		Well No. 4
Unit Letter F	Section 31	Township 22-S	Range 38-E	County Lea
Actual Footage Location of Well: 1980 feet from the North line and 1980 feet from the West line				
Ground Level Elev. 3324	Producing Formation Blinberry	Pool Blinberry Gas	Dedicated Acreage: 120 Acres	

1. Is the Operator the only owner in the dedicated acreage outlined on the plat below? YES ☒ NO ____ . ("Owner" means the person who has the right to drill into and to produce from any pool and to appropriate the production either for himself or for himself and another. (65-3-29 (e) NMSA 1935 Comp.)
2. If the answer to question one is "no," have the interests of all the owners been consolidated by communitization agreement or otherwise? YES ____ NO ____ . If answer is "yes," Type of Consolidation _____
3. If the answer to question two is "no," list all the owners and their respective interests below:

Owner	Land Description

SECTION B

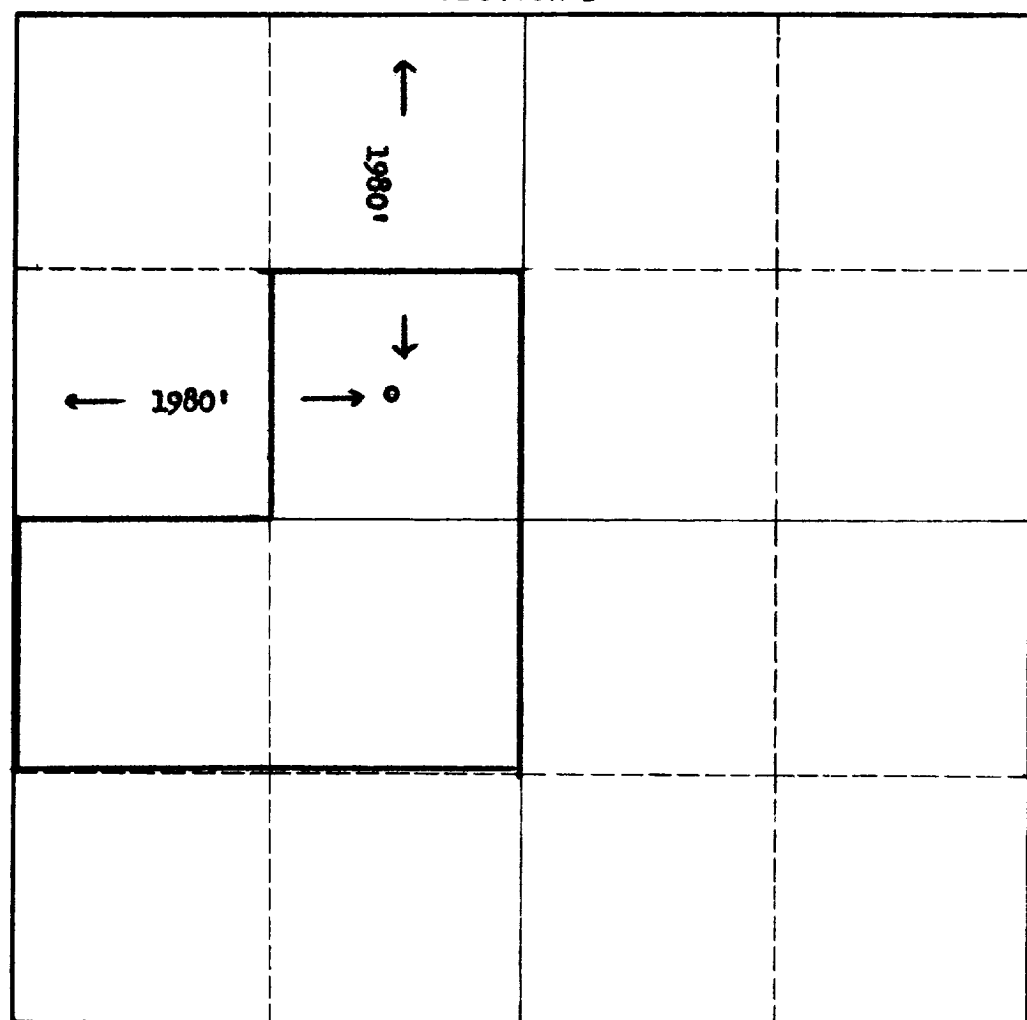

CERTIFICATION

I hereby certify that the information in SECTION A above is true and complete to the best of my knowledge and belief.

Name	<i>J. C. Ballinger</i>
Position	Area Petroleum Engineer
Company	Gulf Oil Corporation
Date	December 4, 1962

I hereby certify that the well location shown on the plat in SECTION B was plotted from field notes of actual surveys made by me or under my supervision, and that the same is true and correct to the best of my knowledge and belief.

Date Surveyed	
Registered Professional Engineer and/or Land Surveyor	
Certificate No.	

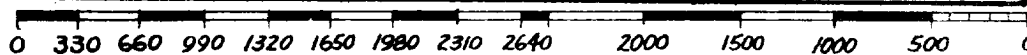

INSTRUCTIONS FOR COMPLETION OF FORM C-128

1. Operator shall furnish and certify to the information called for in Section A.
2. Operator shall outline the dedicated acreage for *both* oil and gas wells on the plat in Section B.
3. A registered professional engineer or land surveyor registered in the State of New Mexico or approved by the Commission shall show on the plat the location of the well and certify this information in the space provided.
4. All distances shown on the plat must be from the outer boundaries of the Section.
5. If additional space is needed for listing owners and their respective interests as required in question 3 of Section A, please use space below.

NUMBER OF COPIES RECEIVED	
DISTRIBUTION	
SANTA FE	
FILE	
U.S.G.S.	
LAND OFFICE	
TRANSPORTER	OIL GAS
PRODUCTION OFFICE	
OPERATOR	

NEW MEXICO OIL CONSERVATION COMMISSION
WELL LOCATION AND ACREAGE DEDICATION PLAT
 SEE INSTRUCTIONS FOR COMPLETING THIS FORM ON THE REVERSE

FORM C-128
Revised 5/1/57

SECTION A

Operator Gulf Oil Corporation		Lease Searborough Estate		Well No. 4
Unit Letter F	Section 31	Township 22-S	Range 38-E	County Lea
Actual Footage Location of Well: 1980 feet from the North line and 1980 feet from the West line				
Ground Level Elev. 3124	Producing Formation Blinberry	Pool Blinberry Gas	Dedicated Acreage: 160 Acres	

1. Is the Operator the only owner in the dedicated acreage outlined on the plat below? YES ☒ NO ____ . ("Owner" means the person who has the right to drill into and to produce from any pool and to appropriate the production either for himself or for himself and another. (65-3-29 (e) NMSA 1935 Comp.)
2. If the answer to question one is "no," have the interests of all the owners been consolidated by communitization agreement or otherwise? YES ____ NO ____ . If answer is "yes," Type of Consolidation _____
3. If the answer to question two is "no," list all the owners and their respective interests below:

Owner	Land Description

SECTION B

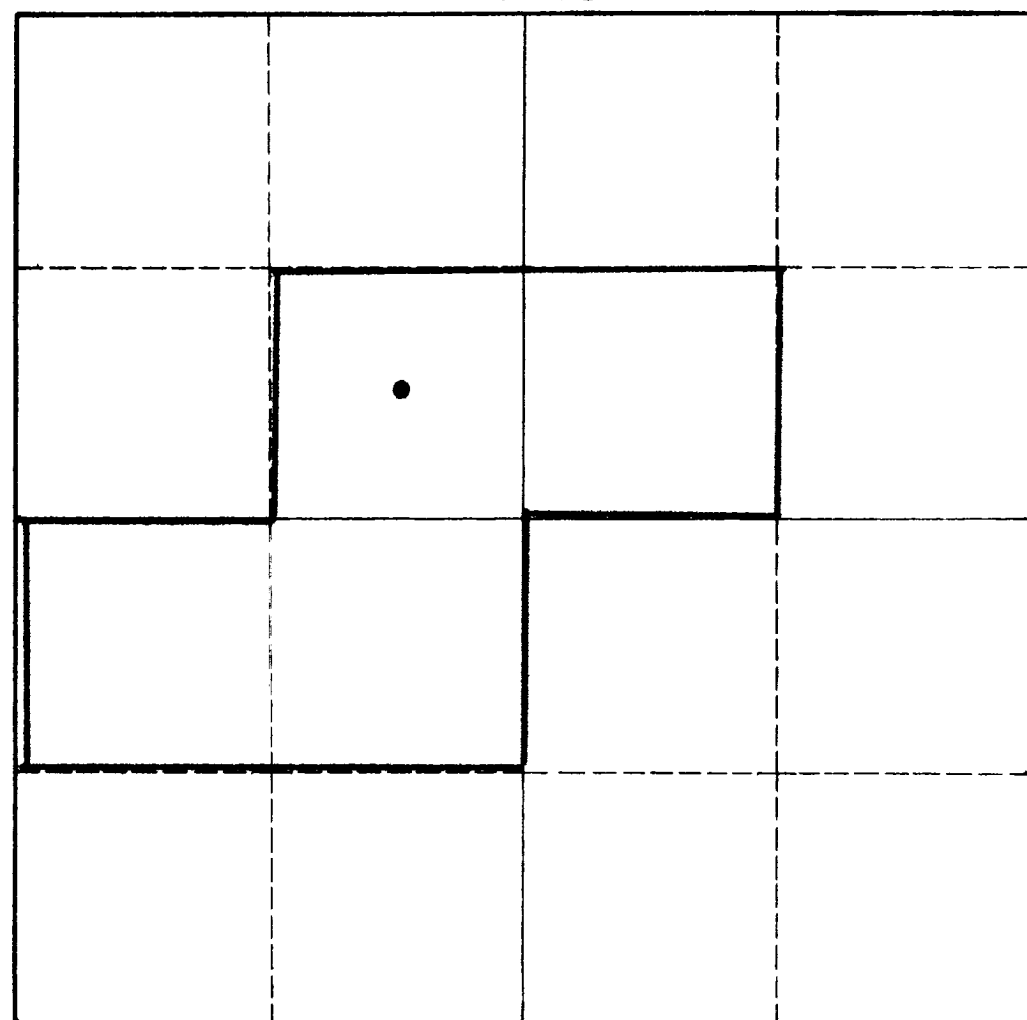

CERTIFICATION

I hereby certify that the information in SECTION A above is true and complete to the best of my knowledge and belief.

Name <i>X. H. Russell</i>
Position Area Production Manager
Company Gulf Oil Corporation
Date April 23, 1962

I hereby certify that the well location shown on the plat in SECTION B was plotted from field notes of actual surveys made by me or under my supervision, and that the same is true and correct to the best of my knowledge and belief.

Date Surveyed
Registered Professional Engineer and/or Land Surveyor
Certificate No.

0 330 660 990 1320 1650 1980 2310 2640 2000 1500 1000 500 0

INSTRUCTIONS FOR COMPLETION OF FORM C-128

1. Operator shall furnish and certify to the information called for in Section A.
2. Operator shall outline the dedicated acreage for *both* oil and gas wells on the plat in Section B.
3. A registered professional engineer or land surveyor registered in the State of New Mexico or approved by the Commission shall show on the plat the location of the well and certify this information in the space provided.
4. All distances shown on the plat must be from the outer boundaries of the Section.
5. If additional space is needed for listing owners and their respective interests as required in question 3 of Section A, please use space below.

SECTION A

Operator Gulf Oil Corporation		Lease Garborough Estate		Well No. 4
Unit Letter F	Section 31	Township 22-S	Range 38-E	County La
Actual Footage Location of Well: 1930 feet from the North line and 1950 feet from the East line				
Ground Level Elev. 1124	Producing Formation Blinberry	Pool Blinberry Gas	Dedicated Acreage: 120 Acres	

1. Is the Operator the only owner in the dedicated acreage outlined on the plat below? YES X NO ____ . ("Owner" means the person who has the right to drill into and to produce from any pool and to appropriate the production either for himself or for himself and another. (65-3-29 (e) NMSA 1935 Comp.)
2. If the answer to question one is "no," have the interests of all the owners been consolidated by communitization agreement or otherwise? YES ____ NO ____ . If answer is "yes," Type of Consolidation _____
3. If the answer to question two is "no," list all the owners and their respective interests below:

Owner	Land Description

SECTION B

CERTIFICATION

I hereby certify that the information in SECTION A above is true and complete to the best of my knowledge and belief.

ORIGINAL SIGNED

Name J. M. RUSSELL

Position	Area reduction manager
----------	------------------------

Company	Gulf Oil Corporation
---------	----------------------

Date
September 26, 1961

I hereby certify that the well location shown on the plat in SECTION B was plotted from field notes of actual surveys made by me or under my supervision, and that the same is true and correct to the best of my knowledge and belief.

Date Surveyed

Registered Professional Engineer
and/or Land Surveyor

Certificate No.

INSTRUCTIONS FOR COMPLETION OF FORM C-128

1. Operator shall furnish and certify to the information called for in Section A.
2. Operator shall outline the dedicated acreage for *both* oil and gas wells on the plat in Section B.
3. A registered professional engineer or land surveyor registered in the State of New Mexico or approved by the Commission shall show on the plat the location of the well and certify this information in the space provided.
4. All distances shown on the plat must be from the outer boundaries of the Section.
5. If additional space is needed for listing owners and their respective interests as required in question 3 of Section A, please use space below.

NEW MEXICO OIL CONSERVATION COMMISSION

Well Location and Acreage Dedication Plat

Section A.

Date 4-9-59

Operator Gulf Oil Corporation Lease Scarborough Estate
Well No. 4 Unit Letter F Section 31 Township 22-S Range 38-E NMPM
Located 1980 Feet From North Line, 1980 Feet From West Line
County Lea G. L. Elevation 3324.2' Dedicated Acreage 160 Acres
Name of Producing Formation Blinebry Pool Blinebry Gas

1. Is the Operator the only owner* in the dedicated acreage outlined on the plat below?
Yes X No .
2. If the answer to question one is "no," have the interests of all the owners been consolidated by communitization agreement or otherwise? Yes No . If answer is "yes," Type of Consolidation
3. If the answer to question two is "no," list all the owners and their respective interests below:

Owner

Land Description

Section B



- Dual



- Oil Well



- Acreage Dedicated

- Lease Line

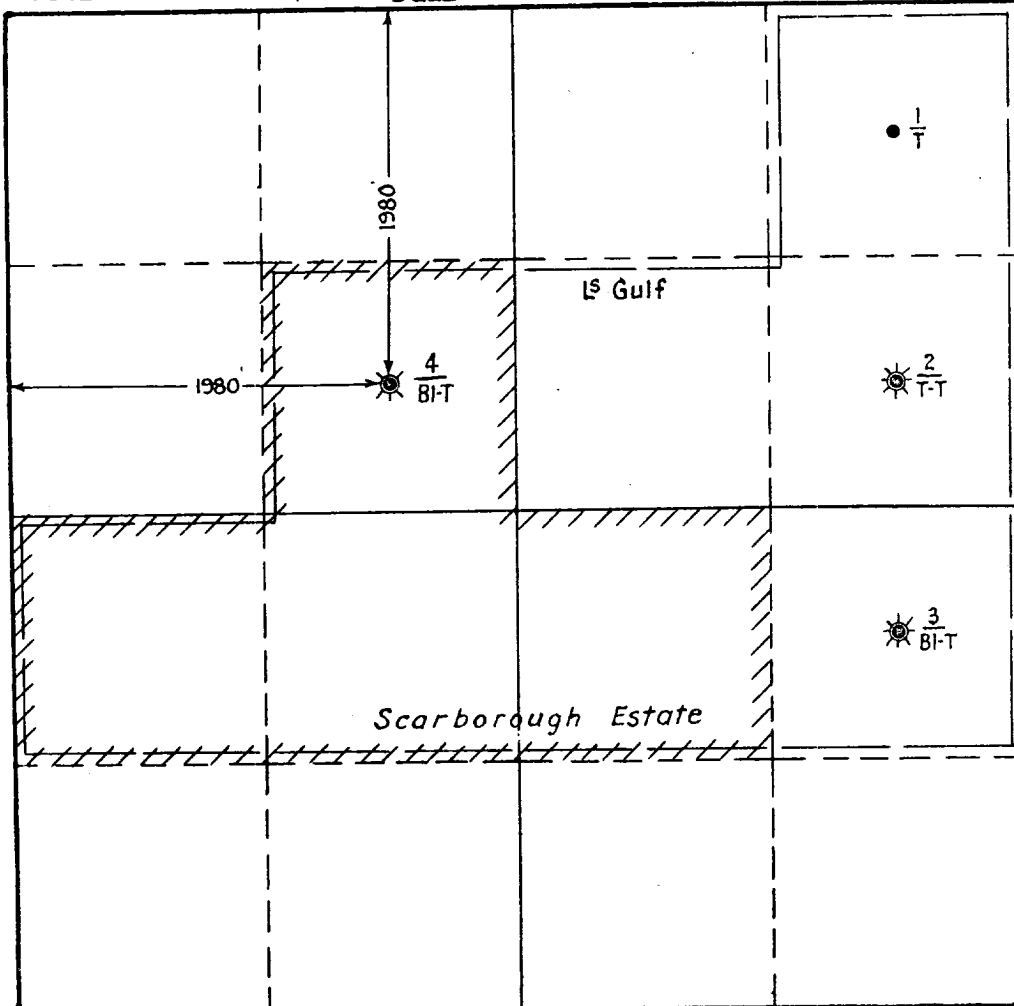

This is to certify that the information in Section A above is true and complete to the best of my knowledge and belief.

Gulf Oil Corporation
(Operator)

J. H. King, Jr.
(Representative)

P. O. Box 1290
Fort Worth 1, Texas
Address

This is to certify that the well location shown on the plat in Section B was plotted from field notes of actual surveys made by me or under my supervision and that the same is true and correct to the best of my knowledge and belief.

Date Surveyed

Registered Professional
Engineer and/or Land Surveyor.

Certificate No.

INSTRUCTIONS FOR COMPLETION:

1. Operator shall furnish and certify to the information called for in Section A.
2. Operator shall outline the dedicated acreage for both oil and gas wells on the plat in Section B.
3. A registered professional engineer or land surveyor registered in the State of New Mexico or approved by the Commission shall show on the plat the location of the well and certify this information in the space provided.
4. All distances shown on the plat must be from the outer boundaries of Section.
5. If additional space is needed for listing owners and their respective interests as required in question 3, Section A, please use space below

* "Owner" means the person who has the right to drill into and to produce from any pool and to appropriate the production either for himself or for himself and another. (65-3-29 (e) NMSA 1953 Comp.)

CORRECTED

NEW MEXICO OIL CONSERVATION COMMISSION

Well Location and Acreage Dedication Plat

Section A.

Date 4-9-59

Operator Gulf Oil Corporation Lease Scarborough Estate
Well No. 4 Unit Letter F Section 31 Township 22-S Range 38-E NMPM
Located 1980 Feet From North Line, 1980 Feet From West Line
County Lea G. L. Elevation 3324.2' Dedicated Acreage 160 Acres
Name of Producing Formation Tubb Pool Tubb Gas

1. Is the Operator the only owner* in the dedicated acreage outlined on the plat below?
Yes X No .
2. If the answer to question one is "no," have the interests of all the owners been consolidated by communitization agreement or otherwise? Yes No . If answer is "yes," Type of Consolidation
3. If the answer to question two is "no," list all the owners and their respective interests below:

Owner

Land Description

Section B

☼ - Dual

• - Oil Well

//// - Acreage Dedicated

----- - Lease Line

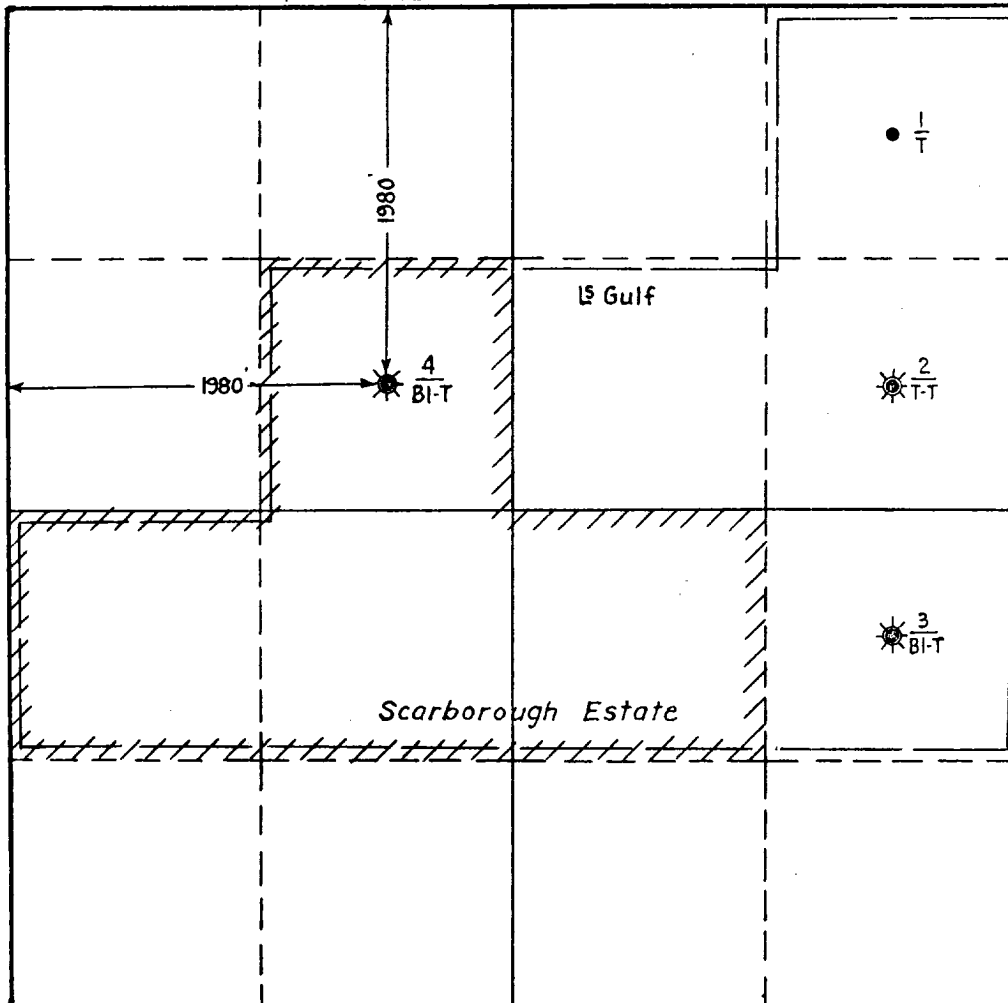

This is to certify that the information in Section A above is true and complete to the best of my knowledge and belief.

Gulf Oil Corporation
(Operator)

J. H. King, Jr.
(Representative)

P. O. Box 1290
Fort Worth 1, Texas
Address

This is to certify that the well location shown on the plat in Section B was plotted from field notes of actual surveys made by me or under my supervision and that the same is true and correct to the best of my knowledge and belief.

Date Surveyed

Registered Professional
Engineer and/or Land Surveyor.

Certificate No.

INSTRUCTIONS FOR COMPLETION:

1. Operator shall furnish and certify to the information called for in Section A.
2. Operator shall outline the dedicated acreage for both oil and gas wells on the plat in Section B.
3. A registered professional engineer or land surveyor registered in the State of New Mexico or approved by the Commission shall show on the plat the location of the well and certify this information in the space provided.
4. All distances shown on the plat must be from the outer boundaries of Section.
5. If additional space is needed for listing owners and their respective interests as required in question 3, Section A, please use space below

* "Owner" means the person who has the right to drill into and to produce from any pool and to appropriate the production either for himself or for himself and another. (65-3-29 (e) NMSA 1953 Comp.)

NEW MEXICO OIL CONSERVATION COMMISSION

Well Location and Acreage Dedication Plat

RUDS OFFICE 000

Section A.

Date 1-29-59

Operator Gulf Oil Corporation Lease 1959, MAY 15, 1959 Scarborough Estate 52
 Well No. 4 Unit Letter F Section 31 Township 22-S Range 38-E NMPM
 Located 1980 Feet From North Line, 1980 Feet From West Line
 County Lea G. L. Elevation 3324.2' Dedicated Acreage 40¹/₂ Acres
 Name of Producing Formation Tubb Pool Tubb Gas

1. Is the Operator the only owner* in the dedicated acreage outlined on the plat below?
Yes X No .
2. If the answer to question one is "no," have the interests of all the owners been consolidated by communitization agreement or otherwise? Yes No . If answer is "yes," Type of Consolidation
3. If the answer to question two is "no," list all the owners and their respective interests below: #Application for a non-standard gas proration unit will be submitted.

OwnerLand Description

Section B

☼ - Dual

• - Oil Well

///// - Acreage Dedicated

- - - - - Lease Line

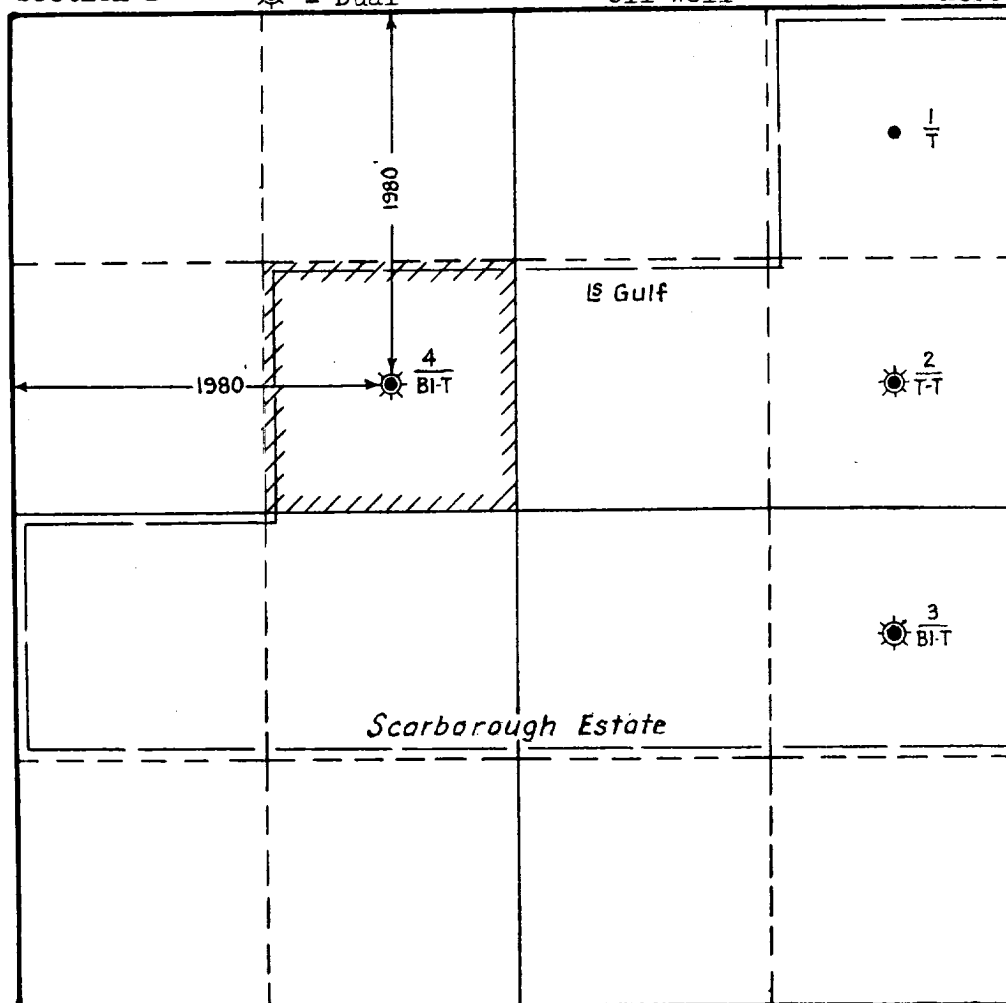

This is to certify that the information in Section A above is true and complete to the best of my knowledge and belief.

Gulf Oil Corporation
(Operator)

AM King, Jr.
(Representative)
P. O. Box 1290
Fort Worth 1, Texas
Address

This is to certify that the well location shown on the plat in Section B was plotted from field notes of actual surveys made by me or under my supervision and that the same is true and correct to the best of my knowledge and belief.

Date Surveyed

Registered Professional
Engineer and/or Land Surveyor.

Certificate No.

(See instructions for completing this form on the reverse side)

INSTRUCTIONS FOR COMPLETION:

1. Operator shall furnish and certify to the information called for in Section A.
2. Operator shall outline the dedicated acreage for both oil and gas wells on the plat in Section B.
3. A registered professional engineer or land surveyor registered in the State of New Mexico or approved by the Commission shall show on the plat the location of the well and certify this information in the space provided.
4. All distances shown on the plat must be from the outer boundaries of Section.
5. If additional space is needed for listing owners and their respective interests as required in question 3, Section A, please use space below

* "Owner" means the person who has the right to drill into and to produce from any pool and to appropriate the production either for himself or for himself and another. (65-3-29 (e) NMSA 1953 Comp.)

NEW MEXICO OIL CONSERVATION COMMISSION

Well Location and Acreage Dedication Plat

HOBBS OFFICE 000

Section A.

Date 1-29-59

Operator Gulf Oil Corporation Lease 1959 Scarborough Estate
Well No. 4 Unit Letter F Section 31 Township 22-S Range 38-E NMPM
Located 1980 Feet From North Line, 1980 Feet From West Line
County Lea G. L. Elevation 3324.2' Dedicated Acreage 40# Acres
Name of Producing Formation Blinebry Pool Blinebry Gas

1. Is the Operator the only owner* in the dedicated acreage outlined on the plat below?
Yes X No .
2. If the answer to question one is "no," have the interests of all the owners been consolidated by communitization agreement or otherwise? Yes No . If answer is "yes," Type of Consolidation
3. If the answer to question two is "no," list all the owners and their respective interests below: #Application for a non-standard gas proration unit will be submitted.

Owner

Land Description

Section B

☼ - Dual

● - Oil Well

//////// - Acreage Dedicated

----- - Lease Line

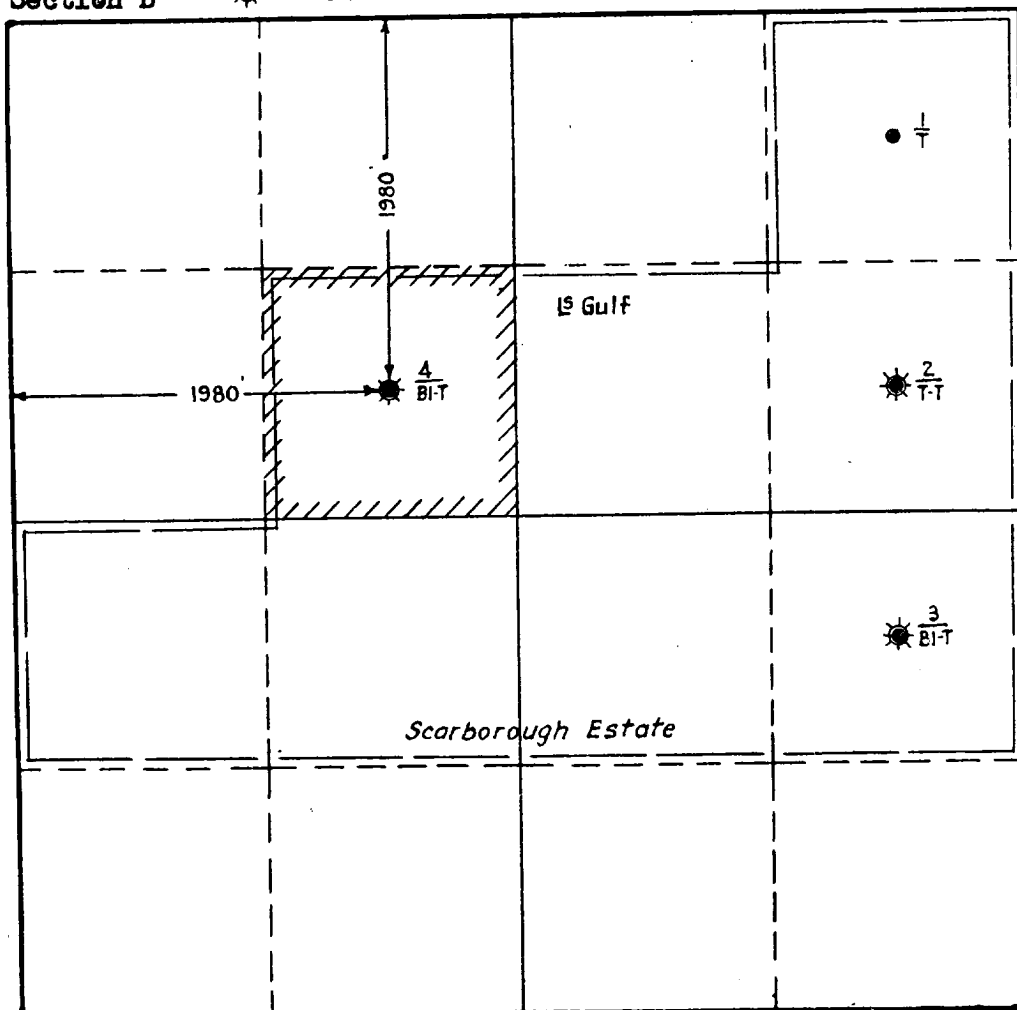

This is to certify that the information in Section A above is true and complete to the best of my knowledge and belief.

Gulf Oil Corporation
(Operator)

J. M. King, Jr.
(Representative)

P. O. Box 1290
Fort Worth 1, Texas
Address

This is to certify that the well location shown on the plat in Section B was plotted from field notes of actual surveys made by me or under my supervision and that the same is true and correct to the best of my knowledge and belief.

Date Surveyed

Registered Professional
Engineer and/or Land Surveyor.

Certificate No.

(See instructions for completing this form on the reverse side)

INSTRUCTIONS FOR COMPLETION:

1. Operator shall furnish and certify to the information called for in Section A.
2. Operator shall outline the dedicated acreage for both oil and gas wells on the plat in Section B.
3. A registered professional engineer or land surveyor registered in the State of New Mexico or approved by the Commission shall show on the plat the location of the well and certify this information in the space provided.
4. All distances shown on the plat must be from the outer boundaries of Section.
5. If additional space is needed for listing owners and their respective interests as required in question 3, Section A, please use space below

* "Owner" means the person who has the right to drill into and to produce from any pool and to appropriate the production either for himself or for himself and another. (65-3-29 (e) NMSA 1953 Comp.)