

NEW MEXICO OIL CONSERVATION COMMISSION
Well Location and Acreage Dedication Plat

Section A.

Date 7-30-57

Operator Gulf Oil Corp. Lease L. R. Andrews
Well No. 3-T Unit Letter J Section 32 Township 22 S Range 38 E NMPM
Located 1980 Feet From South Line, 1980 Feet From East Line
County Lea G. L. Elevation _____ Dedicated Acreage 40 Acres
Name of Producing Formation _____ Pool _____

1. Is the Operator the only owner* in the dedicated acreage outlined on the plat below?
Yes ☒ No _____.
2. If the answer to question one is "no," have the interests of all the owners been consolidated by communitization agreement or otherwise? Yes _____ No _____. If answer is "yes," Type of Consolidation _____
3. If the answer to question two is "no," list all the owners and their respective interests below:

Owner

Land Description

Section B

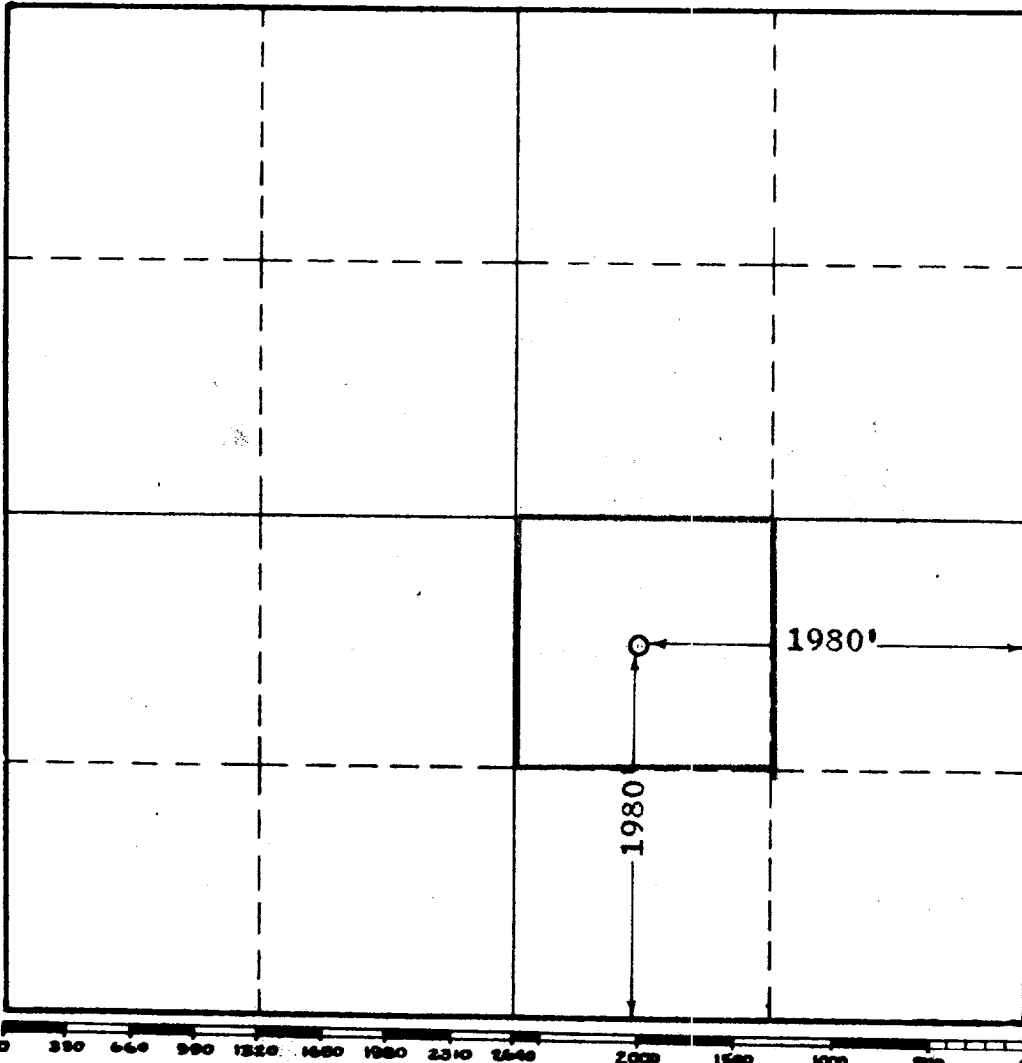

This is to certify that the information in Section A above is true and complete to the best of my knowledge and belief.

Gulf Oil Corporation

(Operator)

John Russell
(Representative)

Asst. Area Supt. of Prod.
Box 2167, Hobbs, New Mexico
Address

This is to certify that the well location shown on the plat in Section B was plotted from field notes of actual surveys made by me or under my supervision and that the same is true and correct to the best of my knowledge and belief.

Date Surveyed 7-30-57

John W. West
Registered Professional
Engineer and/or Land Surveyor.

Certificate No. 676

(See instructions for completing this form on the reverse side)