

NONES 11-11-64

FEB 12 11 20 AM '64

February 13, 1964

New Mexico Oil Conservation Commission
P. O. Box 2088
Santa Fe, New Mexico

Re: Multiple Completion Application
TEXACO Inc., A. H. Blinebry (NCT-1)
Well No. 3, Tubb (Gas) and South
(Paddock) Pools, Lea County, New Mexico

ATTENTION: Mr. A. L. Porter, Jr.

Gentlemen:

TEXACO Inc. respectfully requests exception to Rule 112-A (I) to permit the dual completion of A. H. Blinebry (NCT-1) Well No. 3 in the South Paddock and Tubb (Gas) Pools, located in the SW/4 NW/4 of Section 33, Township 22 South, Range 38 East, Lea County, New Mexico. This well was previously approved by Order No. DC-724 for dually completing in the Tubb (Gas) Pool and Blinebry (Oil) Pool. Since initially completing the subject well, the production from the Blinebry zone has declined to marginal commercial value.

It is TEXACO's desire to recomplete the well in the South Paddock Pool and isolate the Blinebry by setting a packer between the Paddock and Blinebry zones and use the existing packer to separate the Blinebry from the Tubb zone as indicated on the attached diagram. This would prevent production from being obtained from the Blinebry zone as well as hold the zone in reserve for whatever commercial value it may have in the future. It is intended to place inverted oil-emulsion mud between the packers and run parallel tubing strings for producing the Paddock and Tubb zones.

Your favorable consideration of TEXACO's request would be appreciated.

Yours very truly,

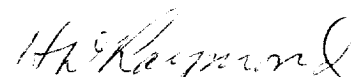

H. D. Raymond
Assistant District Superintendent

WPI/om

cc: HMOCC

Attachment

1. The first group of people who are not in the labor force are those who are not in the labor force for any reason. This group is the largest and is made up of people who are not in the labor force for any reason. This group is the largest and is made up of people who are not in the labor force for any reason.

Journal of Management Education 30(6)p.789-804

(1) The Commission of the European Communities (CEC) has been established by the Treaty of Rome, which entered into force on 1 January 1973. The CEC is responsible for the implementation of the common agricultural policy (CAP) and the common transport policy (CTP). The CEC also has the task of ensuring the proper functioning of the internal market.

1. The first of the three main parts of the report is a general survey of the situation in the country. This part is divided into three sections: (a) the political situation, (b) the economic situation, and (c) the social situation. The second part of the report is a detailed study of the political situation. This part is divided into two sections: (a) the political system, and (b) the political parties. The third part of the report is a detailed study of the economic situation. This part is divided into two sections: (a) the economic system, and (b) the economic problems. The fourth part of the report is a detailed study of the social situation. This part is divided into two sections: (a) the social system, and (b) the social problems. The fifth part of the report is a summary of the findings of the study. This part is divided into two sections: (a) the conclusions, and (b) the recommendations. The sixth part of the report is a bibliography of the sources used in the study. This part is divided into two sections: (a) the books, and (b) the articles. The seventh part of the report is an index of the subjects covered in the report. This part is divided into two sections: (a) the subjects, and (b) the pages. The eighth part of the report is a list of the names of the persons who have contributed to the study. This part is divided into two sections: (a) the names, and (b) the addresses. The ninth part of the report is a list of the names of the persons who have assisted in the study. This part is divided into two sections: (a) the names, and (b) the addresses. The tenth part of the report is a list of the names of the persons who have assisted in the study. This part is divided into two sections: (a) the names, and (b) the addresses.

...and the other is the fact that the system is not self-correcting. The system is not self-correcting because the system is not self-correcting.

... ..

Figure 1. The effect of the concentration of the *Agrobacterium* suspension on the transformation efficiency of *Agrobacterium* strains.

1000

1. *Chlorophyll a* and *Chlorophyll b* were determined by the method of Arar and Collins (1987).

NEW MEXICO OIL CONSERVATION COMMISSION

SANTA FE, NEW MEXICO

O.C.C.

5-1-61

APPLICATION FOR MULTIPLE COMPLETION

Feb 13 1964

Operator TEXACO Inc.		County Lea	Date February 13, 1964
Address P. O. Box 728, Hobbs, New Mexico		Lease A. H. Blinbry HCT-1	Well No. 8
Location of Well E	Unit 33	Township 22-S	Range 38-E

1. Has the New Mexico Oil Conservation Commission heretofore authorized the multiple completion of a well in these same pools or in the same zones within one mile of the subject well? YES ☒ NO ☐
2. If answer is yes, identify one such instance: Order No. **R-1152**; Operator, Lease, and Well No.:

Gulf Oil Corp., T. R. Andrews Well No. 3

3. The following facts are submitted:	Upper Zone	Intermediate Zone	Lower Zone
a. Name of Pool and Formation	South Paddock	Blinbry	Tubb (Gas)
b. Top and Bottom of Pay Section (Perforations)	5214, 5217, 5223	5584-5634 5676-5722 5755-5800	6150-6230
c. Type of production (Oil or Gas)	Oil	Oil	Gas
d. Method of Production (Flowing or Artificial Lift)	Pump	Temporarily shut in between packers	Flow

4. The following are attached. (Please mark YES or NO)

- ~~Yes~~ a. Diagrammatic Sketch of the Multiple Completion, showing all casing strings, including diameters and setting depths, centralizers and /or turbolizers and location thereof, quantities used and top of cement, perforated intervals, tubing strings, including diameters and setting depth, location and type of packers and side door chokes, and such other information as may be pertinent.
- ~~Yes~~ b. Plat showing the location of all wells on applicant's lease, all offset wells on offset leases, and the names and addresses of operators of all leases offsetting applicant's lease.
- ~~No~~ c. Waivers consenting to such multiple completion from each offset operator, or in lieu thereof, evidence that said offset operators have been furnished copies of the application.*
- ☒ d. Electrical log of the well or other acceptable log with tops and bottoms of producing zones and intervals of perforation indicated thereon. (If such log is not available at the time application is filed, it shall be submitted as provided by Rule 112-A.)

5. List all offset operators to the lease on which this well is located together with their correct mailing address.

Gulf Oil Corporation, P. O. Drawer 1938, Roswell, New Mexico

Anderson Pritchard Oil Corp., P.O. Box 1659, Midland, Texas

Tidewater Oil Company, P. O. Box 547, Hobbs, New Mexico

Great Western Drilling Company, P. O. Box 1659, Midland, Texas

6. Were all operators listed in Item 5 above notified and furnished a copy of this application? YES ☒ NO ☐. If answer is yes, give date of such notification **Feb. 13, 1964 by registered mail.**

CERTIFICATE: I, the undersigned, state that I am the **Assist. Dist. Supt.** of the **TEXACO Inc.** (company), and that I am authorized by said company to make this report; and that this report was prepared under my supervision and direction and that the facts stated therein are true, correct and complete to the best of my knowledge.

H. D. Raymond

Signature

- * Should waivers from all offset operators not accompany an application for administrative approval, the New Mexico Oil Conservation Commission will hold the application for a period of twenty (20) days from date of receipt by the Commission's Santa Fe office. If, after said twenty-day period, no protest nor request for hearing is received by the Santa Fe office, the application will then be processed.
- NOTE: If the proposed multiple completion will result in an unorthodox well location and/or a non-standard proration unit in either or both of the producing zones, then separate application for approval of the same should be filed simultaneously with this application.

*Log submitted with dual completion application, dated December 23, 1958.

DIAGRAMMATIC SKETCH SHOWING DUAL COMPLETION INSTALLATION

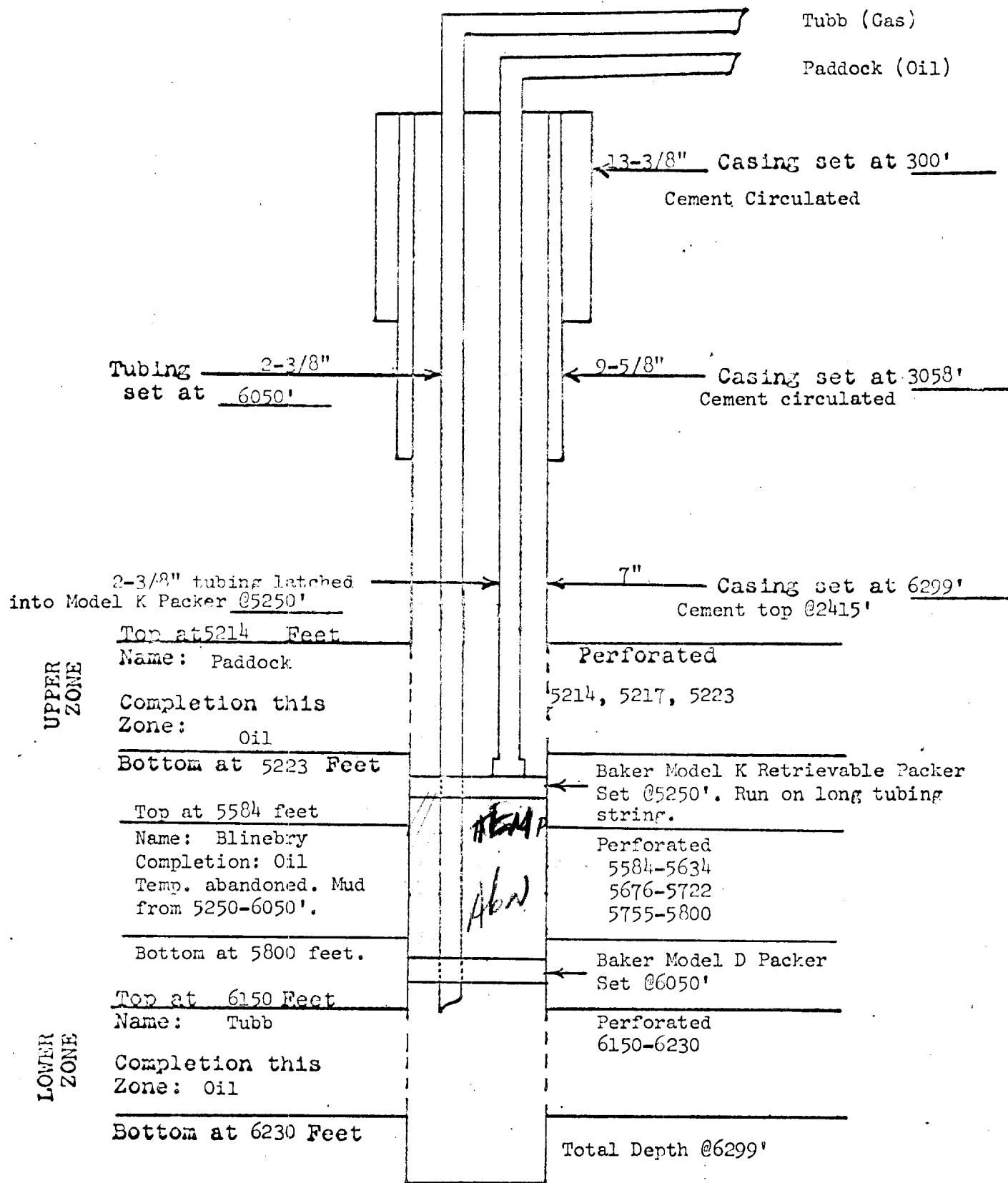

COMPANY: TEXACO Inc.

LEASE: A. H. Blinebry (NCT-1) Well No. 8

FIELD: Tubb (Gas) & South Paddock

DATE: February 13, 1964

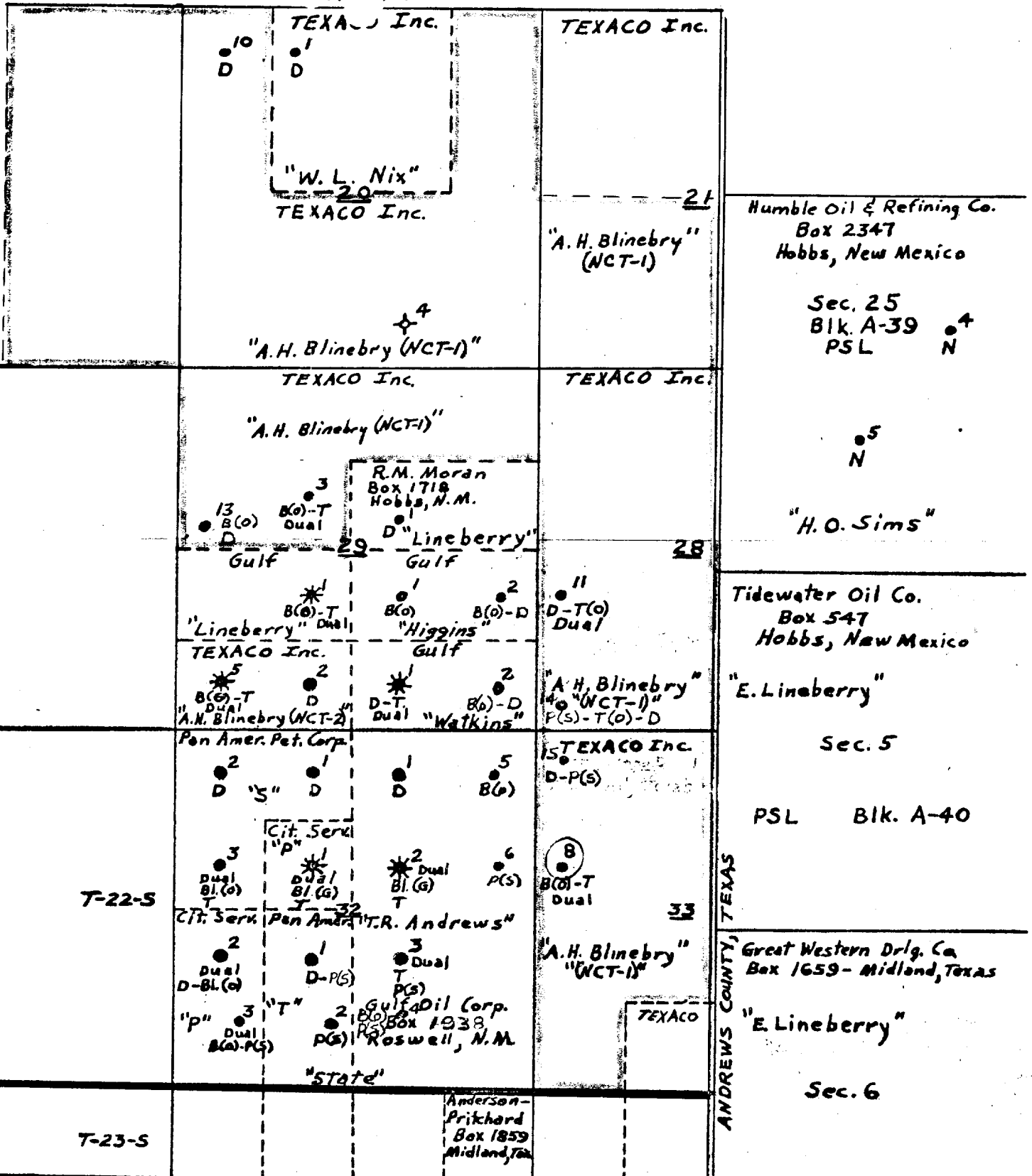

SCALE: 1"=2000'