

P. O. Box 352  
Midland, Texas  
December 23, 1958

DUAL COMPLETION APPLICATION  
The Texas Company  
A. H. Blinbry (NCT-1) Well No. 8  
Blinbry (Oil) & Tubb (Gas) Pools  
Lea County, New Mexico

New Mexico Oil Conservation Commission  
Box 871  
Santa Fe, New Mexico

Attention: Mr. A. L. Porter, Jr., Secretary-Director

Gentlemen:

In accordance with Order No. R-1214, The Texas Company requests administrative approval to dually complete the subject well in the Blinbry (Oil) and Tubb (Gas) Pools, Lea County, New Mexico.

All offset operators listed on the attached application have been notified by copy of this application through registered mail.

Yours very truly,

THE TEXAS COMPANY

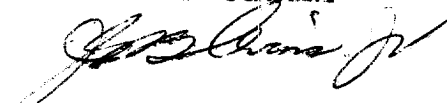

J. G. Blevins, Jr.  
Asst. Dist. Supt.

LMF-AR

Attach:

- cc: 2 - New Mexico Oil Conservation Commission - Box 2045 - Hobbs, New Mexico  
1 - Gulf Oil Corporation - Box 669 - Roswell, New Mexico  
1 - Tidewater Oil Company - Box 547 - Hobbs, New Mexico  
1 - Great Western Drilling Company - Box 1659 - Midland, Texas  
1 - Anderson Pritchard Oil Corporation - Box 1859 - Midland, Texas



## NEW MEXICO OIL CONSERVATION COMMISSION

SANTA FE, NEW MEXICO

7-3-58

## APPLICATION FOR DUAL COMPLETION

Field Name <b>Blinebry (Oil) &amp; Tubb (Gas)</b>		County <b>Lea</b>	Date <b>December 23, 1958</b>
Operator <b>The Texas Company</b>		Lease <b>A. H. Blinebry (NCT-1)</b>	Well No. <b>8</b>
Location of Well <b>E</b>	Unit <b>33</b>	Township <b>22-S</b>	Range <b>38-E</b>

1. Has the New Mexico Oil Conservation Commission heretofore authorized the dual completion of a well in these same pools or in the same zones within one mile of the subject well? YES ☒ NO ☐
2. If answer is yes, identify one such instance: Order No. **R-977**; Operator, Lease, and Well No.:

**Pan American Petroleum Corporation, State "S" Well No. 3**

3. The following facts are submitted:	Upper Zone	Lower Zone
a. Name of reservoir	<b>Blinebry</b>	<b>Tubb</b>
b. Top and Bottom of Pay Section (Perforations)	<b>5670'-5770' (Est.)</b>	<b>6190'-6250' (Est.)</b>
c. Type of production (Oil or Gas)	<b>Oil</b>	<b>Gas</b>
d. Method of Production (Flowing or Artificial Lift)	<b>Flow</b>	<b>Flow</b>

4. The following are attached. (Please mark YES or NO)

- Yes** a. Diagrammatic Sketch of the Dual Completion, showing all casing strings, including size and setting, top of cement, perforated intervals, tubing strings, including diameters and setting depth, location and type of packers and side door chokes, and such other information as may be pertinent.
- Yes** b. Plat showing the location of all wells on applicant's lease, all offset wells on offset leases, and the names and addresses of operators of all leases offsetting applicant's lease.
- Yes** c. Waivers consenting to such dual completion from each offset operator, or in lieu thereof, evidence that said offset operators have been furnished copies of the application.\*
- No** d. Electrical log of the well or other acceptable log with tops and bottoms of producing zones and intervals of perforation indicated thereon. (If such log is not available at the time application is filed, it shall be submitted as provided by Rule 112-A.)

5. List all offset operators to the lease on which this well is located together with their correct mailing address.

**Gulf Oil Corporation - Box 669 - Roswell, New Mexico****Anderson Pritchard Oil Corporation - Box 1859 - Midland, Texas****Tidewater Oil Company - Box 547 - Hobbs, New Mexico****Great Western Drilling Company - Box 1659 - Midland, Texas**

6. Were all operators listed in Item 5 above notified and furnished a copy of this application? YES ☒ NO ☐ . If answer is yes, give date of such notification **December 23, 1958**

CERTIFICATE: I, the undersigned, state that I am the **Asst. Dist. Supt.** of the **The Texas Company** (company), and that I am authorized by said company to make this report; and that this report was prepared under my supervision and direction and that the facts stated therein are true, correct and complete to the best of my knowledge.

**J. O. Elovins, Jr.** Signature

- \* Should waivers from all offset operators not accompany an application for administrative approval, the New Mexico Oil Conservation Commission will hold the application for a period of twenty (20) days from date of receipt by the Commission's Santa Fe office. If, after said twenty-day period, no protest nor request for hearing is received by the Santa Fe office, the application will then be processed.
- NOTE: If the proposed dual completion will result in an unorthodox well location and/or a non-standard proration unit in either or both of the producing zones, then separate application for approval of the same should be filed simultaneously with this application.

# DIAGRAMMATIC SKETCH SHOWING DUAL COMPLETION INSTALLATION

- PROPOSED -

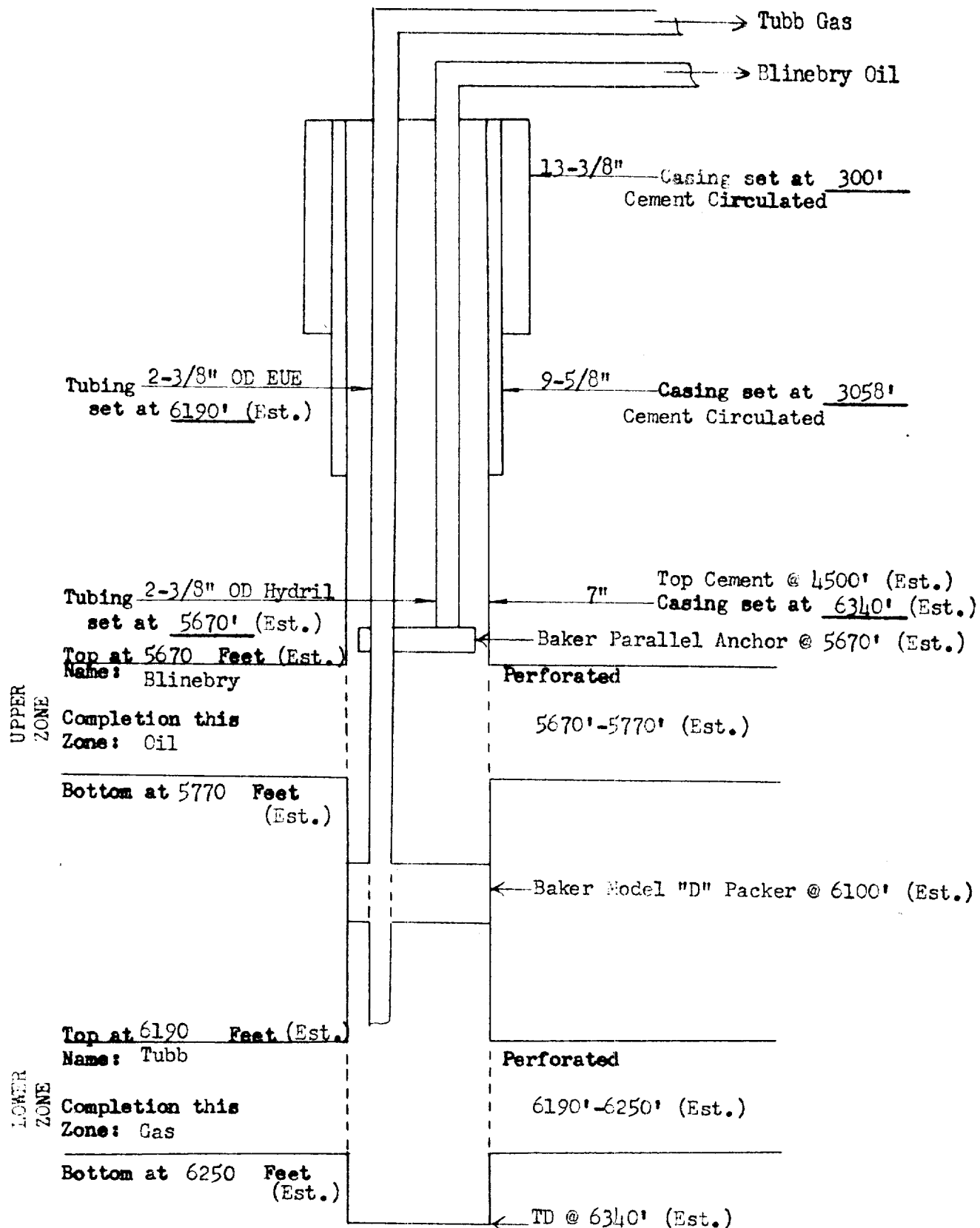

COMPANY: The Texas Company

LEASE: A. H. Blinebry (NCT-1) Well No. 8

FIELD: Blinebry (Oil) & Tubb (Gas)

DATE: December 23, 1958

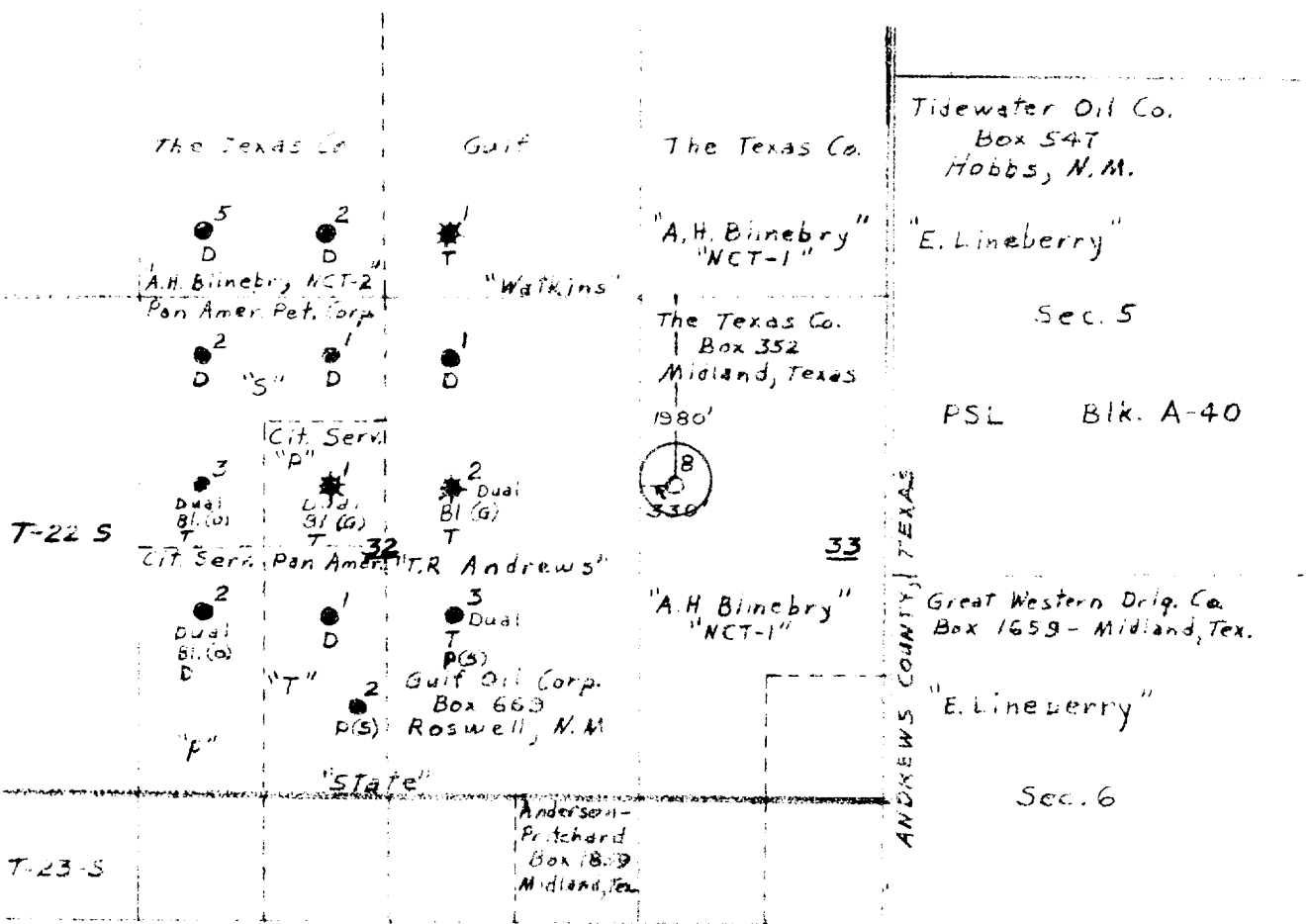

R-38-E

LEA COUNTY, NEW MEXICO

B(G) - Blinebry Gas Pool  
B(G) - Blinebry Oil Pool  
D - Drinkard Pool  
P(S) - Padlock, South Pool  
T - Tubb Gas Pool

SCALE: 1"=2000'