

OIL CONSERVATION COMMISSION

BOX 2045

HOBBS, NEW MEXICO

DATE Dec. 4, 1961

OIL CONSERVATION COMMISSION  
BOX 371  
SANTA FE, NEW MEXICO

Re: Proposed NSP.....

Proposed NSL.....

Proposed NFC.....

Proposed DC X

Gentlemen:

I have examined the application dated 11/21/61  
for the Texaco, Inc. A. H. Blinbry NCT-1 #15 33-22-38  
Operator Lease and Well No. S-T-R

and my recommendations are as follows:

Recommend a Hearing---E.F.E.

Geologically O.K.---J.W.R.

Yours very truly,

OIL CONSERVATION COMMISSION

11

THE CHAIRMAN

TO THE

MEMBERS OF THE

COMMISSION

WILLIAM

WILLIAM

PLEASE

There is

name

date

to be included

1947/1948

non-probation

ILLEGIBLE

# TEXACO INC.

PETROLEUM PRODUCTS



P. O. Box 728  
Hobbs, New Mexico  
November 20, 1961

APPLICATION FOR DUAL COMPLETION (TUBINGLESS)  
TEXACO Inc. A. H. Blinbry (NCT-1) Well No. 15  
Drinkard and South Paddock Pools  
Lea County, New Mexico

New Mexico Oil Conservation Commission  
P. O. Box 871  
Santa Fe, New Mexico

Attention: Mr. A. L. Porter, Jr.

Gentlemen:

TEXACO Inc. respectfully requests administrative approval of an exception to Rule 112-A to permit the dual completion (tubingless) of the subject well in the Drinkard and South Paddock Pools. The well is to be located in Unit "D", 330' from the north and west lines of Section 33, T-22-S, R-38-E, Lea County, New Mexico, as shown on the attached plat.

To our knowledge there is no existing dual completion in the Drinkard and South Paddock Pools; however, the direct north offset to the subject location is a triple completion which includes the Drinkard and South Paddock Pools with the third completion zone in the Tubb (Oil) Pool. Order No. R-2054 is assigned this triple completion as indicated on the attached "Application for Dual Completion" form. There is, however, a dual completion in the area in the Drinkard and Paddock formations, Drinkard and Paddock Pools, Order No. DC-934, being TEXACO Inc.'s C. H. Lockhart (NCT-1) Well No. 3 located in Unit 0, Section 18, T-22-S, R-38-E.

The completion method for the proposed dual is as follows: Two strings of 2-3/8 inches OD casing, one to each source of supply, are to be cemented in a common well bore of 7-5/8 inches diameter. Primary cementing operations will be performed through the short string of casing at a depth of approximately 6950 feet with a sufficient amount of cement to provide coverage to approximately 4000 feet. Cementing in this manner will permit an open hole completion to be made through perforated casing in the lowermost zone (Drinkard). In lieu of installing centralizers or turbolizers on the casing strings it is proposed to install sliding side doors in the long casing string at appropriate points

November 20, 1961

above the lower completion zone (Drinkard) and above and below the upper completion interval (South Paddock). Following the primary cementing operation, cement squeeze operations will be performed through the sliding side doors, thus assuring isolation of all zones. Directional perforating equipment will be used during completion of the upper zone. A diagrammatic sketch of the dual completion installation is attached.

Crude production from the South Paddock completion will be sour with a gravity of approximately  $34^{\circ}$  API. Bottom hole pressure of this zone will approximate 1700 psi and the producing gas-oil ratio is estimated at 400 cubic feet per barrel. Crude production from the Drinkard completion will be intermediate sweet with a gravity of approximately  $40^{\circ}$  API. Bottom hole pressure of this zone will approximate 2000 psi and the producing gas-oil ratio is estimated at 1200 cubic feet per barrel.

Mild corrosion and paraffin is expected to exist in the upper (South Paddock) completion and the casing string for this zone will be internally plasticcoated throughout to afford the required protection.

It is anticipated that the two zones will complete flowing. At such time in the future that artificial lift is required, conventional rod pumps will be installed. If desired, hydraulic pump installations could be used.

Copies of this letter and application are being sent this date by registered mail to all offset operators to the addresses shown on the accompanying "Application For Dual Completion" form.

Yours very truly,



W. B. Hubbard  
District Superintendent

LMF-MSV

Attachments

cc: Offset Operators  
NMOCC, Hobbs

## NEW MEXICO OIL CONSERVATION COMMISSION

SANTA FE, NEW MEXICO

7-3-58

## APPLICATION FOR DUAL COMPLETION (TUBINGLESS)

Field Name Drinkard and South Paddock		County Lea	Date November 20, 1961
Operator TEXACO Inc.		Lease A. H. Blinebry (NCT-1)	Well No. 15
Location of Well D	Unit 33	Township 22-S	Range 38-E

1. Has the New Mexico Oil Conservation Commission heretofore authorized the ~~well~~ completion of a well in these same pools or in the same zones within one mile of the subject well? YES X NO multiple

2. If answer is yes, identify one such instance: Order No. \*3-2054; Operator, Lease, and Well No.:

\* Triple completion in Drinkard, South Paddock and Tubb (Oil). TEXACO Inc.  
A. H. Blinebry (NCT-1) Well No. 14, north offset to subject well.

3. The following facts are submitted:	Upper Zone	Lower Zone
a. Name of reservoir	South Paddock	Drinkard
b. Top and Bottom of Pay Section (Perforations)	5220' - 5235'	6950' - 7200' (Open Hole)
c. Type of production (Oil or Gas)	Oil	Oil
d. Method of Production (Flowing or Artificial Lift)	Flowing	Flowing

4. The following are attached. (Please mark YES or NO)

Yes a. Diagrammatic Sketch of the Dual Completion, showing all casing strings, including size and setting, top of cement, perforated intervals, tubing strings, including diameters and setting depth, location and type of packers and side door chokes, and such other information as may be pertinent.

Yes b. Plat showing the location of all wells on applicant's lease, all offset wells on offset leases, and the names and addresses of operators of all leases offsetting applicant's lease.

No c. Waivers consenting to such dual completion from each offset operator, or in lieu thereof, evidence that said offset operators have been furnished copies of the application. \*

No d. Electrical log of the well or other acceptable log with tops and bottoms of producing zones and intervals of perforation indicated thereon. (If such log is not available at the time application is filed, it shall be submitted as provided by Rule 112-A.)

5. List all offset operators to the lease on which this well is located together with their correct mailing address.

Humble Oil & Refining Company, P. O. Box 2347, Hobbs, New Mexico

Tidewater Oil Company, P. O. Box 547, Hobbs, New Mexico

Great Western Drilling Company, P. O. Box 1659, Midland, Texas

Anderson-Pritchard Oil Corp., P. O. Box 1859, Midland, Texas

Gulf Oil Corp., P. O. Box 1938, Roswell, New Mexico

R. M. Moran, P. O. Box 1718, Hobbs, New Mexico

6. Were all operators listed in Item 5 above notified and furnished a copy of this application? YES X NO   . If answer is yes, give date of such notification November 20, 1961 (By registered mail)

CERTIFICATE: I, the undersigned, state that I am the District Superintendent ~~for~~ TEXACO Inc.

(company), and that I am authorized by said company to make this report; and that this report was prepared under my supervision and direction and that the facts stated therein are true, correct and complete to the best of my knowledge.

W. B. Hubbard Signature

\* Should waivers from all offset operators not accompany an application for administrative approval, the New Mexico Oil Conservation Commission will hold the application for a period of twenty (20) days from date of receipt by the Commission's Santa Fe office. If, after said twenty-day period, no protest nor request for hearing is received by the Santa Fe office, the application will then be processed.

NOTE: If the proposed dual completion will result in an unorthodox well location and/or a non-standard proration unit in either or both of the producing zones, then separate application for approval of the same should be filed simultaneously with this application.

# DIAGRAMMATIC SKETCH SHOWING DUAL COMPLETION INSTALLATION (TUBINGLESS)

**NOTE:** The 2- 2-3/8" casing strings to be cemented through the short string at 6950' with 550 sacks Incor, 8% gel. Calculated cement top at 4000'. Primary cementing to be supplemented with 50 to 100 sack cement squeezes through Otis Sliding Side Doors in long casing string.

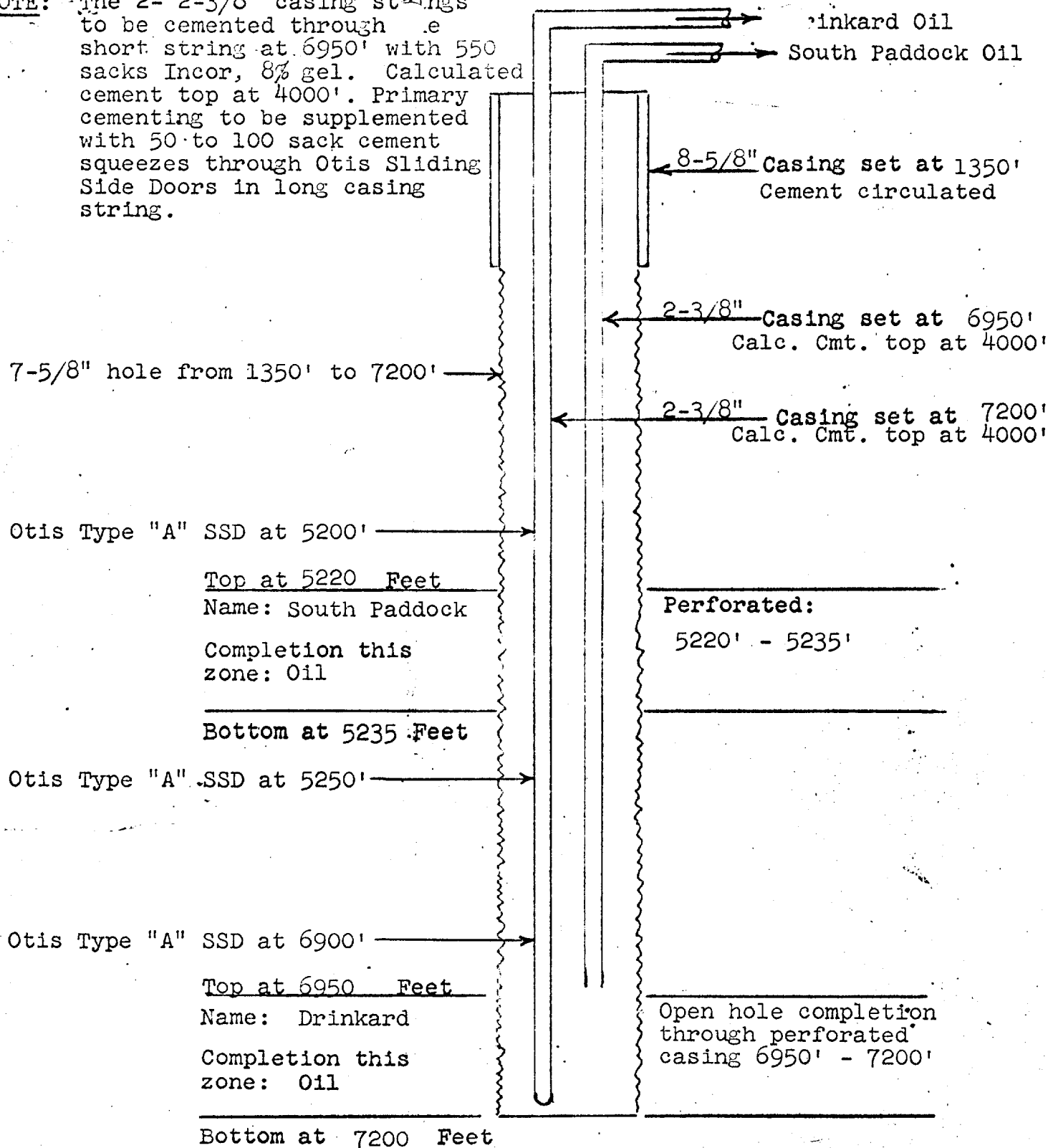

TEXACO Inc.

LEASE: A. H. Blinebry (NCT-1) Well No. 15  
 FIELD: South Paddock and Drinkard  
 DATE: November 20, 1961

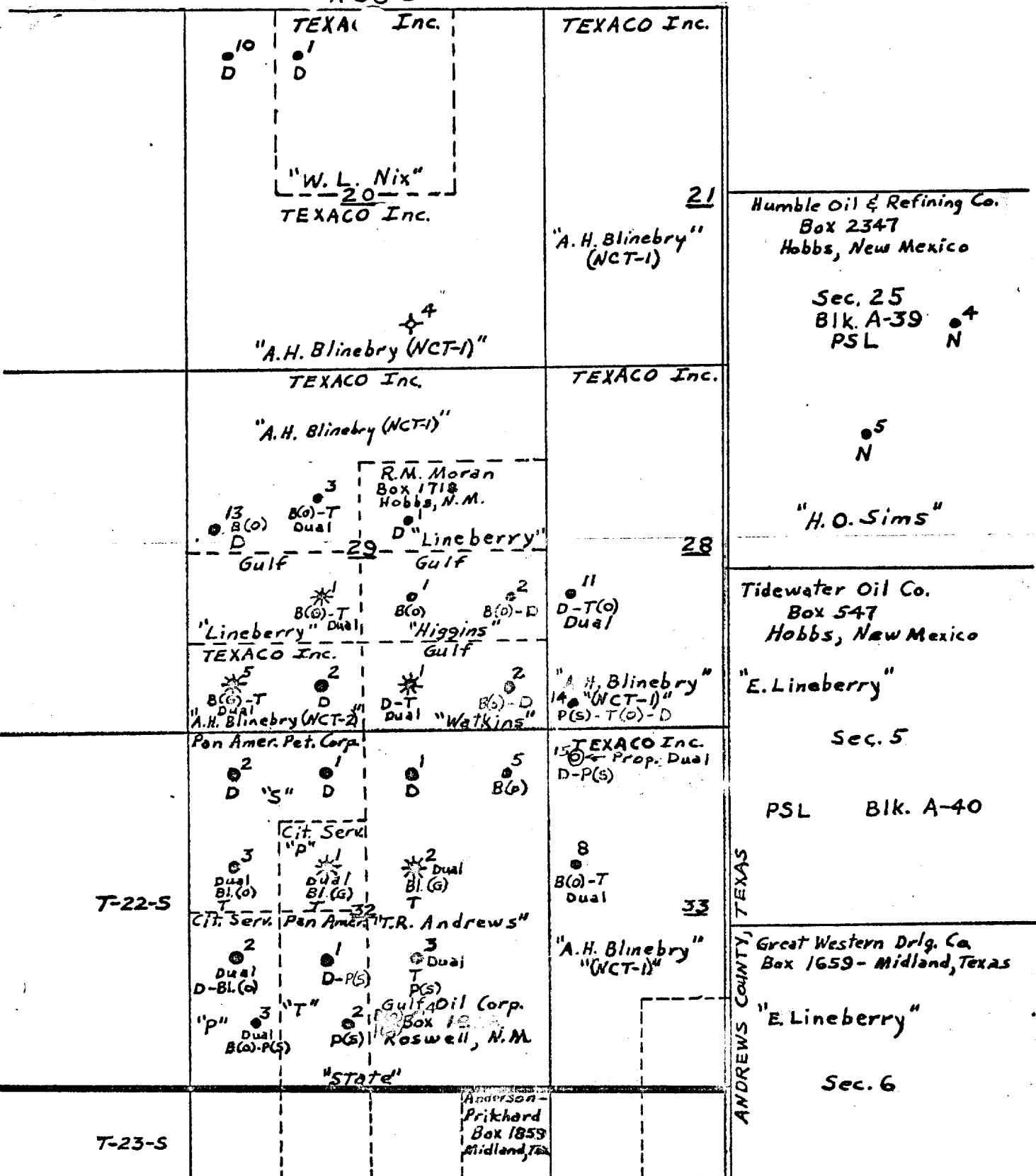

SCALE: 1"=2000'  
LMF - NOVEMBER 20, 1961