

APPROVED

* Subject 1
AUG 1961

COP 7 O. C. C. (C) 1961

E. W. STANDLEY
DISTRICT ENGINEER

NOTICE OF INTENTION TO TEST WATER SHUT-OFF	NOTICE OF INTENTION TO REPAIR OR REPAIR REPAIRING
NOTICE OF INTENTION TO SHUT OR ABANDON	NOTICE OF INTENTION TO SHUT OR ABANDON
NOTICE OF INTENTION TO PULL OR ALTER CABLE	NOTICE OF INTENTION TO PULL OR ALTER CABLE
NOTICE OF INTENTION TO REPAIR WELL	NOTICE OF INTENTION TO REPAIR WELL

(INDICATE ABOVE BY CHECKING IN ONE OF THE BOXES, NOTED OR OTHER BOXES)

Exhibit No. 100-1
A. E. Standley 100-1

Approved: 21, 1961

Well No. 1-5 is located 330 ft. from line of sec. 33

Sec. 33 5-22-8 5-22-8 5-22-8

Underground (Paddock) New Mexico
(City or Sub. Name) (State or Territory)

The elevation of the Derrick floor above sea level is 4225.0 ft.

Drill String Details

Drill String Details

1000'	1000'	3-5/8"	500'	1000'
1400'	1400'	2-3/8"	500'	1000'
1800'	1800'	2-3/8"	500'	1000'
2200'	2200'	2-3/8"	500'	1000'
2600'	2600'	2-3/8"	500'	1000'
3000'	3000'	2-3/8"	500'	1000'
3400'	3400'	2-3/8"	500'	1000'
3800'	3800'	2-3/8"	500'	1000'
4200'	4200'	2-3/8"	500'	1000'
4600'	4600'	2-3/8"	500'	1000'
5000'	5000'	2-3/8"	500'	1000'
5400'	5400'	2-3/8"	500'	1000'
5800'	5800'	2-3/8"	500'	1000'
6200'	6200'	2-3/8"	500'	1000'
6600'	6600'	2-3/8"	500'	1000'
7000'	7000'	2-3/8"	500'	1000'
7400'	7400'	2-3/8"	500'	1000'
7800'	7800'	2-3/8"	500'	1000'
8200'	8200'	2-3/8"	500'	1000'
8600'	8600'	2-3/8"	500'	1000'
9000'	9000'	2-3/8"	500'	1000'
9400'	9400'	2-3/8"	500'	1000'
9800'	9800'	2-3/8"	500'	1000'
10200'	10200'	2-3/8"	500'	1000'
10600'	10600'	2-3/8"	500'	1000'
11000'	11000'	2-3/8"	500'	1000'
11400'	11400'	2-3/8"	500'	1000'
11800'	11800'	2-3/8"	500'	1000'
12200'	12200'	2-3/8"	500'	1000'
12600'	12600'	2-3/8"	500'	1000'
13000'	13000'	2-3/8"	500'	1000'
13400'	13400'	2-3/8"	500'	1000'
13800'	13800'	2-3/8"	500'	1000'
14200'	14200'	2-3/8"	500'	1000'
14600'	14600'	2-3/8"	500'	1000'
15000'	15000'	2-3/8"	500'	1000'
15400'	15400'	2-3/8"	500'	1000'
15800'	15800'	2-3/8"	500'	1000'
16200'	16200'	2-3/8"	500'	1000'
16600'	16600'	2-3/8"	500'	1000'
17000'	17000'	2-3/8"	500'	1000'
17400'	17400'	2-3/8"	500'	1000'
17800'	17800'	2-3/8"	500'	1000'
18200'	18200'	2-3/8"	500'	1000'
18600'	18600'	2-3/8"	500'	1000'
19000'	19000'	2-3/8"	500'	1000'
19400'	19400'	2-3/8"	500'	1000'
19800'	19800'	2-3/8"	500'	1000'
20200'	20200'	2-3/8"	500'	1000'
20600'	20600'	2-3/8"	500'	1000'
21000'	21000'	2-3/8"	500'	1000'
21400'	21400'	2-3/8"	500'	1000'
21800'	21800'	2-3/8"	500'	1000'
22200'	22200'	2-3/8"	500'	1000'
22600'	22600'	2-3/8"	500'	1000'
23000'	23000'	2-3/8"	500'	1000'
23400'	23400'	2-3/8"	500'	1000'
23800'	23800'	2-3/8"	500'	1000'
24200'	24200'	2-3/8"	500'	1000'
24600'	24600'	2-3/8"	500'	1000'
25000'	25000'	2-3/8"	500'	1000'
25400'	25400'	2-3/8"	500'	1000'
25800'	25800'	2-3/8"	500'	1000'
26200'	26200'	2-3/8"	500'	1000'
26600'	26600'	2-3/8"	500'	1000'
27000'	27000'	2-3/8"	500'	1000'
27400'	27400'	2-3/8"	500'	1000'
27800'	27800'	2-3/8"	500'	1000'
28200'	28200'	2-3/8"	500'	1000'
28600'	28600'	2-3/8"	500'	1000'
29000'	29000'	2-3/8"	500'	1000'
29400'	29400'	2-3/8"	500'	1000'
29800'	29800'	2-3/8"	500'	1000'
30200'	30200'	2-3/8"	500'	1000'
30600'	30600'	2-3/8"	500'	1000'
31000'	31000'	2-3/8"	500'	1000'
31400'	31400'	2-3/8"	500'	1000'
31800'	31800'	2-3/8"	500'	1000'
32200'	32200'	2-3/8"	500'	1000'
32600'	32600'	2-3/8"	500'	1000'
33000'	33000'	2-3/8"	500'	1000'
33400'	33400'	2-3/8"	500'	1000'
33800'	33800'	2-3/8"	500'	1000'
34200'	34200'	2-3/8"	500'	1000'
34600'	34600'	2-3/8"	500'	1000'
35000'	35000'	2-3/8"	500'	1000'
35400'	35400'	2-3/8"	500'	1000'
35800'	35800'	2-3/8"	500'	1000'
36200'	36200'	2-3/8"	500'	1000'
36600'	36600'	2-3/8"	500'	1000'
37000'	37000'	2-3/8"	500'	1000'
37400'	37400'	2-3/8"	500'	1000'
37800'	37800'	2-3/8"	500'	1000'
38200'	38200'	2-3/8"	500'	1000'
38600'	38600'	2-3/8"	500'	1000'
39000'	39000'	2-3/8"	500'	1000'
39400'	39400'	2-3/8"	500'	1000'
39800'	39800'	2-3/8"	500'	1000'
40200'	40200'	2-3/8"	500'	1000'
40600'	40600'	2-3/8"	500'	1000'
41000'	41000'	2-3/8"	500'	1000'
41400'	41400'	2-3/8"	500'	1000'
41800'	41800'	2-3/8"	500'	1000'
42200'	42200'	2-3/8"	500'	1000'
42600'	42600'	2-3/8"	500'	1000'
43000'	43000'	2-3/8"	500'	1000'
43400'	43400'	2-3/8"	500'	1000'
43800'	43800'	2-3/8"	500'	1000'
44200'	44200'	2-3/8"	500'	1000'
44600'	44600'	2-3/8"	500'	1000'
45000'	45000'	2-3/8"	500'	1000'
45400'	45400'	2-3/8"	500'	1000'
45800'	45800'	2-3/8"	500'	1000'
46200'	46200'	2-3/8"	500'	1000'
46600'	46600'	2-3/8"	500'	1000'
47000'	47000'	2-3/8"	500'	1000'
47400'	47400'	2-3/8"	500'	1000'
47800'	47800'	2-3/8"	500'	1000'
48200'	48200'	2-3/8"	500'	1000'
48600'	48600'	2-3/8"	500'	1000'
49000'	49000'	2-3/8"	500'	1000'
49400'	49400'	2-3/8"	500'	1000'
49800'	49800'	2-3/8"	500'	1000'
50200'	50200'	2-3/8"	500'	1000'
50600'	50600'	2-3/8"	500'	1000'
51000'	51000'	2-3/8"	500'	1000'
51400'	51400'	2-3/8"	500'	1000'
51800'	51800'	2-3/8"	500'	1000'
52200'	52200'	2-3/8"	500'	1000'
52600'	52600'	2-3/8"	500'	1000'
53000'	53000'	2-3/8"	500'	1000'
53400'	53400'	2-3/8"	500'	1000'
53800'	53800'	2-3/8"	500'	1000'
54200'	54200'	2-3/8"	500'	1000'
54600'	54600'	2-3/8"	500'	1000'
55000'	55000'	2-3/8"	500'	1000'
55400'	55400'	2-3/8"	500'	1000'
55800'	55800'	2-3/8"	500'	1000'
56200'	56200'	2-3/8"	500'	1000'
56600'	56600'	2-3/8"	500'	1000'
57000'	57000'	2-3/8"	500'	1000'
57400'	57400'	2-3/8"	500'	1000'
57800'	57800'	2-3/8"	500'	1000'
58200'	58200'	2-3/8"	500'	1000'
58600'	58600'	2-3/8"	500'	1000'
59000'	59000'	2-3/8"	500'	1000'
59400'	59400'	2-3/8"	500'	1000'
59800'	59800'	2-3/8"	500'	1000'
60200'	60200'	2-3/8"	500'	1000'
60600'	60600'	2-3/8"	500'	1000'
61000'	61000'	2-3/8"	500'	1000'
61400'	61400'	2-3/8"	500'	1000'
61800'	61800'	2-3/8"	500'	1000'
62200'	62200'	2-3/8"	500'	1000'
62600'	62600'	2-3/8"	500'	1000'
63000'	63000'	2-3/8"	500'	1000'
63400'	63400'	2-3/8"	500'	1000'
63800'	63800'	2-3/8"	500'	1000'
64200'	64200'	2-3/8"	500'	1000'
64600'	64600'	2-3/8"	500'	1000'
65000'	65000'	2-3/8"	500'	1000'
65400'	65400'	2-3/8"	500'	1000'
65800'	65800'	2-3/8"	500'	1000'
66200'	66200'	2-3/8"	500'	1000'
66600'	66600'	2-3/8"	500'	1000'
67000'	67000'	2-3/8"	500'	1000'
67400'	67400'	2-3/8"	500'	1000'
67800'	67800'	2-3/8"	500'	1000'
68200'	68200'	2-3/8"	500'	1000'
68600'	68600'	2-3/8"	500'	1000'
69000'	69000'	2-3/8"	500'	1000'
69400'	69400'	2-3/8"	500'	1000'
69800'	69800'	2-3/8"	500'	1000'
70200'	70200'	2-3/8"	500'	1000'
70600'	70600'	2-3/8"	500'	1000'
71000'	71000'	2-3/8"	500'	1000'
71400'	71400'	2-3/8"	500'	1000'
71800'	71800'	2-3/8"	500'	1000'
72200'	72200'	2-3/8"	500'	1000'
72600'	72600'	2-3/8"	500'	1000'
73000'	73000'	2-3/8"	500'	1000'
73400'	73400'	2-3/8"	500'	1000'
73800'	73800'	2-3/8"	500'	1000'
74200'	74200'	2-3/8"	500'	1000'
74600'	74600'	2-3/8"	500'	1000'
75000'	75000'	2-3/8"	500'	1000'
75400'	75400'	2-3/8"	500'	1000'
75800'	75800'	2-3/8"	500'	1000'
76200'	76200'	2-3/8"	500'	1000'
76600'	76600'	2-3/8"	500'	1000'
77000'	77000'	2-3/8"	500'	1000'
77400'	77400'	2-3/8"	500'	1000'
77800'	77800'	2-3/8"	500'	1000'
78200'	78200'	2-3/8"	500'	1000'
78600'	78600'	2-3/8"	500'	1000'
79000'	79000'	2-3/8"	500'	1000'
79400'	79400'	2-3/8"	500'	1000'
79800'	79800'	2-3/8"	500'	1000'
80200'	80200'	2-3/8"	500'	1000'
80600'	80600'	2-3/8"	500'	1000'
81000'	81000'	2-3/8"	500'	1000'
81400'	81400'	2-3/8"	500'	1000'
81800'	81800'	2-3/8"	500'	1000'
82200'	82200'	2-3/8"	500'	1000'
82600'	82600'	2-3/8"	500'	1000'
83000'	83000'	2-3/8"	500'	1000'
83400'	83400'	2-3/8"	500'	1000'
83800'	83800'	2-3/8"	500'	1000'
84200'	84200'	2-3/8"	500'	1000'
84600'	84600'	2-3/8"	500'	1000'
85000'	85000'	2-3/8"	500'	1000'
85400'	85400'	2-3/8"	500'	1000'
85800'	85800'	2-3/8"	500'	1000'
86200'	86200'	2-3/8"	500'	1000'
86600'	86600'	2-3/8"	500'	1000'
87000'	87000'	2-3/8"	500'	1000'
87400'	87400'	2-3/8"	500'	1000'
87800'	87800'	2-3/8"	500'	1000'
88200'	88200'	2-3/8"	500'	1000'
88600'	88600'	2-3/8"	500'	1000'
89000'	89000'	2-3/8"	500'	1000'
89400'	89400'	2-3/8"	500'	1000'
89800'	89800'	2-3/8"	500'	1000'
90200'	90200'	2-3/8"	500'	1000'
90600'	90600'	2-3/8"	500'	1000'
91000'	91000'	2-3/8"	500'	1000'
91400'	91400'	2-3/8"	500'	1000'
91800'	91800'	2-3/8"	500'	1000'
92200'	92200'	2-3/8"	500'	1000'
92600'	92600'	2-3/8"	500'	1000'
93000'	93000'	2-3/8"	500'	1000'
93400'	93400'	2-3/8"	500'	1000'
93800'	93800'	2-3/8"	500'	1000'
94200'	94200'	2-3/8"	500'	1000'
94600'	94600'	2-3/8"	500'	1000'
95000'	95000'	2-3/8"	500'	1000'
95400'	95400'	2-3/8"	500'	1000'
95800'	95800'	2-3/8"	500'	1000'
96200'	96200'	2-3/8"	500'	1000'
96600'	96600'	2-3/8"	500'	1000'
97000'	97000'	2-3/8"	500'	1000'
97400'	97400'	2-3/8"	500'	1000'
97800'	97800'	2-3/8"	500'	1000'
98200'	98200'	2-3/8"	5	

WELL LOCATION AND COMMUNICATION PLAT

SEE INSTRUCTIONS FOR COMPLETING THIS PLAT ON THE REVERSE SIDE

Operator TEXACO Inc.		Well No. 15*	
Unit Letter D	Section 22	Township 32 North	Range 40 East
Actual Footage Location of Well 330' East from the Mouth of the Creek			
Ground Level Elev. 3373'	Producing Formation Padlock & Drinkard	Well Undesignated Drinkard	Estimated Height Across

- * To be a dual in Undesignated Drinkard & Undesignated Padlock
1. Is the Operator the only owner in the dedicated acreage outlined on the plat below? YES ☒ NO ☐ ("Owner" means the person who has the right to drill into and to produce from any pool and to appropriate the production either for himself or for himself and another. (65-3-29 (e) NMSA 1935 Comp.)
 2. If the answer to question one is "no," have the interests of all the owners been consolidated by communication agreement or otherwise? YES ☐ NO ☐ If answer is "yes," Type of Consolidation _____
 3. If the answer to question two is "no," list all the owners and their respective interests below:

Owner	Land Description

SECTION B

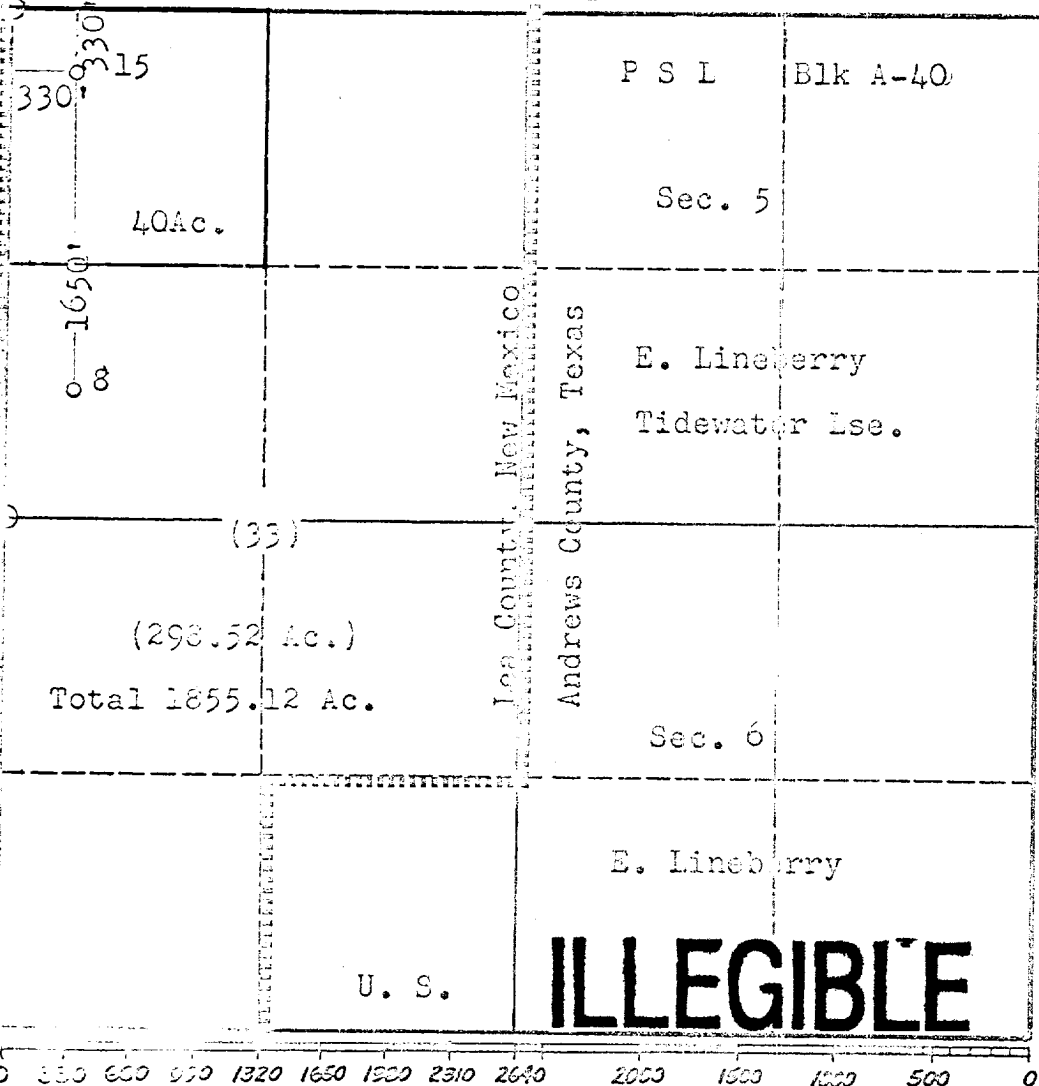

CERTIFICATION

I hereby certify that the information in SECTION A above is true and complete to the best of my knowledge and belief.

Name J. J. Velten
Position Division Civil Engineer
Company TEXACO Inc.
Date 11/20/61

O - Brass Caps

I hereby certify that the well location shown on the plat in SECTION B was plotted from field notes of actual surveys made by me or under my supervision, and that the same is true and correct to the best of my knowledge and belief.

Date Surveyed 11/20/61
Registered Professional Engineer and/or Land Surveyor J. J. Velten
Certificate No. 8174

[illegible]

Figure 1. The effect of the concentration of the H_2O_2 solution on the amount of the released H_2O from the H_2O_2 -sensitive hydrogel. The amount of the released H_2O was measured by the weight difference of the hydrogel before and after the swelling in the H_2O_2 solution. The concentration of the H_2O_2 solution was 0, 0.1, 0.2, 0.3, 0.4, 0.5, 0.6, 0.7, 0.8, 0.9, and 1.0 wt. %.

Figure 1. Schematic representation of the experimental design. The subjects were divided into two groups: a control group and an experimental group. The control group received a standard diet, while the experimental group received a diet supplemented with 10% of the total energy from fat. The subjects were then divided into two subgroups: a sedentary subgroup and an exercise subgroup. The exercise subgroup performed a 12-week exercise program. The subjects were then divided into two subgroups: a control subgroup and an experimental subgroup. The control subgroup received a standard diet, while the experimental subgroup received a diet supplemented with 10% of the total energy from fat. The subjects were then divided into two subgroups: a sedentary subgroup and an exercise subgroup. The exercise subgroup performed a 12-week exercise program.

•

The Soc. 22

Acres

3. If the answer to question two is "no," list all the owners and their respective interests below:

Lead Description

