

Submit 3 Copies  
to Appropriate  
District Office

State of New Mexico  
Energy, Minerals and Natural Resources Department

Form C-103  
Revised 1-1-89

DISTRICT I  
P.O. Box 1980, Hobbs, NM 88240

DISTRICT II  
P.O. Drawer DD, Artesia, NM 88210

DISTRICT III  
1000 Rio Brazos Rd., Aztec, NM 87410

OIL CONSERVATION DIVISION

P O. Box 2088  
Santa Fe, New Mexico 87504-2088

WELL API NO. <b>3002502555</b>
5. Indicate Type of Lease STATE <input checked="" type="checkbox"/> FEE <input type="checkbox"/>
6. State Oil & Gas Lease No. <b>B-934</b>
7. Lease Name or Unit Agreement Name <b>NEW MEXICO S STATE</b>
8. Well No. <b>234</b>
9. Pool name or Wildcat <b>BLINEBRY GAS</b>
10. Elevation (Show whether DF, RKB, RT, GR, etc.)

SUNDRY NOTICES AND REPORTS ON WELLS  
(DO NOT USE THIS FORM FOR PROPOSALS TO DRILL OR TO DEEPEN OR PLUG BACK TO A  
DIFFERENT RESERVOIR. USE "APPLICATION FOR PERMIT"  
(FORMC-101) FOR SUCH PROPOSALS.)

1. Type of Well:  
OIL ☐ GAS ☒ OTHER

2. Name of Operator  
**EXXON CORPORATION**

3. Address of Operator  
**ATTN: REGULATORY AFFAIRS  
P. O. BOX 1600  
MIDLAND, TX 79702**

4. Well Location  
Unit Letter **P** : **990** Feet From The **SOUTH** Line and **990** Feet From The **EAST** Line  
Section **2** Township **22S** Range **37E** NMPM **LEA** County

Check Appropriate Box to Indicate Nature of Notice, Report, or Other Data  
NOTICE OF INTENTION TO:

PERFORM REMEDIAL WORK ☐ PLUG AND ABANDON ☐  
TEMPORARILY ABANDON ☐ CHANGE PLANS ☐  
PULL OR ALTER CASING ☐  
OTHER: ☐

SUBSEQUENT REPORT OF:

REMEDIAL WORK ☐ ALTERING CASING ☐  
COMMENCE DRILLING OPNS. ☐ PLUG & ABANDONMENT ☐  
CASING TEST AND CEMENT JOB ☐  
OTHER: **REDEDICATE ACREAGE** ☒

12. Describe Proposed or Completed Operations (Clearly state all pertinent details, and give pertinent dates, including estimated date of starting any proposed work) SEE RULE 1103.

**REDEDICATE ACREAGE FROM 120 ACS TO 160 ACS. ACREAGE WAS REDUCED TO 120  
ACS INORDER TO ALLOW #24 TO BE COMPLETED IN BLINEBRY OIL BUT THIS  
ATTEMPT WAS UNSUCCESSFUL.**

**C102 IS ATTACHED.**

I hereby certify that the information above is true and complete to the best of my knowledge and belief.

SIGNATURE Alex M. Correa TITLE Administrative Specialist DATE 03/20/92

TYPE OR PRINT NAME Alex M. Correa (915) 688-7532 TELEPHONE NO.

(This space for State Use)

APPROVED BY \_\_\_\_\_ TITLE \_\_\_\_\_ DATE \_\_\_\_\_

CONDITIONS OF APPROVAL, IF ANY:

OIL CONSERVATION DIVISION

DISTRICT I  
P.O. Box 1980, Hobbs, NM 88240

DISTRICT II  
P.O. Drawer DD, Artesia, NM 88210

DISTRICT III  
1000 Rio Brazos Rd., Aztec, NM 87410

P.O. Box 2088  
Santa Fe, New Mexico 87504-2088

WELL LOCATION AND ACREAGE DEDICATION PLAT

All distances must be from the outer boundaries of the Section.

Operator Exxon Corporation			Lease NEW MEXICO STATE "S"		Well No. 23
Unit Letter P	Section 2	Township 22/S	Range 37/E	NMPM	County LEA
Actual Footage Location of Well: 990 feet from the SOUTH line and 990 feet from the EAST line.					
Ground level Elev. 3355	Producing Formation BLINEBRY		Pool BLINEBRY GAS		Dedicated Acreage: 160 Acres

- Outline the acreage dedicated to the subject well by colored pencil or hatchure marks on the plat below.
- If more than one lease is dedicated to the well, outline each and identify the ownership thereof (both as to working interest and royalty).
- If more than one lease of different ownership is dedicated to the well, have the interest of all owners been consolidated by communitization, unitization, force-pooling, etc.?

☐ Yes ☐ No If answer is "yes", type of consolidation

If answer is "no", list the owners and tract descriptions which have actually been consolidated. (Use reverse side of this form if necessary.)

No allowable will be assigned to the well until all interests have been consolidated (by communitization, unitization, forced-pooling, or otherwise) or until a non-standard unit, eliminating such interest, has been approved by the Division.

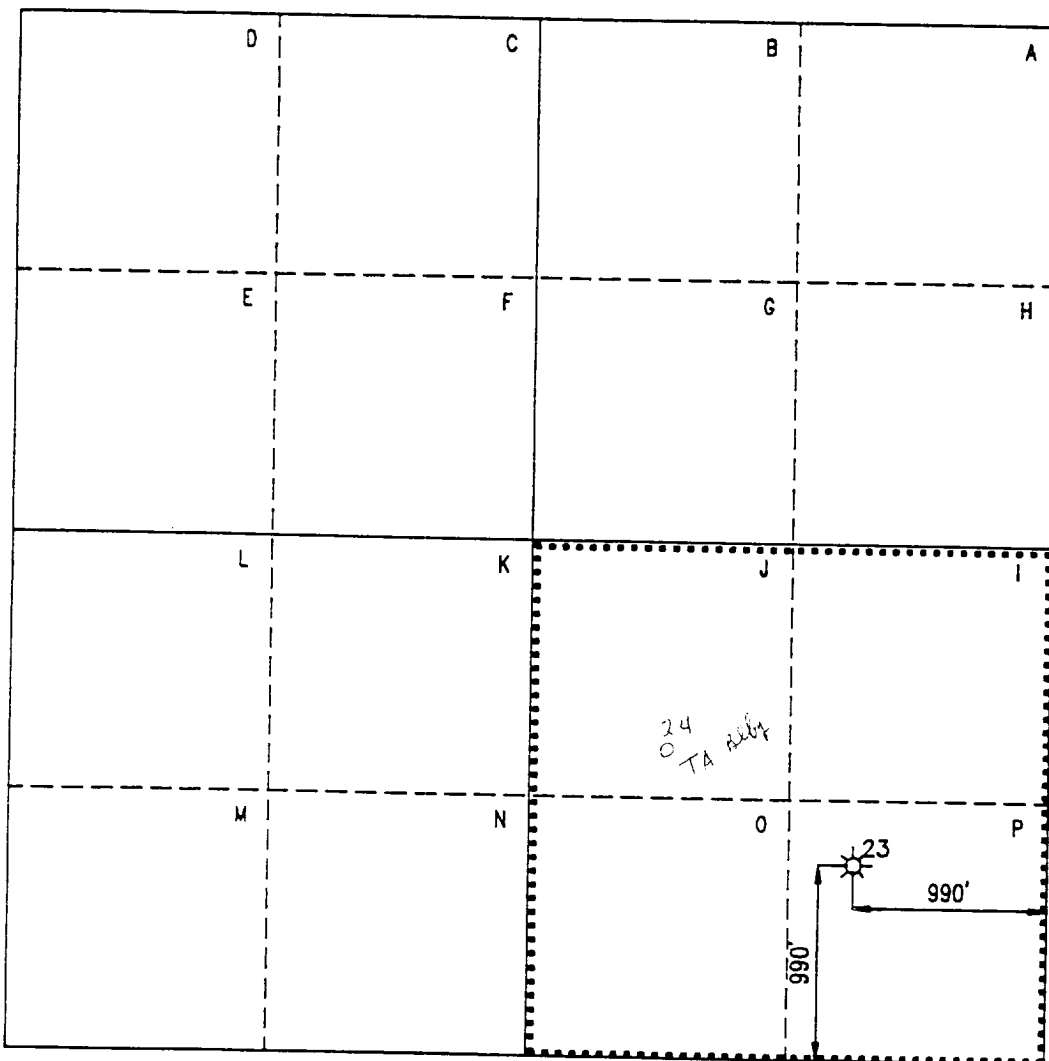

OPERATOR CERTIFICATION

I hereby certify that the information contained herein is true and complete to the best of my knowledge and belief.

Signature  
*Charlotte H. Harper*  
Printed Name  
CHARLOTTE H. HARPER  
Position  
PERMITS SUPERVISOR

Company Exxon Corporation  
P.O. Box 1600-Midland, Tx.-79702  
Date  
3-20-92

SURVEYOR CERTIFICATION

I hereby certify that the well location shown on this plat was plotted from field notes of actual surveys made by me or under my supervision, and that the same is true and correct to the best of my knowledge and belief.

Date Surveyed  
3/14/55

Signature & Seal of  
Professional Surveyor

Certificate No.

1.6 Miles SE of EUNICE, New Mexico.

C.E. File No. A01839