

Submit to Appropriate  
District Office  
State Lease—4 copies  
Fee Lease—3 copies

State of New Mexico  
Energy, Minerals and Natural Resources Department

Form C-1  
Revised 1-

OIL CONSERVATION DIVISION

P.O. Box 2088  
Santa Fe, New Mexico 87504-2088

DISTRICT I  
P.O. Box 1980, Hobbs, NM 88240

DISTRICT II  
P.O. Drawer DD, Artesia, NM 88210

DISTRICT III  
1000 Rio Brazos Rd., Aztec, NM 87410

WELL LOCATION AND ACREAGE DEDICATION PLAT

All distances must be from the outer boundaries of the Section.

Operator Exxon Corporation			Lease NEW MEXICO STATE (S)		Well No. 23
Unit Letter P	Section 2	Township 22/S	Range 37/E	County NMPM	LEA
Actual Footage Location of Well: 990 feet from the SOUTH line and 990 feet from the EAST line.					
Ground level Elev. 3355	Producing Formation BLINEERY		Pool BLINEERY (PRO GAS)(CONSOLIDATED)		Dedicated Acreage: 120 Acres

- Outline the acreage dedicated to the subject well by colored pencil or hatchure marks on the plat below.
- If more than one lease is dedicated to the well, outline each and identify the ownership thereof (both as to working interest and royalty).
- If more than one lease of different ownership is dedicated to the well, have the interest of all owners been consolidated by communitization, unitization, force-pooling, etc.?

☐ Yes ☐ No If answer is "yes", type of consolidation \_\_\_\_\_

If answer is "no", list the owners and tract descriptions which have actually been consolidated. (Use reverse side of this form if necessary.) \_\_\_\_\_

No allowable will be assigned to the well until all interests have been consolidated (by communitization, unitization, forced-pooling, or otherwise) or until a non-standard unit, eliminating such interest, has been approved by the Division.

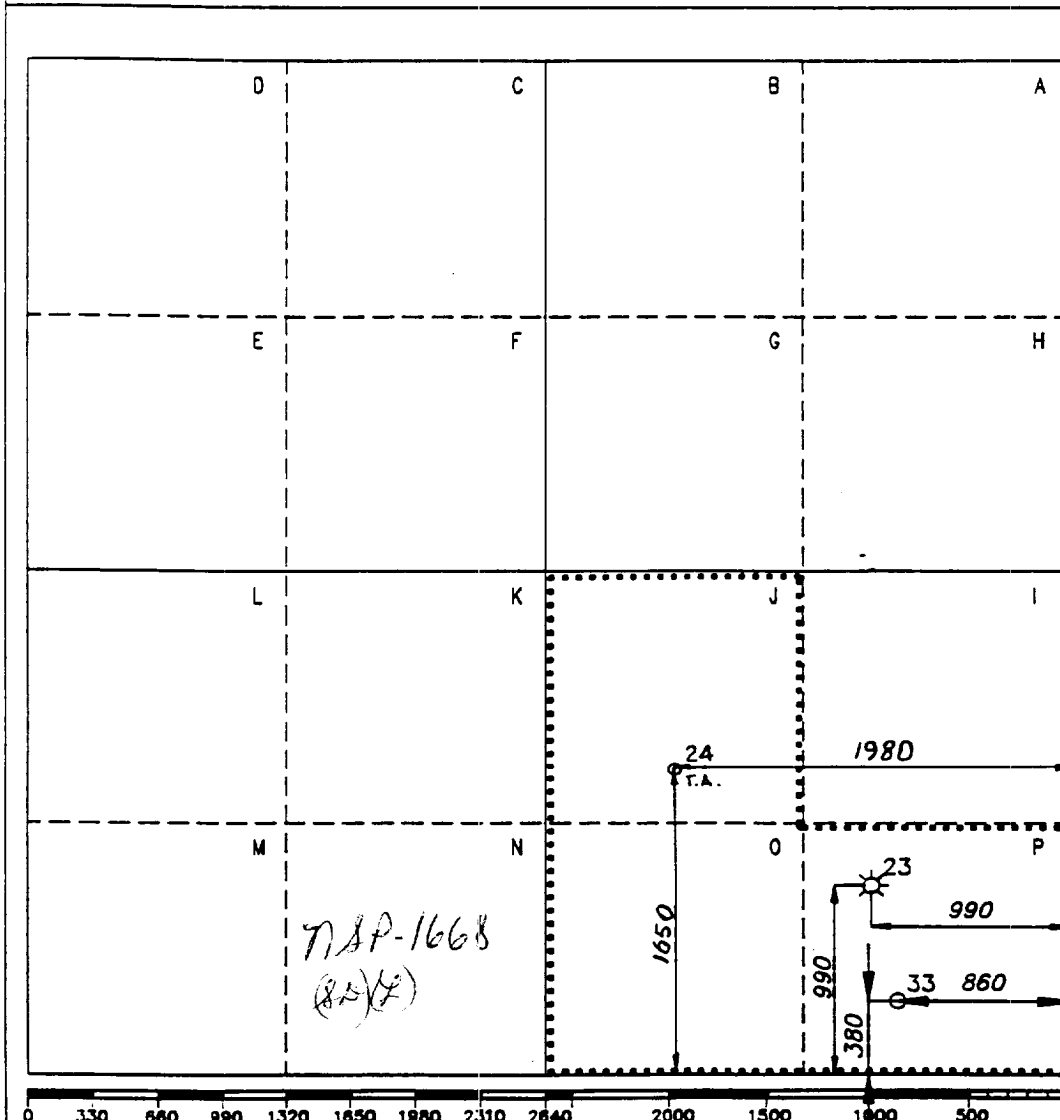

OPERATOR CERTIFICATION

I hereby certify that the information contained herein is true and complete to the best of my knowledge and belief.

Signature *C.H. Harper*

Printed Name C.H. HARPER

Position PERMITS SUPERVISOR

Company Exxon Corporation

P.O. Box 1600—Midland, Tx.—7970

Date 4-1-83

SURVEYOR CERTIFICATION

I hereby certify that the well location shown on this plat was plotted from field notes of actual surveys made by me or under my supervision, and that the same is true and correct to the best of my knowledge and belief.

Date Surveyed 3/14/55

Signature & Seal of Professional Surveyor

Certificate No.

1.6 Miles SE of EUNICE, New Mexico.

C.E. File No. A01839x