

APPROVED COPY TO O.C.C.

Form 9-381a
(Feb. 1951)

	X		

APR 22 1963

(SUBMIT IN TRIPLICATE) HOBBS

E. G. HUBBLE UNITED STATES
ACTING DISTRICT ENGINEER
DEPARTMENT OF THE INTERIOR
GEOLOGICAL SURVEY

Budget Bureau No. 42-R358.4.
Form Approved.

Land Office Las Cruces

Lease No. LC 068387

Unit Bell Lake

APR 22 1963

SUNDRY NOTICES AND REPORTS ON WELLS

NOTICE OF INTENTION TO DRILL.....	X	SUBSEQUENT REPORT OF WATER SHUT-OFF.....	
NOTICE OF INTENTION TO CHANGE PLANS.....		SUBSEQUENT REPORT OF SHOOTING OR ACIDIZING.....	
NOTICE OF INTENTION TO TEST WATER SHUT-OFF.....		SUBSEQUENT REPORT OF ALTERING CASING.....	
NOTICE OF INTENTION TO RE-DRILL OR REPAIR WELL.....		SUBSEQUENT REPORT OF RE-DRILLING OR REPAIR.....	
NOTICE OF INTENTION TO SHOOT OR ACIDIZE.....		SUBSEQUENT REPORT OF ABANDONMENT.....	
NOTICE OF INTENTION TO PULL OR ALTER CASING.....		SUPPLEMENTARY WELL HISTORY.....	
NOTICE OF INTENTION TO ABANDON WELL.....			

(INDICATE ABOVE BY CHECK MARK NATURE OF REPORT, NOTICE, OR OTHER DATA)

Bell Lake Unit

April 19

, 1963

Well No. 9 is located 1980 ft. from ~~XXXX~~ S line and 1980 ft. from ~~XXXX~~ W line of sec. 18
NE/4 of SW/4 Sec. 18 23S 34E NMPM
(1/4 Sec. and Sec. No.) (Twp.) (Range) (Meridian)
Wildcat Lea New Mexico
(Field) (County or Subdivision) (State or Territory)

The elevation of the derrick floor above sea level is ft.

DETAILS OF WORK

(State names of and expected depths to objective sands; show sizes, weights, and lengths of proposed casings; indicate mudding jobs, cementing points, and all other important proposed work)

It is our intention to drill a well at the above location to an approximate depth of 8,900' to attempt a completion in the Bone Spring horizon. All casing points will be cemented in accordance with approved methods of the U.S.G.S. and any special requirements will be complied with.

It is planned to use the following casing pattern: 12 1/4" hole, 8 5/8" casing to be set at 1200' and cemented w/1,000 sacks cement. Cement is to circulate. 7 7/8" hole, 5 1/2" casing to be set at 8900' and cemented w/860 sacks cement and 90 gal. latex. Cement is to return to 4000'.

Permission is requested to perform the above work and to produce this well upon completion.

I understand that this plan of work must receive approval in writing by the Geological Survey before operations may be commenced.

Company Continental Oil Company

Address Box 427

Hobbs, New Mexico

By

Title Asst. District Superintendent

U.S.G.S. (5) N.M.O.C.C. (2) WAM FILE

GPO 914974

NEW MEXICO OIL CONSERVATION COMMISSION
WELL LOCATION AND ACREAGE DEDICATION PLAT

FORM C-128
Revised 5/1/57

SEE INSTRUCTIONS FOR COMPLETING THIS FORM ON THE REVERSE SIDE

SECTION A

Operator CONTINENTAL OIL CO.		Lease BELL LAKE UNIT		Well No. 9
Unit Letter K	Section 18	Township 23 SOUTH	Range 34 EAST	County LEA
Actual Footage Location of Well: 1980 feet from the SOUTH line and 1980 feet from the WEST line				
Ground Level Elev.	Producing Formation Bone Spring		Pool Bone Spring	Dedicated Acreage: 40 Acres

1. Is the Operator the only owner in the dedicated acreage outlined on the plat below? YES ☒ NO ☐ ("Owner" means the person who has the right to drill into and to produce from any pool and to appropriate the production either for himself or for himself and another. (65-3-29 (e) NMSA 1935 Comp.)
2. If the answer to question one is "no," have the interests of all the owners been consolidated by communitization agreement or otherwise? YES ☐ NO ☐ If answer is "yes," Type of Consolidation _____
3. If the answer to question two is "no," list all the owners and their respective interests below:

Owner	Land Description

SECTION B

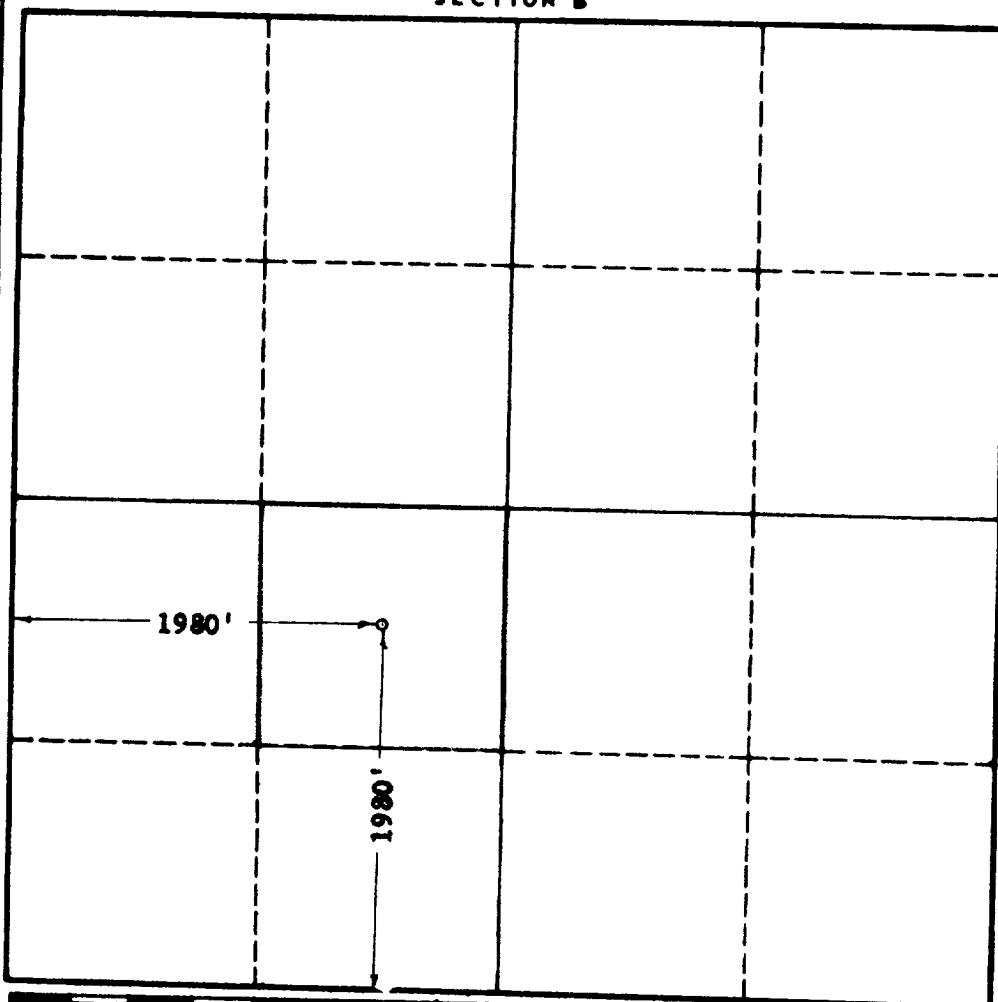

CERTIFICATION

I hereby certify that the information in SECTION A above is true and complete to the best of my knowledge and belief.

Name John W. West
Position Asst. Dist. Superintendent
Company Continental Oil Co.
Date April 19, 1963

I hereby certify that the well location shown on the plat in SECTION B was plotted from field notes of actual surveys made by me or under my supervision, and that the same is true and correct to the best of my knowledge and belief.

Date Surveyed APRIL 18, 1963
Registered Professional Engineer and/or Land Surveyor, JOHN W. WEST
John W. West
Certificate No. N. M. - P. E. & L. S. NO. 676