

NEW MEXICO OIL CONSERVATION COMMISSION
WELL LOCATION AND ACREAGE DEDICATION PLAT

FORM C-128
 Revised 5/1/57

SEE INSTRUCTIONS FOR COMPLETING THIS FORM ON THE REVERSE SIDE

OCT 7 7 40 AM '63

SECTION A

Operator MARATHON OIL CO.		Lease STATE McDONALD ACCT. "1B"		Well No. 31
Unit Letter B	Section 25	Township 22 SOUTH	Range 36 EAST	County LEA
Actual Footage Location of Well: 660 feet from the NORTH line and 2310 feet from the EAST line				
Ground Level Elev. 3423.5	Producing Formation QUEEN		Pool SOUTH EUNICE	Dedicated Acreage: 40 Acres

1. Is the Operator the only owner in the dedicated acreage outlined on the plat below? YES ☒ NO ____ . ("Owner" means the person who has the right to drill into and to produce from any pool and to appropriate the production either for himself or for himself and another. (65-3-29 (a) NMSA 1935 Comp.)
2. If the answer to question one is "no," have the interests of all the owners been consolidated by communitization agreement or otherwise? YES ____ NO ____ . If answer is "yes," Type of Consolidation _____
3. If the answer to question two is "no," list all the owners and their respective interests below:

Owner	Land Description

SECTION B

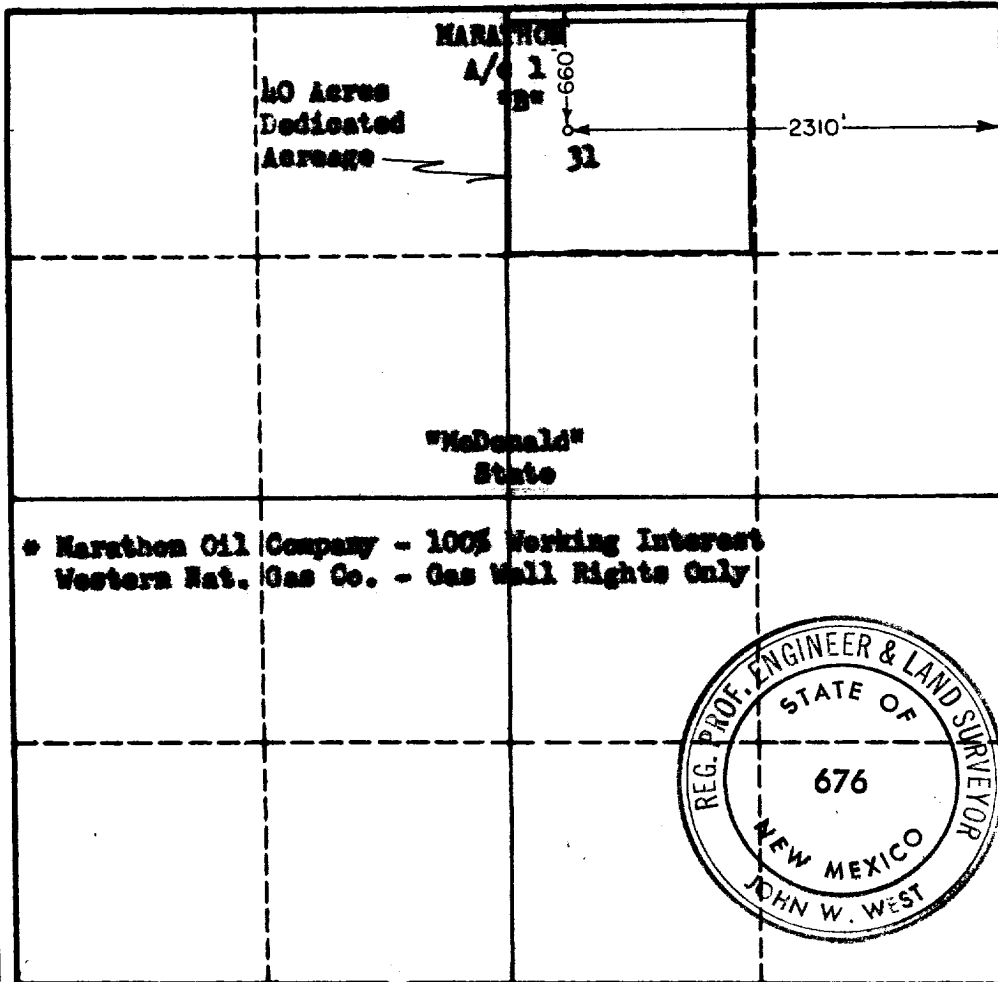

CERTIFICATION

I hereby certify that the information in SECTION A above is true and complete to the best of my knowledge and belief.

John R. Barber

Name
J. R. Barber
 Position
Area Petroleum Engineer
 Company
Marathon Oil Company
 Date
10-3-63

I hereby certify that the well location shown on the plat in SECTION B was plotted from field notes of actual surveys made by me or under my supervision, and that the same is true and correct to the best of my knowledge and belief.

Date Surveyed
10-1-63
 Registered Professional Engineer and/or Land Surveyor, **JOHN W. WEST**
John W. West
 Certificate No.
N.M. - P.E. & L.S. NO. 676

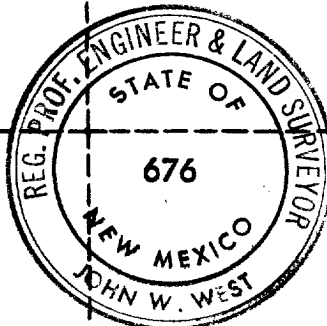

0 330 660 990 1320 1650 1980 2310 2640 2970 3300 3630 3960 4290 4620 4950 5280 5610 5940 6270 6600