

APPROVED

COPY TO O. C. C.

Budget Bureau No. 42-R358.4.  
Form Approved.

MAR 26 1963

(SUBMIT IN TRIPLICATE)

Las Cruces

Land Office

Lease No. 068680

Unit

J. L. GORDON

UNITED STATES

ACTING DISTRICT ENGINEER

DEPARTMENT OF THE INTERIOR

GEOLOGICAL SURVEY

MAR 26 1963

U. S. GEOLOGICAL SURVEY  
HOBBS, NEW MEXICO

## SUNDRY NOTICES AND REPORTS ON WELLS

NOTICE OF INTENTION TO DRILL	X	SUBSEQUENT REPORT OF WATER SHUT-OFF	
NOTICE OF INTENTION TO CHANGE PLANS		SUBSEQUENT REPORT OF SHOOTING OR ACIDIZING	
NOTICE OF INTENTION TO TEST WATER SHUT-OFF		SUBSEQUENT REPORT OF ALTERING CASING	
NOTICE OF INTENTION TO RE-DRILL OR REPAIR WELL		SUBSEQUENT REPORT OF RE-DRILLING OR REPAIR	
NOTICE OF INTENTION TO SHOOT OR ACIDIZE		SUBSEQUENT REPORT OF ABANDONMENT	
NOTICE OF INTENTION TO PULL OR ALTER CASING		SUPPLEMENTARY WELL HISTORY	
NOTICE OF INTENTION TO ABANDON WELL			

(INDICATE ABOVE BY CHECK MARK NATURE OF REPORT, NOTICE, OR OTHER DATA)

Levick

March 26

19 63

Well No. 1 is located 660 ft. from ~~XXXX~~ line and 660 ft. from ~~XXXX~~ line of sec. 20

SE/4 of SE/4 Sec. 20

23S

33E

NMIM

(1/4 Sec. and Sec. No.)

(Twp.)

(Range)

(Meridian)

Wildcat

Lea

New Mexico

(Field)

(County or Subdivision)

(State or Territory)

The elevation of the derrick floor above sea level is \_\_\_\_\_ ft.

## DETAILS OF WORK

(State names of and expected depths to objective sands; show sizes, weights, and lengths of proposed casings; indicate mudding jobs, cementing points, and all other important proposed work)

It is our intention to drill a well at the above location to an approximate depth of 5,350' to attempt a completion in the Upper Bell Canyon horizon. All casing points will be cemented in accordance with approved methods of the U.S.G.S. and any special requirements will be complied with.

It is planned to use the following casing pattern: 11" hole, 7 5/8" casing to be set at 375' and cemented w/200 sacks cement. Cement is to circulate. 6 3/4" hole, 4 1/2" casing to be set at 5,350' and cemented w/250 sacks cement. Cement is to return to 4,800'. Permission is requested to perform the above work and to produce this well upon completion.

I understand that this plan of work must receive approval in writing by the Geological Survey before operations may be commenced.

Company Continental Oil Company

Address Box 427

Hobbs, New Mexico

By *K. M. M. Alister*

Title District Superintendent

USGS (5) NMOC (2) WAM FILE

NEW MEXICO OIL CONSERVATION COMMISSION  
WELL LOCATION AND ACREAGE DEDICATION PLAT 000

FORM C-120  
Revised 5/1/57

SEE INSTRUCTIONS FOR COMPLETING THIS FORM ON THE REVERSE SIDE

SECTION A

Operator <b>CONTINENTAL OIL CO.</b>		Lease <b>LEVICK</b>		Well No. <b>1</b>	
Unit Letter <b>P</b>	Section <b>20</b>	Township <b>23 SOUTH</b>	Range <b>33 EAST</b>	County <b>LEA</b>	
Actual Footage Location of Well: <b>660</b> feet from the <b>SOUTH</b> line and <b>660</b> feet from the <b>EAST</b> line					
Ground Level Elev.	Producing Formation <b>Upper Bell Canyon</b>		Pool <b>Wildcat</b>	Dedicated Acreage: <b>40</b> Acres	

1. Is the Operator the only owner in the dedicated acreage outlined on the plat below? YES ☒ NO \_\_\_\_ . ("Owner" means the person who has the right to drill into and to produce from any pool and to appropriate the production either for himself or for himself and another. (65-3-29 (e) NMSA 1955 Comp.)
2. If the answer to question one is "no," have the interests of all the owners been consolidated by communitization agreement or otherwise? YES \_\_\_\_ NO \_\_\_\_ . If answer is "yes," Type of Consolidation \_\_\_\_
3. If the answer to question two is "no," list all the owners and their respective interests below:

Owner	Land Description

SECTION B

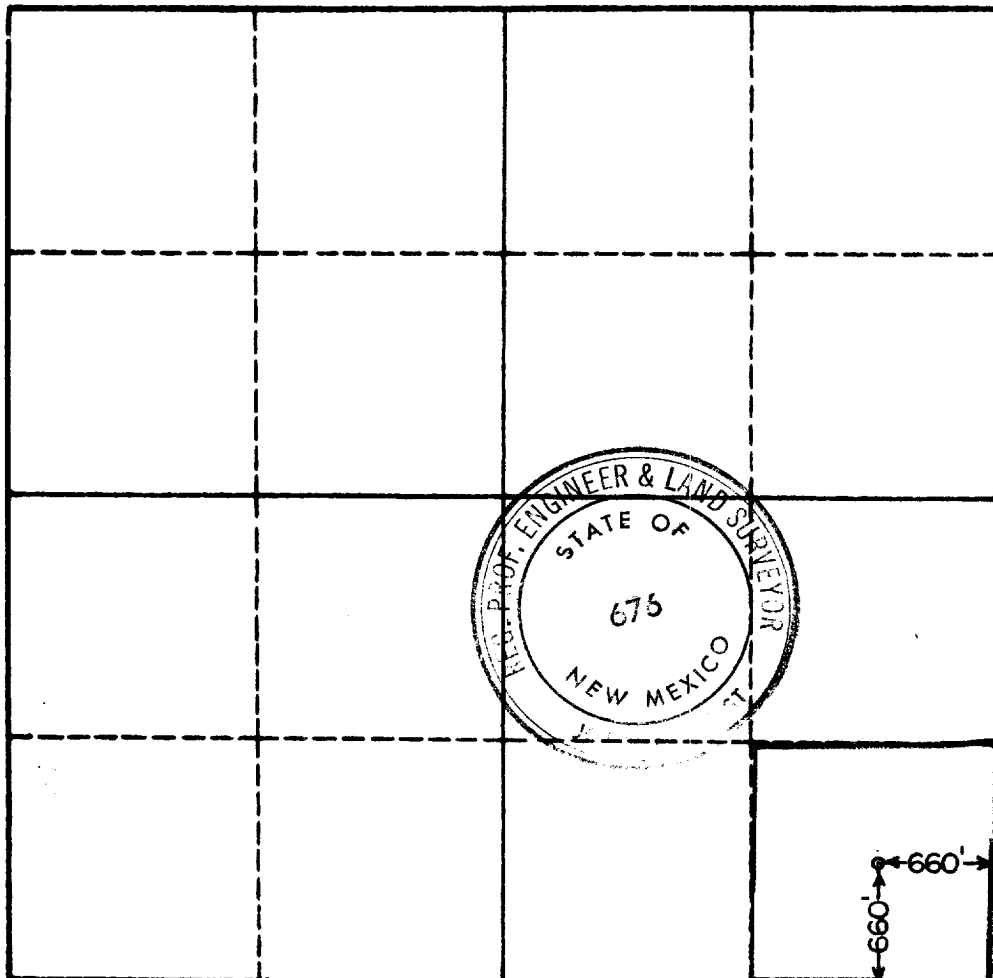

CERTIFICATION

I hereby certify that the information in SECTION A above is true and complete to the best of my knowledge and belief.

Name  
*T. M. Adair*  
Position  
**District Superintendent**  
Company  
**Continental Oil Company**  
Date  
**3-26-63**

I hereby certify that the well location shown on the plat in SECTION B was plotted from field notes of actual surveys made by me or under my supervision, and that the same is true and correct to the best of my knowledge and belief.

Date Surveyed  
**3-21-63**  
Registered Professional Engineer and/or Land Surveyor, **JOHN W. WEST**  
*John W. West*  
Certificate No.  
**N. M. - P. E. & L. S. NO. 676**

0 330 660 990 1320 1650 1980 2310 2640 2000 1500 1000 500 0