

MAR 20 1963

COPY TO O. C. C.
HOBBS

X		

E. W. STANLEY
DISTRICT ENGINEER

(SUBMIT IN TRIPLICATE)

UNITED STATES
DEPARTMENT OF THE INTERIOR
GEOLOGICAL SURVEY

Indian Agency

Las Cruces

Lease No. 062887

MAR 20 AM 8 17

SUNDRY NOTICES AND REPORTS ON WELLS

NOTICE OF INTENTION TO DRILL.....	X	SUBSEQUENT REPORT OF WATER SHUT-OFF.....	
NOTICE OF INTENTION TO CHANGE PLANS.....		SUBSEQUENT REPORT OF SHOOTING OR ACIDIZING.....	
NOTICE OF INTENTION TO TEST WATER SHUT-OFF.....		SUBSEQUENT REPORT OF ALTERING CASING.....	
NOTICE OF INTENTION TO REDRILL OR REPAIR WELL.....		SUBSEQUENT REPORT OF REDRILLING OR REPAIR.....	
NOTICE OF INTENTION TO SHOOT OR ACIDIZE.....		SUBSEQUENT REPORT OF ABANDONMENT.....	
NOTICE OF INTENTION TO PULL OR ALTER CASING.....		SUPPLEMENTARY WELL HISTORY.....	
NOTICE OF INTENTION TO ABANDON WELL.....			

(INDICATE ABOVE BY CHECK MARK NATURE OF REPORT, NOTICE, OR OTHER DATA)

March 28, 1963

Wehrli

Well No. 1 is located 990 ft. from $\begin{matrix} N \\ X \end{matrix}$ line and 2310 ft. from $\begin{matrix} E \\ W \end{matrix}$ line of sec. 25

NE/4 NW/4 of Sec. 25

(1/4 Sec. and Sec. No.)

23

(Twp.)

32

(Range)

NMPM

(Meridian)

Undesignated

(Field)

Lea

(County or Subdivision)

New Mexico

(State or Territory)

RECEIVED
MAR 23 1963

The elevation of the derrick floor above sea level is ft.

U. S. GEOLOGICAL SURVEY
ROSWELL, NEW MEXICO

DETAILS OF WORK

(State names of and expected depths to objective sands; show sizes, weights, and lengths of proposed casings; indicate mudding jobs, cementing points, and all other important proposed work)

It is my intention to drill a well at the above location to an approximate depth of 5150' to attempt a completion in the Delaware Sand horizon. All casing points will be cemented in accordance with approved methods of the USGS, and any special requirements will be complied with.

It is planned to use the following casing pattern: 11" hole, 7 5/8" casing to be set at 400' and cement with 200 sacks. Cement is to circulate. 6 3/4" hole, 4 1/2" casing to be set at 5150' and cemented with 200 sacks. Cement is to return to 3800'.

Permission is requested to produce the well upon completion.

I understand that this plan of work must receive approval in writing by the Geological Survey before operations may be commenced.

Company Hugh L. Johnston, Sr.

Address 1901 S. Heights Dr.

Roswell, New Mexico

By *Hugh L. Johnston, Sr.*

Title Owner

NEW MEXICO OIL CONSERVATION COMMISSION
WELL LOCATION AND ACREAGE DEDICATION PLAT

FORM C-128
Revised 5/1/57

SEE INSTRUCTIONS FOR COMPLETING THIS FORM ON THE REVERSE SIDE

SECTION A

Operator H. L. JOHNSTON, SR.		Lease CONTINENTAL FIELDS FEDERAL		Well No. 8117 1	
Unit Letter C	Section 25	Township 23 SOUTH	Range 32 EAST	County LEA	
Actual Footage Location of Well: 990 feet from the NORTH line and 2310 feet from the WEST line					
Ground Level Elev. 3706.3	Producing Formation		Pool		Dedicated Acreage: Acres

1. Is the Operator the only owner in the dedicated acreage outlined on the plat below? YES _____ NO _____. ("Owner" means the person who has the right to drill into and to produce from any pool and to appropriate the production either for himself or for himself and another. (65-3-29 (e) NMSA 1935 Comp.)
2. If the answer to question one is "no," have the interests of all the owners been consolidated by communitization agreement or otherwise? YES _____ NO _____. If answer is "yes," Type of Consolidation _____
3. If the answer to question two is "no," list all the owners and their respective interests below:

Owner	Land Description

SECTION B

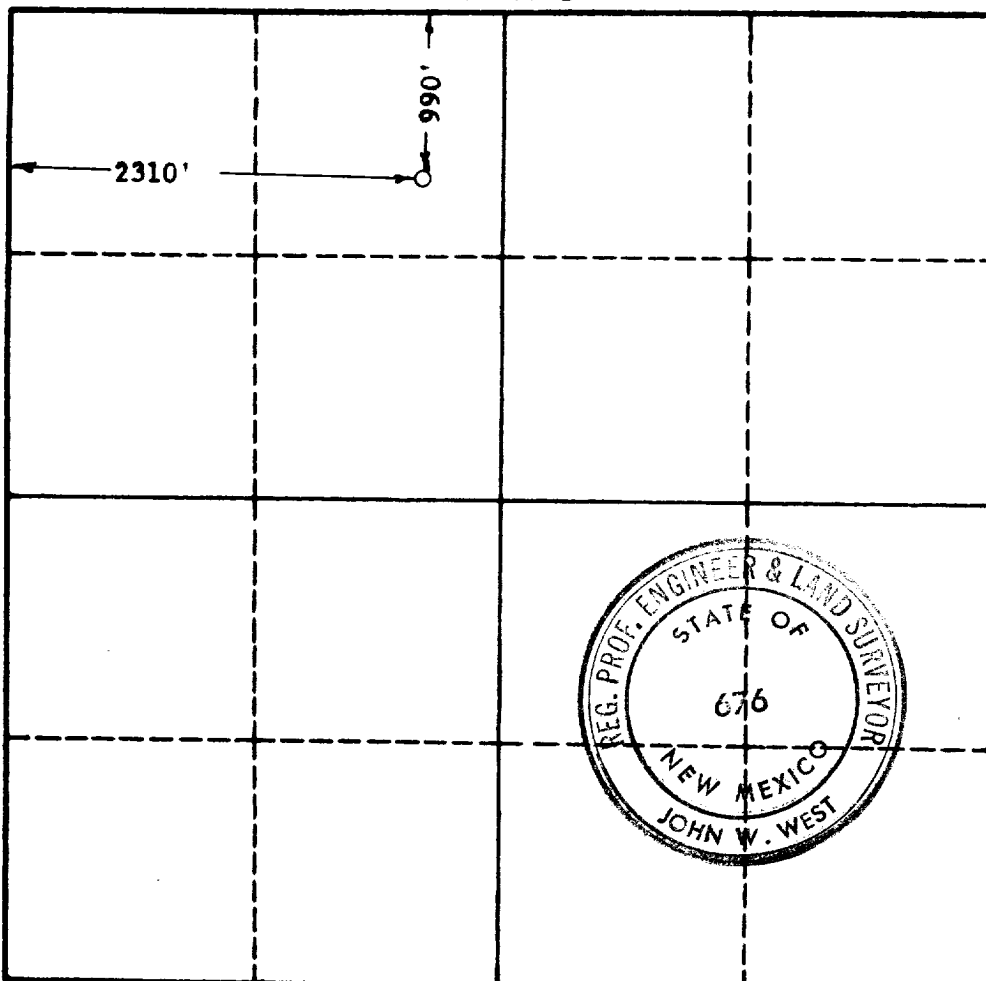

CERTIFICATION

I hereby certify that the information in SECTION A above is true and complete to the best of my knowledge and belief.

H. L. Johnston Sr.
Name

Owner
Position

Company

Date

I hereby certify that the well location shown on the plat in SECTION B was plotted from field notes of actual surveys made by me or under my supervision, and that the same is true and correct to the best of my knowledge and belief.

Date Surveyed
3-23-1963

Registered Professional Engineer
and/or Land Surveyor, JOHN W. WEST

John W. West
Signature
Certificate No.
N. M. - P. E. & L. S. NO. 676

0 330 660 990 1320 1650 1980 2310 2640 2970 3300 3630 3960 4290 4620 4950 5280 5610 5940 6270 6600