

NEW MEXICO OIL CONSERVATION COMMISSION
WELL LOCATION AND ACREAGE DEDICATION PLAT

FORM C-128
Revised 3/1/57

SEE INSTRUCTIONS FOR COMPLETING THIS FORM ON THE REVERSE SIDE

SECTION A

| | | | | | |
|---|--|--|-------------------------------|---------------------------------------|--|
| Operator Texas Pacific Oil Company | | Lease St. of New Mexico "A" Act. 2 | | Well No. 103 | |
| Unit Letter N | Section 11 | Township 23 South | Range 36 East | County Lea | |
| Actual Footage Location of Well: 660 feet from the South line and 1980 feet from the West line | | | | | |
| Ground Level Elev. | Producing Formation 7-Rivers-Queen | | Pool Langlie-Mattix | Dedicated Acreage: 40 Acres | |

1. Is the Operator the only owner in the dedicated acreage outlined on the plat below? YES ☒ NO ☐ ("Owner" means the person who has the right to drill into and to produce from any pool and to appropriate the production either for himself or for himself and another. (65-3-29 (e) NMSA 1935 Comp.)
2. If the answer to question one is "no," have the interests of all the owners been consolidated by communitization agreement or otherwise? YES ☐ NO ☐ If answer is "yes," Type of Consolidation _____
3. If the answer to question two is "no," list all the owners and their respective interests below:

| Owner | Land Description |
|-------|------------------|
| | |
| | |

SECTION B

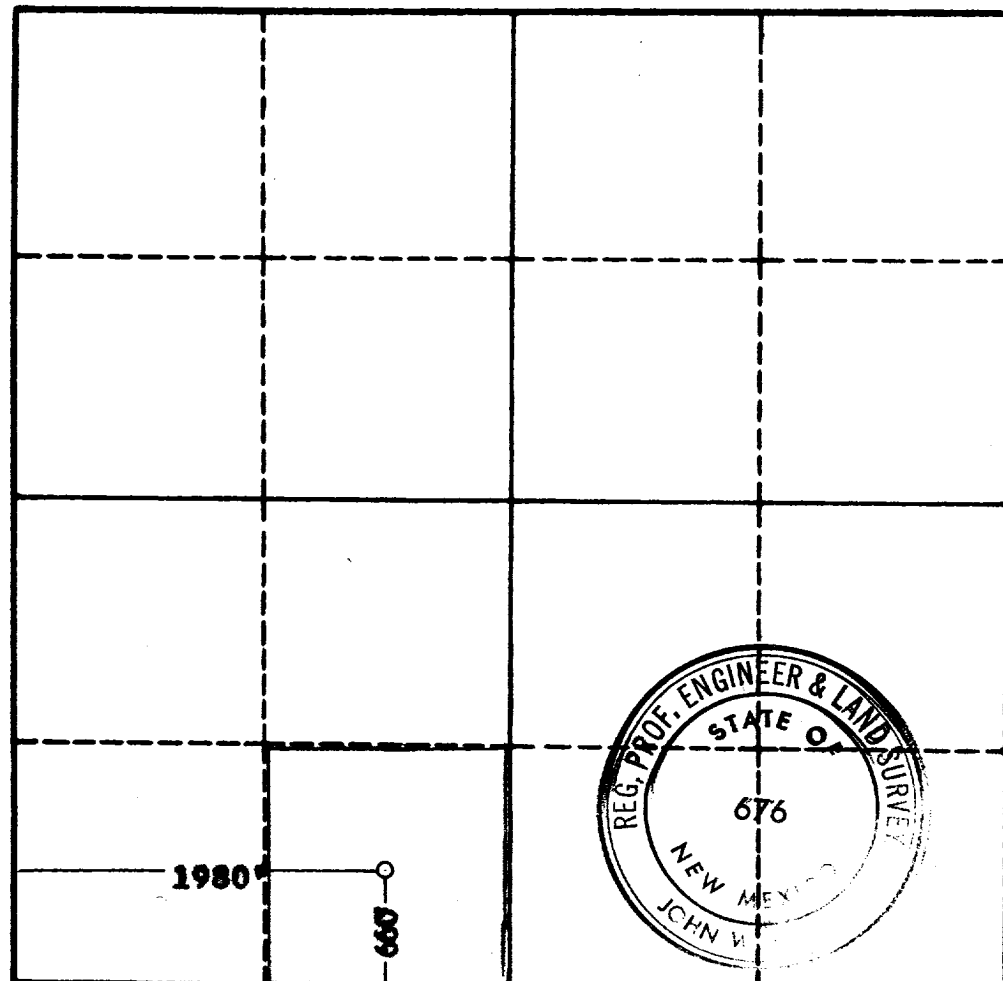

CERTIFICATION

I hereby certify that the information in SECTION A above is true and complete to the best of my knowledge and belief.

Name *[Signature]*
Position
Division Superintendent
Company
TEXAS PACIFIC OIL COMPANY
Date
November 22, 1963

I hereby certify that the well location shown on the plat in SECTION B was plotted from field notes of actual surveys made by me or under my supervision, and that the same is true and correct to the best of my knowledge and belief.

Date Surveyed
11-21-63
Registered Professional Engineer and/or Land Surveyor, **JOHN W. WEST**
[Signature]
Certificate No.
N. M. - P. E. & L. S. NO. 676

0 330 660 990 1320 1650 1980 2310 2640 2970 3300 0