

N. M. OIL CONS. COMMISS
P. O. BOX 1980
HOBBS, NEW MEXICO 88240SUBMIT IN TRIPLICATE*
(Other Instr. on
reverse side)Form approved.
Budget Bureau No. 42-R1425.UNITED STATES
DEPARTMENT OF THE INTERIOR
GEOLOGICAL SURVEY

APPLICATION FOR PERMIT TO DRILL, DEEPEN, OR PLUG BACK

1a. TYPE OF WORK

DRILL ☐DEEPEN ☐PLUG BACK ☒

b. TYPE OF WELL

OIL
WELL ☒GAS
WELL ☐

OTHER

SINGLE
ZONE ☐MULTIPLE
ZONE ☒

2. NAME OF OPERATOR

Texaco Inc.

3. ADDRESS OF OPERATOR

Box 3109 Midland, Texas 79701

4. LOCATION OF WELL (Report location clearly and in accordance with any State requirements.)*

At surface

660' FSL & 660' FEL, Section 20

At proposed prod. zone

14. DISTANCE IN MILES AND DIRECTION FROM NEAREST TOWN OR POST OFFICE*

7 Miles Southeast of Eunice, New Mexico

15. DISTANCE FROM PROPOSED*

LOCATION TO NEAREST

PROPERTY OR LEASE LINE, FT.

(Also to nearest drlg. unit line, if any)

2088'

660'

18. DISTANCE FROM PROPOSED LOCATION*

TO NEAREST WELL, DRILLING, COMPLETED,
OR APPLIED FOR, ON THIS LEASE, FT.

1320'

16. NO. OF ACRES IN LEASE

1855.12

19. PROPOSED DEPTH

6630 PBTD

17. NO. OF ACRES ASSIGNED
TO THIS WELL

40

20. ROTARY OR CABLE TOOLS

21. ELEVATIONS (Show whether DF, RT, GR, etc.)

3376 Gr

22. APPROX. DATE WORK WILL START*

May 15, 1983

23.

PROPOSED CASING AND CEMENTING PROGRAM

SIZE OF HOLE	SIZE OF CASING	WEIGHT PER FOOT	SETTING DEPTH	QUANTITY OF CEMENT
11"	8 5/8"	28#, 24#, 20#	1397'	530 Sacks
7 7/8"	2 7/8"	6.5#	7340'	1200 Sacks

Refer to Attachment for Workover Program

* Present Drinkard completion will be plugged & abandoned during this workover.

RECEIVED

APR 13 1983

OIL & GAS
MINERALS MGMT. SERVICE
ROSWELL, NEW MEXICO

IN ABOVE SPACE DESCRIBE PROPOSED PROGRAM: If proposal is to deepen or plug back, give data on present productive zone and proposed new productive zone. If proposal is to drill or deepen directionally, give pertinent data on subsurface locations and measured and true vertical depths. Give blowout preventer program, if any.

24.

SIGNED

R. S. Lane

TITLE Asst. Petr. Engr. Manager

DATE April 12, 1983

(This space for Federal or State office use)

PERMIT NO.

APPROVAL DATE

APPROVED BY

(Orig. Sgd.) PETER W. CHESTER

TITLE

DATE

CONDITIONS OF APPROVAL, IF ANY:

APR 19 1983

note change
step #2

*See Instructions On Reverse Side

RECEIVED

APR 22 1983

C.C.D.
HOBBS OFFICE

A. H. Blinebry NCT-1 # 32
Lea County, New Mexico
Workover Program

APR 13 1983

MINERALS MGMT. CO.
ROSWELL, NEW MEXICO

1. Move in rig up: install BOP
2. Run in hole w/CIBP set @ ~~6550~~⁶⁹⁵⁰ POH
3. Run back in w/1 11/16" dump bailer, cap CIBP w/40cmt. P.O.H. Prep to perforate.
4. Run in hole w/1 9/16" perforating gun, perforate Tubb zone w/1JSPI @ 6356,61,66,69,72,74,79,83,91,99,6411,19,21,28,30,33,38,44,51,61,72,76,80,83,88,6500,03,10,13,19,34,38 (32 holes)
5. Test 2 1/16" N-80 tbg, PKR & RBP to 6000 psi set RBP @ 6570' cap w/sand. Pull up set PKR @ 6300'; load back side; prep to acidize.
6. Acidize Tubb perforations 6356-6538 w/6500 gal 20% NE-FE LST Acid in (3) three equal stages according to the following procedure. (4-5 BPM 6000 Psi max)
 - A. Pump 500 gal acid.
 - B. Pump 1500 gal 30 lb gelled 2% KCI water pad w/1PPG 100 mesh sand (for fluid loss control).
 - C. Pump 2000 gal acid.
 - D. Pump 500 gal 2% KCI water.
 - E. Pump 150 lbs. Rock Salt Block in 4 bbls of 10 lb brine.
 - F. Repeat B-E adjusting block as necessary.
 - G. Repeat B-D.
 - H. Overflush w/1000 gal 2% KCI water
 - I. Shut in one hour; test and evaluate. Run in and record 72 hr. build up if necessary.
7. Release PKR Retrieve RBP @ 6570'. Pull up set RBP @ 6310' cap w/sand P.O.H.
8. Run in hole w/1 9/16" perforating gun perforate Blinebry zone w/1JSPI @ 5820,26,30,35,40,45,48,57,68,70,91,93,97,5907,18,30,33,54,88,6006,19,24,26,30,39,58,62,81,6118,25,28,34,44,52,56,63,92,6203,6209,17,44,68,74, (43 holes) P.O.H
9. Run in w/2 1/16 N-80 tbg & PKR @ 5750. Load Back Side Prep to Acidize.
10. Acidize Blinebry perforations (5820'- 6274') w/8500 gal 20% NE-FE LST Acid in 4 equal stages according to the following procedure. (4-5 BPM 6000 psi max)
 - A. Pump 500 gal acid
 - B. Pump 1500 gal 30 lb gelled 2% KCI water pad w/1PPG 100 mesh sand (for fluid loss control).
 - C. Pump 2000 gal Acid.
 - D. Pump 500 gal 2% KCI water.
 - E. Pump 150 lbs rock salt block in 4 bbls of 10 lb. brine.
 - F. Repeat B-E twice adjusting block as necessary.
 - G. B-D
 - H. Overflush w/1000 gal 2% KCI water.
 - I. Shut in one hour; test and evaluate.

RECEIVED

APR 22 1983

O.C.D.
HOBBS OFFICE

11. Run in w/BHP recording device record 72 hour build-up. From data determine if zones can be DHC.
12. If zones can be DHC release PKR; retrieve RBP @ 6310 POH.
13. Run 2 1/16" tubing as deep as possible; pump and rods return to production.
14. If zones can not be DHC; leave RBP @ 6310 Run 2 1/16" tbg pump and rods and place Blinbry zone on production.

RECEIVED

APR 22 1983

O.C.D.
HOBBS OFFICE

N MEXICO OIL CONSERVATION COMMISSION
WELL LOCATION AND ACREAGE DEDICATION PLAT

Form C-102
Supersedes C-128
Effective 1-1-65

All distances must be from the outer boundaries of the Section.

Operator TEXACO Inc.			Lease A. H. Blinebry NCT-1		Well No. 32
Unit Letter P	Section 20	Township 22 South	Range 38 East	County Lea	
Actual Footage Location of Well: 660 feet from the South line and 660 feet from the East line Sec. 20					
Ground Level Elev. 3376	Producing Formation Blinebry & Tubb		Pool Blinebry & Tubb		Dedicated Acreage: 40 Acres

1. Outline the acreage dedicated to the subject well by colored pencil or hachure marks on the plat below.
2. If more than one lease is dedicated to the well, outline each and identify the ownership thereof (both as to working interest and royalty).
3. If more than one lease of different ownership is dedicated to the well, have the interests of all owners been consolidated by communitization, unitization, force-pooling, etc?

☐ Yes ☐ No If answer is "yes," type of consolidation _____

If answer is "no," list the owners and tract descriptions which have actually been consolidated. (Use reverse side of this form if necessary.) _____

No allowable will be assigned to the well until all interests have been consolidated (by communitization, unitization, forced-pooling, or otherwise) or until a non-standard unit, eliminating such interests, has been approved by the Commission.

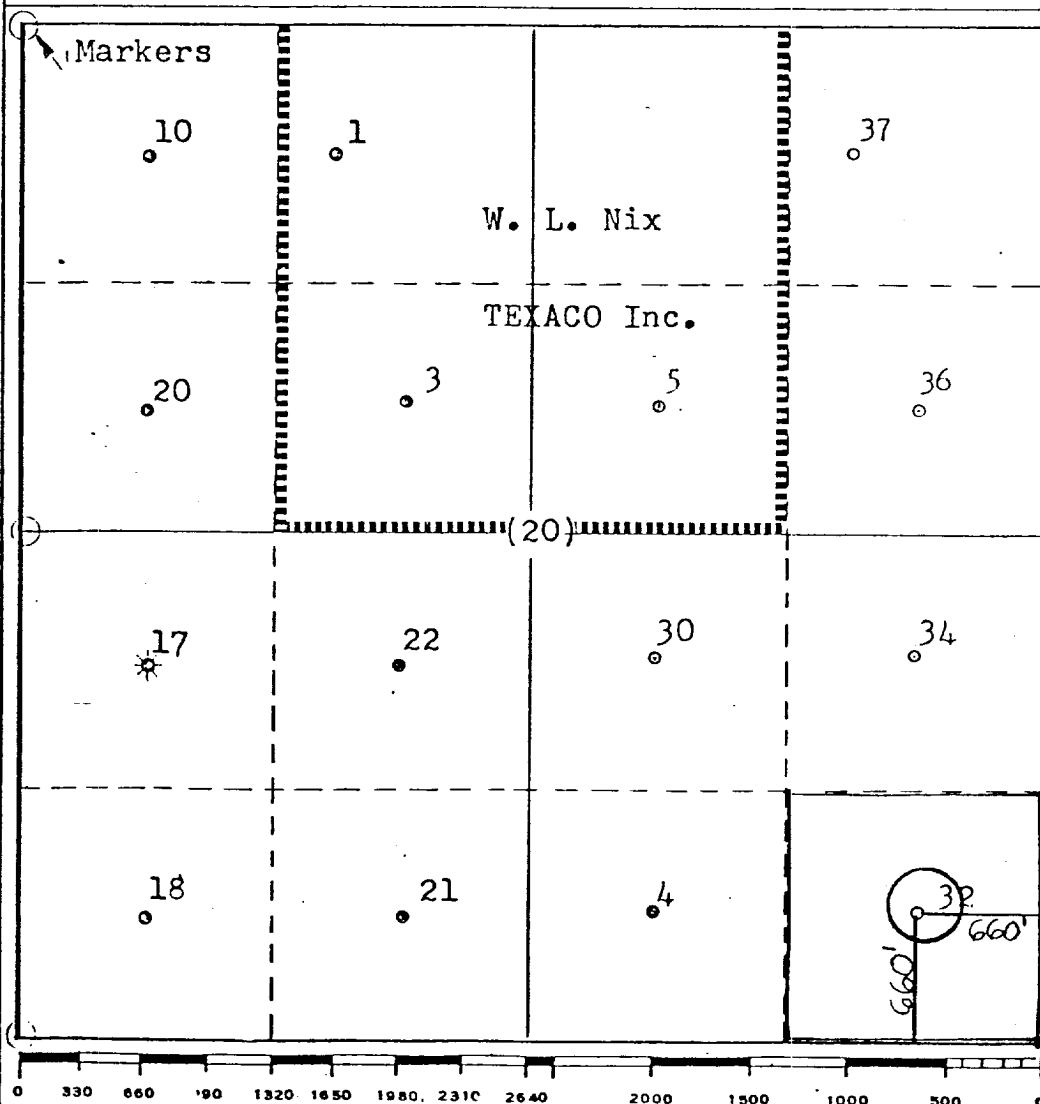

CERTIFICATION

I hereby certify that the information contained herein is true and complete to the best of my knowledge and belief.

R. S. Lane
Name
R. S. Lane
Position
Asst. Petr. Eng. Manager
Company
Texaco Inc.
Date

I hereby certify that the well location shown on this plat was plotted from field notes of actual surveys made by me or under my supervision, and that the same is true and correct to the best of my knowledge and belief.

Date Surveyed
Registered Professional Engineer and/or Land Surveyor
Certificate No.

RECEIVED

APR 22 1983

C.C.D.
HOBBS OFFICE