

NO. OF COPIES RECEIVED		
DISTRIBUTION		
SANTA FE		
FILE		
U.S.G.S.		
LAND OFFICE		
OPERATOR		

NEW MEXICO OIL CONSERVATION COMMISSION

Form C-101
Revised 1-1-65

5A. Indicate Type of Lease	
STATE <input type="checkbox"/>	FEE <input checked="" type="checkbox"/>
5. State Oil & Gas Lease No.	

APPLICATION FOR PERMIT TO DRILL, DEEPEN, OR PLUG BACK

1a. Type of Work		7. Unit Agreement Name	
b. Type of Well OIL WELL <input checked="" type="checkbox"/> GAS WELL <input type="checkbox"/> OTHER <input type="checkbox"/>		8. Farm or Lease Name Boyd	
2. Name of Operator Samedan Oil Corporation		9. Well No. 2	
3. Address of Operator 2207 Wilco Building, Midland, Texas 79701		10. Field and Pool, or Wildcat Brumson (McKee)	
4. Location of Well UNIT LETTER J LOCATED 1650 FEET FROM THE South LINE AND 2090 FEET FROM THE East LINE OF SEC. 23 TWP. 22-J RGE. 37-N NMPM		12. County Lea	
19. Proposed Depth 7800'		19A. Formation McKee Sand	
20. Rotary or C.T. Rotary		21. Elevations (Show whether DF, RT, etc.) 3319.9 G.L.	
21A. Kind & Status Plug. Bond Blanket - OK		21B. Drilling Contractor Unknown at present	
22. Approx. Date Work will start Upon approval			

PROPOSED CASING AND CEMENT PROGRAM

SIZE OF HOLE	SIZE OF CASING	WEIGHT PER FOOT	SETTING DEPTH	SACKS OF CEMENT	EST. TOP
12-3/4"	9-5/8"	32.30#	1150	Circ. to surface	Surface
7-7/8"	4-1/2"	11.6 #	7800	450	5000

The proposed total depth of this well is 7800'. We plan to drill and run casing according to the above outlined program. Completion will be made in the McKee Sand if shows and tests warrant.

IN ABOVE SPACE DESCRIBE PROPOSED PROGRAM: IF PROPOSAL IS TO DEEPEN OR PLUG BACK, GIVE DATA ON PRESENT PRODUCTIVE ZONE AND PROPOSED NEW PRODUCTIVE ZONE. GIVE BLOWOUT PREVENTER PROGRAM, IF ANY.

I hereby certify that the information above is true and complete to the best of my knowledge and belief.

Signed G. W. Putnam Title Division Production Superintendent Date April 2, 1968

(This space for State Use)

APPROVED BY [Signature] TITLE Sec. DATE 7-8-68

CONDITIONS OF APPROVAL, IF ANY:

**NEW MEXICO OIL CONSERVATION COMMISSION
WELL LOCATION AND ACREAGE DEDICATION PLAT**

Form C-102
Supersedes C-128
Effective 1-1-65

All distances must be from the outer boundaries of the Section

Operator SAMEDAN OIL CORP.		Lease BOYD		Well No. 2
Unit Letter J	Section 23	Township 22 SOUTH	Range 37 EAST	County LEA
Actual Footage Location of Well: 1650 feet from the SOUTH line and 2090 feet from the EAST line				
Ground Level Elev. 3319.9	Producing Formation McKee Sand	Pool East Brunson (McKee)	Dedicated Acreage: 40 Acres	

1. Outline the acreage dedicated to the subject well by colored pencil or hatchure marks on the plat below.
2. If more than one lease is dedicated to the well, outline each and identify the ownership thereof (both as to working interest and royalty).
3. If more than one lease of different ownership is dedicated to the well, have the interests of all owners been consolidated by communitization, unitization, force-pooling, etc?

☐ Yes ☐ No If answer is "yes," type of consolidation _____

If answer is "no," list the owners and tract descriptions which have actually been consolidated. (Use reverse side of this form if necessary.) _____

No allowable will be assigned to the well until all interests have been consolidated (by communitization, unitization, forced-pooling, or otherwise) or until a non-standard unit, eliminating such interests, has been approved by the Commission.

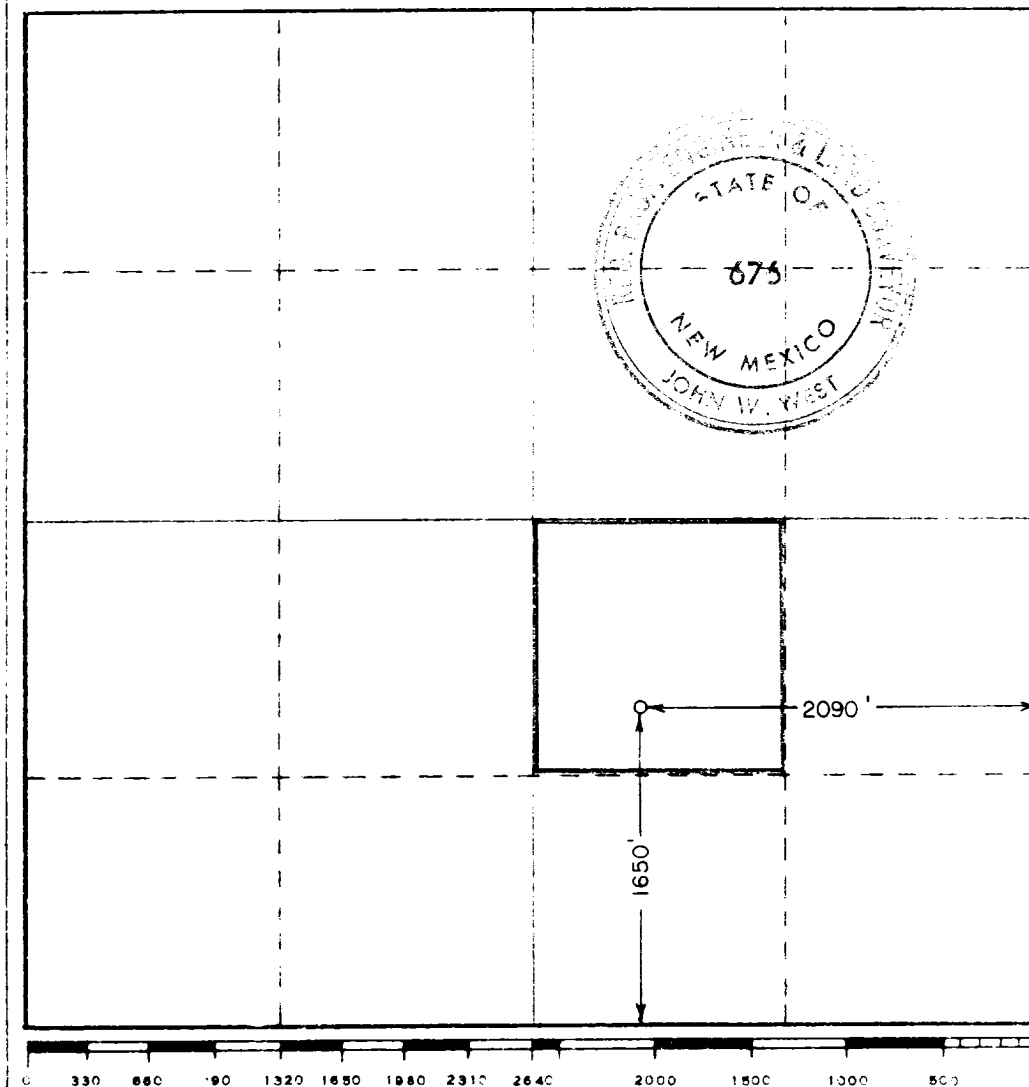

CERTIFICATION

I hereby certify that the information contained herein is true and complete to the best of my knowledge and belief.

G. W. Putnam
Signature

**G. W. Putnam
Div. Prod. Supt.**

Location
Samedan Oil Corporation

Date
April 2, 1968

I hereby certify that the well location shown on this plat was plotted from field notes of actual surveys made by me or under my supervision, and that the same is true and correct to the best of my knowledge and belief.

Date Surveyed
MARCH 19, 1968

Registered Professional Engineer and/or Land Surveyor

[Signature]
Certificate No.

676